

Dual Line Common Mode Panel Mount Filter

Employing a common mode choke, line to ground and line to line capacitance enables attenuation of common and differential mode voltages (noise) from both lines on inputs and outputs of AC or DC systems in a single hermetically sealed package.

Features

- EMI filtering of common mode noise from 30 KHz to 1 GHz
- Differential mode noise filtering from 30 KHz to 10 MHz
- Voltage ratings from 50 V to 200 VDC/130 VAC, 400 Hz
- Designed to meet MIL-PRF-15733
- Popular 0.690" case diameter
- Space saving, compact design
- 50% less the weight versus employing two single line filters

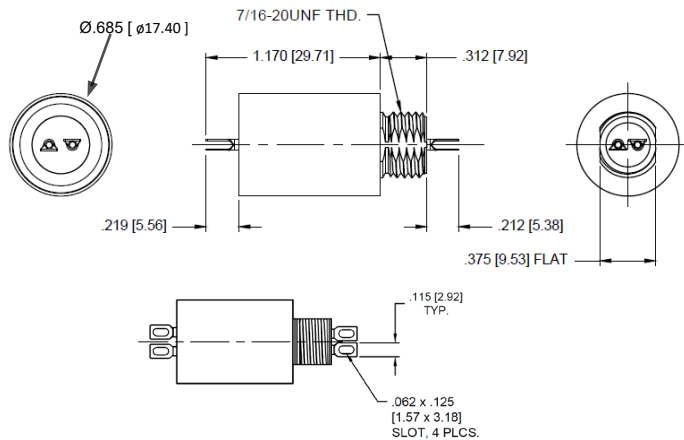

Applications

- Telecommunication equipment
- Military and defense applications
- Industrial control panels
- Measuring and testing instruments
- Medical equipment



Schematic

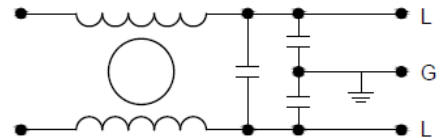

Electrical Specifications - 0.690 Ø Dual Line Mode Standard Product

Part Number	Rated Voltage		Current	DCR Max Ohms /Line	Mode	Minimum Insertion Loss (dB) No Load 25°C						
	DC	AC				30 KHz	100 KHz	300 KHz	1 MHz	10 MHz	100 MHz	1 GHz
51-875-003	200	130	1	0.08	Comm	-	11	28	50	60	70	65
					Diff	12	21	30	36	48	-	-
51-875-004	200	130	3	0.025	Comm	-	9	22	43	60	65	65
					Diff	12	21	30	36	48	-	-
51-875-001	200	130	5	0.01	Comm	-	-	15	33	56	65	60
					Diff	9	18	27	35	50	-	-
51-875-002	100	-	10	0.008	Comm	16	26	40	56	70	70	60
					Diff	20	30	39	49	58	-	-

X-ON Electronics

Largest Supplier of Electrical and Electronic Components

Click to view similar products for [Common Mode Chokes / Filters](#) category:

Click to view products by [Spectrum](#) manufacturer:

Other Similar products are found below :

[PE-64683](#) [RD5122-6-9M6](#) [ST6118T-R](#) [FE3X025-10-7NL](#) [T8114NLT](#) [TCM0806G-350-2P-T](#) [TCM0806G-650-2P-T](#) [IND-0110](#)
[UAL21VR0802000](#) [UALSC023000000](#) [UALSC1020JH000](#) [UALSU10VD20010](#) [UALSU9VD070100](#) [36-00037](#) [CM7060M132R-10](#)
[UALW21HS072450](#) [UALSU9H0208000](#) [UAL24VK06450CH](#) [PE-67531](#) [TLH10UB](#) [113 OR5](#) [2752045447](#) [CM8663Z161B-10](#) [7351V](#)
[CMF16-153131](#) [T8116NLT](#) [CMS2-10-R](#) [FE2X10-4-2NL](#) [T8003NLT](#) [CTX01-13663](#) [CTX66-19521-R](#) [RC212-0.5-10M](#) [RC112-0.4-15M](#)
[RC212-0.6-6M8](#) [RC212-0.4-15M](#) [RC112-0.3-30M](#) [4534-3](#) [WTCF2012Z0M751PB](#) [PH9408.814NLT](#) [B82498B3221J000](#) [PAC6006.364NLT](#)
[PAC6006.444NLT](#) [PAC6006.204NLT](#) [PH9407.204NLT](#) [PAC6006.264NLT](#) [PH9408.105NLT](#) [PH9408.494NLT](#) [PAC6006.104NLT](#)
[CM6350R-683-REEL](#) [CUW43T-513T-AU](#) [CUW43T-104T-AU](#)