

R NON FLAMMABLE WIRE WOUND RESISTOR

DIMENSION

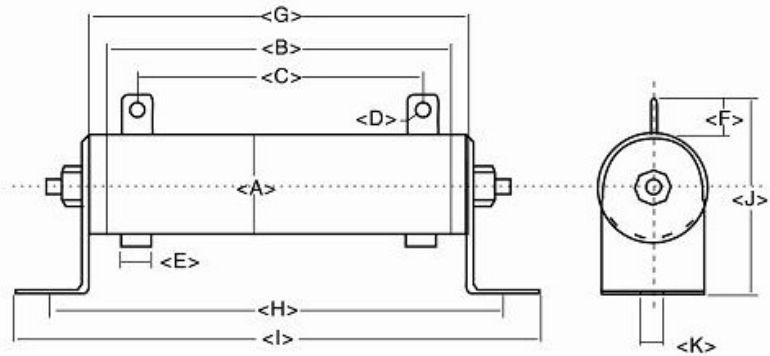

SPECIFICATIONS

(W) Power Rating	Dimensions (mm)											(Ω) Resistance Range	Remark
	A±1	B±2	C±2	D±0.1	E±0.2	F±1	G±2	H±2	I±2	J±2	K±0.1		
R - 10W	12.5	45	37	2.1	4	10.5	46	53	63	28	4	1Ω ~ 5KΩ	
R - 20W	16.5	60	49	3	5	12	70	78	97	42	4	1Ω ~ 10KΩ	
R - 30W	16.5	80	69	3	5	12	90	98	117	42	4	1Ω ~ 15KΩ	
R - 40W	16.5	110	99	3	5	12	120	128	147	42	4	1Ω ~ 20KΩ	
R - 50W	25	110	94	5.2	8	19	120	142	164	58	6	0.1Ω ~ 25KΩ	
R - 60W	28	90	72	5.2	8	17.6	101	125	145	60	6	0.1Ω ~ 30KΩ	
R - 80W	28	110	92	5.2	8	17.6	121	145	165	60	6	0.1Ω ~ 40KΩ	
R - 100W	28	140	122	5.2	8	17.6	151	175	195	60	6	0.1Ω ~ 50KΩ	
R - 120W	28	160	142	5.2	8	17.6	171	195	215	60	6	0.1Ω ~ 60KΩ	
R - 150W	28	195	177	5.2	8	17.6	206	230	250	60	6	0.1Ω ~ 75KΩ	
R - 160W	35	185	167	5.2	8	18	197	219	249	75	8	0.1Ω ~ 80KΩ	
R - 200W	35	210	190	5.2	8	18	222	244	274	75	8	0.1Ω ~ 100KΩ	
R - 250W	40	210	186	5.5	10	17.5	224	245	277	88.8	9	0.5Ω ~ 125KΩ	
R - 300W	40	260	241	5.5	10	17.5	273	294	327	88.8	9	0.5Ω ~ 150KΩ	
R - 400W	40	330	305	5.5	10	17.5	343	362	396	88.8	9	0.5Ω ~ 200KΩ	
R - 500W	50	330	298	6.4	12	25.5	346	367	400	99	10	0.5Ω ~ 250KΩ	
R - 600W	50	400	368	6.4	12	25.5	416	437	470	99	10	1Ω ~ 300KΩ	
R - 700W	50	460	428	6.4	12	25.5	475	497	528	99	10	1Ω ~ 350KΩ	
R - 800W	60	460	420	6.4	15	28	480	502	533	112	10	1Ω ~ 400KΩ	
R - 1000W	60	540	500	6.4	15	28	560	582	613	110	10	1Ω ~ 500KΩ	
R - 1300W	65	650	615	6.4	15	31	672	696	725	125	10	1Ω ~ 600KΩ	

R NON FLAMMABLE WIRE WOUND RESISTOR

ELECTRICAL PERFORMANCE

Characteristics	Limits	Test methods
Resistance and resistance tolerance	Resistance nominal $1\Omega \leq R$	JIS-C-5202 5-1
	Resistance tolerance $\pm 5\% (J)$	
Temperatuer coefficient	$1\Omega > R$	JIS-C-5202 5-2 b
	$\pm 200\text{ppm}/^\circ\text{C}$ max.	
Power rating load	$\Delta R/R \leq \pm(1\% + 0.05\Omega)$ (temperature) 350°C max.	JIS-C-5202 5-4
Short-time overload	1000% rated power 5 seconds $\Delta R/R \leq \pm(2\% + 0.05\Omega)$	JIS-C-5202 5-5
Insulation resistance	DC500V $100\text{M}\Omega$ mim.	JIS-C-5202 5-6
Dielectric withstanding voltage	AC3000V 1 mintue	JIS-C-5202 5-7

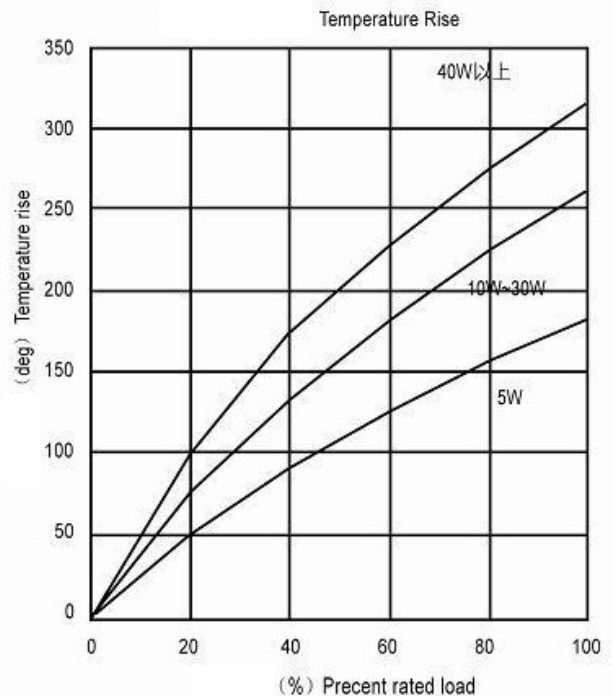
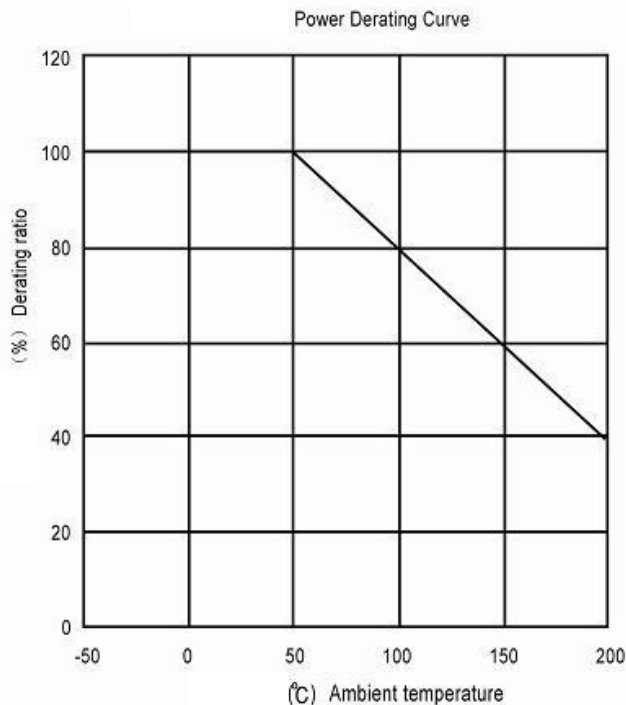

Short-time Overload Rating

(Second) Load Time	1	2	3	4	5	10	30	60	180	300	600	900
(%) Power Increase	2600	2000	1600	1400	1300	1000	600	450	200	150	120	110

X-ON Electronics

Largest Supplier of Electrical and Electronic Components

Click to view similar products for [Wirewound Resistors - SMD category](#):

Click to view products by [SR Passives manufacturer](#):

Other Similar products are found below :

[SMW5120RJT](#) [SMW518RJT](#) [SMW524RJT](#) [SMW52R2JT](#) [SMW530RJT](#) [WSM24R99FLFTR](#) [RWS5 R47 J B](#) [RWS5 R68 F B](#) [SMW516RJT](#)
[SMW52R7JT](#) [SMW57R5JT](#) [SMW5R33JT](#) [SMW5R39JT](#) [SMW551RJT](#) [RWS5 82R F B](#) [RWS5 1R F B](#) [RWS5 120R F B](#) [RWS5 10R F B](#)
[RWS5 100R J B](#) [RWS5 1R5 F B](#) [SMW51R2JT](#) [SMW512RJT](#) [ACS-10S-15R-J](#) [PRZDAWJW101B00](#) [SMW3300RJT](#) [RW7S0FB180RJET](#)
[RW5S0FA470RJET](#) [RW7S0FB4K70JET](#) [RW7S0FB4K70FET](#) [RWS5 1R J B](#) [RWS5 33R J B](#) [0480100/7660087](#) [QL0000J0220200](#)
[QL0025J0101000](#) [QL0025J0470000](#) [QL0050J0100000](#) [QL0050J0362000](#) [QL0050J0470000](#) [R100W-10R](#) [R100W-22R](#) [R150W-470R](#)
[HEWRB0J0101600](#) [HEWRB0J0220600](#) [R200W-220R](#) [R200W-22R](#) [R50W-10R](#) [R50W-22R](#) [R50W-2R2](#) [R80W-10K](#) [R80W-47R](#)