

Dimensions mm[inch]
tolerances acc. to DIN ISO 2768-m
Toleranzen gem. DIN ISO 2768-m

Isometric
Scale 2:1
Maßstab 2:1

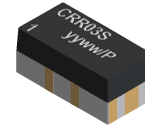

Post reflow height

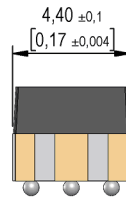
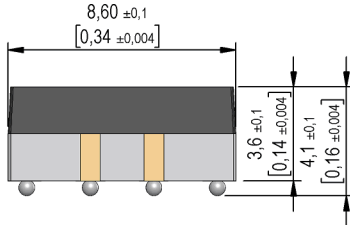
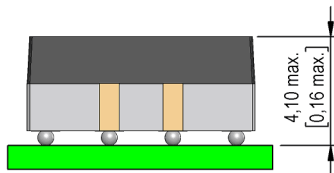

Layout

Top view
Draufsicht

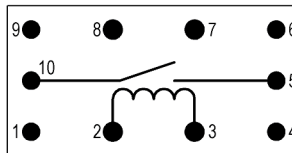

Marking

according to EN60062/factory code
gem. EN60062/Fertigungsstätte

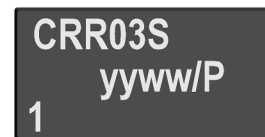

Recommended PCB Pad Layout

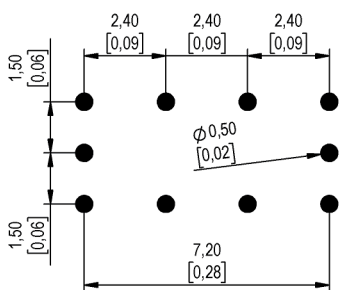

Recommended Reflow Lead-free Profile

(acc. to JEDEC J-STD 020D.1)
for usage with a tin Sn96.5/Ag3/Cu0.5

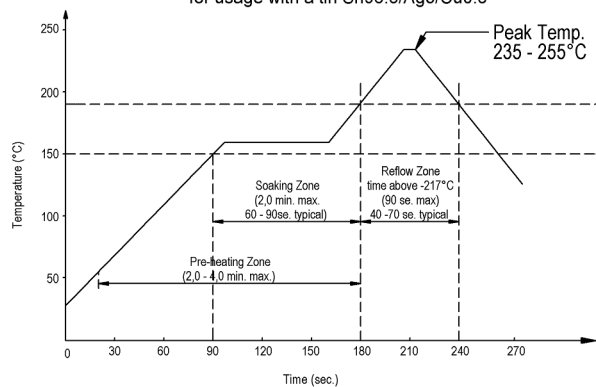

Relay packaging orientation

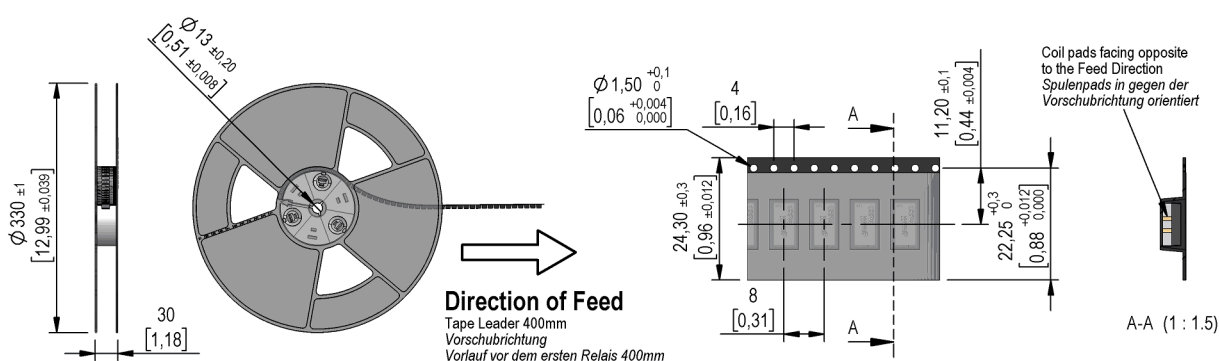



Europe: +49 / 7731 8399 0

| Email: info@standexmeder.com

Item No.:

USA: +1 / 508 295 0771

| Email: salesusa@standexmeder.com

9603180010

Asia: +852 / 2955 1682

| Email: salesasia@standexmeder.com

Item:

CRR03-1AS

| Coil Data at 20 °C | Conditions | Min | Typ | Max | Unit |
|--------------------|------------|------|-----|------|------|
| Coil resistance | | 63 | 70 | 77 | Ohm |
| Coil voltage | | | 3 | | VDC |
| Rated power | | | 129 | | mW |
| Pull-In voltage | | | | 2,25 | VDC |
| Drop-Out voltage | | 0,45 | | | VDC |

| Contact data 80 | Conditions | Min | Typ | Max | Unit |
|---------------------------|---|---------|-------|------|------|
| Contact-material | | Rhodium | | | |
| Contact-rating | Any DC combination of V & A not to exceed their individual max.'s | | | 10 | W |
| Switching voltage | DC or Peak AC | | | 170 | V |
| Switching current | DC or Peak AC | | | 0,5 | A |
| Carry current | DC or Peak AC | | | 1 | A |
| Contact resistance static | Measured with 40% overdrive Start Value | | | 200 | mOhm |
| Insulation resistance | RH <45 %, 100 V test voltage | 100 | 1.000 | | GOhm |
| Breakdown voltage | according to EN 60255-5 | 210 | | | VDC |
| Operate time incl. bounce | measured with 40% overdrive | | | 0,6 | ms |
| Release time | measured with no coil excitation | | | 0,05 | ms |
| Capacitance | @ 10 kHz above open switch | | 0,3 | 0,5 | pF |

| Special Product Data | Conditions | Min | Typ | Max | Unit |
|------------------------------------|--|---|-----|-----|-------|
| Number of contacts | | 1 | | | |
| Contact - form | | A - NO | | | |
| Contact Bulk Resistance | Through all plated material on substrate | | 260 | 440 | mOhm |
| Dielectric Strength Coil/Contact | according to EN 60255-5 | 1,5 | | | kV DC |
| Insulation resistance Coil/Contact | RH <45%, 200 VDC Measuring Voltage | 10 | 100 | | TOhm |
| Capacitance Coil/Contact | @ 10 kHz | | 0,9 | 1,1 | pF |
| Case color | | black/white | | | |
| Housing material | | Ceramic + mineral filled epoxy | | | |
| Material connection pads | | BGA solderballs D=0,025" (Sn96,5 Ag3 Cu0,5) | | | |
| Magnetic Shield | | yes, internal | | | |
| Approval | | UL-File No. NRNT2.E156887 | | | |
| Reach / RoHS conformity | | yes | | | |

| Environmental data | Conditions | Min | Typ | Max | Unit |
|-----------------------------|------------------------------------|--------------|-----|-----|------|
| Shock | 1/2 sine, duration 11ms, in 3 axis | | | 50 | g |
| Vibration | from 10 - 2000 Hz | | | 20 | g |
| Operating temperature | | -40 | | 125 | °C |
| Storage temperature | | -55 | | 125 | °C |
| Soldering Temperature Tsold | Reflow acc.IPC/JEDEC J-STD-020D.1 | | | 255 | °C |
| Washability | | fully sealed | | | |

| General data | Conditions | Min | Typ | Max | Unit |
|--------------|------------|-------------------------|------|-----|------|
| Total weight | | | 0,37 | | g |
| Packaging | | Tape & Reel / 1000 pcs. | | | |

Modifications in the sense of technical progress are reserved

Designed at: 15.09.11 Designed by: WKOVACS

Approval at: 19.09.11 Approval by: CRUF

Last Change at: 25.09.17 Last Change by: WKOVACS

Approval at: 26.10.17 Approval by: DSTASTNY

Version: 04

X-ON Electronics

Largest Supplier of Electrical and Electronic Components

Click to view similar products for [Reed Relays](#) category:

Click to view products by [Standexmeder](#) manufacturer:

Other Similar products are found below :

[M2C24AH](#) [D1A05HD-3](#) [741A10](#) [8000-0211](#) [8000-0217](#) [836C2](#) [922A06C4C](#) [PRMA1A12C](#) [PRMA1A24B](#) [PRMA1A24C](#) [PRMA1B12C](#)
[PRMA1B24C](#) [PRMA1C05F](#) [PRMA2A24C](#) [R1C5DR](#) [R2A5D](#) [1220-0039](#) [RA30521051](#) [RA31232051](#) [HGS1005](#) [HGS1021](#) [HGS1048](#)
[HGS1088](#) [HGS2MT51111F00](#) [HGS2MT51111M00](#) [HGZM1C24](#) [HGZM2C05](#) [HGZM2C48](#) [DA1A24DWD](#) [DA1A-24V](#) [DA1C05FWD](#)
[DA1C12FW](#) [DA2A-6V](#) [134MPCX-3](#) [MRR1ADS8-12D](#) [MRR1ADS8-24D](#) [MRR1ADS8-5D](#) [MRR1ADSK-12D](#) [159-151-T00](#) [MSS62A05](#)
[MSS71A05](#) [MSS71A05B](#) [MSS71A12](#) [MSS71A24](#) [1804-105](#) [191TE1C2M-5S](#) [191TE2A1-5G](#) [191TE2A1-6G](#) [193RE4C3-24G](#) [HYR2001-1520](#)