



All dimensions in mm

- Provides an easy means of exit through a normally locked door
- Touch-free technology
- 12 VDC
- 2 Year limited warranty
- Designed to meet FCC and CE requirements
- Illuminated for easy visual location
- Colour change to indicate activation

## Request to Exit Switch (Illuminated)

Specified for use with all Storm AXS access control systems this touch-free technology 'request to exit' switch allows personnel to leave a secured area by simply waving their hand across an illuminated sensor.

This device is designed to be easily installed to a flush mounted, standard US format, electrical back box.

This REX switch provides a fast and convenient lock release for a defined (timed) duration. The active switch is surrounded by an illuminated annular ring that changes colour when the switch is activated. Intended for location at the secured side of any access controlled door.



### Typical Installation of a Request to Exit Switch

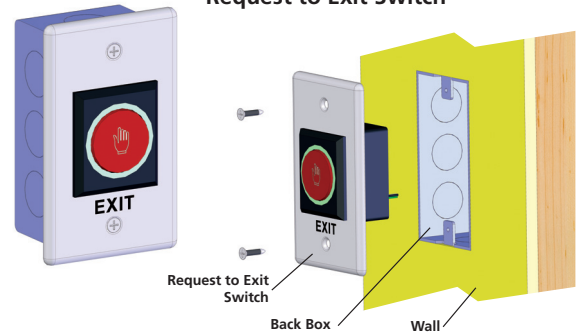

For more information & to order:

[www.storm-interface.com](http://www.storm-interface.com)



Whilst every effort is made to ensure details are correct at time of print, specifications are subject to change without notice.

Designed & produced by NIK Design [nik@nikdesign.co.uk](mailto:nik@nikdesign.co.uk)

Storm Interface products include technology protected by international patents and design registration. All rights reserved.



Storm is a trademark of Keymat Technology Ltd  
Storm Interface is a trading name of Keymat Technology Ltd

DEEX010 July 2014



FM 39602



## X-ON Electronics

Largest Supplier of Electrical and Electronic Components

*Click to view similar products for* [Emergency Stop Switches / E-Stop Switches](#) *category:*

*Click to view products by* [Storm Interface](#) *manufacturer:*

Other Similar products are found below :

[84-6830.0020](#) [AVN302N-R](#) [3050.1302Y](#) [44-710](#) [84-6841.2B20](#) [ZA2BV05](#) [951FY000-WO](#) [ER6022-022N](#) [952+2000-00](#) [ES3S51653001](#)  
[601+0000-OP](#) [E100-A2A22S05A](#) [XCSEA802](#) [XCSB502](#) [2TLA030051R0100](#) [D2D 1009M](#) [D2D 1013H](#) [AZM 170SK-02ZRKA 24VAC/DC](#)  
[84-6820.0020A](#) [84-6820.0040](#) [XY2CH13250H29](#) [XCSDMR590L01M12](#) [XCSTA892](#) [XCSMP80L5](#) [FB1W-HW1B-M220B](#) [FB1W-HW1B-](#)  
[X401R](#) [84-5221.2B20](#) [AZM KEY \(M5\)](#) [AZ 17/170-B15](#) [AZM 161SK-12/12RKA-110/230](#) [AZM 415-11/11ZPK 24VAC/DC](#) [AZM 415-](#)  
[11/11ZPKA 24VAC/DC](#) [AZM 161-B1S](#) [AZ 15/16-B1-2245](#) [AZ 17/170-B11](#) [AZ 17-11ZI B5](#) [BNS 40S-12Z 10,0M](#) [AZ 16-02ZVRK-ST](#)  
[AZ/AZM 415-B2](#) [AZ/AZM 415-B3](#) [MZM 100-B1.1](#) [A-K8P-M12-S-G-5M-BK-2-X-A-4-69](#) [A-K8P-M12-S-G-10M-BK-2-X-A-4-69](#) [A-K5P-](#)  
[M12-S-G-10M-BK-2-X-A-4-69](#) [A-K4P-M12-S-G-2M-BK-2-X-A-4-69](#) [AZ/AZM201-B30-RTAG1P1-SZ](#) [SK-BETÄTIGER M3](#) [SK-BET.M4](#)  
[KPL. M.KAP.](#) [BETÄTIGER A1 KPL.](#) [SKT-U1Z M3](#)