



X.XXX	±1°	X.XX°	±1°
X.XX	±2°	X.X°	±2°
X.X	±3°	X.°	±3°

SIZE	A4
UNIT	mm

SCALE	1:1
DATE	2018.03.29
DATE	2018.03.29
DATE	2018.03.29

APPROVE:	Ady Zhou
CHECK:	Xie Yong
ORIGINAL DRAWN:	Xu Peiguang

REV.	2
SHEET	1/2

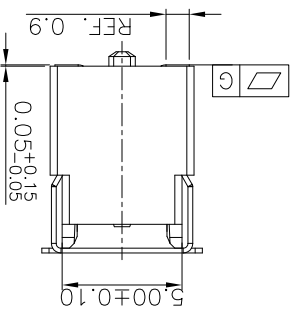
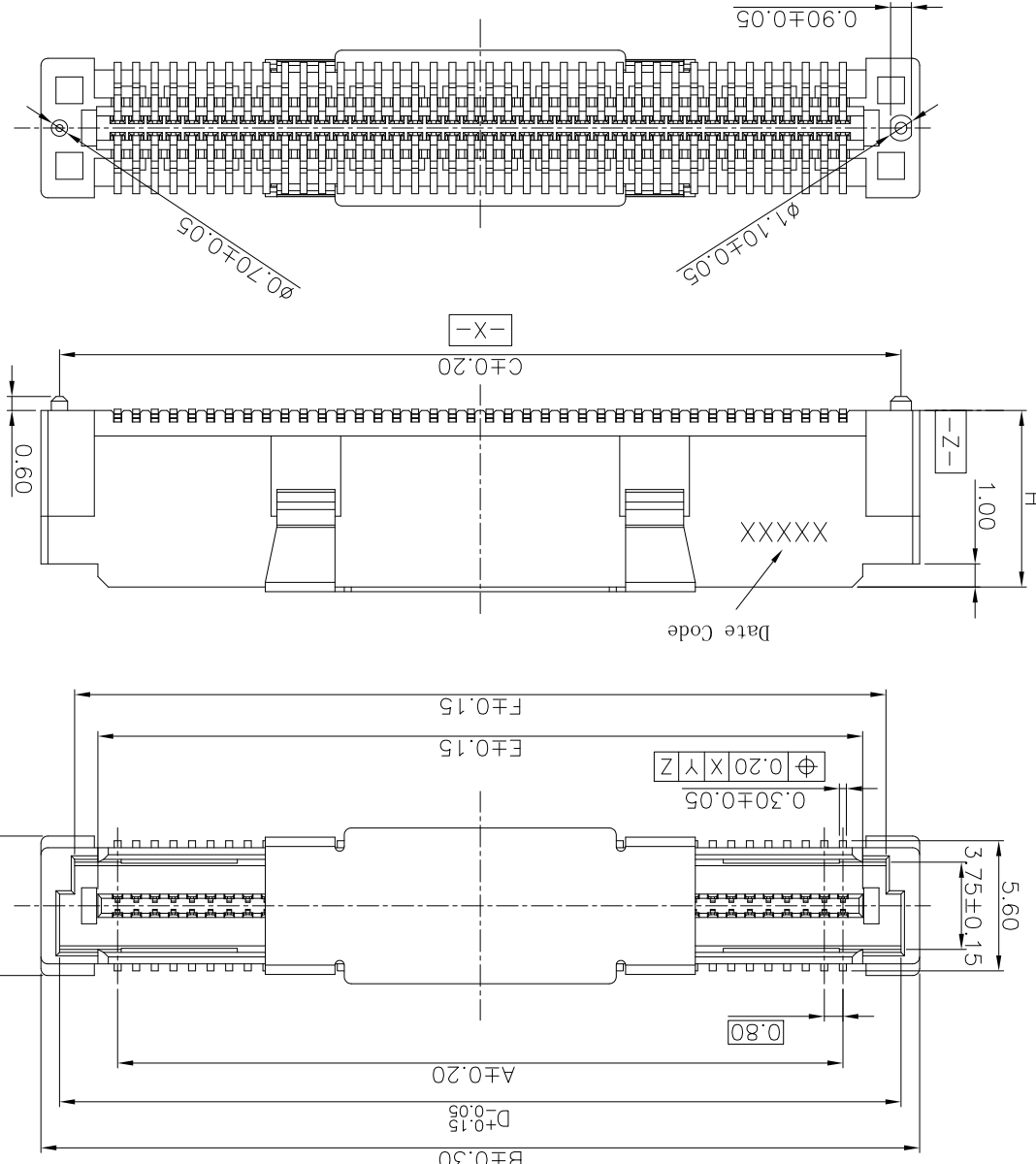

NOTES: (UNLESS OTHERWISE SPECIFIED)  
 1. DIMENSION SHALL BE INTERPRETED PER ANSI Y14.5M-1994.  
 2. MATERIAL:  
 HOUSING MATERIAL: HIGH TEMPERATURE PLASTICS.  
 CONTACT MATERIAL: COPPER ALLOY,  
 VACUUM COVER MATERIAL: STAINLESS STEEL.  
 ELECTRICAL SPECIFICATION:  
 CONTACT RESISTANCE: 50 m ohms Max(Initial).  
 INSULATION RESISTANCE: 100M ohms Min.  
 CURRENT RATING: 0.5A.  
 DIELECTRIC WITHSTANDING VOLTAGE: 500V AC rms./minute  
 DURABILITY: 30 CYCLES.  
 INSERTION FORCE: 150gf Max. PER PIN.  
 WITHDRAWAL FORCE: 25gf Min. PER PIN.  
 3. PRODUCT NUMBER MATRIX:  
 B A 4 I-XX X T-X X -X H X  
 RTB  
 Series code  
 0.80 Pitch  
 Plug  
 PIN No.  
 40\*80:40\*80PIN  
 A0:100PIN ; G0:160PIN  
 C0:120PIN ; I0:180PIN  
 E0:140PIN ; K0:200PIN  
 Height  
 A: H=4.60mm  
 B: H=5.60mm  
 C: H=7.60mm  
 Soldering Type  
 T:SMT  
 0:Without Chamfer  
 1:With Chamfer  
 Housing Color  
 Null:Nature  
 B:Black  
 ◎All plated its lead free.

Definition	Code
◎ Matte Tin plated	A
◎ Bright Tin plated	V
◎ Gold plated over all	
Flash B 1u" R 3u" C	
5u" D 10u" E 15u" F	
20u" G 25u" H 30u" J	
◎ Duplex plated	
Flash K 1u" S 3u" L	
5u" M 10u" N 15u" P	
20u" Q 25u" T 30u" U	

REV.	ECN Number	Description	Drawn
1	CS17100003	RELEASE	XPG_2017.10.10
②	E18030025	CHANGE PART NUMBER	XPG_2018.03.29

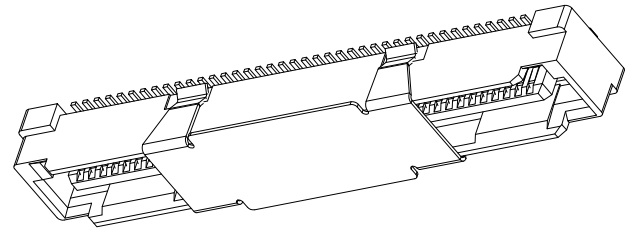



Shenzhen Shentai Weitang Electronics Co., Ltd.

TOLERANCE UNLESS OTHERWISE SPECIFIED

X X ±0.30 X. ° ±3.

X XX ±0.20 X. X° ±2.

X XXX ±1. X. XX° ±1.

SIZE A4

UNIT mm

SCALE 1:1

ORIGINAL DRAWN: Xu Peiguang

CHECK: Xie Yong

APPROVE: Ady Zhou

DATE 2018.03.29

DATE 2018.03.29

DATE 2018.03.29

DWG. NO.

600-0000-0232

TITLE

BA41 CUSTOMER DRAWING

BA41

REV.

2

SHEET

2/2

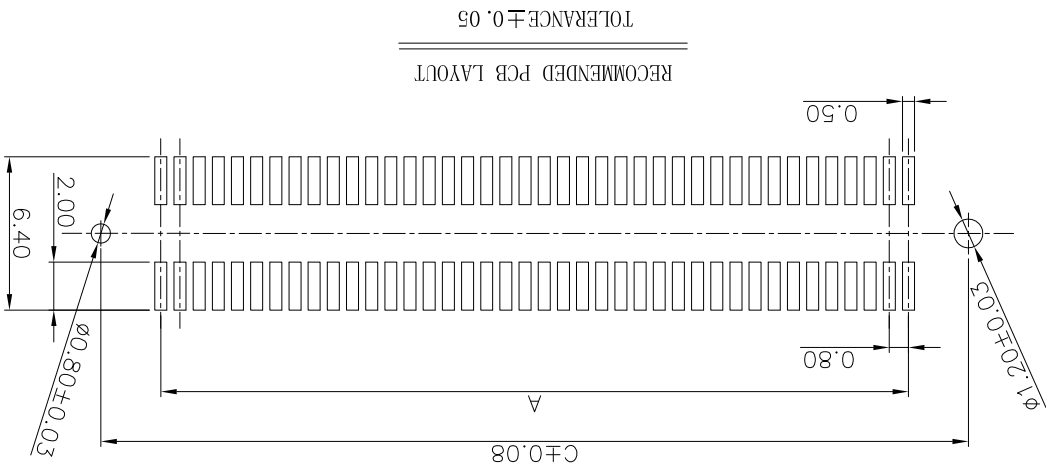

RECOMMENDED PCB LAYOUT  
TOLERANCE ±0.05

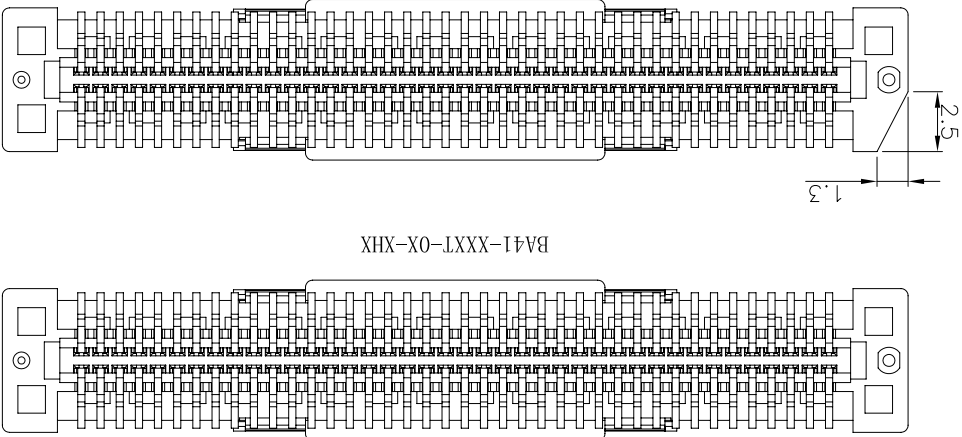

PRODUCT NUMBER MATRIX: BA41-XX X T-X X -X H X  
0: Without Chamfer  
1: With Chamfer

BA41-XXXXT-1X-XHX

BA41-XXXXT-0X-XHX

OLD AND PART NO. COMPARISON	
NEW	OLD
BA41-80CT-1-NHB	AB41-80NB-1-001
BA41-80CT-0-NHB	ZIW-80S6-N-1-B
	AB41-80NB-0-001
BA41-40BT-0-NHB	AB41-80NB-H-001
	ZIW-40S8-VN-1-B
	ZIW-40S8-N-1-B
BA41-60BT-0-NHB	AB41-40NB-H-003
	ZIW-60S8-VN-1-B
	AB41-60NB-0-003
BA41-A0BT-0-NHB	AB41-60NB-H-003
	ZIW-A0S8-VN-1-B
	AB41-A0NB-0-003
BA41-80BT-1-NHB	ZIW-80S8-N-1-B-S01
	AB41-80NB-H-004
BA41-80AT-1-NHB	AB41-80NB-1-004



CT	DIM.A	DIM.B	DIM.C	DIM.D	DIM.E	DIM.F	DIM.G
40	15.20	21.80	20.20	20.20	16.90	18.90	
50	19.20	25.80	24.20	24.20	20.90	22.90	0.10
60	23.20	29.80	28.20	28.20	24.90	26.90	
80	31.20	37.80	36.20	36.20	32.90	34.90	
100	39.20	45.80	44.20	44.20	40.90	42.90	
120	47.20	53.80	52.20	52.20	48.90	50.90	
140	55.20	61.80	60.20	60.20	56.90	58.90	0.12
160	63.20	69.80	68.20	68.20	64.90	66.90	
180	71.20	77.80	76.20	76.20	72.90	74.90	
200	79.20	85.80	84.20	84.20	80.90	82.90	

## X-ON Electronics

Largest Supplier of Electrical and Electronic Components

*Click to view similar products for [Board to Board & Mezzanine Connectors](#) category:*

*Click to view products by [STWXE](#) manufacturer:*

Other Similar products are found below :

[10135583-642402LF](#) [89885-310LF](#) [589158040000018](#) [6-1393048-0](#) [68683-613](#) [MDF7-12DP-2.54DSA](#) [MDF7-18P-2.54DSA\(01\)](#) [MDF7-20DP-2.54DSA](#) [MDF7-26D-2.54DSA\(55\)](#) [MDF7-3P-2.54DSA\(01\)](#) [MDF7B-20P-2.54DSA\(01\)](#) [MDF7B-3P-2.54DSA\(55\)](#) [MDF7C-11P-2.54DSA\(55\)](#) [MDF7C-18P-2.54DSA\(55\)](#) [MDF7C-5P-2.54DSA\(01\)](#) [MDF7P-5P-2.54DSA\(55\)](#) [75234-0516](#) [FCN-230C068-11](#) [FCN-268F012-G/BD](#) [FCN-268F036-G/BD](#) [FCN-268M012-G/0D](#) [FCN-268M024-G/1D](#) [FCN-360C008-C](#) [FCN-360C040-C](#) [FCN-723J004/1](#) [MIS-048-01-F-D-DP-K](#) [832-10-034-10-001000](#) [93696-325LF](#) [11828-1FA](#) [AXK630345P](#) [18097-0013](#) [ICA-328STT](#) [2007042-2](#) [304400-2](#) [FCN-214Q030-G/0](#) [FCN-215Q040-G/0](#) [FCN-230C068-ESA](#) [FCN-234P048-G/0](#) [FCN-235D050-G/C](#) [FCN-360A3](#) [FCN-360C040-B](#) [210-93-314-41-105000](#) [2-22603-0](#) [379-064-521-202](#) [MDF7-12P-2.54DSA\(01\)](#) [MDF7-16P-2.54DS\(56\)](#) [MDF7-40DP-2.54DSA\(55\)](#) [MDF7-8P-2.54DSA\(55\)](#) [MDF7B-16P-2.54DSA\(55\)](#) [AXG720047](#)