

REV.	ECN Number	Description	Drawn
1	CS18030038	RELEASE	XPG_2018.03.20

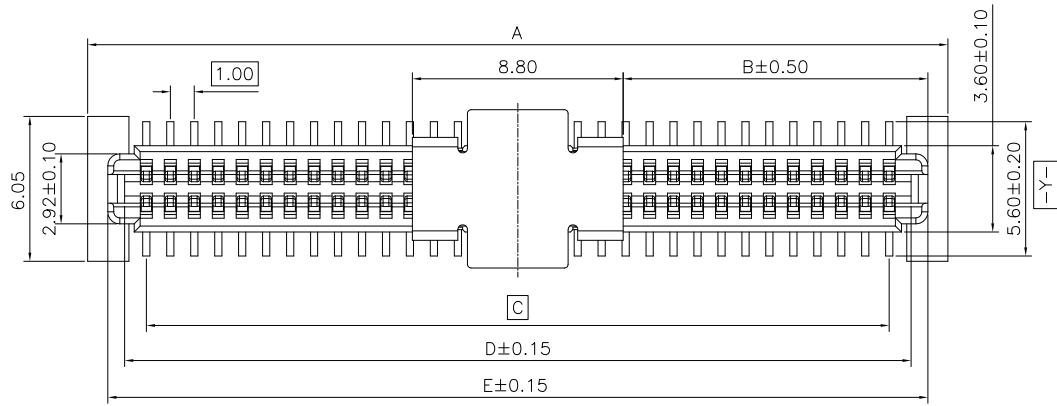

NOTES: (UNLESS OTHERWISE SPECIFIED)

- DIMENSION SHALL BE INTERPRETED PER ANSI Y14.5M-1994
- MATERIAL:
HOUSING: LCP, UL 94V-0.
CONTACT: PHOSPHOR BRONZE, T=0.20mm
VACUUM COVER: STAINLESS STEEL, T=0.20mm
- ELECTRICAL SPECIFICATION:
CONTACT RESISTANCE: 30 m ohms Max Initail.
INSULATION RESISTANCE: 1000M ohms Min.
OPERATION VOLTAGE: 100V AC/DC
CURRENT RATING: 1.0A
DIELECTRIC WITHSTANDING VOLTAGE: 250V AC
- MECHANICAL SPECIFICATION:
CONTACT RETENTION FORCE: 250gf Min.
INSERTION FORCE: 120gf Max. Per Pin.
WITHDRAWAL FORCE: 10gf Min. Per Pin.
- OPERATING TEMPERATURE: -55° C To +85° C
- PRODUCT NUMBER MATRIX:

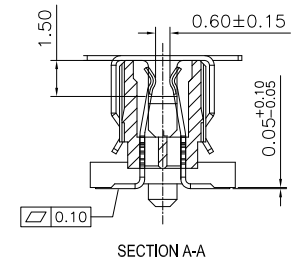
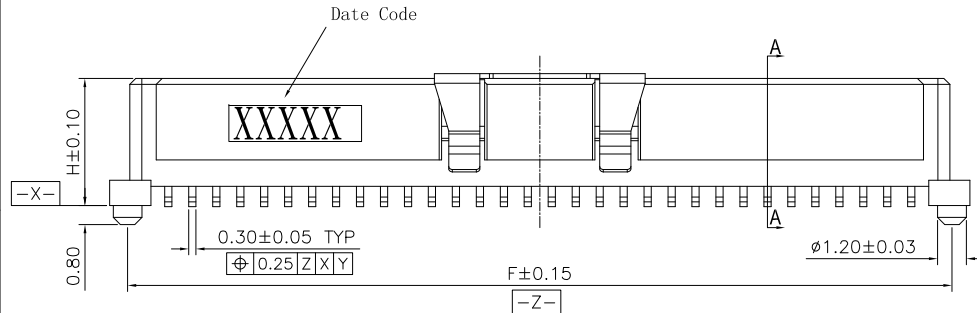

BTB
Series code
1.00 Pitch
Receptacle
PIN No.
64:64PIN
Height
Soldering Type
T:SMT

BA 5 2-64 A T- 3 - U H B

Packing:
B: REEL+MPAD
H: Halogen free
Plating
U: 30u" gold on contact area, matte Tin on solder area
3: With Locating peg

B: H=7.30mm

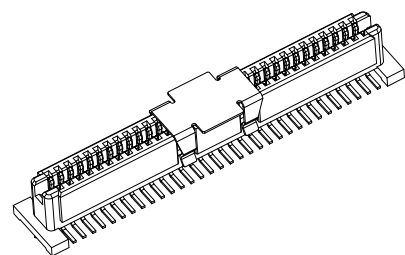
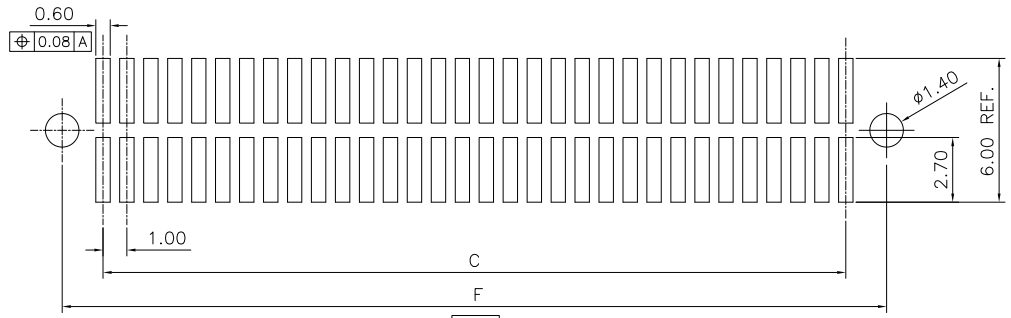

RECOMMENDED PCB LAYOUT
TOLERANCE ±0.05

OLD AND NEW PART NO. COMPARISON						
OLD			NEW			
AB52-64UB-H-002			BA52-64BT-3-UHB			

CKT	DIM A	DIM B	DIM C	DIM D	DIM E	DIM F
64	35.90	12.71	31.00	32.82	34.22	34.40

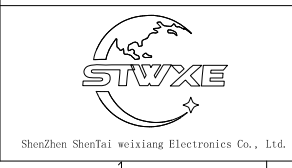

TOLERANCE UNLESS OTHERWISE SPECIFIED			
X.X	±0.30	X.°	±3°
X.XX	±0.20	X.X°	±2°
X.XXX		X.XX°	±1°

SCALE	1:1
UNIT	mm
SIZE	A4

ORIGINAL DRAWN:
Xu peiguang

CHECK:
Xie Yong

APPROVE:
Ady zhou

DATE
2018.03.20

DATE
2018.03.20

DATE
2018.03.20

DWG. NO.
600-0000-0354

PARTS NO. (INTENDED USE)
BA52-64BT-3-UHB

TITLE
BA52
CUSTOMER DRAWING

REV.
1

SHEET
1/1

X-ON Electronics

Largest Supplier of Electrical and Electronic Components

Click to view similar products for [Headers & Wire Housings](#) category:

Click to view products by [STWXE](#) manufacturer:

Other Similar products are found below :

[95000-104TRLF](#) [10135584-644402LF](#) [DF62W-EP2022PCA](#) [95000-106TRLF](#) [DF62W-2022SCA](#) [DF62W-EP2022PC](#) [2203348](#) [DF62W-2022SC](#) [1084018](#) [1029039](#) [1084017](#) [802-10-012-10-002000](#) [1112640](#) [1112639](#) [891-007-9SS-BST1T](#) [000-34000](#) [0008550134](#) [0009482033](#) [0009507031](#) [57102-F02-18ULF](#) [57102-S06-03LF](#) [57202-S52-04LF](#) [PCN6-15S-2.5E](#) [0039019024](#) [58102-G61-06LF](#) [582553-1](#) [0009485154](#) [0009508121](#) [0022285053](#) [0050291907](#) [018731A](#) [LY20-4P-DT1-P1E-BR](#) [02.125.8002.8](#) [60101931](#) [60598-1 \(Cut Strip\)](#) [M1625-3R/100](#) [61062-3](#) [61082-181009](#) [CSU011177004](#) [636-1427](#) [638009-1](#) [641938-9](#) [641991-4](#) [644168-1](#) [644827-2](#) [647662-1](#) [65039-019ELF](#) [65692-001LF](#) [65781-018](#) [65781-047](#)