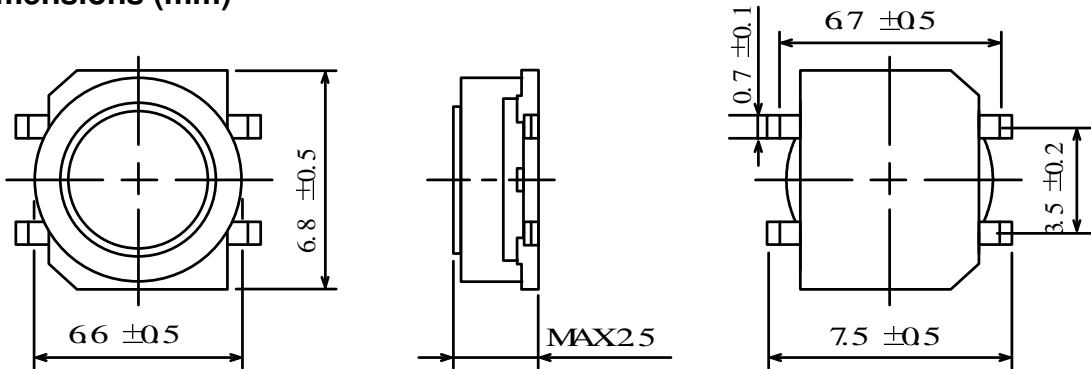
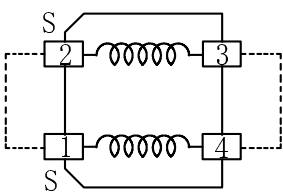
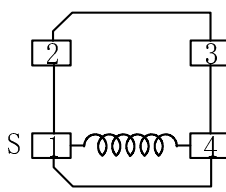

Type: CLS62
◆ Product Description

- 7.3×7.1mm Max.(L×W), 2.5mm Max. Height.
- Inductance Range: 10 μ H~39mH, Rated current range: 37mA~700mA
- In addition to the typical versions of parameters shown here, custom designs are available to meet your exact requirements.

◆ Feature

- Magnetically shielded construction.
- Ideally used in power supply of DSC, DVC, Note PC .
- RoHS Compliance

◆ Dimensions (mm)

◆ Schematics (Bottom)

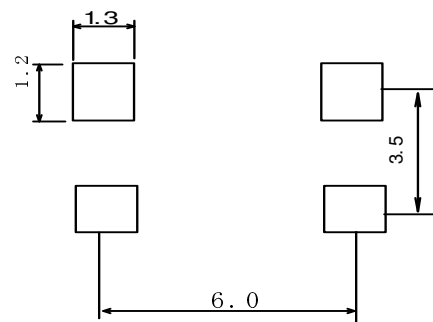
 $10 \mu \text{ H} \sim 22 \mu \text{ H}$
 $270 \mu \text{ H} \sim 390 \mu \text{ H}$

 $27 \mu \text{ H} \sim 220 \mu \text{ H}$
 $470 \mu \text{ H} \sim 3.9\text{mH}$

“ S ” indicates winding start.

◆ Land Pattern (mm)

X-ON Electronics

Largest Supplier of Electrical and Electronic Components

Click to view similar products for [Fixed Inductors](#) category:

Click to view products by [Sumida](#) manufacturer:

Other Similar products are found below :

[CR43NP-680KC](#) [CR54NP-820KC](#) [CR54NP-8R5MC](#) [CTX32CT-100](#) [70F224AI](#) [MGDQ4-00004-P](#) [MHL1ECTTP18NJ](#) [MHL1JCTTD12NJ](#)
[PE-51506NL](#) [PE-53601NL](#) [PE-53602NL](#) [PE-53630NL](#) [PE-53824SNLT](#) [PE-62892NL](#) [PE-92100NL](#) [PG0434.801NLT](#) [PG0936.113NLT](#)
[9310-16](#) [PM06-2N7](#) [PM06-39NJ](#) [A01TK](#) [1206CS-471XJ](#) [HC2-2R2TR](#) [HC2LP-R47-R](#) [HC3-2R2-R](#) [1206CS-151XG](#) [RCH664NP-140L](#)
[RCH664NP-4R7M](#) [RCH8011NP-221L](#) [RCP1317NP-332L](#) [RCP1317NP-391L](#) [RCR1010NP-470M](#) [RCR110DNP-331L](#) [DH2280-4R7M](#)
[DS1608C-106](#) [ASPI-4020HI-R10M-T](#) [B10TJ](#) [B82477P4333M](#) [B82498B3101J000](#) [B82498B3680J000](#) [ELJ-RE27NJF2](#) [1812CS-153XJ](#)
[1812CS-183XJ](#) [1812CS-223XJ](#) [1812LS-104XJ](#) [1812LS-105XJ](#) [1812LS-124XJ](#) [1812LS-154XJ](#) [1812LS-223XJ](#) [1812LS-224XJ](#)