

Country	Jurisdiction & Control List
FR	NOT LISTED

	critical dimension
	major dimension

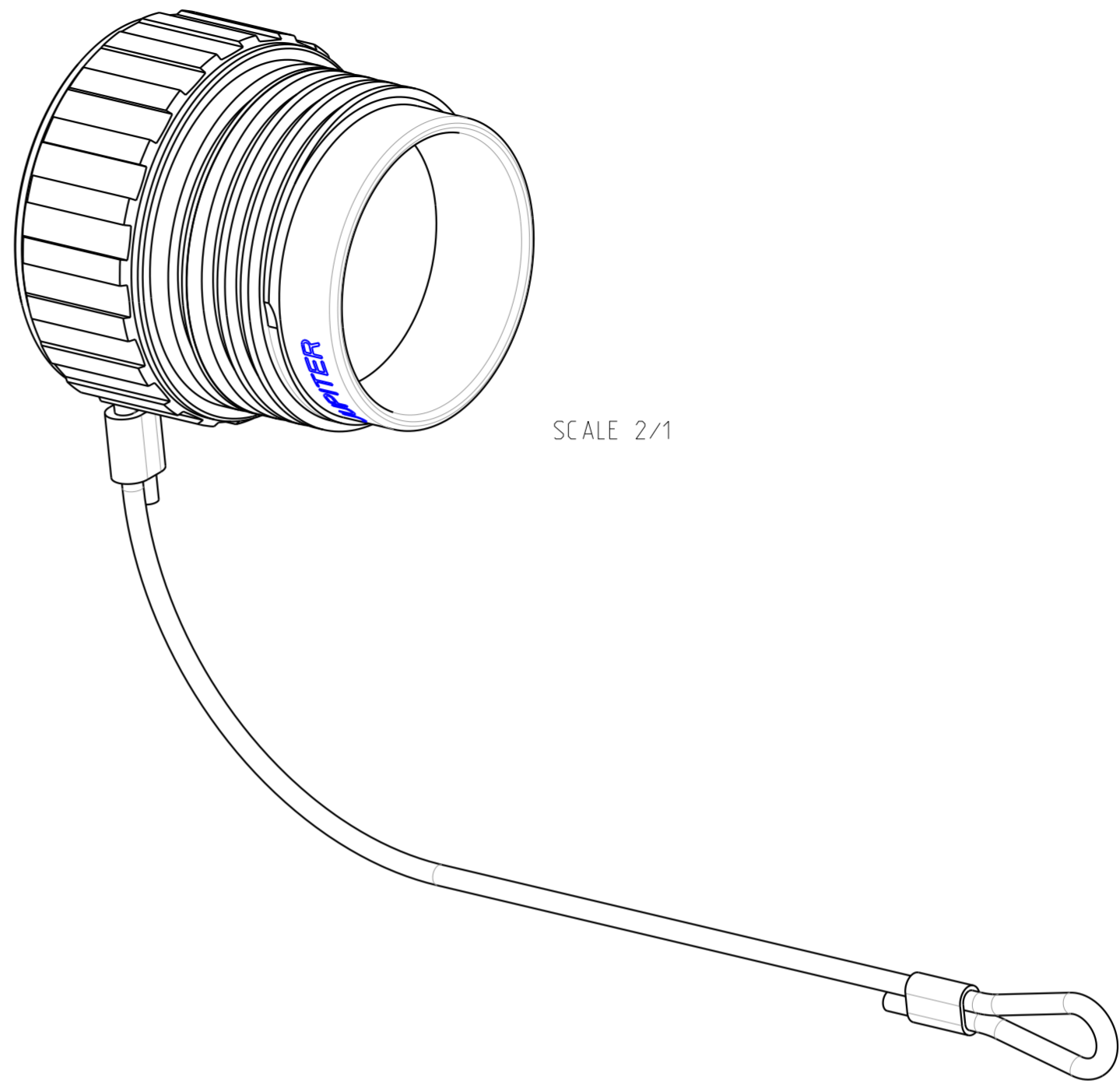
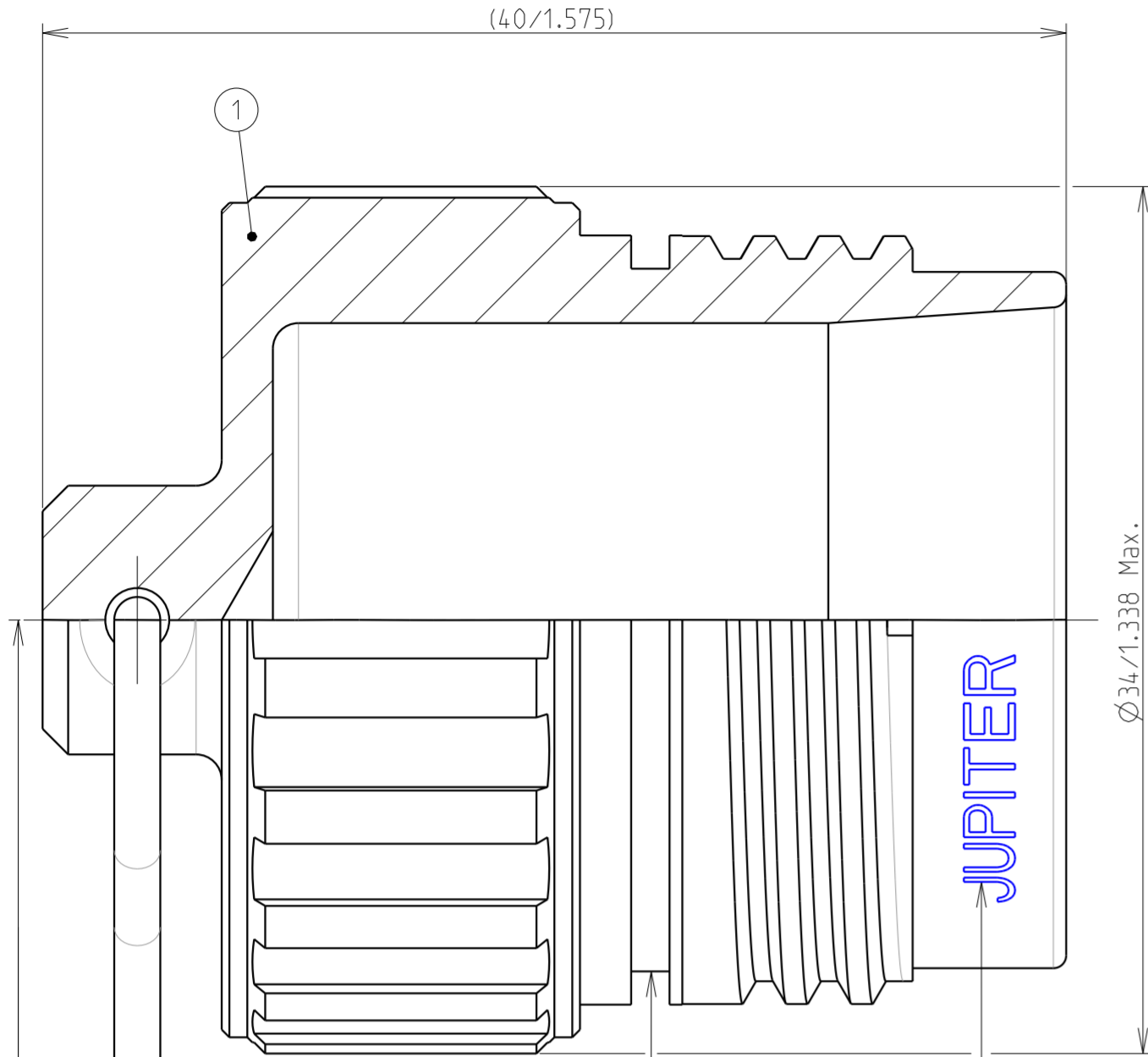

Bande témoin d'accouplement
Mating witness marking

MARQUAGE/MARKING

**** JUPITER FR BEF14PLY
 SEMAINE/WEEK
 ANNEE/YEAR

REFERENCE COMMERCIALE PART NUMBER	
BEF14PLY	(Sans cordelette / Without fixing rope)
BEFC14PLY	(Avec cordelette / With fixing rope)

4	COLLIER / COLLAR
3	MANCHON / SLEEVE
2	CORDELETTE / FIXING ROPE
1	BOUCHON DE FICHE / PLUG CAP
REP	DESIGNATION

N1 : UNIQUEMENT POUR LA REFERENCE BEFC14PLY
 ONLY FOR PART NUMBER BEFC14PLY

B	22/06/18	Modification référence commerciale			SYakoubi	MEFFRE	DE2018-0140
A	21/09/16	Initial drawing			ORAIN	MEFFRE	DIFF
Iss	Date	MODIFICATIONS	A	C	Designed by	Checked by	MOD N°
			Naf.				

MATERIAL --	TREATMENT	PROTECTION/PLATING
--	--	--
--	--	CODE --

DIMENSIONS ARE DEFINED BEFORE PLATING		
TITLE	BOUCHON DE FICHE (BEF) / PLUG CAP (BEF) SERIE PL - TAILLE 14	PROJECT PL54

Material Reference Voir Référence Commerciale / See Part Number		SOURIAU	
Generales tolerances ISO 2768		3. RUE DU VALLON ZAC N°2 94440 MAROLLES-EN-BRIE (FRANCE) TEL. 33 (0)1 45 10 78 00	
Scale 4/1	General machining Surface texture	SOURIAU	
Geometrical Tolerances: NF EN ISO 1101		FORMAT A2	SOURIAU DRG N° 543B1030B9C
This document is the property of SOURIAU it must not be reproduced or communicated without permission.		Iss B	SHEET 1/1

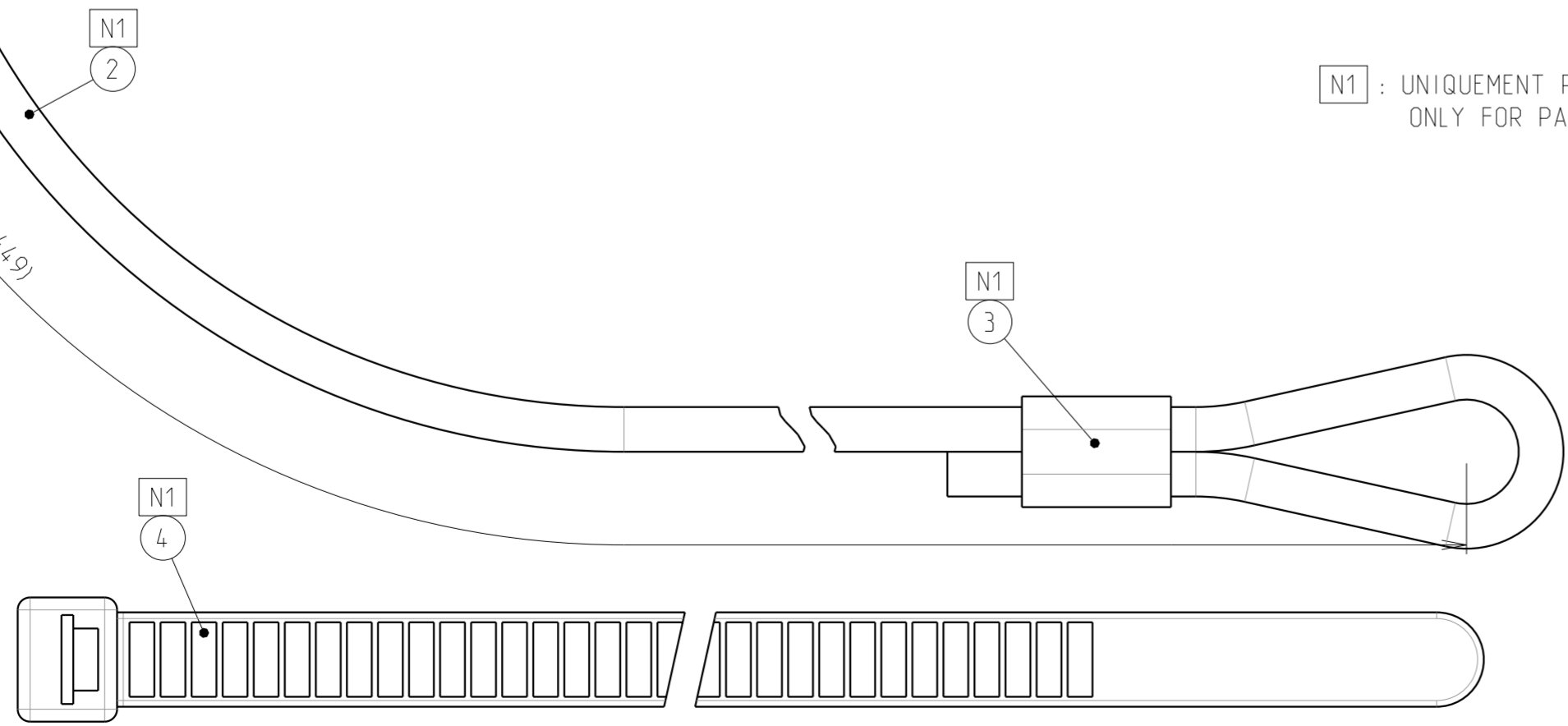

X-ON Electronics

Largest Supplier of Electrical and Electronic Components

Click to view similar products for [Standard Circular Connector](#) category:

Click to view products by [Sunbank](#) manufacturer:

Other Similar products are found below :

[5M2530B10P](#) [600259N006](#) [600273N007](#) [6134-336-13149](#) [6134-337-11149](#) [6134-337-2390](#) [6134-341-17149](#) [6280-4SG-516](#) [6280-7SG-3DC](#)
[6290](#) [6291A](#) [66200A-10](#) [680-SMG](#) [681-PMG](#) [CXS3102A14S2P](#) [CXS3102A181S](#) [7271-6SG-300](#) [7282-3PG-300-CH3](#) [75-474014-05S](#) [75-](#)
[474618-01S](#) [75-474618-04P](#) [75-474618-04S](#) [799539-000](#) [MI8-SE](#) [805-005-07NF11-19PC](#) [805-005-07NF15-7PA](#) [8280-4PG-516](#) [8280-7PG-](#)
[519](#) [8282-5PG-519](#) [836783-1](#) [MP-4102-25P-C](#) [862256-1](#) [864019-2](#) [866857-1](#) [867865-1](#) [PT01SP-14-18P](#) [PT08P-14-5S](#) [120-1833-000](#)
[QCM019PC2DC012B](#) [1-2069279-1](#) [121583-0217](#) [121667-0020](#) [129591AU](#) [1000B BULK](#) [RD10A16-19-P6CS051/1](#) [RD10A20-31-](#)
[P8CS051/1](#) [RD16A14-12-S6CS051/2](#) [1301240290](#) [1301240347](#) [1301860202](#) [1301240268](#)