

② ④  
┌ .101 ± .003 DIA.

└ .070 ± .003 DIA.

②  
└ .470

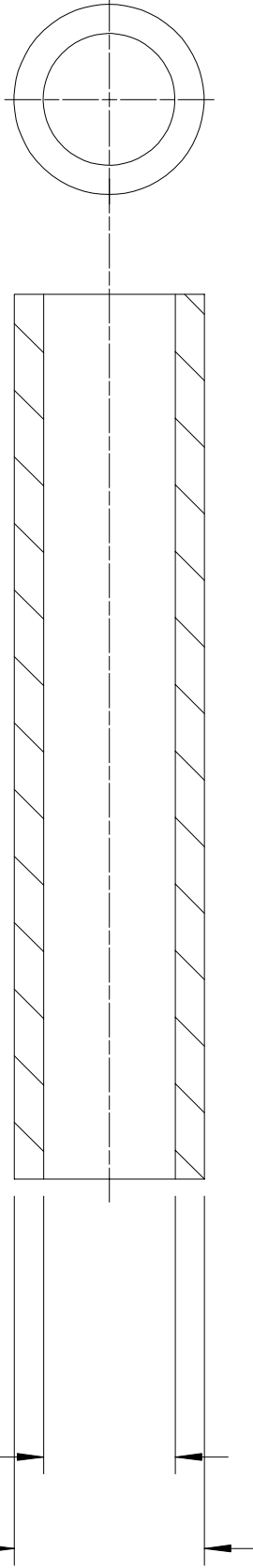

MATERIAL: POLYETHYLENE  
COLOR NATURAL ③

REFERENCES: SD51447

REV	DESCRIPTION	BY DATE	CHKD DATE	SHEET NO.	ZONE
4	ADDED ±.003 TO DIM.101 & .070, ALSO REDREW ON CAD PER ECN4322.	SAF 3-15-99	DAF	SHEET NO.	ZONE
3	COLOR NATURAL ADDED (DC 5790)	KT 6-23-69	JPS	SHEET NO.	ZONE
2	.47 WAS .41, .101 WAS .104 (EC 36838)	JIS 1-7-69	SFP	SHEET NO.	ZONE
1	.104 WAS .102, .070 WAS .067 (EC 26307)	TMM 8-14-62	TJM	SHEET NO.	ZONE

REVISION

SUPPORTING SLEEVE

FMSC NO. 09922

CAT NO. RCMXB-067

LINEAR MEASURE	INCH [mm]
THIRD ANGLE PROJECTION	
TOLERANCES UNLESS OTHERWISE SPECIFIED	
NO. OF PLACES	INCH [mm]
ONE PLACE	±.1 [±3]
TWO PLACES	±.02 [±0.5]
THREE PLACES	±.005 [±0.13]
ANGLES ±1°	

DWG RELEASED TO CENTRAL FILE:

CAGE NO: DON: XXXX PC: 831 SIZE: A

FCI Electronics Systems Division

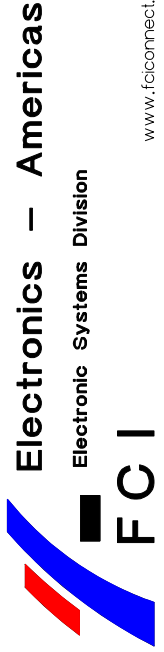

www.fcicomnect.com

APPROVAL	DRAWN: WWT 04-27-62
	CHKD: AR 05-11-62
	DSGN: AEM 05-16-62
	MFG: XXX XX-XX-XX
	QC: XXX XX-XX-XX
	DRAWING SCALE: 10 : 1
	DRAWING NO. REV
	SA51449 4
	SHEET 1 OF 1

## X-ON Electronics

Largest Supplier of Electrical and Electronic Components

*Click to view similar products for [Standard Circular Contacts](#) category:*

*Click to view products by [Sunbank](#) manufacturer:*

Other Similar products are found below :

[RC16M23J](#) [133780-1](#) [RM20M13D28](#) [RM24M9D28](#) [RMMX110-1D28](#) [MS3474W10-6P L/C](#) [ELVP16100E](#) [164-901-CD](#) [EN3545007SCE](#)  
[BV002BSQ20049CZ](#) [BV002SSQ160404CZ](#) [1900ND05S1B00B](#) [SJS862201](#) [166566-1](#) [1900ND04S1X00D](#) [ST-JL05-16S-C3-100](#) [ST-JL05-20S-C1-100](#) [ST-JL05-20S-C2-100](#) [T01-CRIMP-S03](#) [APK-SA16A07-002](#) [27963-15T12](#) [CONT-JL05-08S-C2-10](#) [CONT-JL05-12S-C1-10](#)  
[RC16M-23T](#) [RFD26L-1D28](#) [BV002ASJ16049CW](#) [JN1-22-20S-R-PKG100](#) [031-50213](#) [031-50565](#) [031-50794](#) [SJS861301M](#) [ST-JL05-16S-C1-100](#) [ST-JL05-20P-C1-100](#) [82911466K](#) [82911467NK](#) [192991-0087](#) [192900-0570](#) [T3P16FC3LZ](#) [ST-JL05-16S-C2-3500](#) [ZP-4016-10NF](#)  
[CONT-JL05-12P-C1-10](#) [RM20M12G8D28](#) [031-50676](#) [12115010110](#) [RJFTVC2MG](#) [CAP-DACMDPC2](#) [031-50675-002](#) [CAP-DD1FDPC2](#)  
[CAP-DACMDPC1](#) [031-50966-010](#)