

DWG. NO. SD44088

ASSEMBLY COMPONENTS FOR OUTER CONTACTS

- NOTES:
- FOR PLATING TYPES, REFER TO INDIVIDUAL SALES DRAWINGS AS LISTED.
  - FOR COMMONING BLOCK APPLICATIONS, THE YOC110L-6 REPLACES THE YOC110. (SC49453). FOR DIRECTION OF BLUE MARKING SEE SHEET 2 (VIEW 2)
  - THE CONTACTS LISTED ARE RECOMMENDED FOR USE WITH THE FOLLOWING SOURIAU CONNECTORS:

ME6MX13 P/R	RSMX110-2
ME12MX P/R	RSMX110-3
MD12MX P/R	RSMX110-1
MC8MX13 P/R	M18TBX
PD21MX P/R	M22T10X
RSCMX110-2	MA28C19
RSCMX110-3	MA28C96

REFERENCE:

SC48873-RMMX110-1  
 SC48870-RCMX110-1  
 DS101  
 DS104  
 DS110  
 SC49453-YOC126L-6

WEIGHT TABLE	
PART NO.	APPROXIMATE WEIGHT IN GRAMS
RMMX110-1	1.2
RCMX110-1	1.4
RMM26W-1	.13
YORX110-2	.11
RFM26W-1	.15
RMM22W-1	.13
RFM22W-1	.15
YOC 110	.02
RCMXB-053	.03
RCMXB-067	.03
RMM20W-1	.12
RFM20W-1	.14
YORX110-2P1	.40

RECOMMENDATION NUMBER	CABLE TYPE	INNER COND. SIZE			INNER CONDUCTOR CONTACTS				OUTER CONDUCTOR (BRAID) CONTACTS				ASSEMBLY COMPONENTS FOR OUTER CONTACTS		ASSEMBLY PROCEDURE SHEET NO.
		DIA OVER JACKET	DIA OVER DIELEC.	INNER COND SIZE	INNER PIN		INNER SOCKET		OUTER PIN		OUTER SOCKET		RCMXB	YOC	
					CATALOG NO.	TOOL INDEX NUMBER	CATALOG NO.	TOOL INDEX NUMBER	CATALOG NO.	TOOL INDEX NUMBER	CATALOG NO.	TOOL INDEX NUMBER			
DRAWING NO.	DRAWING NO.	DRAWING NO.	DRAWING NO.	DRAWING NO.	DRAWING NO.	DRAWING NO.	DRAWING NO.	DRAWING NO.	DRAWING NO.	DRAWING NO.	DRAWING NO.	DRAWING NO.	DRAWING NO.		
1	#24 SHIELDED PHILCO TYPE SC-12	.108 MAX.	.046	7/32	RMM22W-1___ SC48876	CT-442	RFM22W-1___ SC48877	CT-441	RMMX110-1___ SC48873	CT-423	RCMX110-1___ SC48870	CT-425	YORX110-2 SA46549	RCMXB053 SA46546	5
2	SURPRENANT *9872	.140	.100	7/.0056	RMM26W-1___ SC48876	CT-440	RFM26W-1___ SC48877	CT-439	RMMX110-1___ SC48873	CT-422	RCMX110-1___ SC48870	CT-424	YOC 110 SA25594		2
3	SURPRENANT *4029	.136	.092	#29 SOLID	RMM26W-1___ SC48876	CT-440	RFM26W-1___ SC48877	CT-439	RMMX110-1___ SC48873	CT-422	RCMX110-1___ SC48870	CT-424	YOC 110 SA25594		2
4	RG161/U	.090	.057	7/38	RMM26W-1___ SC48876	CT-440	RFM26W-1___ SC48877	CT-439	RMMX143-1___ SC48875	CT-444	RCMX143-1___ SC48872	CT-443	YIRX069 SC43377		3
5	RG174/U	.100	.060	7/34	RMM26W-1___ SC48876	CT-440	RFM26W-1___ SC48877	CT-439	RMMX110-1___ SC48873	CT-446	RCMX110-1___ SC48870	CT-445	YORX110-2 SA46549		6
6	RG187/U	.110 MAX.	.060	7/.004	RMM26W-1___ SC48876	CT-440	RFM26W-1___ SC48877	CT-439	RMMX110-1___ SC48873	CT-446	RCMX110-1___ SC48870	CT-445	YORX110-2 SA46549		6
7	RG188/U	.110 MAX.	.060	7/.0067	RMM26W-1___ SC48876	CT-440	RFM26W-1___ SC48877	CT-440	RMMX110-1___ SC48873	CT-696	RCMX110-1___ SC48870	CT-697	YORX110-2 SA46549 RCMXB-067 SA51449		4
8	RG195/U	.155 MAX.	.102	7/.004	RMM26W-1___ SC48876	CT-440	RFM26W-1___ SC48877	CT-439	RMMX110-1___ SC48873	CT-422	RCMX110-1___ SC48870	CT-424	YOC 110 SA25594		2
9	AMPHENOL #21-597	.150	.100	7/.0056	RMM26W-1___ SC48876	CT-440	RFM26W-1___ SC48877	CT-439	RMMX110-1___ SC48873	CT-422	RCMX110-1___ SC48870	CT-424	YOC 110 SA25594		2
10	AMPHENOL #21-598	.105	.060	7/.0063	RMM26W-1___ SC48876	CT-440	RFM26W-1___ SC48877	CT-439	RMMX110-1___ SC48873	CT-446	RCMX110-1___ SC48870	CT-445	YORX110-1 SA46549		6
11	MICRODOT #93-3902	-	-	-	RMM26W-1___ SC48876	CT-440	RFM26W-1___ SC48877	CT-439	RMMX110-1___ SC48873	CT-422	RCMX110-1___ SC48870	CT-424	YOC 110 SA25594		2
12	TWISTED PAIR #24AWG PER MIL-W-16878C TYPE B	-	.046	7/.008	RMM22W-1___ SC48876	CT-442	RFM22W-1___ SC48877	CT-441	RMMX110-1___ SC48873	CT-423	RCMX110-1___ SC48870	CT-425	YORX110-2 SA46549 RCMXB-053 SA46546		5
13	RESISTOR-CAPACITOR TERMINATION	-	-	.032	RMM20W-1___ SC48876	CT-448	RFM20W-1___ SC48877	CT-447	RMMX110-1___ SC48873	CT-582	RCMX110-1___ SC48870	CT-583	YOC 110 SA25594 RCMXB-053 SA46546		7
14	RG180B/U	.145 MAX.	.102	7/.004	RMM26W-1___ SC48876	CT-440	RFM26W-1___ SC48877	CT-439	RMMX110-1___ SC48873	CT-422	RCMX110-1___ SC48870	CT-424	YOC 110 SA25594		2
17	MICRO DOT # 93-3913	.132	.090	#.29 SOLID	RMM26W-1___ SC48876	CT-440	RFM26W-1___ SC48877	CT-439	RMMX110-1___ SC48873	CT-422	RCMX110-1___ SC48870	CT-424	YOC 110 SA25594		2
18	RG 196/U SEE SHEET 4	.080	.034	7/.004	RMM26W-1___ SC48876	CT-440	RFM26W-1___ SC48877	CT-439	RMMX110-1___ SC48873	CT-423	RCMX110-1___ SC48870	CT-425	YORX110-2 SA46549 RCMXB053 SA46546		4
19	RG 180/U	.141	.103	7/.0039	RMM26W-1___ SC48876	CT-440	RFM26W-1___ SC48877	CT-439	RMMX110-1___ SC48873	CT-422	RCMX110-1___ SC48870	CT-424	YOC 110 SA25594		2
20	RG 180A/U	.145	.102	7/.004	RMM26W-1___ SC48876	CT-440	RFM26W-1___ SC48877	CT-439	RMMX110-1___ SC48873	CT-422	RCMX110-1___ SC48870	CT-424	YOC 110 SA25594		2
21	22 TWISTED PAIR (7) STR. PER 18M DWG #5284583	-	.058	7/.010	RMM22W-1___ SC48876	CT-442	RFM22W-1___ SC48877	CT-441	RMMX110-1___ SC48873	CT-423	RCMX110-1___ SC48870	CT-425	YORX110-2 SA46549 RCMXB-067 SA51449		5
22	#22 SHIELDED MIL-W-16878 TYPE "B" (19STR)	.110	.052	19/.0063	RMM20W-1___ SC48876	CT-448	RFM20W-1___ SC48877	CT-447	RMMX110-1___ SC48873	CT-426	RCMX110-1___ SC48870	CT-445	YORX110-2P1 SA49289		6

LINEAR MEASURE:  $\frac{INCH}{mm}$

THIRD ANGLE PROJECTION

TOLERANCES UNLESS OTHERWISE SPECIFIED

No. OF PLACES	INCH [mm]
ONE PLACE	$\pm .1 [\pm 3]$
TWO PLACES	$\pm .02 [\pm 0.5]$
THREE PLACES	$\pm .010 [\pm 0.25]$

ANGLES  $\pm 1^\circ$

DRAWING TITLE: **ASSY. PROCEDURE FOR MINIATURE COAX HYFEN**

CAT NO. **RCMX \_\_\_ & RMMX \_\_\_**

CAGE NO: 09922 SIZE: C

**CUSTOMER**

**SOURIAU**

WWW.SOURIAU.COM

INTERPRET THIS DRAWING IN ACCORDANCE WITH ASME Y14.5M - 1994.

AD	REVISED PER ECN 12048	SKV	TW
REV	DESCRIPTION	BY	CHKD
		DATE	DATE

APPROVAL

DRAWN: SKV	08-16-13
CHKD: TW	08-06-13
DSGN: XXX	XX-XX-XX
MFG: DH	08-06-13
QC: BB	08-06-13

DRAWING SCALE: 5:1

DRAWING NO. **SD44088** REV **AD**

1 OF 7

THIS DRAWING IS A CONTROLLED DOCUMENT FOR SOURIAU USA, INC. IT IS SUBJECT TO CHANGE WITHOUT NOTICE. CONTACT THE DOCUMENT CONTROL CENTER FOR THE LATEST REVISION.

D

C

B

A

THIS DRAWING IS A CONTROLLED DOCUMENT FOR SOURIAU USA, INC. IT IS SUBJECT TO CHANGE WITHOUT NOTIFICATION. CONTACT THE DOCUMENT CONTROL CENTER FOR THE LATEST REVISION.

1

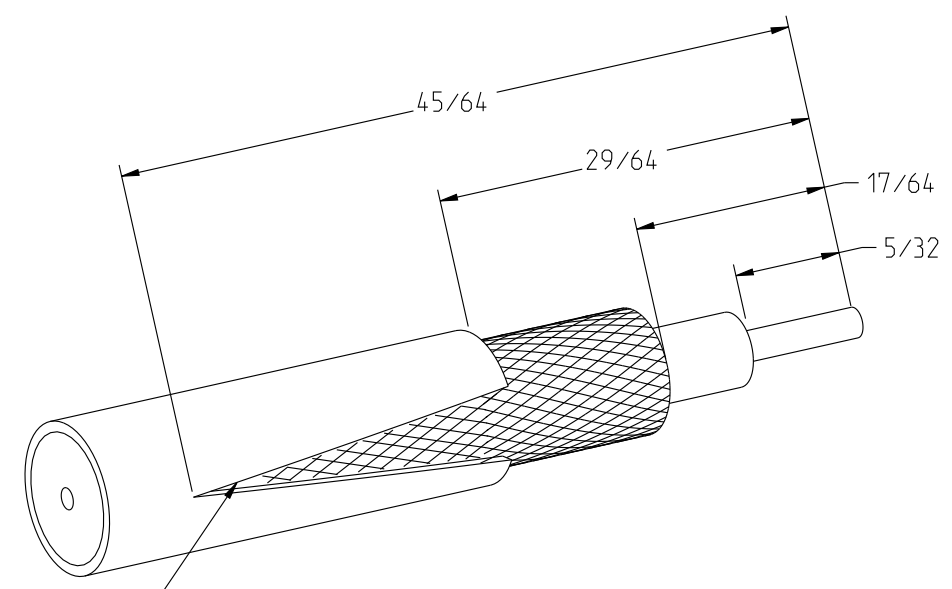

SLIT TO BE MADE ONLY WHEN JACKET MATERIAL IS NOT ELASTIC

STRIP COAXIAL CABLE TO DIMENSIONS SHOWN (DIMENSION MAY BE ALTERED TO SUIT CHARACTERISTICS OF CABLE)

2

WHEN THE YOC110L-6 IS USED IN A MINIATURE COAX HYFEN ASSEMBLY, THE BLUE MARKING IS ON THIS END.

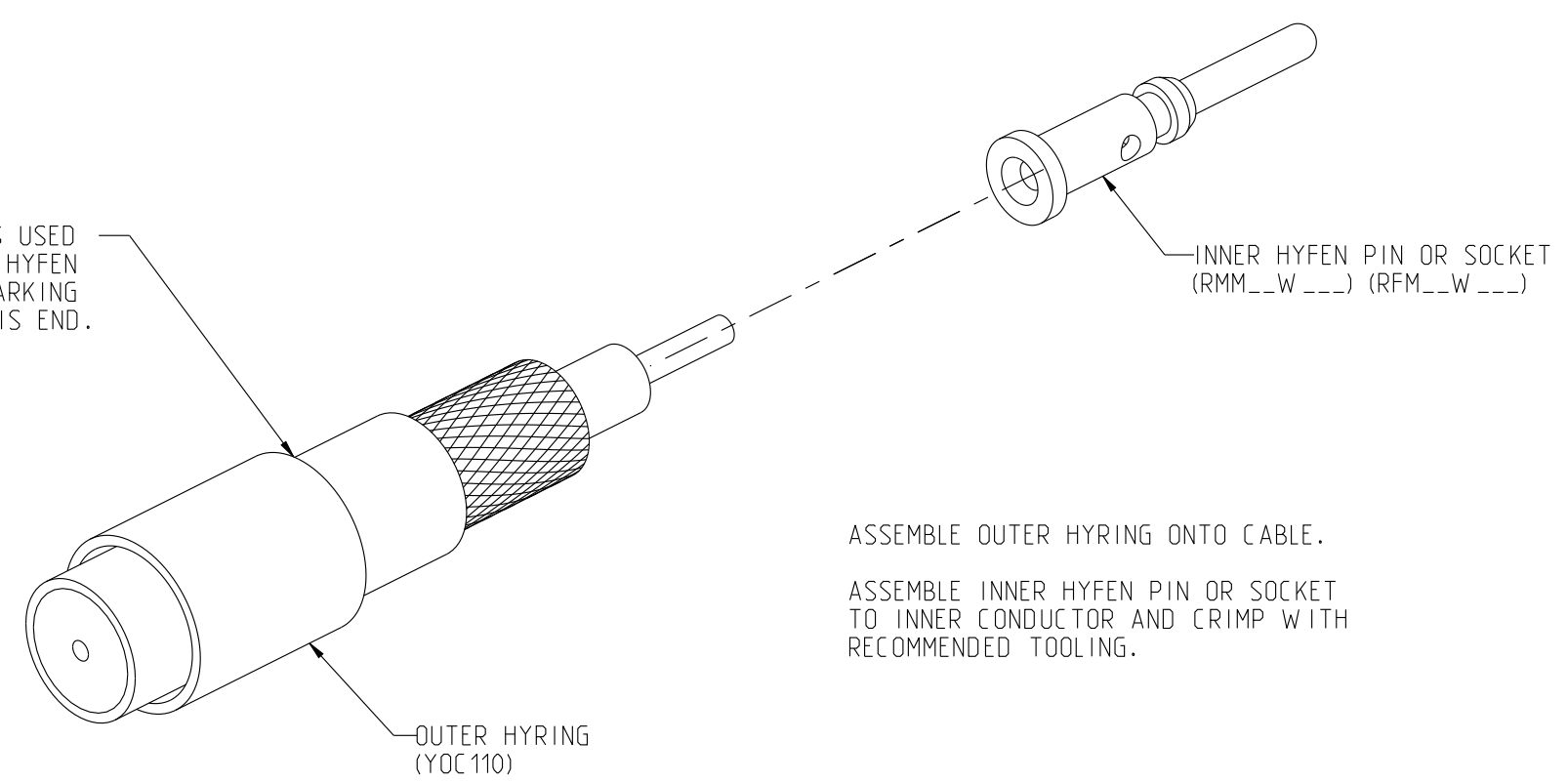

ASSEMBLE OUTER HYRING ONTO CABLE.

ASSEMBLE INNER HYFEN PIN OR SOCKET TO INNER CONDUCTOR AND CRIMP WITH RECOMMENDED TOOLING.

3

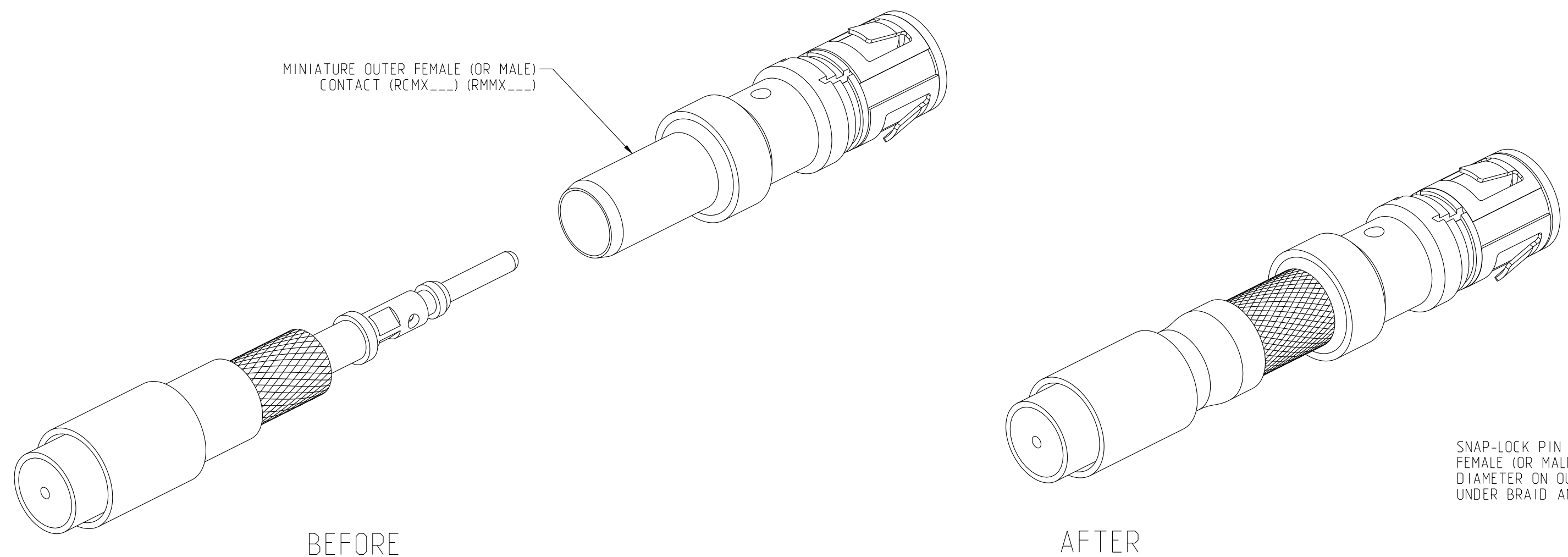

MINIATURE OUTER FEMALE (OR MALE) CONTACT (RCMX\_\_\_) (RMMX\_\_\_)

BEFORE

AFTER

SNAP-LOCK PIN OR SOCKET INTO OUTER FEMALE (OR MALE) CONTACT. SMALL DIAMETER ON OUTER BODY MUST SLIDE UNDER BRAID AND OUTER INSULATION.

4

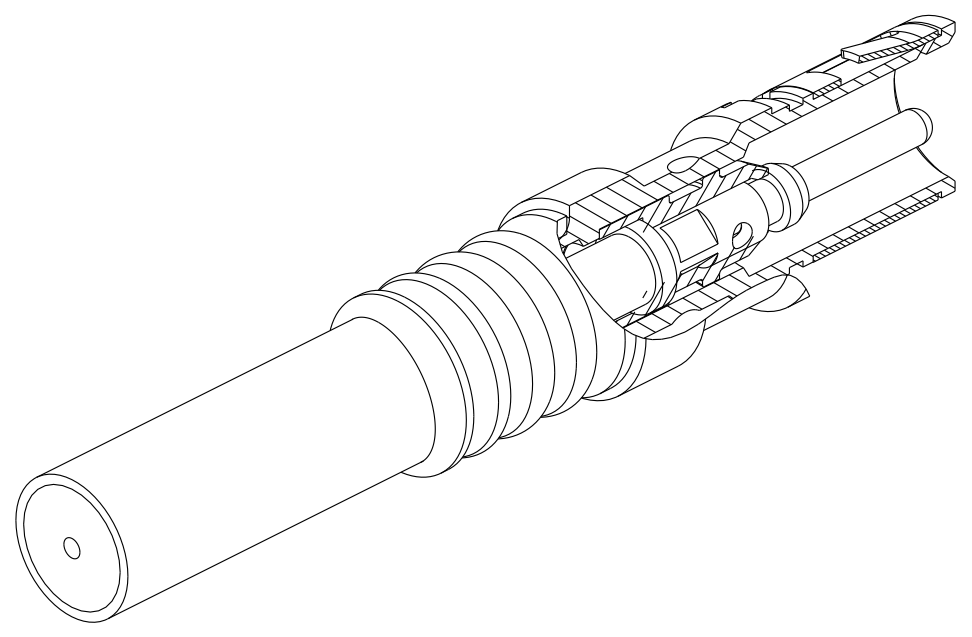

SLIDE OUTER HYRING OVER EXPOSED BRAID, AND CRIMP HYRING ONTO BRAID AND OUTER INSULATION WITH RECOMMENDED TOOLING.

ASSEMBLY CAN NOW BE SNAP-LOCKED INTO CONNECTOR BLOCK

-	ALL REVISIONS RECORDED ON SHT 1	-	-
REV	DESCRIPTION	BY DATE	CHKD DATE

DRAWING TITLE  
**ASSY. PROCEDURE FOR MINIATURE COAX HYFEN**  
CAT NO. **RCMX\_\_\_ & RMMX\_\_\_**

LINEAR MEASURE:	$\frac{\text{INCH}}{\text{mm}}$	INCH [mm]
THIRD ANGLE PROJECTION		
TOLERANCES UNLESS OTHERWISE SPECIFIED		
No. OF PLACES	INCH [mm]	
ONE PLACE	$\pm .1 [\pm 3]$	
TWO PLACES	$\pm .02 [\pm 0.5]$	
THREE PLACES	$\pm .010 [\pm 0.25]$	
ANGLES $\pm 1^\circ$		

CAGE NO: 09922	SIZE: C	DRAWN: SKV 08-16-13	CHKD: TW 08-16-13
<b>CUSTOMER</b>	<b>SOURIAU</b>	DSGN: XXX mm-dd-yy	MFG: DH 08-16-13
		QC: BB 08-16-13	DRAWING SCALE: 5:1
INTERPRET THIS DRAWING IN ACCORDANCE WITH ASME Y14.5M - 1994.		DRAWING NO. SD44088	REV AD
WWW.SOURIAU.COM		2 OF 7	

THE INFORMATION CONTAINED IN THIS DRAWING IS CONFIDENTIAL AND MAY NOT BE DISCLOSED WITHOUT WRITTEN CONSENT FROM SOURIAU USA, INC.

THIS DRAWING IS A CONTROLLED DOCUMENT FOR SOURIAU USA, INC. IT IS SUBJECT TO CHANGE WITHOUT NOTIFICATION. CONTACT THE DOCUMENT CONTROL CENTER FOR THE LATEST REVISION.

1

SLIT TO BE MADE ONLY WHEN JACKET MATERIAL IS NOT ELASTIC

STRIP COAXIAL CABLE TO DIMENSIONS SHOWN. (DIMENSIONS MAY BE ALTERED TO SUIT CHARACTERISTICS OF CABLE)

3

HYFEN PIN OR SOCKET (RMM\_W\_\_\_) (RFM\_W\_\_\_)

INNER HYRING IN POSITION

ASSEMBLE INNER HYFEN PIN OR SOCKET TO INNER CONDUCTOR AND CRIMP WITH RECOMMENDED TOOLING

2

INNER HYRING (YIRX069)

ASSEMBLE INNER HYRING POSITION BETWEEN BRAID AND INNER CONDUCTOR INSULATION WITH BRAID COVERING COMPLETE HYRING UP TO FLANGE.

4

MINIATURE OUTER FEMALE (OR MALE) CONTACT (RCMX\_\_\_) (RMMX\_\_\_)

SNAP-LOCK PIN (OR SOCKET) INTO OUTER FEMALE (OR MALE) CONTACT BRAID AND JACKET OF CABLE FIT INTO OUTER CONTACT

5

INSPECT FOR BRAID THROUGH PEEP HOLE (INNER HYRING SHOULD BE CLEAR OF HOLE). CRIMP REAR PORTION OF OUTER CONTACT WITH RECOMMENDED TOOLING.

ASSEMBLY CAN NOW BE SNAP-LOCKED INTO CONNECTOR BLOCK.

1

-	ALL REVISIONS RECORDED ON SHT 1	-	-
REV	DESCRIPTION	BY DATE	CHKD DATE

DRAWING TITLE: ASSY. PROCEDURE FOR MINIATURE COAX HYFEN

CAT NO.: RCMX\_\_\_ & RMMX\_\_\_

CAGE NO.: 09922 SIZE: C

LINEAR MEASURE:	$\frac{\text{INCH}}{\text{mm}}$	INCH [mm]
THIRD ANGLE PROJECTION		
TOLERANCES UNLESS OTHERWISE SPECIFIED		
No. OF PLACES	INCH [mm]	
ONE PLACE	$\pm .1 [\pm 3]$	
TWO PLACES	$\pm .02 [\pm 0.5]$	
THREE PLACES	$\pm .010 [\pm 0.25]$	
ANGLES $\pm 1^\circ$		

CUSTOMER

**SOURIAU**

WWW.SOURIAU.COM

DRAWN: SKV	08-16-13
CHKD: TW	08-16-13
DSGN: XXX	mm-dd-yy
MFG: DH	08-16-13
QC: BB	08-16-13
DRAWING SCALE: 5:1	
DRAWING NO.	REV
SD44088	AD
3 OF 7	

INTERPRET THIS DRAWING IN ACCORDANCE WITH ASME Y14.5M - 1994.

PRO-E

THE INFORMATION CONTAINED IN THIS DRAWING IS CONFIDENTIAL AND MAY NOT BE DISCLOSED WITHOUT WRITTEN CONSENT FROM SOURIAU USA, INC.

THIS DRAWING IS A CONTROLLED DOCUMENT FOR SOURIAU USA, INC. IT IS SUBJECT TO CHANGE WITHOUT NOTIFICATION. CONTACT THE DOCUMENT CONTROL CENTER FOR THE LATEST REVISION.

C

B

A

D

C

B

A

1

BRAID MUST BE COMBED FOR RG 196/U CABLE

STRIP COAXIAL CABLE TO DIMENSIONS SHOWN (DIMENSIONS MAY BE ALTERED TO SUIT CHARACTERISTICS OF CABLE)

2

SUPPORTING SLEEVE (RCMXB067)

INNER HYFEN PIN (OR SOCKET) (RMM\_\_W\_\_)(RFM\_\_W\_\_)

STEPPED OUTER HYRING (YORX110-2)

1. ASSEMBLE STEPPED OUTER HYRING ONTO CABLE
2. ASSEMBLE SUPPORTING SLEEVE OVER INNER DIELECTRIC AND UNDER BRIDE
3. ASSEMBLE INNER HYFEN PIN OR SOCKET TO INNER CONDUCTOR AND CRIMP WITH RECOMMENDED TOOLING

3

MINIATURE OUTER FEMALE (OR MALE) CONTACT (RCMX\_\_)(RMMX\_\_)

SUPPORTING SLEEVE IN POSITION

BEFORE

AFTER

SNAP-LOCK PIN (OR SOCKET) INTO OUTER FEMALE (OR MALE) CONTACT SMALL DIAMETER ON OUTER CONTACT MUST SLIDE OVER SUPPORTING SLEEVE AND UNDER BRAID.

4

SLIDE STEPPED OUTER HYRING OVER EXPOSED BRAID AND CRIMP HYRING ONTO BRAID WITH RECOMMENDED TOOLING

ASSEMBLY CAN NOW BE SNAP-LOCKED INTO CONNECTOR BLOCK

-	ALL REVISIONS RECORDED ON SHT 1	-	-
REV	DESCRIPTION	BY DATE	CHKD DATE

DRAWING TITLE: ASSY. PROCEDURE FOR MINIATURE COAX HYFEN

CAT NO.: RCMX\_\_ & RMMX\_\_

CAGE NO.: 09922 SIZE: C

DRAWN: SKV	08-16-13
CHKD: TW	08-16-13
DSGN: XXX	mm-dd-yy
MFG: DH	08-16-13
QC: BB	08-16-13

DRAWING SCALE: 5:1

DRAWING NO.: SD44088

REV: AD

4 OF 7

LINEAR MEASURE:	$\frac{\text{INCH}}{\text{mm}}$	INCH [mm]
THIRD ANGLE PROJECTION		
TOLERANCES UNLESS OTHERWISE SPECIFIED		
No. OF PLACES	INCH [mm]	
ONE PLACE	$\pm .1$ [ $\pm 3$ ]	
TWO PLACES	$\pm .02$ [ $\pm 0.5$ ]	
THREE PLACES	$\pm .010$ [ $\pm 0.25$ ]	
ANGLES $\pm 1^\circ$		

CUSTOMER

SOURIAU

WWW.SOURIAU.COM

INTERPRET THIS DRAWING IN ACCORDANCE WITH ASME Y14.5M - 1994.

PRO-E

THE INFORMATION CONTAINED IN THIS DRAWING IS CONFIDENTIAL AND MAY NOT BE DISCLOSED WITHOUT WRITTEN CONSENT FROM SOURIAU USA, INC.

4

3

2

1

1

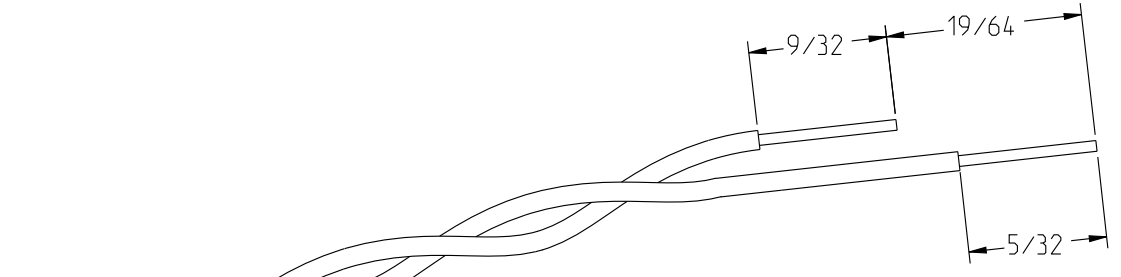

STRIP WIRE TO DIMENSIONS SHOWN

2

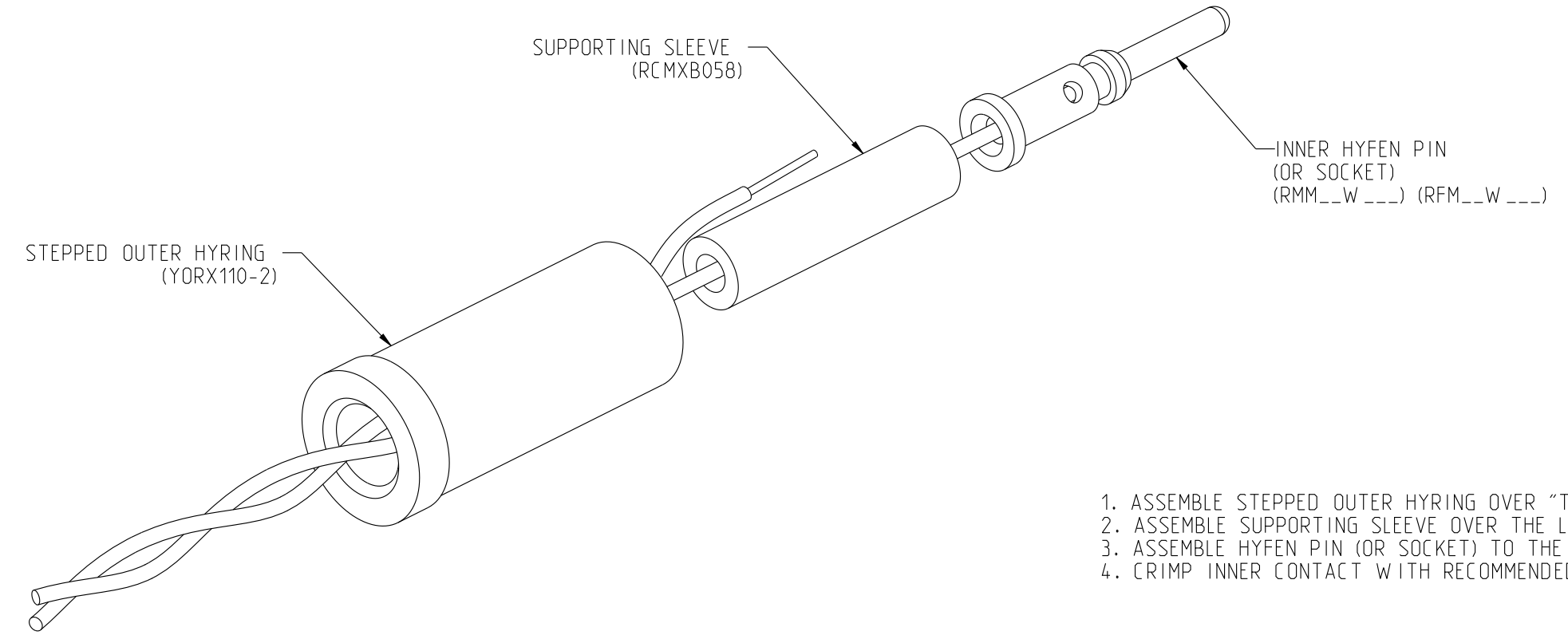

1. ASSEMBLE STEPPED OUTER HYRING OVER "TWISTED PAIR"
2. ASSEMBLE SUPPORTING SLEEVE OVER THE LONGER WIRE
3. ASSEMBLE HYFEN PIN (OR SOCKET) TO THE LONGER WIRE.
4. CRIMP INNER CONTACT WITH RECOMMENDED TOOLING.

3

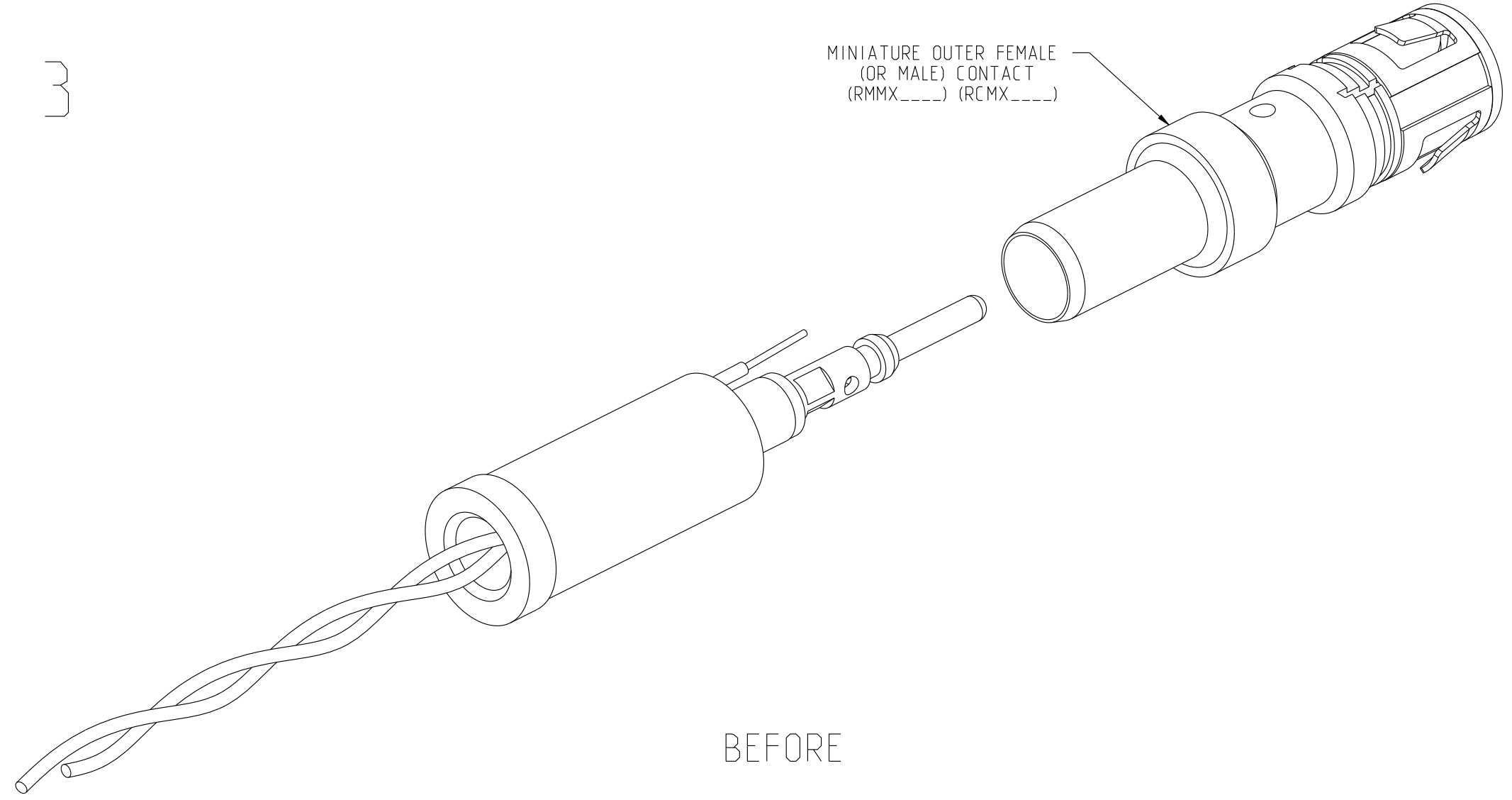

BEFORE

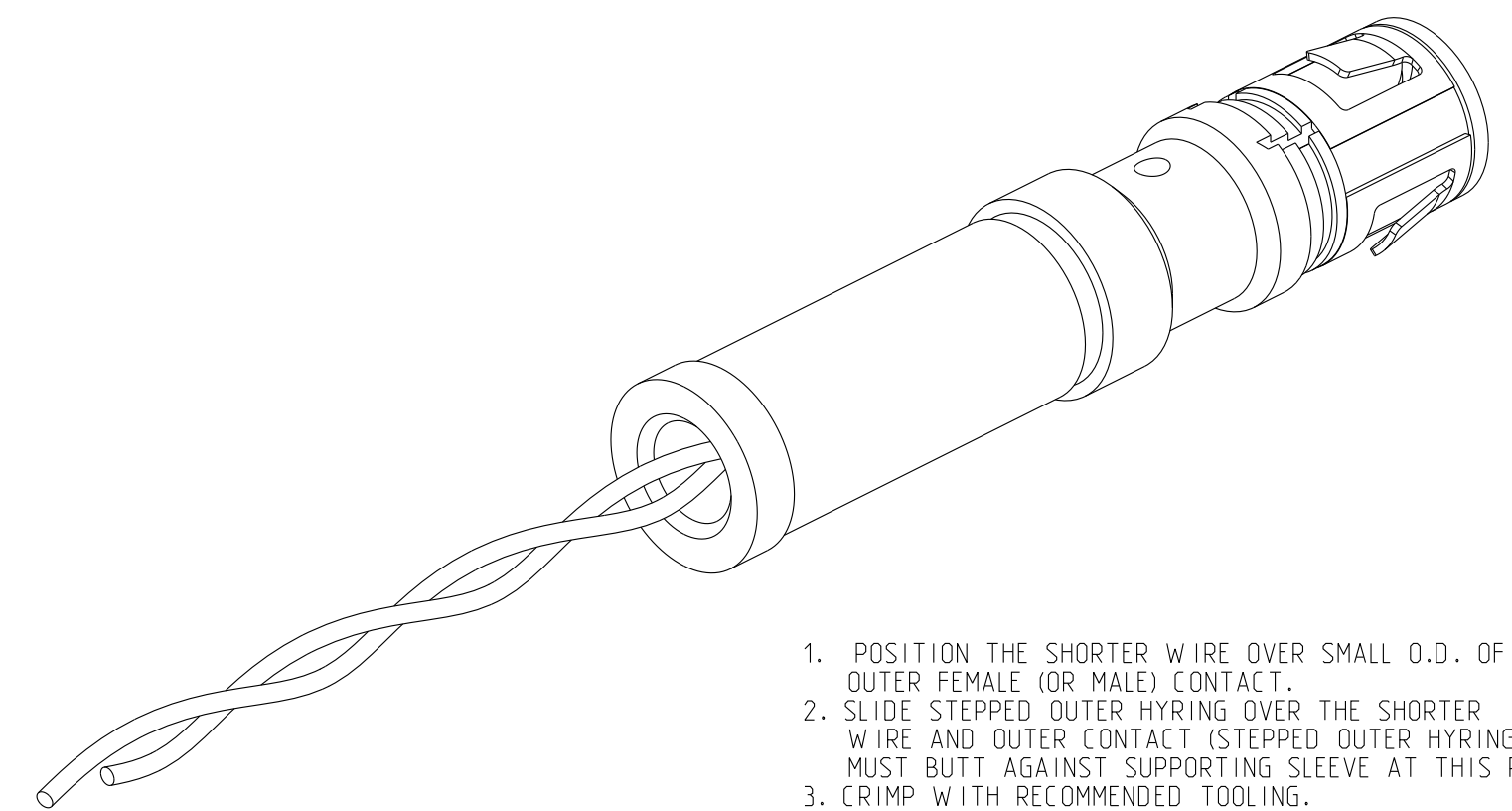

AFTER

1. POSITION THE SHORTER WIRE OVER SMALL O.D. OF OUTER FEMALE (OR MALE) CONTACT.
2. SLIDE STEPPED OUTER HYRING OVER THE SHORTER WIRE AND OUTER CONTACT (STEPPED OUTER HYRING MUST BUTT AGAINST SUPPORTING SLEEVE AT THIS POINT)
3. CRIMP WITH RECOMMENDED TOOLING.

4

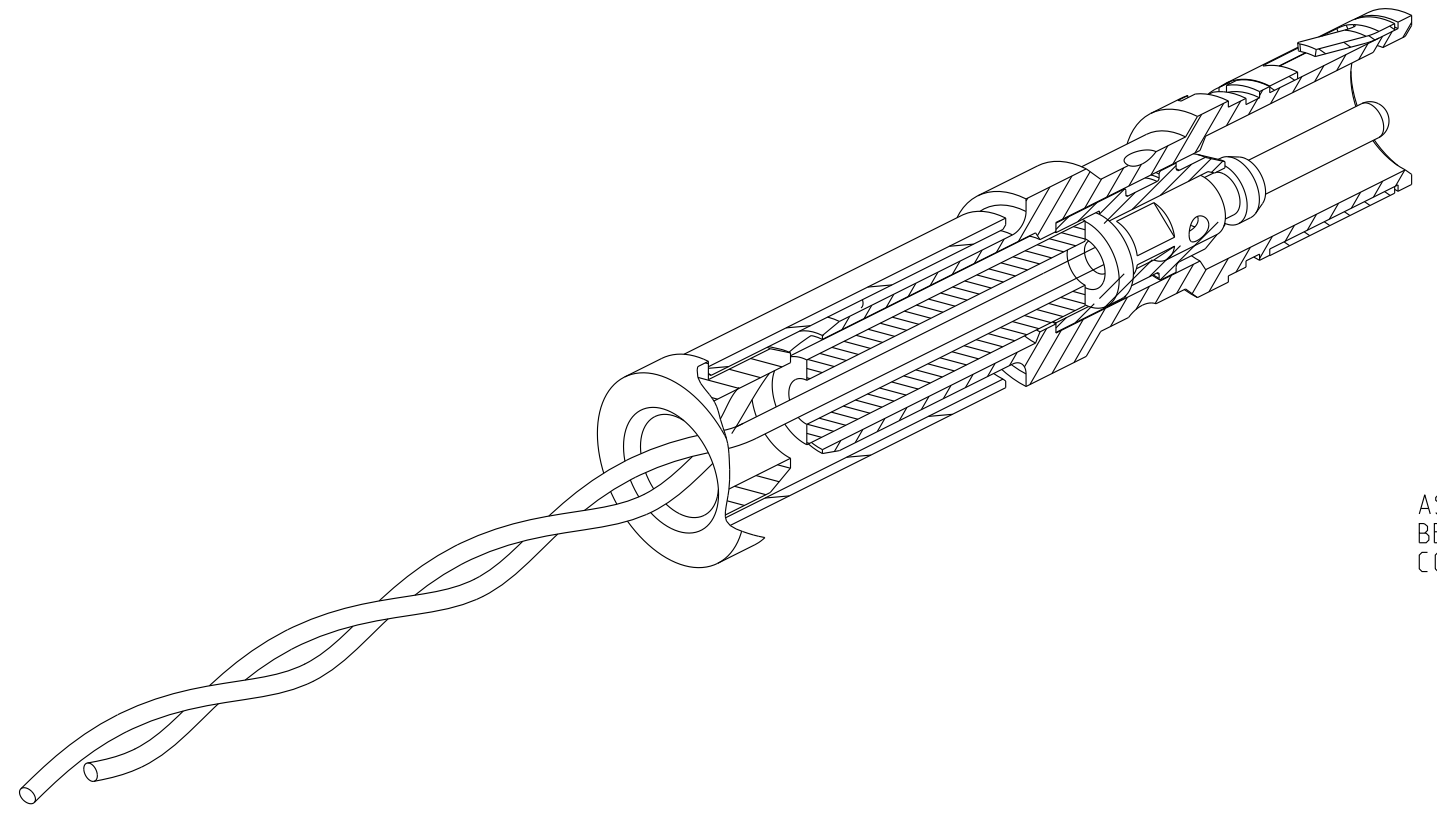

ASSEMBLY CAN NOW BE SNAP LOCKED INTO CONNECTOR BLOCK

-	ALL REVISIONS RECORDED ON SHT 1	-	-
REV	DESCRIPTION	BY DATE	CHKD DATE

DRAWING TITLE  
**ASSY. PROCEDURE FOR MINIATURE COAX HYFEN**

CAT NO. **RCMX\_\_\_ & RMMX\_\_\_**

CAGE NO: 09922	SIZE: C	DRAWN: SKV 08-16-13	CHKD: TW 08-16-13
<b>CUSTOMER</b>		DSGN: XXX mm-dd-yy	MFG: DH 08-16-13
		QC: BB 08-16-13	DRAWING SCALE: 5:1
INTERPRET THIS DRAWING IN ACCORDANCE WITH ASME Y14.5M - 1994.		DRAWING NO. SD44088	REV AD
		5 OF 7	

WWW.SOURIAU.COM

PRO-E

4

3

2

1

THIS DRAWING IS A CONTROLLED DOCUMENT FOR SOURIAU USA, INC. IT IS SUBJECT TO CHANGE WITHOUT NOTIFICATION. CONTACT THE DOCUMENT CONTROL CENTER FOR THE LATEST REVISION.

THE INFORMATION CONTAINED IN THIS DRAWING IS CONFIDENTIAL AND MAY NOT BE DISCLOSED WITHOUT WRITTEN CONSENT FROM SOURIAU USA, INC.

THIS DRAWING IS A CONTROLLED DOCUMENT FOR SOURIAU USA, INC. IT IS SUBJECT TO CHANGE WITHOUT NOTIFICATION. CONTACT THE DOCUMENT CONTROL CENTER FOR THE LATEST REVISION.

1

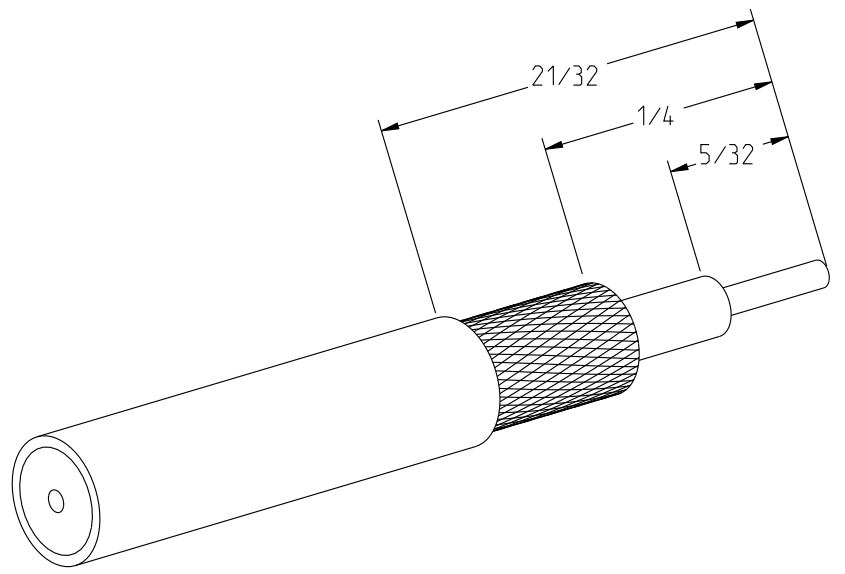

STRIP COAXIAL CABLE TO DIMENSIONS SHOWN (DIMENSIONS MAY BE ALTERED TO SUIT CHARACTERISTICS OF CABLE)

2

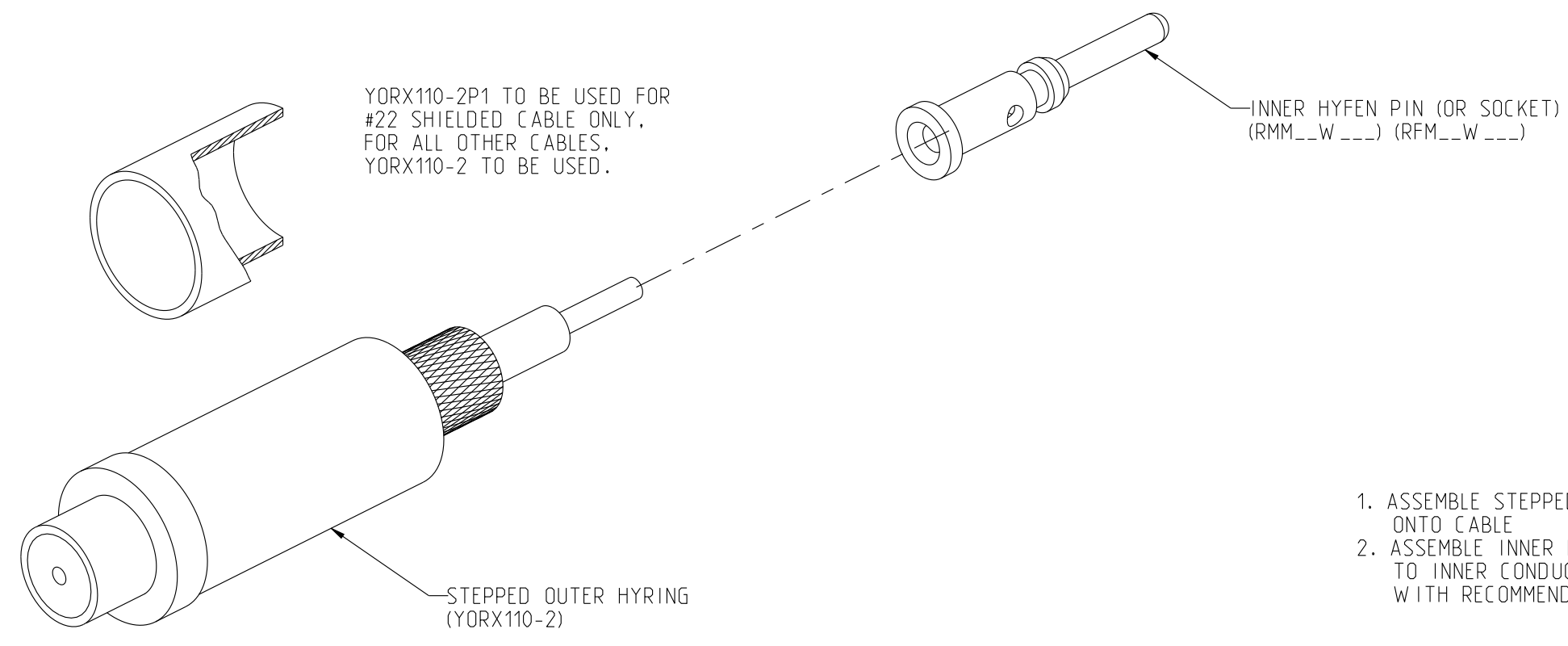

YORX110-2P1 TO BE USED FOR #22 SHIELDED CABLE ONLY. FOR ALL OTHER CABLES, YORX110-2 TO BE USED.

1. ASSEMBLE STEPPED OUTER HYRING ONTO CABLE
2. ASSEMBLE INNER HYFEN PIN OR SOCKET TO INNER CONDUCTOR AND CRIMP WITH RECOMMENDED TOOLING

3

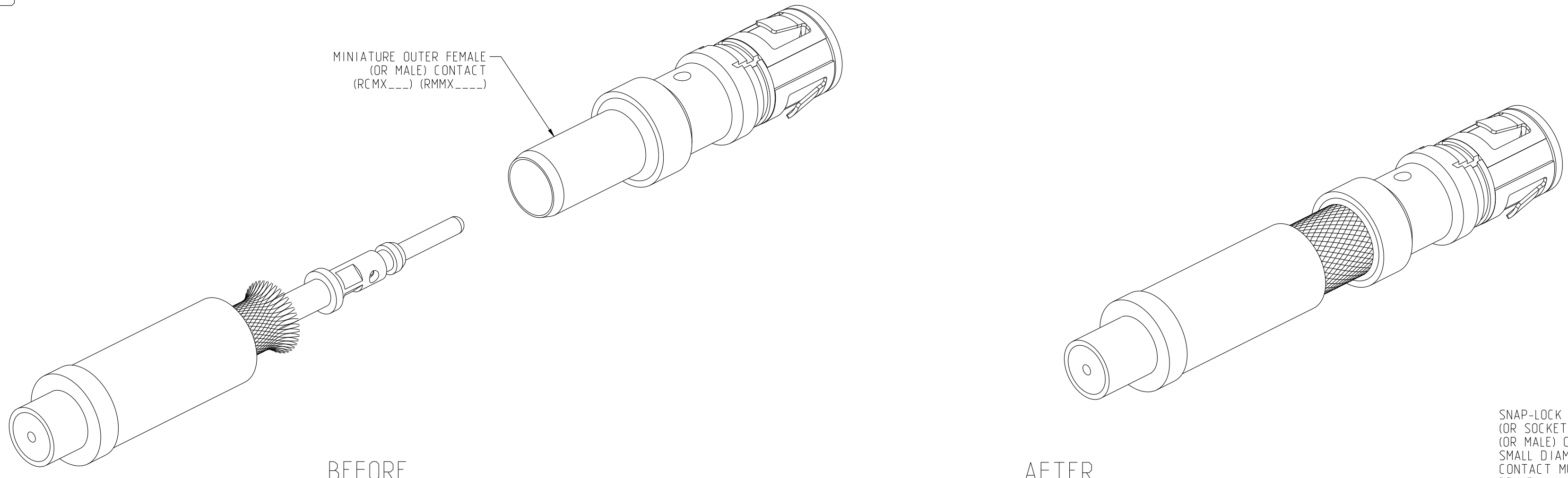

MINIATURE OUTER FEMALE (OR MALE) CONTACT (RCMX\_\_\_) (RMMX\_\_\_)

BEFORE

AFTER

SNAP-LOCK INNER HYFEN PIN (OR SOCKET) IN TO OUTER FEMALE (OR MALE) CONTACT. SMALL DIAMETER ON OUTER CONTACT MUST SLIDE UNDER BRAID

4

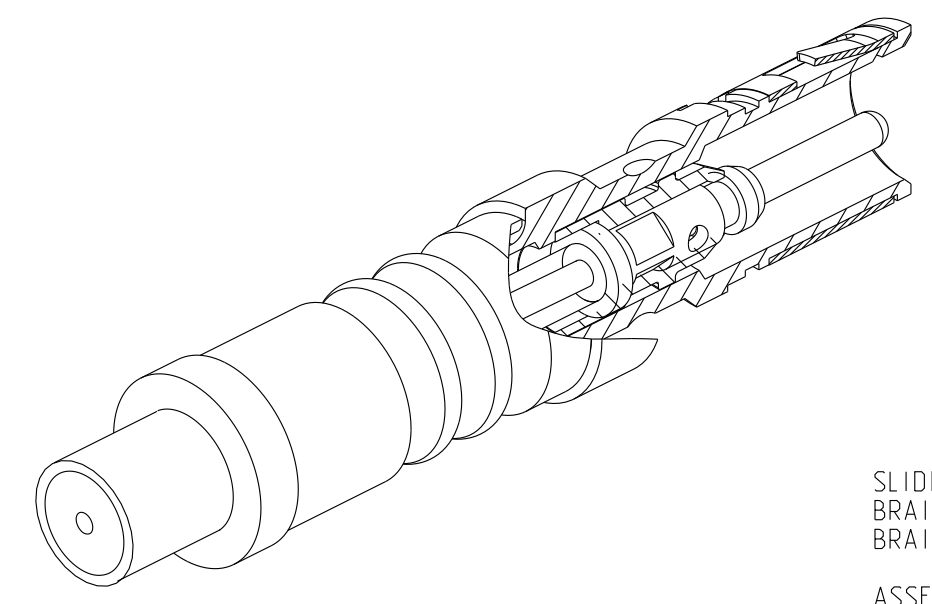

SLIDE STEPPED OUTER HYRING OVER EXPOSED BRAID, AND CRIMP HYRING ONTO BRAID WITH RECOMMENDED TOOLING

ASSEMBLY CAN NOW BE SNAP-LOCKED INTO CONNECTOR BLOCK

-	ALL REVISIONS RECORDED ON SHT 1	-	-
REV	DESCRIPTION	BY DATE	CHKD DATE

DRAWING TITLE  
**ASSY. PROCEDURE FOR MINIATURE COAX HYFEN**  
 CAT NO. **RCMX\_\_\_ & RMMX\_\_\_**

CAGE NO: 09922	SIZE: C	DRAWN: SKV 08-16-13	CHKD: TW 08-16-13
<b>CUSTOMER</b>		DSGN: XXX mm-dd-yy	MFG: DH 08-16-13
		QC: BB 08-16-13	DRAWING SCALE: 5:1
INTERPRET THIS DRAWING IN ACCORDANCE WITH ASME Y14.5M - 1994.		DRAWING NO. REV	SD44088 AD
		WWW.SOURIAU.COM	

LINEAR MEASURE:	$\frac{\text{INCH}}{\text{mm}}$	INCH [mm]
THIRD ANGLE PROJECTION		
TOLERANCES UNLESS OTHERWISE SPECIFIED		
No. OF PLACES	INCH [mm]	
ONE PLACE	$\pm .1$ [ $\pm 3$ ]	
TWO PLACES	$\pm .02$ [ $\pm 0.5$ ]	
THREE PLACES	$\pm .010$ [ $\pm 0.25$ ]	
ANGLES $\pm 1^\circ$		

A

B

C

D

THIS DRAWING IS A CONTROLLED DOCUMENT FOR SOURIAU USA, INC. IT IS SUBJECT TO CHANGE WITHOUT NOTIFICATION. CONTACT THE DOCUMENT CONTROL CENTER FOR THE LATEST REVISION.

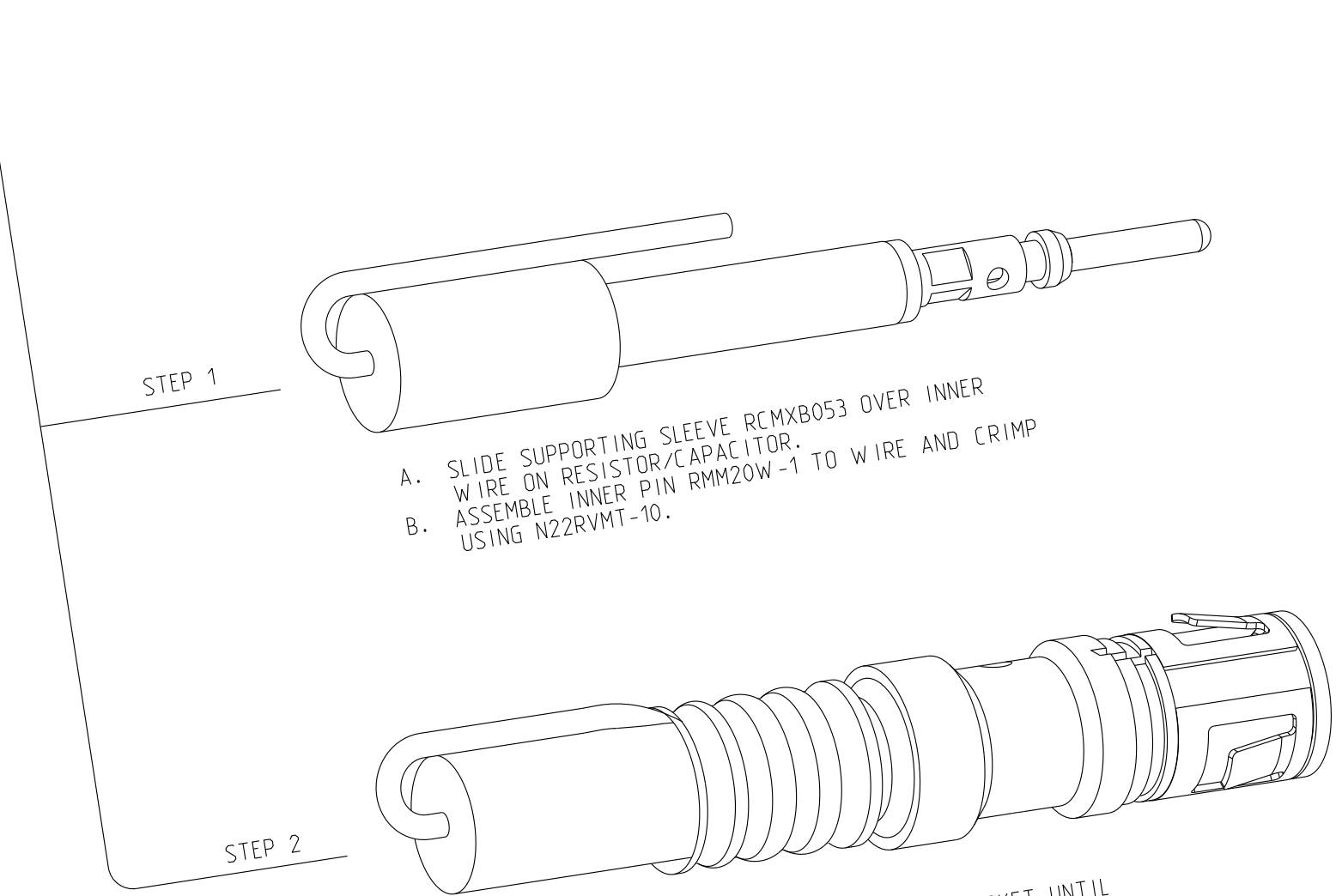
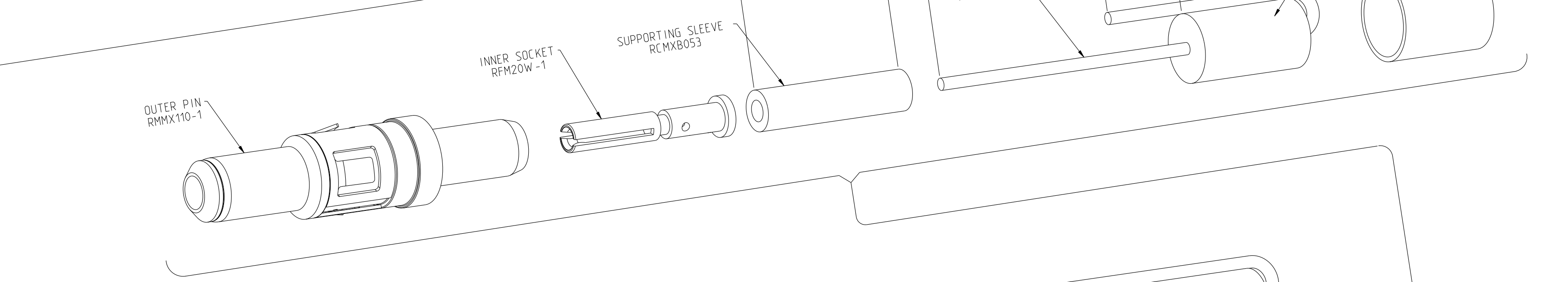
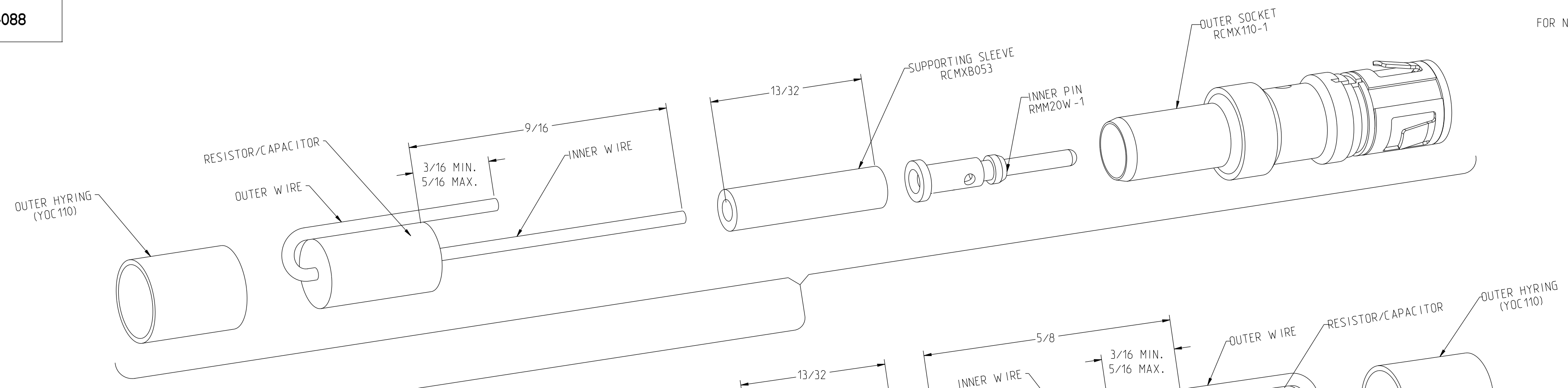

STEP 1  
 A. SLIDE SUPPORTING SLEEVE RCMXB053 OVER INNER WIRE ON RESISTOR/CAPACITOR.  
 B. ASSEMBLE INNER PIN RMM20W-1 TO WIRE AND CRIMP USING N22RVMT-10.

STEP 2  
 A. INSERT THE ASSEMBLY INTO THE OUTER SOCKET UNTIL THE INNER PIN SNAPS INTO PLACE. SLIDE OUTER HYRING OVER OUTER WIRE AND PLACE OUTER WIRE ON RESISTOR/CAPACITOR OVER THE BARREL.  
 B. SLIDE OUTER HYRING OVER BARREL OF OUTER SOCKET. OUTER WIRE SHOULD NOW BE BETWEEN THE BARREL OF THE OUTER SOCKET AND THE OUTER HYRING.  
 C. CRIMP THE OUTER HYRING USING N22RVMT-10

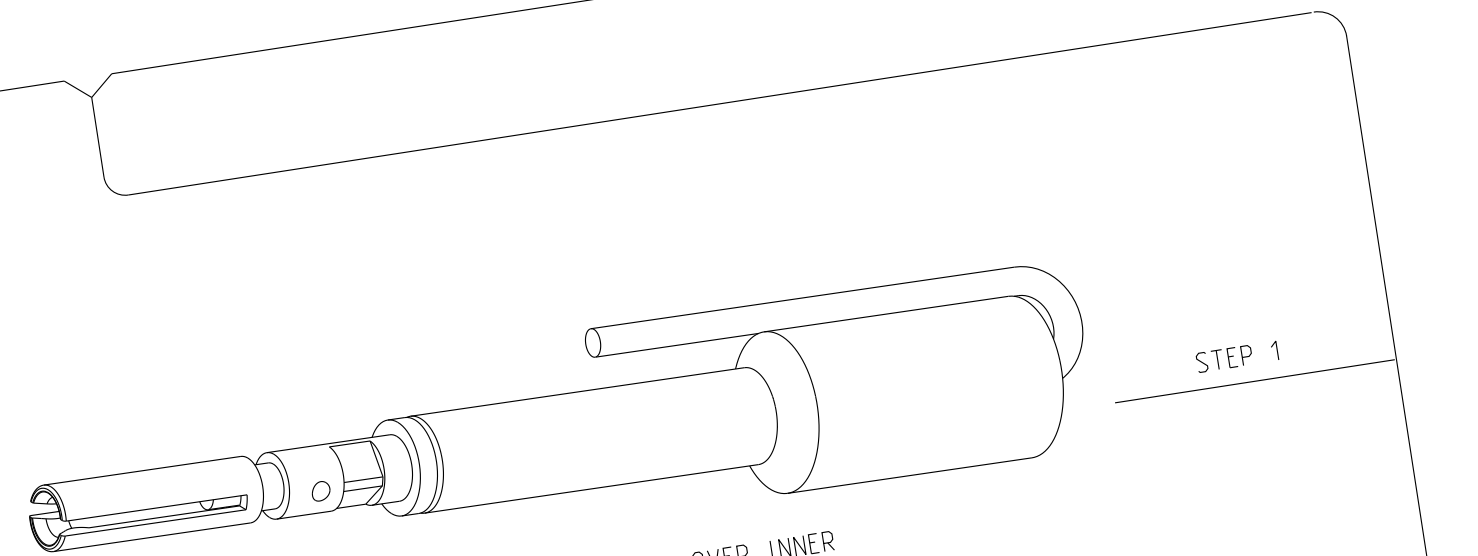

STEP 1  
 A. SLIDE SUPPORTING SLEEVE RCMXB053 OVER INNER WIRE ON RESISTOR/CAPACITOR.  
 B. ASSEMBLE INNER SOCKET RMM20W-1 TO WIRE AND CRIMP USING N22RVMT-10.

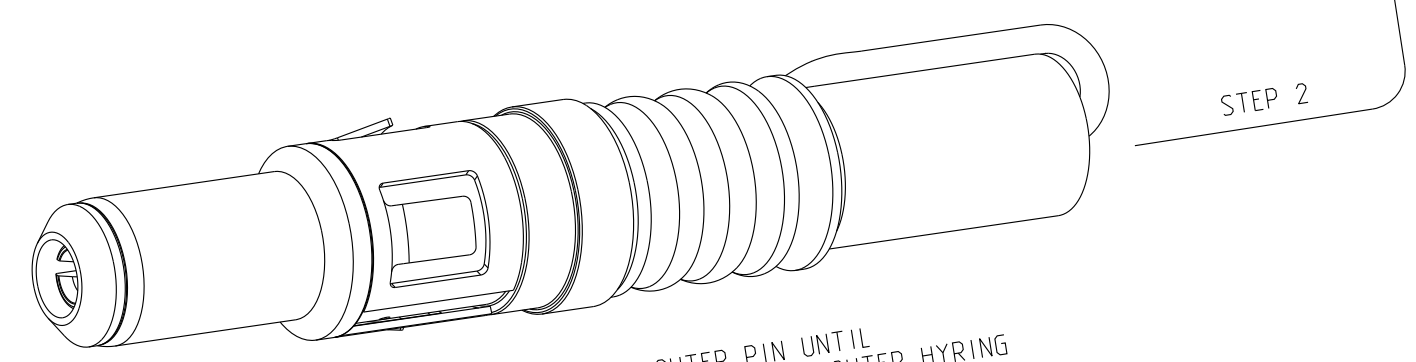

STEP 2  
 A. INSERT THE ASSEMBLY INTO THE OUTER PIN UNTIL THE INNER SOCKET SNAPS INTO PLACE. SLIDE OUTER HYRING OVER OUTER WIRE AND PLACE OUTER WIRE ON RESISTOR/CAPACITOR OVER THE BARREL.  
 B. SLIDE OUTER HYRING OVER BARREL OF OUTER PIN. OUTER WIRE SHOULD NOW BE BETWEEN THE BARREL OF THE OUTER PIN AND THE OUTER HYRING.  
 C. CRIMP THE OUTER HYRING USING N22RVMT-10

-	ALL REVISIONS RECORDED ON SHT 1	-	-
REV	DESCRIPTION	BY DATE	CHKD DATE

DRAWING TITLE  
**ASSY. PROCEDURE FOR MINIATURE COAX HYFEN**

CAT NO. RCMX --- & RMMX ---		DRAWN: SKV 08-16-13	
CAGE NO: 09922	SIZE: C	CHKD: TW 08-16-13	
<b>CUSTOMER</b>		DSGN: XXX mm-dd-yy	
		MFG: DH 08-16-13	
INTERPRET THIS DRAWING IN ACCORDANCE WITH ASME Y14.5M - 1994.		QC: BB 08-16-13	
		DRAWING SCALE: 5:1	
<b>SOURIAU</b> WWW.SOURIAU.COM		DRAWING NO. SD44088	REV AD
		7 OF 7	

LINEAR MEASURE:	$\frac{\text{INCH}}{\text{mm}}$	INCH [mm]
THIRD ANGLE PROJECTION		
TOLERANCES UNLESS OTHERWISE SPECIFIED		
No. OF PLACES	INCH [mm]	
ONE PLACE	±.1 [±3]	
TWO PLACES	±.02 [±0.5]	
THREE PLACES	±.010 [±0.25]	
ANGLES ±1°		

THE INFORMATION CONTAINED IN THIS DRAWING IS CONFIDENTIAL AND MAY NOT BE DISCLOSED WITHOUT WRITTEN CONSENT FROM SOURIAU USA, INC.

## X-ON Electronics

Largest Supplier of Electrical and Electronic Components

*Click to view similar products for [Standard Circular Contacts](#) category:*

*Click to view products by [Sunbank](#) manufacturer:*

Other Similar products are found below :

[60261626SNCOND1](#) [12295/3/F](#) [RM20M13D28](#) [MS3474W10-6P L/C](#) [ELVP16100E](#) [EN3545007SCE](#) [BV002SSQ160404CZ](#)  
[1900ND09S1B00B](#) [1900ND09S1X00D](#) [192900-0021](#) [192900-0061](#) [192900-0236-CGE16MSA](#) [192900-0273](#) [192900-0427](#) [192900-0430](#)  
[192900-0568](#) [192900-0574](#) [192900-0575](#) [192900-0649](#) [192900-0718](#) [JN1-22-26P-10000](#) [166566-1](#) [1900ND02P2B00A](#) [1900ND04S1X00D](#)  
[1900ND12P1B00A](#) [192900-0042](#) [192900-0047](#) [192900-0058](#) [192900-0101](#) [192900-0236-CGE16PSA](#) [192900-0270](#) [192900-0274](#) [192900-0578](#) [ST-JL05-16S-C3-100](#) [ST-JL05-20S-C1-100](#) [APK-SA16A07-002](#) [27963-15T12](#) [CONT-JL05-08S-C2-10](#) [CONT-JL05-12S-C1-10](#)  
[RFD26L-1D28](#) [BV002ASJ16049CW](#) [33505815019](#) [JN1-22-20S-R-PKG100](#) [031-50213](#) [192991-0087](#) [192900-0577](#) [192900-0571](#) [192900-0570](#) [192900-0245](#) [192900-0243](#)