

NOTES: UNLESS OTHERWISE SPECIFIED;

1 INTERPRET THIS DRAWING IN ACCORDANCE WITH ANSI Y14.5M-1982.

2 MATERIAL: NYLON

3 APPROXIMATE WEIGHT: 2.3 GRAMS

4 THIS PART SNAP FITS INTO CATALOG NUMBER RSMDEX-1 AND WILL SEPARATE FROM IT WITH A FORCE NOT GREATER THAN 11 POUNDS (48.9 N) AND NOT LESS THAN 3 POUNDS (13.3 N).

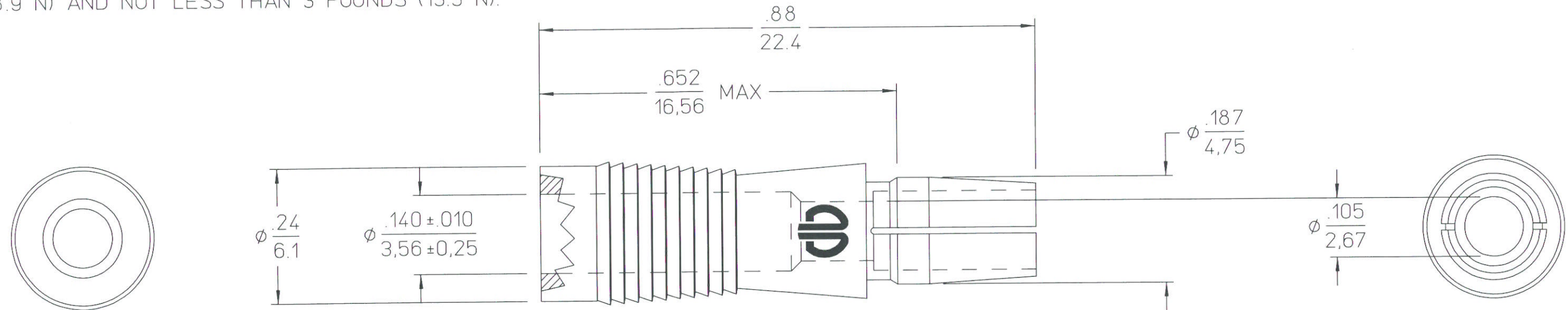

COLOR TABLE

CATALOG NO.	COLOR
RSCDEX-2	NATURAL (CLEAR TO WHITE)
RSCDEX-5	BLACK
RSCDEX-6	BLUE
RSCDEX-7	BROWN
RSCDEX-8	RED
RSCDEX-9	GREEN
RSCDEX-10	YELLOW
RSCDEX-11	VIOLET (PURPLE)
RSCDEX-12	GRAY
RSCDEX-13	ORANGE

REFERENCE:

SC55386 - RSMDEX-___
 SE52918 - SUB-MINIATURE COAX HYFEN
 SD57870 - SUB-MINIATURE COAX
 SD61512 - TRIM TRIO

ACCOMMODATES:

RCDX60-2 (SE52918)

SUPERSEDES:

SC55388
 AND SC60760-3

4	REDRAWN ON CAD WITHOUT CHANGE (ECN3129)	SMM	PJB	10/28/94
REV	REVISION DESCRIPTION	BY	CHKD	DATE

SUB-MINIATURE COAX SPLICE (PLUG) (SEPARABLE)			
CAT NO RSCDEX-___ (SEE TABLE)			
DWG RELEASED TO CENTRAL FILE 11-1-94			
CAGE NO 09922	ECN 3129	PC 830	
© BURNDY CORPORATION 1994			
APPROVAL	DRWN	NF	9-13-67
	CHKD	CAR	9-21-67
	DSGN	MP	9-21-67
	MKT	MG	10-28-94
	QC	SJ	10-28-94
DRAWING SCALE 5 : 1			
DRAWING NO			REV
SC60760			4
SHEET 1 OF 1			

LINEAR MEASURE: INCH mm INCH [mm]	
THIRD ANGLE PROJECTION	
- TOLERANCES - UNLESS OTHERWISE SPECIFIED	
NO OF DECIMAL PLACES IN INCHES	INCH [mm]
ONE PLACE	±.1 [±3]
TWO PLACES	±.02 [±0.5]
THREE PLACES	±.005 [±0.13]
ANGLES ±1°	



X-ON Electronics

Largest Supplier of Electrical and Electronic Components

Click to view similar products for [Circular MIL Spec Tools, Hardware & Accessories](#) *category:*

Click to view products by [Sunbank](#) *manufacturer:*

Other Similar products are found below :

[0113-201-2025](#) [600-079-06](#) [600-146-06](#) [M10-101983-183](#) [M10-454396-008](#) [602GB18808](#) [6134-333-1990](#) [6134-334-1590](#) [6134-334-2190](#)
[CS3102A-22-14PW](#) [M2887615-CD](#) [627-009](#) [M38999/9-19B](#) [630A007NF083A](#) [630B007M051A](#) [630BJ003NF032H](#) [637-149NF04B](#)
[M39029/29-215](#) [6408-203V-09273](#) [6426-201-11343](#) [650FS002NF16](#) [660-008NF14S7-01](#) [660-009M22H8-03](#) [660-013NF19U6-210](#) [660-](#)
[015M10S6-17](#) [660-015NF10S5-01](#) [660-015NF14R3.5-01](#) [660-023NF19H6-19](#) [660-024NF11S12-01](#) [660-024NF11S3-01](#) [660-024NF17S4-](#)
[109](#) [660-050XM17F4-01](#) [660-068NF25R6-30G](#) [660-070M23S8-04](#) [660-073MTCH9-20](#) [M83723/61-18W](#) [M83723/61-218R](#) [M83723/61-](#)
[224W](#) [667-084-23C](#) [667-084-35C](#) [667-224NF16](#) [687-697NF-1](#) [M85049/94-10-A](#) [M85049/96-7-A](#) [M855282-10A01A](#) [M85528/2-10B](#)
[M855282-18A01A](#) [M85528/2-22A01A](#) [M85528/2-22AA](#) [710HS460NF2508](#)