

SMD Type Shielded Power Inductors

◆ Features

1. Magnetically shielded Version.
2. High inductance /High Power Inductor.
3. The products contain no lead and also support lead-free soldering.

◆ Applications

Excellent as VTR, OA equipment, LCD television sets, notebook PC, portable communication equipments, DC/DC converters, etc.

◆ Lead Free Part Numbering

SLD 10D40 S 100 M T T
 (1) (2) (3) (4) (5) (6) (7)

- (1) Series Type
- (2) Dimension: A X C
- (3) Material Code
- (4) Inductance: 2R2=2.2μH ;
100=10μH; 101=100μH
- (5) Inductance Tolerance: M=±20%, Y=±30%
- (6) Company Code
- (7) Packaging : packed in embossed carrier

◆ Dimensions

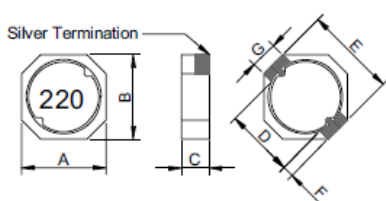

SLD0420S/0530 Series

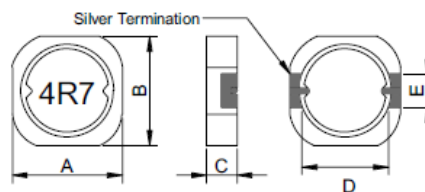

SLD0620/0625/0630/0635 Series

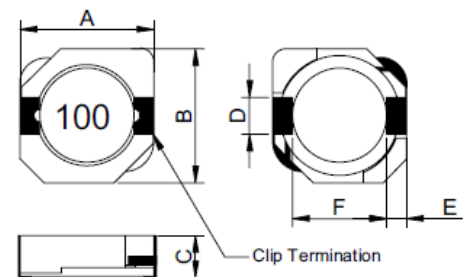

SLD10D30/10D40/10D50 Series

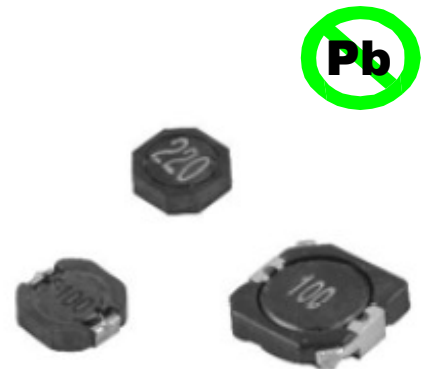

| Series | A(mm) | B(mm) | C(mm) | D(mm) | E(mm) | F(mm) | G(mm) |
|----------|-----------|-----------|----------|----------|----------|----------|----------|
| SLD0420 | 4.3 max. | 4.3 max. | 2.0 max. | 2.7 ref. | 4.4 ref. | 0.5 ref. | 2.0 ref. |
| SLD0530 | 5.3 max. | 5.3 max. | 3.0 max. | 4.2 ref. | 5.8 ref. | 0.6 ref. | 2.0 ref. |
| SLD0620 | 6.3 max. | 6.3 max. | 2.0 max. | 4.8 ref. | 2.0 ref. | - | - |
| SLD0625 | 6.3 max. | 6.3 max. | 2.5 max. | 4.8 ref. | 2.0 ref. | - | - |
| SLD0630 | 6.3 max. | 6.3 max. | 3.0 max. | 4.8 ref. | 2.0 ref. | - | - |
| SLD0635 | 6.3 max. | 6.3 max. | 3.5 max. | 4.8 ref. | 2.0 ref. | - | - |
| SLD10D30 | 10.5 max. | 10.3 max. | 3.0max. | 3.0±0.1 | 1.2±0.15 | 7.7±0.3 | - |
| SLD10D40 | 10.5 max. | 10.3 max. | 4.0max. | 3.0±0.1 | 1.2±0.15 | 7.7±0.3 | - |
| SLD10D50 | 10.5 max. | 10.3 max. | 5.0max. | 3.0±0.1 | 1.2±0.15 | 7.7±0.3 | - |

◆ Specification

| Part Number | Inductance (μ H) | Test Frequency (Hz) | DCR (Ω) max. | IDC (A) max. |
|-----------------------|--------------------------|------------------------|--------------------------|-----------------|
| SLD0420 Series | | | | |
| SLD0420S1R0MTT | 1.0±20% | 1V/100K | 0.028 | 2.00 |
| SLD0420S1R2MTT | 1.2±20% | 1V/100K | 0.040 | 1.70 |
| SLD0420S2R2MTT | 2.2±20% | 1V/100K | 0.073 | 1.50 |
| SLD0420S3R5MTT | 3.5±20% | 1V/100K | 0.120 | 1.30 |
| SLD0420S4R7MTT | 4.7±20% | 1V/100K | 0.160 | 1.10 |
| SLD0420S6R8MTT | 6.8±20% | 1V/100K | 0.210 | 0.90 |
| SLD0420S100MTT | 10±20% | 1V/100K | 0.450 | 0.70 |
| SLD0420S150MTT | 15±20% | 1V/100K | 0.481 | 0.61 |
| SLD0420S220MTT | 22±20% | 1V/100K | 0.720 | 0.52 |
| SLD0420S330MTT | 33±20% | 1V/100K | 1.010 | 0.43 |
| SLD0420S470MTT | 47±20% | 1V/100K | 1.780 | 0.34 |
| SLD0420S680MTT | 68±20% | 1V/100K | 2.770 | 0.25 |
| SLD0420S101MTT | 100±20% | 1V/100K | 3.440 | 0.19 |

◆ Specification

| Part Number | Inductance (μ H) | Test Frequency (Hz) | DCR (Ω) max. | IDC (A) max. |
|-----------------------|--------------------------|------------------------|--------------------------|-----------------|
| SLD0530 Series | | | | |
| SLD0530S1R1MTT | 1.1 \pm 20% | 1V/100K | 0.020 | 3.87 |
| SLD0530S2R0MTT | 2.0 \pm 20% | 1V/100K | 0.027 | 2.92 |
| SLD0530S3R3MTT | 3.3 \pm 20% | 1V/100K | 0.034 | 2.36 |
| SLD0530S4R7MTT | 4.7 \pm 20% | 1V/100K | 0.045 | 1.87 |
| SLD0530S6R8MTT | 6.8 \pm 20% | 1V/100K | 0.068 | 1.51 |
| SLD0530S100MTT | 10 \pm 20% | 1V/100K | 0.090 | 1.33 |
| SLD0530S150MTT | 15 \pm 20% | 1V/100K | 0.142 | 1.05 |
| SLD0530S220MTT | 22 \pm 20% | 1V/100K | 0.208 | 0.86 |
| SLD0530S330MTT | 33 \pm 20% | 1V/100K | 0.257 | 0.72 |
| SLD0530S470MTT | 47 \pm 20% | 1V/100K | 0.352 | 0.62 |
| SLD0530S680MTT | 68 \pm 20% | 1V/100K | 0.525 | 0.51 |
| SLD0530S101MTT | 100 \pm 20% | 1V/100K | 0.801 | 0.43 |

◆ Specification

| Part Number | Inductance (μ H) | Test Frequency (Hz) | DCR (Ω) max. | IDC (A) max. |
|-----------------------|--------------------------|------------------------|--------------------------|-----------------|
| SLD0620 Series | | | | |
| SLD0620S1R0MTT | 1.0 \pm 20% | 1V/100K | 0.016 | 3.50 |
| SLD0620S1R5MTT | 1.5 \pm 20% | 1V/100K | 0.021 | 2.94 |
| SLD0620S2R0MTT | 2.0 \pm 20% | 1V/100K | 0.028 | 2.47 |
| SLD0620S3R3MTT | 3.3 \pm 20% | 1V/100K | 0.047 | 1.99 |
| SLD0620S4R7MTT | 4.7 \pm 20% | 1V/100K | 0.065 | 1.59 |
| SLD0620S6R2MTT | 6.2 \pm 20% | 1V/100K | 0.074 | 1.49 |
| SLD0620S8R2MTT | 8.2 \pm 20% | 1V/100K | 0.102 | 1.25 |
| SLD0620S100MTT | 10 \pm 20% | 1V/100K | 0.118 | 1.22 |
| SLD0620S120MTT | 12 \pm 20% | 1V/100K | 0.153 | 0.99 |
| SLD0620S150MTT | 15 \pm 20% | 1V/100K | 0.197 | 0.94 |
| SLD0620S180MTT | 18 \pm 20% | 1V/100K | 0.207 | 0.83 |
| SLD0620S220MTT | 22 \pm 20% | 1V/100K | 0.253 | 0.80 |
| SLD0620S270MTT | 27 \pm 20% | 1V/100K | 0.33 | 0.65 |
| SLD0620S330MTT | 33 \pm 20% | 1V/100K | 0.368 | 0.63 |
| SLD0620S390MTT | 39 \pm 20% | 1V/100K | 0.473 | 0.55 |
| SLD0620S470MTT | 47 \pm 20% | 1V/100K | 0.542 | 0.50 |

◆ Specification

| Part Number | Inductance (μ H) | Test Frequency (Hz) | DCR (Ω) max. | IDC (A) max. |
|-----------------------|--------------------------|------------------------|--------------------------|-----------------|
| SLD0625 Series | | | | |
| SLD0625S1R0MTT | 1.0 \pm 20% | 1V/100K | 0.014 | 3.48 |
| SLD0625S1R5MTT | 1.5 \pm 20% | 1V/100K | 0.018 | 2.83 |
| SLD0625S2R0MTT | 2.0 \pm 20% | 1V/100K | 0.020 | 2.44 |
| SLD0625S3R3MTT | 3.3 \pm 20% | 1V/100K | 0.030 | 1.89 |
| SLD0625S4R3MTT | 4.3 \pm 20% | 1V/100K | 0.039 | 1.65 |
| SLD0625S6R2MTT | 6.2 \pm 20% | 1V/100K | 0.054 | 1.37 |
| SLD0625S100MTT | 10 \pm 20% | 1V/100K | 0.080 | 1.07 |
| SLD0625S120MTT | 12 \pm 20% | 1V/100K | 0.094 | 0.97 |
| SLD0625S150MTT | 15 \pm 20% | 1V/100K | 0.109 | 0.87 |
| SLD0625S180MTT | 18 \pm 20% | 1V/100K | 0.138 | 0.79 |
| SLD0625S220MTT | 22 \pm 20% | 1V/100K | 0.163 | 0.71 |
| SLD0625S270MTT | 27 \pm 20% | 1V/100K | 0.212 | 0.64 |
| SLD0625S330MTT | 33 \pm 20% | 1V/100K | 0.244 | 0.58 |
| SLD0625S390MTT | 39 \pm 20% | 1V/100K | 0.306 | 0.53 |
| SLD0625S470MTT | 47 \pm 20% | 1V/100K | 0.363 | 0.48 |
| SLD0625S560MTT | 56 \pm 20% | 1V/100K | 0.431 | 0.44 |
| SLD0625S680MTT | 68 \pm 20% | 1V/100K | 0.500 | 0.40 |
| SLD0625S820MTT | 82 \pm 20% | 1V/100K | 0.580 | 0.36 |
| SLD0625S101MTT | 100 \pm 20% | 1V/100K | 0.820 | 0.33 |

◆ Specification

| Part Number | Inductance (μ H) | Test Frequency (Hz) | DCR (Ω) max. | IDC (A) max. |
|-----------------------|--------------------------|------------------------|--------------------------|-----------------|
| SLD0630 Series | | | | |
| SLD0630S1R0MTT | 1.0 \pm 20% | 1V/100K | 0.014 | 3.59 |
| SLD0630S1R5MTT | 1.5 \pm 20% | 1V/100K | 0.016 | 2.93 |
| SLD0630S2R2MTT | 2.2 \pm 20% | 1V/100K | 0.020 | 2.42 |
| SLD0630S3R6MTT | 3.6 \pm 20% | 1V/100K | 0.026 | 1.89 |
| SLD0630S4R7MTT | 4.7 \pm 20% | 1V/100K | 0.034 | 1.66 |
| SLD0630S6R2MTT | 6.2 \pm 20% | 1V/100K | 0.040 | 1.45 |
| SLD0630S100MTT | 10 \pm 20% | 1V/100K | 0.061 | 1.14 |
| SLD0630S120MTT | 12 \pm 20% | 1V/100K | 0.065 | 1.04 |
| SLD0630S150MTT | 15 \pm 20% | 1V/100K | 0.078 | 0.93 |
| SLD0630S180MTT | 18 \pm 20% | 1V/100K | 0.093 | 0.85 |
| SLD0630S220MTT | 22 \pm 20% | 1V/100K | 0.119 | 0.77 |
| SLD0630S270MTT | 27 \pm 20% | 1V/100K | 0.150 | 0.70 |
| SLD0630S330MTT | 33 \pm 20% | 1V/100K | 0.175 | 0.63 |
| SLD0630S390MTT | 39 \pm 20% | 1V/100K | 0.188 | 0.58 |
| SLD0630S470MTT | 47 \pm 20% | 1V/100K | 0.231 | 0.53 |
| SLD0630S560MTT | 56 \pm 20% | 1V/100K | 0.275 | 0.48 |
| SLD0630S680MTT | 68 \pm 20% | 1V/100K | 0.338 | 0.44 |
| SLD0630S820MTT | 82 \pm 20% | 1V/100K | 0.413 | 0.40 |
| SLD0630S101MTT | 100 \pm 20% | 1V/100K | 0.519 | 0.36 |
| SLD0630S151MTT | 150 \pm 20% | 1V/100K | 0.769 | 0.31 |

◆ Specification

| Part Number | Inductance (μ H) | Test Frequency (Hz) | DCR (Ω) max. | IDC (A) max. |
|-----------------------|--------------------------|------------------------|--------------------------|-----------------|
| SLD0635 Series | | | | |
| SLD0635S2R0MTT | 2.0 \pm 20% | 1V/100K | 0.020 | 2.997 |
| SLD0635S2R7MTT | 2.7 \pm 20% | 1V/100K | 0.023 | 2.691 |
| SLD0635S3R3MTT | 3.3 \pm 20% | 1V/100K | 0.027 | 2.573 |
| SLD0635S4R7MTT | 4.7 \pm 20% | 1V/100K | 0.033 | 2.084 |
| SLD0635S6R2MTT | 6.2 \pm 20% | 1V/100K | 0.036 | 1.835 |
| SLD0635S8R2MTT | 8.2 \pm 20% | 1V/100K | 0.045 | 1.542 |
| SLD0635S100MTT | 10 \pm 20% | 1V/100K | 0.052 | 1.491 |
| SLD0635S120MTT | 12 \pm 20% | 1V/100K | 0.065 | 1.282 |
| SLD0635S150MTT | 15 \pm 20% | 1V/100K | 0.080 | 1.103 |
| SLD0635S180MTT | 18 \pm 20% | 1V/100K | 0.085 | 1.046 |
| SLD0635S220MTT | 22 \pm 20% | 1V/100K | 0.111 | 0.968 |
| SLD0635S270MTT | 27 \pm 20% | 1V/100K | 0.146 | 0.821 |
| SLD0635S330MTT | 33 \pm 20% | 1V/100K | 0.169 | 0.755 |
| SLD0635S390MTT | 39 \pm 20% | 1V/100K | 0.199 | 0.700 |
| SLD0635S470MTT | 47 \pm 20% | 1V/100K | 0.218 | 0.677 |
| SLD0635S560MTT | 56 \pm 20% | 1V/100K | 0.268 | 0.602 |
| SLD0635S680MTT | 68 \pm 20% | 1V/100K | 0.333 | 0.556 |
| SLD0635S820MTT | 82 \pm 20% | 1V/100K | 0.436 | 0.468 |
| SLD0635S101MTT | 100 \pm 20% | 1V/100K | 0.496 | 0.449 |
| SLD0635S151MTT | 150 \pm 20% | 1V/100K | 0.691 | 0.367 |

◆ Specification

| Part Number | Inductance (μ H) | Test Frequency (Hz) | DCR (m Ω) max. | IDC (A) max. |
|------------------------|--------------------------|------------------------|---------------------------|-----------------|
| SLD10D30 Series | | | | |
| SLD10D30SR80YTT | 0.8 \pm 30% | 0.1V/100K | 5.7 | 11.20 |
| SLD10D30S1R5MTT | 1.5 \pm 20% | 0.1V/100K | 11 | 8.00 |
| SLD10D30S2R2MTT | 2.2 \pm 20% | 0.1V/100K | 16.9 | 6.70 |
| SLD10D30S3R3MTT | 3.3 \pm 20% | 0.1V/100K | 21 | 5.56 |
| SLD10D30S4R7MTT | 4.7 \pm 20% | 0.1V/100K | 30 | 4.65 |
| SLD10D30S6R8MTT | 6.8 \pm 20% | 0.1V/100K | 35 | 3.84 |
| SLD10D30S8R2MTT | 8.2 \pm 20% | 0.1V/100K | 50 | 3.54 |
| SLD10D30S100MTT | 10 \pm 20% | 0.1V/100K | 59 | 3.18 |
| SLD10D30S150MTT | 15 \pm 20% | 0.1V/100K | 91 | 2.60 |
| SLD10D30S220MTT | 22 \pm 20% | 0.1V/100K | 143 | 2.16 |
| SLD10D30S330MTT | 33 \pm 20% | 0.1V/100K | 202 | 1.74 |
| SLD10D30S470MTT | 47 \pm 20% | 0.1V/100K | 299 | 1.43 |
| SLD10D30S560MTT | 56 \pm 20% | 0.1V/100K | 325 | 1.36 |
| SLD10D30S680MTT | 68 \pm 20% | 0.1V/100K | 429 | 1.22 |
| SLD10D30S820MTT | 82 \pm 20% | 0.1V/100K | 494 | 1.14 |
| SLD10D30S101MTT | 100 \pm 20% | 0.1V/100K | 683 | 1.02 |
| SLD10D30S121MTT | 120 \pm 20% | 0.1V/100K | 754 | 0.89 |
| SLD10D30S151MTT | 150 \pm 20% | 0.1V/100K | 871 | 0.84 |

◆ Specification

| Part Number | Inductance (μ H) | Test Frequency (Hz) | DCR (m Ω) max. | IDC (A) max. |
|------------------------|--------------------------|------------------------|---------------------------|-----------------|
| SLD10D40 Series | | | | |
| SLD10D40S1R5MTT | 1.50 \pm 20% | 0.1V/100K | 8.1 | 10.00 |
| SLD10D40S2R5MTT | 2.50 \pm 20% | 0.1V/100K | 10.5 | 7.50 |
| SLD10D40S3R8MTT | 3.80 \pm 20% | 0.1V/100K | 13 | 6.00 |
| SLD10D40S5R2MTT | 5.20 \pm 20% | 0.1V/100K | 22 | 5.50 |
| SLD10D40S7R0MTT | 7.00 \pm 20% | 0.1V/100K | 27 | 4.80 |
| SLD10D40S100MTT | 10.0 \pm 20% | 0.1V/100K | 35 | 4.40 |
| SLD10D40S150MTT | 15.0 \pm 20% | 0.1V/100K | 50 | 3.60 |
| SLD10D40S220MTT | 22.0 \pm 20% | 0.1V/100K | 73 | 2.90 |
| SLD10D40S330MTT | 33.0 \pm 20% | 0.1V/100K | 93 | 2.30 |
| SLD10D40S470MTT | 47.0 \pm 20% | 0.1V/100K | 128 | 2.10 |
| SLD10D40S680MTT | 68.0 \pm 20% | 0.1V/100K | 213 | 1.50 |
| SLD10D40S101MTT | 100.0 \pm 20% | 0.1V/100K | 304 | 1.35 |
| SLD10D40S151MTT | 150.0 \pm 20% | 0.1V/100K | 506 | 1.15 |
| SLD10D40S221MTT | 220.0 \pm 20% | 0.1V/100K | 756 | 0.92 |
| SLD10D40S331MTT | 330.0 \pm 20% | 0.1V/100K | 1090 | 0.70 |

◆ Specification

| Part Number | Inductance (μ H) | Test Frequency (Hz) | DCR (m Ω) max. | IDC (A) max. |
|------------------------|--------------------------|------------------------|---------------------------|-----------------|
| SLD10D50 Series | | | | |
| SLD10D50SR80YTT | 0.8 \pm 30% | 0.1V/100K | 4.3 | 9.50 |
| SLD10D50S1R5MTT | 1.5 \pm 20% | 0.1V/100K | 5.8 | 8.30 |
| SLD10D50S2R2MTT | 2.2 \pm 20% | 0.1V/100K | 7.2 | 7.50 |
| SLD10D50S3R3MTT | 3.3 \pm 20% | 0.1V/100K | 10.4 | 6.50 |
| SLD10D50S4R7MTT | 4.7 \pm 20% | 0.1V/100K | 12.3 | 6.10 |
| SLD10D50S6R8MTT | 6.8 \pm 20% | 0.1V/100K | 18 | 5.40 |
| SLD10D50S8R2MTT | 8.2 \pm 20% | 0.1V/100K | 20 | 5.00 |
| SLD10D50S100MTT | 10 \pm 20% | 0.1V/100K | 26 | 4.50 |
| SLD10D50S120MTT | 12 \pm 20% | 0.1V/100K | 33 | 3.80 |
| SLD10D50S150MTT | 15 \pm 20% | 0.1V/100K | 41 | 3.40 |
| SLD10D50S180MTT | 18 \pm 20% | 0.1V/100K | 46 | 3.10 |
| SLD10D50S220MTT | 22 \pm 20% | 0.1V/100K | 61 | 2.90 |
| SLD10D50S270MTT | 27 \pm 20% | 0.1V/100K | 69 | 2.60 |
| SLD10D50S330MTT | 33 \pm 20% | 0.1V/100K | 84 | 2.50 |
| SLD10D50S390MTT | 39 \pm 20% | 0.1V/100K | 106 | 2.25 |
| SLD10D50S470MTT | 47 \pm 20% | 0.1V/100K | 130 | 2.00 |
| SLD10D50S560MTT | 56 \pm 20% | 0.1V/100K | 149 | 1.90 |
| SLD10D50S680MTT | 68 \pm 20% | 0.1V/100K | 201 | 1.60 |
| SLD10D50S820MTT | 82 \pm 20% | 0.1V/100K | 227 | 1.45 |
| SLD10D50S101MTT | 100 \pm 20% | 0.1V/100K | 253 | 1.35 |
| SLD10D50S121MTT | 120 \pm 20% | 0.1V/100K | 303 | 1.18 |
| SLD10D50S151MTT | 150 \pm 20% | 0.1V/100K | 370 | 1.10 |
| SLD10D50S181MTT | 180 \pm 20% | 0.1V/100K | 419 | 1.00 |
| SLD10D50S221MTT | 220 \pm 20% | 0.1V/100K | 500 | 0.94 |
| SLD10D50S271MTT | 270 \pm 20% | 0.1V/100K | 672 | 0.80 |
| SLD10D50S331MTT | 330 \pm 20% | 0.1V/100K | 812 | 0.73 |
| SLD10D50S391MTT | 390 \pm 20% | 0.1V/100K | 953 | 0.70 |
| SLD10D50S471MTT | 470 \pm 20% | 0.1V/100K | 1289 | 0.54 |
| SLD10D50S561MTT | 560 \pm 20% | 0.1V/100K | 1430 | 0.52 |
| SLD10D50S681MTT | 680 \pm 20% | 0.1V/100K | 1599 | 0.51 |
| SLD10D50S821MTT | 820 \pm 20% | 0.1V/100K | 1768 | 0.48 |
| SLD10D50S102MTT | 1000 \pm 20% | 0.1V/100K | 1989 | 0.42 |

◆ Note

1. Inductance measured by LCR Meter HP 4284A or equivalent.
2. DCR measured by Milliohm meter HP 4338B or equivalent.
3. Rated current is measured by LCR-meter 3260B (WK) & DC Bias 3265B(WK).
4. Maximum allowable DC current is that which causes a 25% inductance reduction from the initial value, or coil temperature to rise by 40°C, whichever is smaller. (Reference ambient temperature 25°C).

X-ON Electronics

Largest Supplier of Electrical and Electronic Components

Click to view similar products for [Fixed Inductors](#) category:

Click to view products by [Sunltech](#) manufacturer:

Other Similar products are found below :

[CR43NP-680KC](#) [CR54NP-470LC](#) [CR54NP-820KC](#) [CR54NP-8R5MC](#) [70F224AI](#) [MGDQ4-00004-P](#) [MHL1ECTTP18NJ](#) [MHQ1005P10NJ](#)
[MHQ1005P1N0S](#) [MHQ1005P2N4S](#) [MHQ1005P3N6S](#) [MHQ1005P5N1S](#) [MHQ1005P8N2J](#) [PE-51506NL](#) [PE-53601NL](#) [PE-53602NL](#) [PE-53630NL](#) [PE-53824SNLT](#) [PE-92100NL](#) [PG0434.801NLT](#) [PG0936.113NLT](#) [9220-20](#) [9310-16](#) [PM06-2N7](#) [PM06-39NJ](#) [A01TK](#) [1206CS-471XJ](#) [HC2LP-R47-R](#) [HC2-R47-R](#) [HC3-2R2-R](#) [HC3-R50-R](#) [HC8-1R2-R](#) [HCF1305-3R3-R](#) [1206CS-151XG](#) [RCH664NP-140L](#) [RCH664NP-4R7M](#) [RCH8011NP-221L](#) [RCP1317NP-332L](#) [RCP1317NP-391L](#) [RCR1010NP-470M](#) [RCR110DNP-331L](#) [DH2280-4R7M](#) [DS1608C-106](#)
[ASPI-4020HI-R10M-T](#) [B10TJ](#) [B82498B3101J000](#) [ELJ-RE27NJF2](#) [1812CS-153XJ](#) [1812CS-183XJ](#) [1812CS-223XJ](#)