

Drum Core Surface Mount Unshielded Power Inductors

◆ Features

1. Excellent solderability and high heat resistance.
2. Excellent terminal strength construction.
3. Packed in embossed carrier tape and can be used by automatic mounting machine.



◆ Applications

Power supply for VCR,OA equipment ,LCD television set notebook, DC to DC converters, DC to AC inverters etc.



◆ Shape & Dimensions

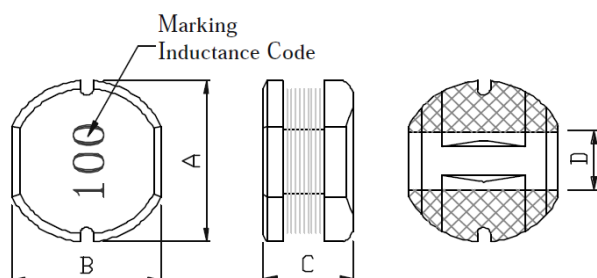

◆ Lead Free Part Numbering

SLF 0403 100 M T T

(1) (2) (3) (4) (5) (6)

- (1) Series Type
- (2) Dimension: A X C
- (3) Inductance: 2R2=2.2 μ H ;
100=10 μ H; 101=100 μ H
- (4) Inductance Tolerance: K= \pm 10%, M= \pm 20%
- (5) Company Code
- (6) Packaging : packed in embossed carrier tape

| Series Item | SLF0301 | SLF0302 | SLF0403 | SLF0502 | SLF0503 | SLF0504 | SLF0703 | SLF0705 | SLF1004 | SLF1005 |
|-------------|---------------|---------------|---------------|---------------|---------------|---------------|---------------|---------------|----------------|----------------|
| A (mm) | 3.5 \pm 0.3 | 3.5 \pm 0.3 | 4.5 \pm 0.3 | 5.8 \pm 0.3 | 5.8 \pm 0.3 | 5.8 \pm 0.3 | 7.8 \pm 0.3 | 7.8 \pm 0.3 | 10.0 \pm 0.3 | 10.0 \pm 0.3 |
| B (mm) | 3.0 \pm 0.3 | 3.0 \pm 0.3 | 4.0 \pm 0.3 | 5.2 \pm 0.3 | 5.2 \pm 0.3 | 5.2 \pm 0.3 | 7.0 \pm 0.3 | 7.0 \pm 0.3 | 9.0 \pm 0.3 | 9.0 \pm 0.3 |
| C (mm) | 1.1 \pm 0.3 | 2.1 \pm 0.3 | 3.2 \pm 0.3 | 2.0 \pm 0.3 | 3.0 \pm 0.3 | 4.5 \pm 0.3 | 3.5 \pm 0.3 | 5.0 \pm 0.3 | 4.0 \pm 0.3 | 5.4 \pm 0.3 |
| D (mm) | 1.0 Typ | 1.0 Typ | 1.2 Typ. | 1.5 Typ. | 1.5 Typ. | 1.5 Typ. | 2.1 Typ. | 2.1 Typ. | 2.9 Typ. | 2.9 Typ. |

◆ Material

| Item | Material |
|-------------|-----------------------|
| a. Core | Ferrite DR Core |
| b. Wire | Enamelled Copper wire |
| c. Terminal | Ag+Sn+SnPb |

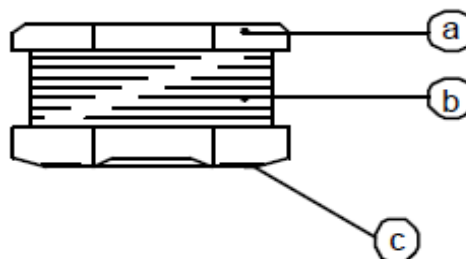

◆ Note

- (1) Inductance is measured by LCR-meter 4284A/4286A (HP) or equivalent.
- (2) Inductance test condition: SLF0301/0302L/0502:100KHz/1.0V,
SLF0302/0403/0503/0504/0703/0705/1004/1005: 1.0 μ H~8.2H:7.96MHz/0.5V,
10.0 μ H~82.0 μ H:2.52MTTHz/0.5V,More than 100.0 μ H at 1.0KHz/1.0V.
- (3) DC Resistance is measured by HP4338B Milliohms Meter or equivalent.
- (4) Rated current is measured by LCR-meter 3260B (WK) & DC Bias 3265B(WK) at 1.0KHz/1.0V.
- (5) Maximum allowable DC current is that which causes a 10% inductance reduction from the initial value, or coil temperature to rise by 40°C, whichever is smaller. (Reference ambient temperature 20°C).
- (6) Operating temperature -55°C ~ +125°C.
- (7) All test data is referenced to 25°C ambient.

◆ Specification

| Part Number | Inductance (μ H) | DCR (Ω) max. | IDC (A) max. |
|------------------------|-----------------------|-----------------------|--------------|
| SLF0301 Series: | | | |
| SLF0301-1R0MTT | 1.00 \pm 20% | 0.083 | 1.40 |
| SLF0301-1R2MTT | 1.20 \pm 20% | 0.099 | 1.24 |
| SLF0301-1R5MTT | 1.50 \pm 20% | 0.128 | 1.06 |
| SLF0301-1R8MTT | 1.80 \pm 20% | 0.145 | 0.96 |
| SLF0301-2R2MTT | 2.20 \pm 20% | 0.190 | 0.88 |
| SLF0301-2R7MTT | 2.70 \pm 20% | 0.225 | 0.80 |
| SLF0301-3R3MTT | 3.30 \pm 20% | 0.270 | 0.79 |
| SLF0301-3R9MTT | 3.90 \pm 20% | 0.321 | 0.68 |
| SLF0301-4R7MTT | 4.70 \pm 20% | 0.376 | 0.66 |
| SLF0301-5R6MTT | 5.60 \pm 20% | 0.393 | 0.61 |
| SLF0301-6R8MTT | 6.80 \pm 20% | 0.485 | 0.56 |
| SLF0301-8R2MTT | 8.20 \pm 20% | 0.628 | 0.50 |
| SLF0301-100MTT | 10.0 \pm 20% | 0.809 | 0.45 |
| SLF0301-120MTT | 12.0 \pm 20% | 0.901 | 0.40 |
| SLF0301-150MTT | 15.0 \pm 20% | 1.063 | 0.37 |
| SLF0301-180MTT | 18.0 \pm 20% | 1.231 | 0.34 |
| SLF0301-220MTT | 22.0 \pm 20% | 1.750 | 0.31 |
| SLF0301-270MTT | 27.0 \pm 20% | 2.110 | 0.28 |
| SLF0301-330MTT | 33.0 \pm 20% | 2.888 | 0.24 |
| SLF0301-390MTT | 39.0 \pm 20% | 3.100 | 0.23 |
| SLF0301-470MTT | 47.0 \pm 20% | 3.513 | 0.21 |
| SLF0301-560MTT | 56.0 \pm 20% | 3.950 | 0.20 |
| SLF0301-680MTT | 68.0 \pm 20% | 5.688 | 0.18 |
| SLF0301-820MTT | 82.0 \pm 20% | 6.575 | 0.15 |
| SLF0301-101KTT | 100.0 \pm 10% | 7.700 | 0.14 |

◆ Specification

| Part Number | Inductance (μ H) | DCR (Ω) max. | IDC (A) max. |
|------------------------|--------------------------|--------------------------|-----------------|
| SLF0302 Series: | | | |
| SLF0302-1R0MTT | 1.0 \pm 20% | 0.040 | 1.50 |
| SLF0302-1R4MTT | 1.4 \pm 20% | 0.050 | 1.50 |
| SLF0302-1R8MTT | 1.8 \pm 20% | 0.060 | 0.80 |
| SLF0302-2R2MTT | 2.2 \pm 20% | 0.080 | 0.75 |
| SLF0302-2R7MTT | 2.7 \pm 20% | 0.100 | 0.75 |
| SLF0302-3R3MTT | 3.3 \pm 20% | 0.150 | 0.60 |
| SLF0302-3R9MTT | 3.9 \pm 20% | 0.200 | 0.50 |
| SLF0302-4R7MTT | 4.7 \pm 20% | 0.200 | 0.50 |
| SLF0302-5R6MTT | 5.6 \pm 20% | 0.230 | 0.45 |
| SLF0302-6R8MTT | 6.8 \pm 20% | 0.250 | 0.40 |
| SLF0302-8R2MTT | 8.2 \pm 20% | 0.300 | 0.40 |
| SLF0302-100MTT | 10 \pm 20% | 0.350 | 0.35 |
| SLF0302-120MTT | 12 \pm 20% | 0.400 | 0.35 |
| SLF0302-150MTT | 15 \pm 20% | 0.500 | 0.30 |
| SLF0302-180MTT | 18 \pm 20% | 0.550 | 0.30 |
| SLF0302-220MTT | 22 \pm 20% | 0.600 | 0.30 |
| SLF0302-270MTT | 27 \pm 20% | 0.700 | 0.30 |
| SLF0302-330MTT | 33 \pm 20% | 1.000 | 0.25 |
| SLF0302-390MTT | 39 \pm 20% | 1.200 | 0.25 |
| SLF0302-470MTT | 47 \pm 20% | 1.500 | 0.20 |
| SLF0302-560MTT | 56 \pm 20% | 1.800 | 0.20 |
| SLF0302-680MTT | 68 \pm 20% | 2.000 | 0.18 |
| SLF0302-820MTT | 82 \pm 20% | 2.500 | 0.16 |
| SLF0302-101KTT | 100 \pm 10% | 3.000 | 0.15 |
| SLF0302-121KTT | 120 \pm 10% | 3.500 | 0.14 |
| SLF0302-151KTT | 150 \pm 10% | 4.000 | 0.13 |
| SLF0302-181KTT | 180 \pm 10% | 5.000 | 0.12 |
| SLF0302-221KTT | 220 \pm 10% | 5.500 | 0.10 |
| SLF0302-271KTT | 270 \pm 10% | 6.000 | 0.10 |
| SLF0302-331KTT | 330 \pm 10% | 7.000 | 0.10 |
| SLF0302-391KTT | 390 \pm 10% | 8.000 | 0.10 |
| SLF0302-471KTT | 470 \pm 10% | 12.000 | 0.09 |

◆ Specification

| Part Number | Inductance (μ H) | DCR (Ω) max. | IDC (A) max. |
|------------------------|--------------------------|--------------------------|-----------------|
| SLF0403 Series: | | | |
| SLF0403-1R0MTT | 1.00 \pm 20% | 0.033 | 3.80 |
| SLF0403-1R4MTT | 1.40 \pm 20% | 0.038 | 3.30 |
| SLF0403-1R8MTT | 1.80 \pm 20% | 0.042 | 2.91 |
| SLF0403-2R2MTT | 2.20 \pm 20% | 0.047 | 2.60 |
| SLF0403-2R7MTT | 2.70 \pm 20% | 0.052 | 2.43 |
| SLF0403-3R3MTT | 3.30 \pm 20% | 0.058 | 2.15 |
| SLF0403-3R9MTT | 3.90 \pm 20% | 0.076 | 1.98 |
| SLF0403-4R7MTT | 4.70 \pm 20% | 0.094 | 1.70 |
| SLF0403-5R6MTT | 5.60 \pm 20% | 0.101 | 1.60 |
| SLF0403-6R8MTT | 6.80 \pm 20% | 0.117 | 1.41 |
| SLF0403-8R2MTT | 8.20 \pm 20% | 0.132 | 1.26 |
| SLF0403-100MTT | 10.0 \pm 20% | 0.182 | 1.15 |
| SLF0403-120MTT | 12.0 \pm 20% | 0.210 | 1.05 |
| SLF0403-150MTT | 15.0 \pm 20% | 0.235 | 0.92 |
| SLF0403-180MTT | 18.0 \pm 20% | 0.338 | 0.84 |
| SLF0403-220MTT | 22.0 \pm 20% | 0.378 | 0.76 |
| SLF0403-270MTT | 27.0 \pm 20% | 0.522 | 0.71 |
| SLF0403-330MTT | 33.0 \pm 20% | 0.540 | 0.64 |
| SLF0403-390MTT | 39.0 \pm 20% | 0.587 | 0.59 |
| SLF0403-470MTT | 47.0 \pm 20% | 0.844 | 0.54 |
| SLF0403-560MTT | 56.0 \pm 20% | 0.937 | 0.50 |
| SLF0403-680MTT | 68.0 \pm 20% | 1.117 | 0.46 |
| SLF0403-820MTT | 82.0 \pm 20% | 1.345 | 0.45 |
| SLF0403-101KTT | 100.0 \pm 10% | 1.520 | 0.44 |
| SLF0403-121KTT | 120.0 \pm 10% | 1.800 | 0.43 |
| SLF0403-151KTT | 150.0 \pm 10% | 2.000 | 0.42 |
| SLF0403-181KTT | 180.0 \pm 10% | 3.200 | 0.38 |
| SLF0403-221KTT | 220.0 \pm 10% | 3.400 | 0.36 |
| SLF0403-271KTT | 270.0 \pm 10% | 3.900 | 0.34 |
| SLF0403-331KTT | 330.0 \pm 10% | 5.300 | 0.28 |
| SLF0403-391KTT | 390.0 \pm 10% | 5.900 | 0.24 |
| SLF0403-471KTT | 470.0 \pm 10% | 6.800 | 0.21 |
| SLF0403-561KTT | 560.0 \pm 10% | 8.500 | 0.20 |
| SLF0403-681KTT | 680.0 \pm 10% | 10.000 | 0.18 |
| SLF0403-821KTT | 820.0 \pm 10% | 13.400 | 0.15 |
| SLF0403-102KTT | 1000.0 \pm 10% | 15.600 | 0.14 |

◆ Specification

| Part Number | Inductance (μ H) | DCR (Ω) max. | IDC (A) max. |
|------------------------|--------------------------|--------------------------|-----------------|
| SLF0502 Series: | | | |
| SLF0502-1R0MTT | 1.00 \pm 20% | 0.045 | 4.50 |
| SLF0502-1R2MTT | 1.20 \pm 20% | 0.050 | 4.20 |
| SLF0502-1R5MTT | 1.50 \pm 20% | 0.060 | 4.00 |
| SLF0502-1R8MTT | 1.80 \pm 20% | 0.065 | 3.70 |
| SLF0502-2R2MTT | 2.20 \pm 20% | 0.070 | 3.50 |
| SLF0502-2R7MTT | 2.70 \pm 20% | 0.080 | 3.20 |
| SLF0502-3R3MTT | 3.30 \pm 20% | 0.100 | 2.70 |
| SLF0502-3R9MTT | 3.90 \pm 20% | 0.120 | 2.40 |
| SLF0502-4R7MTT | 4.70 \pm 20% | 0.140 | 2.00 |
| SLF0502-5R6MTT | 5.60 \pm 20% | 0.150 | 1.80 |
| SLF0502-6R8MTT | 6.80 \pm 20% | 0.160 | 1.50 |
| SLF0502-8R2MTT | 8.20 \pm 20% | 0.170 | 1.40 |
| SLF0502-100MTT | 10.0 \pm 20% | 0.200 | 1.30 |
| SLF0502-120MTT | 12.0 \pm 20% | 0.230 | 1.10 |
| SLF0502-150MTT | 15.0 \pm 20% | 0.250 | 1.05 |
| SLF0502-180MTT | 18.0 \pm 20% | 0.300 | 1.00 |
| SLF0502-220MTT | 22.0 \pm 20% | 0.350 | 0.90 |
| SLF0502-270MTT | 27.0 \pm 20% | 0.400 | 0.85 |
| SLF0502-330MTT | 33.0 \pm 20% | 0.500 | 0.75 |
| SLF0502-390MTT | 39.0 \pm 20% | 0.550 | 0.70 |
| SLF0502-470MTT | 47.0 \pm 20% | 0.650 | 0.60 |
| SLF0502-560MTT | 56.0 \pm 20% | 0.750 | 0.55 |
| SLF0502-680MTT | 68.0 \pm 20% | 0.950 | 0.50 |
| SLF0502-820MTT | 82.0 \pm 20% | 1.200 | 0.45 |
| SLF0502-101KTT | 100.0 \pm 10% | 1.400 | 0.40 |
| SLF0502-121KTT | 120.0 \pm 10% | 1.750 | 0.35 |
| SLF0502-151KTT | 150.0 \pm 10% | 2.000 | 0.25 |
| SLF0502-181KTT | 180.0 \pm 10% | 2.600 | 0.22 |
| SLF0502-221KTT | 220.0 \pm 10% | 3.000 | 0.20 |
| SLF0502-271KTT | 270.0 \pm 10% | 3.700 | 0.18 |
| SLF0502-331KTT | 330.0 \pm 10% | 4.300 | 0.17 |
| SLF0502-391KTT | 390.0 \pm 10% | 6.000 | 0.16 |
| SLF0502-471KTT | 470.0 \pm 10% | 6.700 | 0.15 |
| SLF0502-561KTT | 560.0 \pm 10% | 8.150 | 0.14 |
| SLF0502-681KTT | 680.0 \pm 10% | 8.980 | 0.13 |
| SLF0502-821KTT | 820.0 \pm 10% | 11.240 | 0.12 |
| SLF0502-102KTT | 1000.0 \pm 10% | 15.250 | 0.11 |
| SLF0502-122KTT | 1200.0 \pm 10% | 16.750 | 0.10 |

◆ Specification

| Part Number | Inductance (μ H) | DCR (Ω) max. | IDC (A) max. |
|------------------------|--------------------------|--------------------------|-----------------|
| SLF0503 Series: | | | |
| SLF0503-1R0MTT | 1.00 \pm 20% | 0.030 | 4.50 |
| SLF0503-1R2MTT | 1.20 \pm 20% | 0.030 | 4.20 |
| SLF0503-1R5MTT | 1.50 \pm 20% | 0.030 | 4.10 |
| SLF0503-1R8MTT | 1.80 \pm 20% | 0.030 | 3.70 |
| SLF0503-2R2MTT | 2.20 \pm 20% | 0.030 | 3.50 |
| SLF0503-2R7MTT | 2.70 \pm 20% | 0.040 | 3.20 |
| SLF0503-3R3MTT | 3.30 \pm 20% | 0.050 | 2.80 |
| SLF0503-3R9MTT | 3.90 \pm 20% | 0.060 | 2.60 |
| SLF0503-4R7MTT | 4.70 \pm 20% | 0.070 | 2.50 |
| SLF0503-5R6MTT | 5.60 \pm 20% | 0.080 | 2.40 |
| SLF0503-6R8MTT | 6.80 \pm 20% | 0.090 | 2.20 |
| SLF0503-8R2MTT | 8.20 \pm 20% | 0.100 | 2.00 |
| SLF0503-100MTT | 10.0 \pm 20% | 0.120 | 1.80 |
| SLF0503-120MTT | 12.0 \pm 20% | 0.130 | 1.75 |
| SLF0503-150MTT | 15.0 \pm 20% | 0.150 | 1.70 |
| SLF0503-180MTT | 18.0 \pm 20% | 0.180 | 1.60 |
| SLF0503-220MTT | 22.0 \pm 20% | 0.220 | 1.50 |
| SLF0503-270MTT | 27.0 \pm 20% | 0.240 | 1.40 |
| SLF0503-330MTT | 33.0 \pm 20% | 0.300 | 1.10 |
| SLF0503-390MTT | 39.0 \pm 20% | 0.400 | 1.00 |
| SLF0503-470MTT | 47.0 \pm 20% | 0.430 | 0.90 |
| SLF0503-560MTT | 56.0 \pm 20% | 0.500 | 0.85 |
| SLF0503-680MTT | 68.0 \pm 20% | 0.600 | 0.80 |
| SLF0503-820MTT | 82.0 \pm 20% | 0.800 | 0.65 |
| SLF0503-101KTT | 100.0 \pm 10% | 0.900 | 0.60 |
| SLF0503-121KTT | 120.0 \pm 10% | 1.000 | 0.58 |
| SLF0503-151KTT | 150.0 \pm 10% | 1.300 | 0.43 |
| SLF0503-181KTT | 180.0 \pm 10% | 1.500 | 0.41 |
| SLF0503-221KTT | 220.0 \pm 10% | 2.000 | 0.38 |
| SLF0503-271KTT | 270.0 \pm 10% | 2.500 | 0.35 |
| SLF0503-331KTT | 330.0 \pm 10% | 3.200 | 0.28 |
| SLF0503-391KTT | 390.0 \pm 10% | 3.500 | 0.26 |
| SLF0503-471KTT | 470.0 \pm 10% | 4.200 | 0.20 |
| SLF0503-561KTT | 560.0 \pm 10% | 4.500 | 0.19 |
| SLF0503-681KTT | 680.0 \pm 10% | 6.000 | 0.18 |
| SLF0503-821KTT | 820.0 \pm 10% | 6.500 | 0.15 |
| SLF0503-102KTT | 1000.0 \pm 10% | 8.000 | 0.13 |
| SLF0503-122KTT | 1200.0 \pm 10% | 12.500 | 0.12 |

◆ Specification

| Part Number | Inductance (μ H) | DCR (Ω) max. | IDC (A) max. |
|------------------------|--------------------------|--------------------------|-----------------|
| SLF0504 Series: | | | |
| SLF0504-1R0MTT | 1.00 \pm 20% | 0.015 | 5.900 |
| SLF0504-1R2MTT | 1.20 \pm 20% | 0.020 | 5.200 |
| SLF0504-1R5MTT | 1.50 \pm 20% | 0.025 | 4.700 |
| SLF0504-1R8MTT | 1.80 \pm 20% | 0.030 | 4.000 |
| SLF0504-2R2MTT | 2.20 \pm 20% | 0.035 | 3.800 |
| SLF0504-2R7MTT | 2.70 \pm 20% | 0.040 | 3.400 |
| SLF0504-3R3MTT | 3.30 \pm 20% | 0.045 | 3.300 |
| SLF0504-3R9MTT | 3.90 \pm 20% | 0.050 | 2.900 |
| SLF0504-4R7MTT | 4.70 \pm 20% | 0.060 | 2.800 |
| SLF0504-5R6MTT | 5.60 \pm 20% | 0.070 | 2.400 |
| SLF0504-6R8MTT | 6.80 \pm 20% | 0.080 | 2.100 |
| SLF0504-8R2MTT | 8.20 \pm 20% | 0.090 | 2.000 |
| SLF0504-100MTT | 10.0 \pm 20% | 0.100 | 1.440 |
| SLF0504-120MTT | 12.0 \pm 20% | 0.120 | 1.400 |
| SLF0504-150MTT | 15.0 \pm 20% | 0.140 | 1.300 |
| SLF0504-180MTT | 18.0 \pm 20% | 0.150 | 1.230 |
| SLF0504-220MTT | 22.0 \pm 20% | 0.180 | 1.110 |
| SLF0504-270MTT | 27.0 \pm 20% | 0.200 | 0.970 |
| SLF0504-330MTT | 33.0 \pm 20% | 0.230 | 0.880 |
| SLF0504-390MTT | 39.0 \pm 20% | 0.320 | 0.800 |
| SLF0504-470MTT | 47.0 \pm 20% | 0.370 | 0.720 |
| SLF0504-560MTT | 56.0 \pm 20% | 0.420 | 0.680 |
| SLF0504-680MTT | 68.0 \pm 20% | 0.460 | 0.610 |
| SLF0504-820MTT | 82.0 \pm 20% | 0.600 | 0.580 |
| SLF0504-101MTT | 100.0 \pm 20% | 0.700 | 0.520 |
| SLF0504-121MTT | 120.0 \pm 20% | 0.930 | 0.480 |
| SLF0504-151MTT | 150.0 \pm 20% | 1.100 | 0.400 |
| SLF0504-181MTT | 180.0 \pm 20% | 1.380 | 0.380 |
| SLF0504-221MTT | 220.0 \pm 20% | 1.570 | 0.350 |
| SLF0504-271KTT | 270.0 \pm 10% | 1.650 | 0.320 |
| SLF0504-331KTT | 330.0 \pm 10% | 1.700 | 0.280 |
| SLF0504-391KTT | 390.0 \pm 10% | 1.800 | 0.260 |
| SLF0504-471KTT | 470.0 \pm 10% | 2.300 | 0.230 |
| SLF0504-561KTT | 560.0 \pm 10% | 2.500 | 0.200 |
| SLF0504-681KTT | 680.0 \pm 10% | 3.000 | 0.190 |
| SLF0504-821KTT | 820.0 \pm 10% | 4.500 | 0.160 |
| SLF0504-102KTT | 1000.0 \pm 10% | 4.800 | 0.140 |

◆ Specification

| Part Number | Inductance (μ H) | DCR (Ω) max. | IDC (A) max. |
|------------------------|--------------------------|--------------------------|-----------------|
| SLF0703 Series: | | | |
| SLF0703-1R0MTT | 1.00 \pm 20% | 0.030 | 8.85 |
| SLF0703-1R2MTT | 1.20 \pm 20% | 0.040 | 7.85 |
| SLF0703-1R5MTT | 1.50 \pm 20% | 0.050 | 6.96 |
| SLF0703-1R8MTT | 1.80 \pm 20% | 0.050 | 5.46 |
| SLF0703-2R2MTT | 2.20 \pm 20% | 0.050 | 4.88 |
| SLF0703-2R7MTT | 2.70 \pm 20% | 0.060 | 4.32 |
| SLF0703-3R3MTT | 3.30 \pm 20% | 0.060 | 3.71 |
| SLF0703-3R9MTT | 3.90 \pm 20% | 0.060 | 3.70 |
| SLF0703-4R7MTT | 4.70 \pm 20% | 0.070 | 3.52 |
| SLF0703-5R6MTT | 5.60 \pm 20% | 0.070 | 2.86 |
| SLF0703-6R8MTT | 6.80 \pm 20% | 0.080 | 2.55 |
| SLF0703-8R2MTT | 8.20 \pm 20% | 0.080 | 2.44 |
| SLF0703-100MTT | 10.0 \pm 20% | 0.080 | 1.44 |
| SLF0703-120MTT | 12.0 \pm 20% | 0.090 | 1.39 |
| SLF0703-150MTT | 15.0 \pm 20% | 0.100 | 1.24 |
| SLF0703-180MTT | 18.0 \pm 20% | 0.110 | 1.12 |
| SLF0703-220MTT | 22.0 \pm 20% | 0.130 | 1.07 |
| SLF0703-270MTT | 27.0 \pm 20% | 0.150 | 0.94 |
| SLF0703-330MTT | 33.0 \pm 20% | 0.170 | 0.85 |
| SLF0703-390MTT | 39.0 \pm 20% | 0.220 | 0.74 |
| SLF0703-470MTT | 47.0 \pm 20% | 0.250 | 0.68 |
| SLF0703-560MTT | 56.0 \pm 20% | 0.280 | 0.64 |
| SLF0703-680MTT | 68.0 \pm 20% | 0.330 | 0.59 |
| SLF0703-820MTT | 82.0 \pm 20% | 0.410 | 0.54 |
| SLF0703-101KTT | 100.0 \pm 10% | 0.480 | 0.51 |
| SLF0703-121KTT | 120.0 \pm 10% | 0.540 | 0.49 |
| SLF0703-151KTT | 150.0 \pm 10% | 0.750 | 0.40 |
| SLF0703-181KTT | 180.0 \pm 10% | 1.020 | 0.36 |
| SLF0703-221KTT | 220.0 \pm 10% | 1.200 | 0.31 |
| SLF0703-271KTT | 270.0 \pm 10% | 1.310 | 0.29 |
| SLF0703-331KTT | 330.0 \pm 10% | 1.500 | 0.28 |
| SLF0703-391KTT | 390.0 \pm 10% | 1.800 | 0.26 |
| SLF0703-471KTT | 470.0 \pm 10% | 1.950 | 0.23 |
| SLF0703-561KTT | 560.0 \pm 10% | 2.300 | 0.21 |
| SLF0703-681KTT | 680.0 \pm 10% | 2.700 | 0.13 |
| SLF0703-821KTT | 820.0 \pm 10% | 3.200 | 0.11 |
| SLF0703-102KTT | 1000.0 \pm 10% | 3.800 | 0.08 |

◆ Specification

| Part Number | Inductance (μ H) | DCR (Ω) max. | IDC (A) max. |
|------------------------|--------------------------|--------------------------|-----------------|
| SLF0705 Series: | | | |
| SLF0705-1R0MTT | 1.00 \pm 20% | 0.030 | 11.25 |
| SLF0705-1R2MTT | 1.20 \pm 20% | 0.030 | 9.87 |
| SLF0705-1R5MTT | 1.50 \pm 20% | 0.040 | 8.35 |
| SLF0705-1R8MTT | 1.80 \pm 20% | 0.040 | 7.12 |
| SLF0705-2R2MTT | 2.20 \pm 20% | 0.050 | 6.52 |
| SLF0705-2R7MTT | 2.70 \pm 20% | 0.060 | 6.06 |
| SLF0705-3R3MTT | 3.30 \pm 20% | 0.060 | 5.26 |
| SLF0705-3R9MTT | 3.90 \pm 20% | 0.060 | 4.68 |
| SLF0705-4R7MTT | 4.70 \pm 20% | 0.070 | 4.54 |
| SLF0705-5R6MTT | 5.60 \pm 20% | 0.070 | 4.25 |
| SLF0705-6R8MTT | 6.80 \pm 20% | 0.070 | 3.45 |
| SLF0705-8R2MTT | 8.20 \pm 20% | 0.070 | 3.10 |
| SLF0705-100MTT | 10.0 \pm 20% | 0.070 | 2.30 |
| SLF0705-120MTT | 12.0 \pm 20% | 0.080 | 2.00 |
| SLF0705-150MTT | 15.0 \pm 20% | 0.090 | 1.80 |
| SLF0705-180MTT | 18.0 \pm 20% | 0.100 | 1.60 |
| SLF0705-220MTT | 22.0 \pm 20% | 0.110 | 1.50 |
| SLF0705-270MTT | 27.0 \pm 20% | 0.120 | 1.30 |
| SLF0705-330MTT | 33.0 \pm 20% | 0.130 | 1.20 |
| SLF0705-390MTT | 39.0 \pm 20% | 0.160 | 1.10 |
| SLF0705-470MTT | 47.0 \pm 20% | 0.180 | 1.10 |
| SLF0705-560MTT | 56.0 \pm 20% | 0.240 | 0.94 |
| SLF0705-680MTT | 68.0 \pm 20% | 0.280 | 0.85 |
| SLF0705-820MTT | 82.0 \pm 20% | 0.370 | 0.78 |
| SLF0705-101KTT | 100.0 \pm 10% | 0.430 | 0.72 |
| SLF0705-121KTT | 120.0 \pm 10% | 0.470 | 0.66 |
| SLF0705-151KTT | 150.0 \pm 10% | 0.640 | 0.58 |
| SLF0705-181KTT | 180.0 \pm 10% | 0.710 | 0.51 |
| SLF0705-221KTT | 220.0 \pm 10% | 0.960 | 0.49 |
| SLF0705-271KTT | 270.0 \pm 10% | 1.110 | 0.42 |
| SLF0705-331KTT | 330.0 \pm 10% | 1.260 | 0.40 |
| SLF0705-391KTT | 390.0 \pm 10% | 1.770 | 0.36 |
| SLF0705-471KTT | 470.0 \pm 10% | 1.960 | 0.34 |
| SLF0705-561KTT | 560.0 \pm 10% | 2.000 | 0.33 |
| SLF0705-681KTT | 680.0 \pm 10% | 2.200 | 0.32 |
| SLF0705-821KTT | 820.0 \pm 10% | 2.900 | 0.25 |
| SLF0705-102KTT | 1000.0 \pm 10% | 3.900 | 0.20 |

◆ Specification

| Part Number | Inductance (μ H) | DCR (Ω) max. | IDC (A) max. |
|------------------------|--------------------------|--------------------------|-----------------|
| SLF1004 Series: | | | |
| SLF1004-1R0MTT | 1.00 \pm 20% | 0.020 | 12.25 |
| SLF1004-1R5MTT | 1.50 \pm 20% | 0.030 | 9.86 |
| SLF1004-2R2MTT | 2.20 \pm 20% | 0.030 | 7.48 |
| SLF1004-3R3MTT | 3.30 \pm 20% | 0.040 | 6.21 |
| SLF1004-4R7MTT | 4.70 \pm 20% | 0.040 | 5.43 |
| SLF1004-6R8MTT | 6.80 \pm 20% | 0.053 | 4.56 |
| SLF1004-100MTT | 10.0 \pm 20% | 0.053 | 2.38 |
| SLF1004-120MTT | 12.0 \pm 20% | 0.061 | 2.13 |
| SLF1004-150MTT | 15.0 \pm 20% | 0.070 | 1.87 |
| SLF1004-180MTT | 18.0 \pm 20% | 0.081 | 1.73 |
| SLF1004-220MTT | 22.0 \pm 20% | 0.088 | 1.60 |
| SLF1004-270MTT | 27.0 \pm 20% | 0.100 | 1.44 |
| SLF1004-330MTT | 33.0 \pm 20% | 0.120 | 1.26 |
| SLF1004-390MTT | 39.0 \pm 20% | 0.151 | 1.20 |
| SLF1004-470MTT | 47.0 \pm 20% | 0.170 | 1.10 |
| SLF1004-560MTT | 56.0 \pm 20% | 0.199 | 1.01 |
| SLF1004-680MTT | 68.0 \pm 20% | 0.223 | 0.91 |
| SLF1004-820MTT | 82.0 \pm 20% | 0.252 | 0.85 |
| SLF1004-101KTT | 100.0 \pm 10% | 0.344 | 0.74 |
| SLF1004-121KTT | 120.0 \pm 10% | 0.396 | 0.69 |
| SLF1004-151KTT | 150.0 \pm 10% | 0.544 | 0.61 |
| SLF1004-181KTT | 180.0 \pm 10% | 0.621 | 0.56 |
| SLF1004-221KTT | 220.0 \pm 10% | 0.721 | 0.53 |
| SLF1004-271KTT | 270.0 \pm 10% | 0.949 | 0.45 |
| SLF1004-331KTT | 330.0 \pm 10% | 1.100 | 0.42 |
| SLF1004-391KTT | 390.0 \pm 10% | 1.245 | 0.38 |
| SLF1004-471KTT | 470.0 \pm 10% | 1.526 | 0.35 |
| SLF1004-561KTT | 560.0 \pm 10% | 1.904 | 0.32 |
| SLF1004-681KTT | 680.0 \pm 10% | 2.200 | 0.31 |
| SLF1004-821KTT | 820.0 \pm 10% | 2.700 | 0.30 |

◆ Specification

| Part Number | Inductance (μ H) | DCR (Ω) max. | IDC (A) max. |
|------------------------|--------------------------|--------------------------|-----------------|
| SLF1004 Series: | | | |
| SLF1005-1R0MTT | 1.00 \pm 20% | 0.010 | 15.35 |
| SLF1005-1R5MTT | 1.50 \pm 20% | 0.020 | 11.58 |
| SLF1005-2R2MTT | 2.20 \pm 20% | 0.020 | 9.24 |
| SLF1005-3R3MTT | 3.30 \pm 20% | 0.030 | 7.36 |
| SLF1005-4R7MTT | 4.70 \pm 20% | 0.030 | 5.67 |
| SLF1005-6R8MTT | 6.80 \pm 20% | 0.040 | 4.52 |
| SLF1005-100MTT | 10.0 \pm 20% | 0.060 | 2.60 |
| SLF1005-150MTT | 15.0 \pm 20% | 0.080 | 2.27 |
| SLF1005-220MTT | 22.0 \pm 20% | 0.100 | 1.95 |
| SLF1005-330MTT | 33.0 \pm 20% | 0.120 | 1.50 |
| SLF1005-470MTT | 47.0 \pm 20% | 0.170 | 1.28 |
| SLF1005-560MTT | 56.0 \pm 20% | 0.190 | 1.17 |
| SLF1005-680MTT | 68.0 \pm 20% | 0.220 | 1.11 |
| SLF1005-820MTT | 82.0 \pm 20% | 0.250 | 1.00 |
| SLF1005-101KTT | 100.0 \pm 10% | 0.350 | 0.97 |
| SLF1005-121KTT | 120.0 \pm 10% | 0.400 | 0.89 |
| SLF1005-151KTT | 150.0 \pm 10% | 0.470 | 0.78 |
| SLF1005-181KTT | 180.0 \pm 10% | 0.630 | 0.72 |
| SLF1005-221KTT | 220.0 \pm 10% | 0.730 | 0.66 |
| SLF1005-271KTT | 270.0 \pm 10% | 0.970 | 0.57 |
| SLF1005-331KTT | 330.0 \pm 10% | 1.150 | 0.52 |
| SLF1005-391KTT | 390.0 \pm 10% | 1.300 | 0.48 |
| SLF1005-471KTT | 470.0 \pm 10% | 1.480 | 0.42 |
| SLF1005-561KTT | 560.0 \pm 10% | 1.900 | 0.33 |
| SLF1005-681KTT | 680.0 \pm 10% | 2.250 | 0.28 |
| SLF1005-821KTT | 820.0 \pm 10% | 2.550 | 0.24 |

X-ON Electronics

Largest Supplier of Electrical and Electronic Components

Click to view similar products for [Fixed Inductors](#) category:

Click to view products by [Sunltech](#) manufacturer:

Other Similar products are found below :

[CR32NP-100KC](#) [CR32NP-151KC](#) [CR32NP-180KC](#) [CR32NP-181KC](#) [CR32NP-1R5MC](#) [CR32NP-390KC](#) [CR32NP-3R9MC](#) [CR32NP-680KC](#) [CR32NP-820KC](#) [CR32NP-8R2MC](#) [CR43NP-390KC](#) [CR43NP-560KC](#) [CR43NP-680KC](#) [CR54NP-181KC](#) [CR54NP-470LC](#) [CR54NP-820KC](#) [CR54NP-8R5MC](#) [70F224AI](#) [MGDQ4-00004-P](#) [MHL1ECTTP18NJ](#) [MHQ1005P10NJ](#) [MHQ1005P1N0S](#) [MHQ1005P2N4S](#) [MHQ1005P3N6S](#) [MHQ1005P5N1S](#) [MHQ1005P8N2J](#) [PE-51506NL](#) [PE-53601NL](#) [PE-53602NL](#) [PE-53630NL](#) [PE-53824SNLT](#) [PE-92100NL](#) [PG0434.801NLT](#) [PG0936.113NLT](#) [9220-20](#) [9310-16](#) [PM06-2N7](#) [PM06-39NJ](#) [A01TK](#) [1206CS-471XJ](#) [HC2LP-R47-R](#) [HC2-R47-R](#) [HC3-2R2-R](#) [HCF1305-3R3-R](#) [1206CS-151XG](#) [RCH664NP-140L](#) [RCH664NP-4R7M](#) [RCH8011NP-221L](#) [RCP1317NP-332L](#) [RCP1317NP-391L](#)