

◆ Features

- 1、Magnetic-resin shielded construction reduces buzz noise to ultra-low levels;
- 2、Metallization on ferrite core results in excellent shock resistance and damage-free durability;
- 3、Closed magnetic circuit design reduces leakage flux and Electro Magnetic Interference (EMI);
- 4、30% higher current rating than conventional inductors of equal size;
- 5、Take up less PCB real estate and save more power.

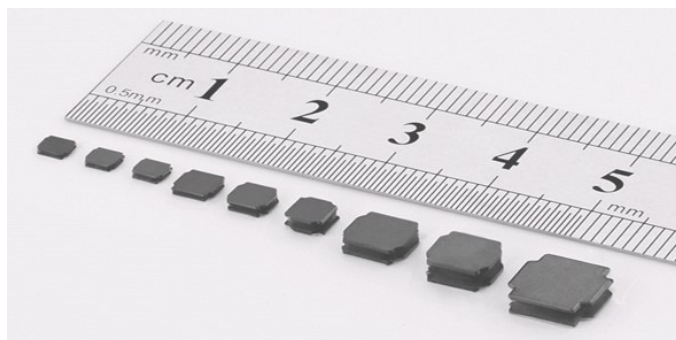

◆ Applications

- 1、LED Lighting;
- 2、Mobile devices with multifunction such as adding color TV and camera;
- 3、Flat-screen TVs, blue-ray disc recorders, set top boxes;
- 4、Notebooks, desktop computers, servers, graphic cards;
- 5、Portable gaming devices, personal navigation systems, personal multimedia devices;
- 6、Automotive systems
- 7、Telecomm base stations

◆ Lead Free Part Numbering

SLW 4020 S 100 M S T
(1) (2) (3) (4) (5) (6) (7)

- (1) Series Type
- (2) Dimension: L X H
- (3) Material Code
- (4) Inductance: 2R2=2.2 μ H ;
100=10 μ H; 101=100 μ H
- (5) Inductance Tolerance: M=±20%, N=±30%
- (6) Company Code
- (7) Packaging : Tape Carrier Package

◆ Dimensions

SLW 252010/252012 Series

Recommended Land Pattern



◆ Dimensions

SLW 30/40/50/60/80 Series

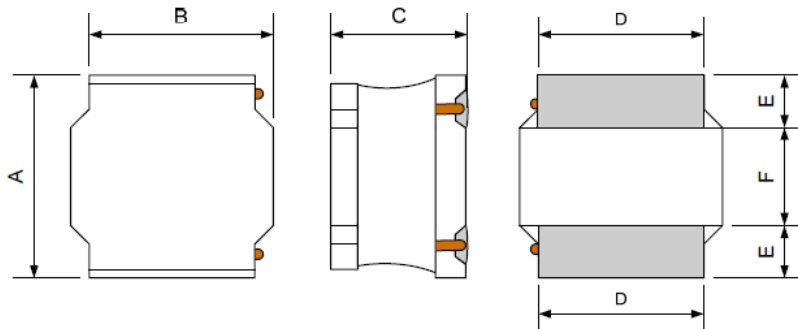

Unit:mm

| Series | A | B | C | D | E | F | a Typ. | b Typ. | c Typ. |
|-----------|---------|---------|---------|---------|----------|----------|--------|--------|--------|
| SLW252010 | 2.5±0.1 | 2.0±0.1 | 1.0Max. | 1.5±0.2 | 0.80±0.2 | 0.80±0.2 | 0.8 | 0.85 | 2.0 |
| SLW252012 | 2.5±0.1 | 2.0±0.1 | 1.2Max. | 1.5±0.2 | 0.80±0.2 | 0.80±0.2 | 0.8 | 0.85 | 2.0 |
| SLW3010 | 3.0±0.2 | 3.0±0.2 | 1.0Max. | 2.5±0.2 | 0.75±0.2 | 1.50±0.2 | 1.5 | 0.8 | 2.7 |
| SLW3012 | 3.0±0.2 | 3.0±0.2 | 1.2Max. | 2.5±0.2 | 0.75±0.2 | 1.50±0.2 | 1.5 | 0.8 | 2.7 |
| SLW3015 | 3.0±0.2 | 3.0±0.2 | 1.5Max. | 2.5±0.2 | 0.75±0.2 | 1.50±0.2 | 1.5 | 0.8 | 2.7 |
| SLW4012 | 4.0±0.2 | 4.0±0.2 | 1.2Max. | 3.3±0.2 | 0.95±0.2 | 2.10±0.2 | 1.9 | 1.1 | 3.7 |
| SLW4018 | 4.0±0.2 | 4.0±0.2 | 1.8Max. | 3.3±0.2 | 0.95±0.2 | 2.10±0.2 | 1.9 | 1.1 | 3.7 |
| SLW4020 | 4.0±0.2 | 4.0±0.2 | 2.0Max. | 3.3±0.2 | 0.95±0.2 | 2.10±0.2 | 1.9 | 1.1 | 3.7 |
| SLW4030 | 4.0±0.2 | 4.0±0.2 | 3.0Max. | 3.3±0.2 | 0.95±0.2 | 2.10±0.2 | 1.9 | 1.1 | 3.7 |
| SLW5020 | 5.0±0.2 | 5.0±0.2 | 2.0Max. | 4.0±0.2 | 1.25±0.2 | 2.50±0.2 | 2.1 | 1.5 | 4.4 |
| SLW5040 | 5.0±0.2 | 5.0±0.2 | 4.0Max. | 4.0±0.2 | 1.25±0.2 | 2.50±0.2 | 2.1 | 1.5 | 4.4 |
| SLW6020 | 6.0±0.3 | 6.0±0.3 | 2.0Max. | 4.9±0.3 | 1.55±0.3 | 2.90±0.3 | 2.8 | 1.7 | 5.7 |
| SLW6028 | 6.0±0.3 | 6.0±0.3 | 2.8Max. | 4.9±0.3 | 1.55±0.3 | 2.90±0.3 | 2.8 | 1.7 | 5.7 |
| SLW6045 | 6.0±0.3 | 6.0±0.3 | 4.5Max. | 4.9±0.3 | 1.55±0.3 | 2.90±0.3 | 2.8 | 1.7 | 5.7 |
| SLW8040 | 8.0±0.3 | 8.0±0.3 | 4.2Max. | 6.3±0.3 | 2.00±0.3 | 4.00±0.3 | 3.8 | 2.2 | 7.5 |

◆ External Dimensions(L×W×H) [mm]

| Series | L×W×H | Series | L×W×H |
|-----------|-------------|---------|-------------|
| SLW252010 | 2.5×2.0×1.0 | SLW4030 | 4.0×4.0×3.0 |
| SLW252012 | 2.5×2.0×1.2 | SLW5020 | 5.0×5.0×2.0 |
| SLW3010 | 3.0×3.0×1.0 | SLW5040 | 5.0×5.0×4.0 |
| SLW3012 | 3.0×3.0×1.2 | SLW6020 | 6.0×6.0×2.0 |
| SLW3015 | 3.0×3.0×1.5 | SLW6028 | 6.0×6.0×2.8 |
| SLW4012 | 4.0×4.0×1.2 | SLW6045 | 6.0×6.0×4.5 |
| SLW4018 | 4.0×4.0×1.8 | SLW8040 | 8.0×8.0×4.0 |
| SLW4020 | 4.0×4.0×2.0 | | |

◆ Specification

| Part Number | Inductance @100KHz,1V (μ H) | DC Resistance(Ω) | | Saturation Current(A) | | Heat Rating Current (A) |
|--------------------------|--|---------------------------|-------|-----------------------|------|----------------------------|
| | | Max. | Typ. | Min. | Typ. | Typ. |
| | | DCR | | Isat | | Irms |
| SLW252010S Series | | | | | | |
| SLW252010SR47NST | 0.47 \pm 30% | 0.054 | 0.047 | 2.50 | 3.35 | 2.75 |
| SLW252010SR68NST | 0.68 \pm 30% | 0.072 | 0.061 | 2.20 | 2.75 | 2.20 |
| SLW252010S1R0NST | 1.0 \pm 30% | 0.110 | 0.088 | 1.85 | 2.2 | 1.80 |
| SLW252010S1R5NST | 1.5 \pm 30% | 0.174 | 0.149 | 1.80 | 2.10 | 1.45 |
| SLW252010S2R2NST | 2.2 \pm 30% | 0.199 | 0.171 | 1.30 | 1.65 | 1.20 |
| SLW252010S3R3MST | 3.3 \pm 20% | 0.312 | 0.267 | 1.05 | 1.30 | 1.00 |
| SLW252010S4R7MST | 4.7 \pm 20% | 0.536 | 0.460 | 0.95 | 1.15 | 0.80 |
| SLW252010S6R8MST | 6.8 \pm 20% | 0.854 | 0.732 | 0.78 | 0.92 | 0.72 |
| SLW252010S100MST | 10 \pm 20% | 1.050 | 0.891 | 0.65 | 0.78 | 0.58 |
| SLW252012S Series | | | | | | |
| SLW252012SR47NST | 0.47 \pm 30% | 0.045 | 0.041 | 3.60 | 4.03 | 2.27 |
| SLW252012SR68NST | 0.68 \pm 30% | 0.079 | 0.072 | 3.06 | 3.43 | 1.73 |
| SLW252012S1R0NST | 1.0 \pm 30% | 0.092 | 0.083 | 2.68 | 3.00 | 1.58 |
| SLW252012S1R2NST | 1.2 \pm 30% | 0.107 | 0.097 | 2.38 | 2.67 | 1.46 |
| SLW252012S1R5MST | 1.5 \pm 20% | 0.122 | 0.110 | 2.24 | 2.51 | 1.40 |
| SLW252012S2R2MST | 2.2 \pm 20% | 0.158 | 0.130 | 1.85 | 2.10 | 1.15 |
| SLW252012S2R7MST | 2.7 \pm 20% | 0.199 | 0.181 | 1.71 | 1.92 | 1.09 |
| SLW252012S3R3MST | 3.3 \pm 20% | 0.216 | 0.196 | 1.61 | 1.80 | 1.04 |
| SLW252012S3R6MST | 3.6 \pm 20% | 0.289 | 0.263 | 1.48 | 1.66 | 0.90 |
| SLW252012S4R3MST | 4.3 \pm 20% | 0.314 | 0.284 | 1.37 | 1.53 | 0.87 |
| SLW252012S4R7MST | 4.7 \pm 20% | 0.341 | 0.299 | 1.18 | 1.32 | 0.84 |
| SLW252012S5R1MST | 5.1 \pm 20% | 0.340 | 0.309 | 1.18 | 1.32 | 0.84 |
| SLW252012S5R6MST | 5.6 \pm 20% | 0.361 | 0.327 | 1.13 | 1.26 | 0.81 |
| SLW252012S6R2MST | 6.2 \pm 20% | 0.450 | 0.409 | 1.03 | 1.16 | 0.73 |
| SLW252012S6R8MST | 6.8 \pm 20% | 0.482 | 0.438 | 0.98 | 1.09 | 0.69 |
| SLW252012S7R5MST | 7.5 \pm 20% | 0.507 | 0.460 | 0.97 | 1.09 | 0.68 |
| SLW252012S8R2MST | 8.2 \pm 20% | 0.546 | 0.495 | 0.98 | 1.10 | 0.65 |
| SLW252012S9R1MST | 9.1 \pm 20% | 0.600 | 0.540 | 0.95 | 1.06 | 0.62 |
| SLW252012S100MST | 10 \pm 20% | 0.621 | 0.564 | 0.88 | 0.97 | 0.62 |
| SLW252012S120MST | 12 \pm 20% | 0.892 | 0.810 | 0.78 | 0.87 | 0.51 |
| SLW252012S150MST | 15 \pm 20% | 1.320 | 1.200 | 0.68 | 0.76 | 0.42 |
| SLW252012S220MST | 22 \pm 20% | 1.640 | 1.480 | 0.53 | 0.59 | 0.38 |

◆ Specification

| Part Number | Inductance @100KHz, 1V (μH) | DC Resistance ±30% (Ω) | Min.Self-resonant Frequency (MHz) | Saturation Current(A) | Heat Rating Current (A) |
|------------------------|-----------------------------------|---------------------------|--------------------------------------|--------------------------|----------------------------|
| | | DCR | S.R.F | Isat | Irms |
| SLW3010S Series | | | | | |
| SLW3010S1R0NST | 1.0±30% | 0.062 | 180 | 1.51 | 1.45 |
| SLW3010S1R5NST | 1.5±30% | 0.076 | 120 | 1.37 | 1.30 |
| SLW3010S2R2NST | 2.2±30% | 0.105 | 100 | 1.24 | 1.09 |
| SLW3010S2R7NST | 2.7±30% | 0.124 | 90 | 1.08 | 1.02 |
| SLW3010S3R3NST | 3.3±30% | 0.138 | 74 | 1.05 | 0.96 |
| SLW3010S3R6MST | 3.6±20% | 0.157 | 67 | 1.03 | 0.90 |
| SLW3010S4R7MST | 4.7±20% | 0.214 | 59 | 0.82 | 0.77 |
| SLW3010S6R8MST | 6.8±20% | 0.290 | 42 | 0.71 | 0.66 |
| SLW3010S100MST | 10±20% | 0.380 | 39 | 0.62 | 0.58 |
| SLW3010S120MST | 12±20% | 0.480 | 36 | 0.55 | 0.52 |
| SLW3010S150MST | 15±20% | 0.580 | 30 | 0.49 | 0.47 |
| SLW3010S220MST | 22±20% | 0.884 | 28 | 0.38 | 0.38 |
| SLW3010S270MST | 27±20% | 1.026 | 25 | 0.32 | 0.35 |
| SLW3010S330MST | 33±20% | 1.473 | 18 | 0.31 | 0.30 |
| SLW3010S390MST | 39±20% | 1.663 | 18 | 0.30 | 0.28 |
| SLW3010S430MST | 43±20% | 1.710 | 18 | 0.25 | 0.27 |
| SLW3010S470MST | 47±20% | 1.853 | 18 | 0.24 | 0.26 |
| SLW3010S510MST | 51±20% | 2.090 | 18 | 0.23 | 0.25 |
| SLW3010S560MST | 56±20% | 2.204 | 16 | 0.23 | 0.24 |
| SLW3012S Series | | | | | |
| SLW3012SR82NST | 0.82±30% | 0.030 | 180 | 2.15 | 2.47 |
| SLW3012S1R0NST | 1.0±30% | 0.040 | 120 | 1.96 | 2.20 |
| SLW3012S1R2NST | 1.2±30% | 0.045 | 120 | 2.33 | 2.01 |
| SLW3012S1R5NST | 1.5±30% | 0.045 | 110 | 1.70 | 2.01 |
| SLW3012S1R8NST | 1.8±20% | 0.055 | 90 | 1.59 | 1.84 |
| SLW3012S2R2NST | 2.2±20% | 0.075 | 84 | 1.26 | 1.55 |
| SLW3012S2R4NST | 2.4±20% | 0.068 | 100 | 1.21 | 1.50 |
| SLW3012S2R7NST | 2.7±20% | 0.085 | 65 | 1.20 | 1.48 |
| SLW3012S3R3MST | 3.3±20% | 0.100 | 64 | 1.10 | 1.36 |
| SLW3012S4R7MST | 4.7±20% | 0.120 | 61 | 0.95 | 1.24 |
| SLW3012S6R8MST | 6.8±20% | 0.190 | 61 | 0.79 | 0.98 |
| SLW3012S100MST | 10±20% | 0.265 | 42 | 0.63 | 0.83 |
| SLW3012S120MST | 12±20% | 0.345 | 32 | 0.50 | 0.73 |
| SLW3012S150MST | 15±20% | 0.360 | 27 | 0.47 | 0.71 |
| SLW3012S180MST | 18±20% | 0.545 | 25 | 0.45 | 0.58 |

◆ Specification

| Part Number | Inductance @100KHz,1V (μ H) | DC Resistance $\pm 30\%$ (Ω) | Min.Self-resonant Frequency (MHz) | Saturation Current(A) | Heat Rating Current (A) |
|------------------------|--|--|--------------------------------------|--------------------------|----------------------------|
| | | DCR | S.R.F | Isat | Irms |
| SLW3012S Series | | | | | |
| SLW3012S220MST | 22 \pm 20% | 0.645 | 23 | 0.44 | 0.53 |
| SLW3012S270MST | 27 \pm 20% | 0.770 | 21 | 0.42 | 0.49 |
| SLW3012S330MST | 33 \pm 20% | 0.875 | 18 | 0.38 | 0.46 |
| SLW3012S360MST | 36 \pm 20% | 0.950 | 18 | 0.36 | 0.44 |
| SLW3012S390MST | 39 \pm 20% | 1.330 | 18 | 0.32 | 0.37 |
| SLW3012S470MST | 47 \pm 20% | 1.380 | 14 | 0.28 | 0.36 |
| SLW3012S560MST | 56 \pm 20% | 1.380 | 14 | 0.27 | 0.36 |
| SLW3012S620MST | 62 \pm 20% | 1.530 | 12 | 0.26 | 0.35 |
| SLW3012S680MST | 68 \pm 20% | 1.670 | 12 | 0.25 | 0.33 |
| SLW3012S820MST | 82 \pm 20% | 2.540 | 12 | 0.23 | 0.27 |
| SLW3012S101MST | 100 \pm 20% | 2.860 | 12 | 0.22 | 0.25 |
| SLW3015S Series | | | | | |
| SLW3015S1R0NST | 1.0 \pm 30% | 0.037 | 150 | 2.44 | 2.10 |
| SLW3015S1R2NST | 1.5 \pm 30% | 0.040 | 110 | 2.34 | 1.95 |
| SLW3015S1R5NST | 1.2 \pm 30% | 0.050 | 100 | 2.44 | 1.70 |
| SLW3015S1R8NST | 1.8 \pm 30% | 0.050 | 92 | 1.86 | 1.70 |
| SLW3015S2R2NST | 2.2 \pm 30% | 0.060 | 86 | 1.70 | 1.60 |
| SLW3015S2R7NST | 2.7 \pm 30% | 0.075 | 64 | 1.61 | 1.43 |
| SLW3015S3R3MST | 3.3 \pm 20% | 0.080 | 68 | 1.45 | 1.36 |
| SLW3015S3R6MST | 3.6 \pm 20% | 0.105 | 59 | 1.36 | 1.20 |
| SLW3015S4R3MST | 4.3 \pm 20% | 0.115 | 53 | 1.27 | 1.14 |
| SLW3015S4R7MST | 4.7 \pm 20% | 0.125 | 46 | 1.17 | 1.09 |
| SLW3015S5R1MST | 5.1 \pm 20% | 0.125 | 49 | 1.14 | 1.09 |
| SLW3015S6R2MST | 6.2 \pm 20% | 0.195 | 46 | 1.06 | 0.86 |
| SLW3015S6R8MST | 6.8 \pm 20% | 0.200 | 39 | 0.92 | 0.85 |
| SLW3015S100MST | 10 \pm 20% | 0.250 | 41 | 0.87 | 0.77 |
| SLW3015S120MST | 12 \pm 20% | 0.320 | 32 | 0.74 | 0.68 |
| SLW3015S150MST | 15 \pm 20% | 0.350 | 30 | 0.70 | 0.65 |
| SLW3015S180MST | 18 \pm 20% | 0.430 | 23 | 0.59 | 0.59 |
| SLW3015S220MST | 22 \pm 20% | 0.460 | 23 | 0.55 | 0.57 |
| SLW3015S330MST | 33 \pm 20% | 0.820 | 20 | 0.47 | 0.43 |
| SLW3015S390MST | 39 \pm 20% | 0.995 | 14 | 0.43 | 0.39 |
| SLW3015S430MST | 43 \pm 20% | 1.060 | 16 | 0.39 | 0.37 |
| SLW3015S470MST | 47 \pm 20% | 1.250 | 14 | 0.37 | 0.35 |
| SLW3015S560MST | 56 \pm 20% | 1.280 | 13 | 0.35 | 0.34 |

◆ Specification

| Part Number | Inductance @100KHz,1V (μ H) | DC Resistance $\pm 30\%$ (Ω) | Min.Self-resonant Frequency (MHz) | Saturation Current(A) | Heat Rating Current (A) |
|------------------------|--|--|--------------------------------------|--------------------------|----------------------------|
| | | DCR | S.R.F | Isat | Irms |
| SLW3015S Series | | | | | |
| SLW3015S620MST | 62 \pm 20% | 1.430 | 13 | 0.34 | 0.32 |
| SLW3015S680MST | 68 \pm 20% | 2.700 | 11 | 0.29 | 0.23 |
| SLW4012S Series | | | | | |
| SLW4012SR82NST | 0.82 \pm 30% | 0.050 | 150 | 3.53 | 1.65 |
| SLW4012S1R0NST | 1.0 \pm 30% | 0.050 | 120 | 2.61 | 1.65 |
| SLW4012S1R5NST | 1.5 \pm 30% | 0.065 | 90 | 2.10 | 1.46 |
| SLW4012S1R8NST | 1.8 \pm 30% | 0.080 | 88 | 2.47 | 1.32 |
| SLW4012S2R2NST | 2.2 \pm 30% | 0.080 | 74 | 1.76 | 1.32 |
| SLW4012S2R7NST | 2.7 \pm 30% | 0.090 | 71 | 1.90 | 1.25 |
| SLW4012S3R3NST | 3.3 \pm 30% | 0.113 | 60 | 1.25 | 1.12 |
| SLW4012S3R6NST | 3.6 \pm 30% | 0.110 | 57 | 1.20 | 1.12 |
| SLW4012S4R3NST | 4.3 \pm 30% | 0.140 | 54 | 1.75 | 1.00 |
| SLW4012S4R7NST | 4.7 \pm 30% | 0.125 | 50 | 1.15 | 1.05 |
| SLW4012S5R1NST | 5.1 \pm 30% | 0.155 | 50 | 1.21 | 0.95 |
| SLW4012S6R8MST | 6.8 \pm 20% | 0.198 | 40 | 0.95 | 0.84 |
| SLW4012S100MST | 10 \pm 20% | 0.265 | 33 | 0.80 | 0.77 |
| SLW4012S120MST | 12 \pm 20% | 0.290 | 32 | 0.66 | 0.70 |
| SLW4012S150MST | 15 \pm 20% | 0.340 | 25 | 0.56 | 0.64 |
| SLW4012S180MST | 18 \pm 20% | 0.470 | 23 | 0.55 | 0.55 |
| SLW4012S220MST | 22 \pm 20% | 0.470 | 20 | 0.54 | 0.55 |
| SLW4012S270MST | 27 \pm 20% | 0.720 | 18 | 0.50 | 0.45 |
| SLW4012S330MST | 33 \pm 20% | 0.810 | 17 | 0.42 | 0.42 |
| SLW4012S360MST | 36 \pm 20% | 0.900 | 14 | 0.40 | 0.40 |
| SLW4012S390MST | 39 \pm 20% | 1.100 | 16 | 0.55 | 0.37 |
| SLW4012S470MST | 47 \pm 20% | 1.100 | 12 | 0.35 | 0.37 |
| SLW4012S560MST | 56 \pm 20% | 1.250 | 11 | 0.33 | 0.33 |
| SLW4012S680MST | 68 \pm 20% | 1.460 | 11 | 0.30 | 0.31 |
| SLW4012S820MST | 82 \pm 20% | 2.140 | 11 | 0.28 | 0.26 |
| SLW4012S101MST | 100 \pm 20% | 2.210 | 9.4 | 0.25 | 0.25 |
| SLW4018S Series | | | | | |
| SLW4018S1R0NST | 1.0 \pm 30% | 0.025 | 80 | 4.80 | 2.00 |
| SLW4018S2R2MST | 2.2 \pm 20% | 0.045 | 52 | 2.70 | 1.65 |
| SLW4018S3R3MST | 3.3 \pm 20% | 0.070 | 44 | 2.45 | 1.23 |
| SLW4018S4R7MST | 4.7 \pm 20% | 0.090 | 34 | 1.70 | 1.20 |
| SLW4018S6R8MST | 6.8 \pm 20% | 0.110 | 29 | 1.45 | 1.06 |

◆ Specification

| Part Number | Inductance @100KHz,1V (μ H) | DC Resistance $\pm 30\%$ (Ω) | Min.Self-resonant Frequency (MHz) | Saturation Current(A) | Heat Rating Current (A) |
|------------------------|--|--|--------------------------------------|--------------------------|----------------------------|
| | | DCR | S.R.F | Isat | Irms |
| SLW4018S Series | | | | | |
| SLW4018S100MST | 10 \pm 20% | 0.180 | 24 | 1.30 | 0.84 |
| SLW4018S150MST | 15 \pm 20% | 0.250 | 19 | 0.94 | 0.65 |
| SLW4018S220MST | 22 \pm 20% | 0.360 | 16 | 0.80 | 0.59 |
| SLW4018S330MST | 33 \pm 20% | 0.530 | 12 | 0.65 | 0.49 |
| SLW4018S470MST | 47 \pm 20% | 0.650 | 10 | 0.57 | 0.42 |
| SLW4018S680MST | 68 \pm 20% | 1.000 | 8.3 | 0.47 | 0.32 |
| SLW4018S101MST | 100 \pm 20% | 1.750 | 6.5 | 0.40 | 0.25 |
| SLW4018S151MST | 150 \pm 20% | 2.500 | 5.5 | 0.31 | 0.22 |
| SLW4018S221MST | 220 \pm 20% | 4.000 | 4 | 0.27 | 0.17 |
| SLW4020S Series | | | | | |
| SLW4020S1R0NST | 1.0 \pm 30% | 0.029 | 75 | 4.85 | 2.15 |
| SLW4020S1R2NST | 1.2 \pm 30% | 0.029 | 72 | 5.10 | 2.15 |
| SLW4020S1R5NST | 1.5 \pm 30% | 0.035 | 71 | 4.45 | 1.98 |
| SLW4020S2R2NST | 2.2 \pm 30% | 0.040 | 49 | 3.40 | 1.85 |
| SLW4020S3R3MST | 3.3 \pm 20% | 0.070 | 44 | 3.20 | 1.40 |
| SLW4020S3R6MST | 3.6 \pm 20% | 0.055 | 49 | 2.80 | 1.54 |
| SLW4020S4R7MST | 4.7 \pm 20% | 0.075 | 42 | 2.35 | 1.34 |
| SLW4020S5R1MST | 5.1 \pm 20% | 0.085 | 42 | 2.30 | 1.27 |
| SLW4020S5R6MST | 5.6 \pm 20% | 0.090 | 30 | 2.20 | 1.22 |
| SLW4020S6R2MST | 6.2 \pm 20% | 0.115 | 36 | 2.15 | 1.08 |
| SLW4020S6R8MST | 6.8 \pm 20% | 0.125 | 33 | 2.20 | 1.04 |
| SLW4020S7R5MST | 7.5 \pm 20% | 0.115 | 30 | 1.85 | 1.08 |
| SLW4020S8R2MST | 8.2 \pm 20% | 0.125 | 27 | 1.75 | 1.04 |
| SLW4020S100MST | 10 \pm 20% | 0.165 | 26 | 1.60 | 0.90 |
| SLW4020S120MST | 12 \pm 20% | 0.175 | 26 | 1.50 | 0.88 |
| SLW4020S150MST | 15 \pm 20% | 0.230 | 24 | 1.35 | 0.77 |
| SLW4020S220MST | 22 \pm 20% | 0.350 | 15 | 1.05 | 0.62 |
| SLW4020S270MST | 27 \pm 20% | 0.545 | 14 | 1.02 | 0.50 |
| SLW4020S330MST | 33 \pm 20% | 0.550 | 11 | 0.85 | 0.49 |
| SLW4020S390MST | 39 \pm 20% | 0.650 | 11 | 0.82 | 0.46 |
| SLW4020S430MST | 43 \pm 20% | 0.660 | 10 | 0.77 | 0.45 |
| SLW4020S470MST | 47 \pm 20% | 0.710 | 10 | 0.74 | 0.44 |
| SLW4020S510MST | 51 \pm 20% | 0.750 | 10 | 0.70 | 0.42 |
| SLW4020S560MST | 56 \pm 20% | 0.800 | 10 | 0.66 | 0.41 |
| SLW4020S620MST | 62 \pm 20% | 0.900 | 9.6 | 0.65 | 0.39 |

◆ Specification

| Part Number | Inductance @100KHz,1V (μ H) | DC Resistance $\pm 30\%$ (Ω) | Min.Self-resonant Frequency (MHz) | Saturation Current(A) | Heat Rating Current (A) |
|------------------------|--|--|--------------------------------------|--------------------------|----------------------------|
| | | DCR | S.R.F | Isat | Irms |
| SLW4020S Series | | | | | |
| SLW4020S680MST | 68 $\pm 20\%$ | 1.060 | 7.7 | 0.61 | 0.36 |
| SLW4020S750MST | 75 $\pm 20\%$ | 1.120 | 7.7 | 0.60 | 0.35 |
| SLW4020S820MST | 82 $\pm 20\%$ | 1.170 | 7.2 | 0.56 | 0.34 |
| SLW4020S101MST | 100 $\pm 20\%$ | 1.350 | 6.3 | 0.52 | 0.31 |
| SLW4030S Series | | | | | |
| SLW4030SR91NST | 0.91 $\pm 30\%$ | 0.022 | 100 | 6.25 | 3.15 |
| SLW4030S1R2NST | 1.2 $\pm 30\%$ | 0.025 | 80 | 5.80 | 2.96 |
| SLW4030S1R5NST | 1.5 $\pm 30\%$ | 0.030 | 62 | 4.84 | 2.92 |
| SLW4030S1R8NST | 1.8 $\pm 30\%$ | 0.030 | 60 | 5.40 | 2.92 |
| SLW4030S2R2NST | 2.2 $\pm 30\%$ | 0.035 | 52 | 4.90 | 2.57 |
| SLW4030S3R3MST | 3.3 $\pm 20\%$ | 0.040 | 38 | 3.30 | 2.40 |
| SLW4030S4R3MST | 4.3 $\pm 20\%$ | 0.055 | 37 | 2.95 | 2.10 |
| SLW4030S4R7MST | 4.7 $\pm 20\%$ | 0.060 | 31 | 2.90 | 2.00 |
| SLW4030S5R6MST | 5.6 $\pm 20\%$ | 0.065 | 30 | 2.60 | 1.95 |
| SLW4030S6R2MST | 6.2 $\pm 20\%$ | 0.070 | 29 | 2.50 | 1.85 |
| SLW4030S6R8MST | 6.8 $\pm 20\%$ | 0.090 | 24 | 2.75 | 1.60 |
| SLW4030S7R5MST | 7.5 $\pm 20\%$ | 0.085 | 26 | 2.20 | 1.65 |
| SLW4030S8R2MST | 8.2 $\pm 20\%$ | 0.090 | 26 | 2.10 | 1.60 |
| SLW4030S9R1MST | 9.1 $\pm 20\%$ | 0.095 | 23 | 2.00 | 1.55 |
| SLW4030S100MST | 10 $\pm 20\%$ | 0.100 | 21 | 1.95 | 1.50 |
| SLW4030S120MST | 12 $\pm 20\%$ | 0.135 | 18 | 1.70 | 1.30 |
| SLW4030S150MST | 15 $\pm 20\%$ | 0.190 | 16 | 1.65 | 1.11 |
| SLW4030S180MST | 18 $\pm 20\%$ | 0.200 | 10 | 1.40 | 1.10 |
| SLW4030S220MST | 22 $\pm 20\%$ | 0.225 | 10 | 1.30 | 1.00 |
| SLW4030S330MST | 33 $\pm 20\%$ | 0.330 | 10 | 1.10 | 0.84 |
| SLW4030S360MST | 36 $\pm 20\%$ | 0.335 | 9.8 | 1.05 | 0.83 |
| SLW4030S390MST | 39 $\pm 20\%$ | 0.435 | 10 | 1.03 | 0.73 |
| SLW4030S430MST | 43 $\pm 20\%$ | 0.440 | 9.2 | 1.00 | 0.73 |
| SLW4030S470MST | 47 $\pm 20\%$ | 0.445 | 8.4 | 0.95 | 0.72 |
| SLW4030S510MST | 51 $\pm 20\%$ | 0.470 | 8.4 | 0.90 | 0.70 |
| SLW4030S560MST | 56 $\pm 20\%$ | 0.555 | 8.4 | 0.85 | 0.65 |
| SLW4030S620MST | 62 $\pm 20\%$ | 0.829 | 7 | 0.80 | 0.53 |
| SLW4030S680MST | 68 $\pm 20\%$ | 0.868 | 7 | 0.75 | 0.52 |
| SLW4030S750MST | 75 $\pm 20\%$ | 1.020 | 6.3 | 0.70 | 0.48 |
| SLW4030S820MST | 82 $\pm 20\%$ | 1.060 | 5.6 | 0.66 | 0.47 |

◆ Specification

| Part Number | Inductance @100KHz,1V (μ H) | DC Resistance $\pm 30\%$ (Ω) | Min.Self-resonant Frequency (MHz) | Saturation Current(A) | Heat Rating Current (A) |
|------------------------|--|--|--------------------------------------|--------------------------|----------------------------|
| | | DCR | S.R.F | Isat | Irms |
| SLW4030S Series | | | | | |
| SLW4030S910MST | 91 $\pm 20\%$ | 1.100 | 5.6 | 0.65 | 0.46 |
| SLW4030S101MST | 100 $\pm 20\%$ | 1.150 | 5.6 | 0.60 | 0.45 |
| SLW4030S121MST | 120 $\pm 20\%$ | 1.350 | 5.4 | 0.55 | 0.42 |
| SLW5020S Series | | | | | |
| SLW5020S1R0NST | 1.0 $\pm 30\%$ | 0.018 | 97 | 4.33 | 3.70 |
| SLW5020S1R5NST | 1.5 $\pm 30\%$ | 0.026 | 80 | 3.85 | 3.20 |
| SLW5020S2R2NST | 2.2 $\pm 30\%$ | 0.035 | 61 | 3.85 | 2.90 |
| SLW5020S3R3NST | 3.3 $\pm 30\%$ | 0.044 | 46 | 3.25 | 2.40 |
| SLW5020S4R7NST | 4.7 $\pm 30\%$ | 0.059 | 33 | 2.40 | 2.05 |
| SLW5020S6R8MST | 6.8 $\pm 20\%$ | 0.087 | 30 | 1.80 | 1.70 |
| SLW5020S100MST | 10 $\pm 20\%$ | 0.110 | 24 | 1.79 | 1.50 |
| SLW5020S150MST | 15 $\pm 20\%$ | 0.165 | 20 | 1.44 | 1.25 |
| SLW5020S220MST | 22 $\pm 20\%$ | 0.235 | 16 | 1.18 | 1.05 |
| SLW5020S330MST | 33 $\pm 20\%$ | 0.370 | 13 | 0.97 | 0.83 |
| SLW5020S470MST | 47 $\pm 20\%$ | 0.525 | 11 | 0.81 | 0.70 |
| SLW5020S680MST | 68 $\pm 20\%$ | 0.885 | 8.8 | 0.70 | 0.53 |
| SLW5020S101MST | 100 $\pm 20\%$ | 1.060 | 7.6 | 0.57 | 0.49 |
| SLW5040S Series | | | | | |
| SLW5040S1R5NST | 1.5 $\pm 30\%$ | 0.013 | 60 | 7.30 | 4.45 |
| SLW5040S2R2NST | 2.2 $\pm 30\%$ | 0.017 | 42 | 6.50 | 3.95 |
| SLW5040S3R3NST | 3.3 $\pm 30\%$ | 0.025 | 32 | 5.10 | 3.40 |
| SLW5040S4R7NST | 4.7 $\pm 30\%$ | 0.029 | 28 | 4.40 | 3.10 |
| SLW5040S6R8MST | 6.8 $\pm 20\%$ | 0.043 | 21 | 3.80 | 2.40 |
| SLW5040S100MST | 10 $\pm 20\%$ | 0.055 | 18 | 2.90 | 2.10 |
| SLW5040S150MST | 15 $\pm 20\%$ | 0.089 | 13 | 2.30 | 1.60 |
| SLW5040S220MST | 22 $\pm 20\%$ | 0.126 | 9 | 1.90 | 1.40 |
| SLW5040S330MST | 33 $\pm 20\%$ | 0.192 | 7 | 1.60 | 1.20 |
| SLW5040S470MST | 47 $\pm 20\%$ | 0.283 | 6 | 1.30 | 0.94 |
| SLW6020S Series | | | | | |
| SLW6020SR50NST | 0.50 $\pm 30\%$ | 0.013 | 130 | 4.90 | 4.05 |
| SLW6020SR68NST | 0.68 $\pm 30\%$ | 0.017 | 120 | 7.50 | 3.80 |
| SLW6020SR82NST | 0.82 $\pm 30\%$ | 0.017 | 110 | 6.60 | 3.80 |
| SLW6020S1R0NST | 1.0 $\pm 30\%$ | 0.020 | 94 | 4.15 | 3.25 |
| SLW6020S1R2NST | 1.2 $\pm 30\%$ | 0.022 | 88 | 5.90 | 3.20 |
| SLW6020S1R5NST | 1.5 $\pm 30\%$ | 0.022 | 79 | 4.25 | 3.20 |

◆ Specification

| Part Number | Inductance @100KHz,1V (μ H) | DC Resistance $\pm 30\%$ (Ω) | Min.Self-resonant Frequency (MHz) | Saturation Current(A) | Heat Rating Current (A) |
|------------------------|--|--|--------------------------------------|--------------------------|----------------------------|
| | | DCR | S.R.F | Isat | Irms |
| SLW6020S Series | | | | | |
| SLW6020S1R8NST | 1.8 $\pm 30\%$ | 0.028 | 68 | 4.85 | 2.75 |
| SLW6020S2R0NST | 2.0 $\pm 30\%$ | 0.035 | 64 | 4.30 | 2.45 |
| SLW6020S2R2NST | 2.2 $\pm 30\%$ | 0.028 | 61 | 3.75 | 2.75 |
| SLW6020S2R7NST | 2.7 $\pm 30\%$ | 0.035 | 56 | 3.90 | 2.60 |
| SLW6020S3R3NST | 3.3 $\pm 30\%$ | 0.035 | 51 | 3.15 | 2.60 |
| SLW6020S3R9NST | 3.9 $\pm 30\%$ | 0.049 | 46 | 3.25 | 2.10 |
| SLW6020S4R3NST | 4.3 $\pm 30\%$ | 0.049 | 44 | 2.70 | 2.10 |
| SLW6020S4R7NST | 4.7 $\pm 30\%$ | 0.058 | 41 | 3.00 | 2.00 |
| SLW6020S5R6NST | 5.6 $\pm 30\%$ | 0.058 | 36 | 2.40 | 1.90 |
| SLW6020S6R2NST | 6.2 $\pm 30\%$ | 0.079 | 35 | 2.30 | 1.80 |
| SLW6020S6R8NST | 6.8 $\pm 30\%$ | 0.079 | 31 | 2.20 | 1.80 |
| SLW6020S8R2NST | 8.2 $\pm 20\%$ | 0.105 | 28 | 2.10 | 1.40 |
| SLW6020S100MST | 10 $\pm 20\%$ | 0.105 | 27 | 1.75 | 1.40 |
| SLW6020S120MST | 12 $\pm 20\%$ | 0.120 | 23 | 1.70 | 1.35 |
| SLW6020S150MST | 15 $\pm 20\%$ | 0.145 | 21 | 1.50 | 1.20 |
| SLW6020S180MST | 18 $\pm 20\%$ | 0.175 | 19 | 1.23 | 1.10 |
| SLW6020S220MST | 22 $\pm 20\%$ | 0.204 | 16 | 1.25 | 1.00 |
| SLW6028S Series | | | | | |
| SLW6028S1R5NST | 1.5 $\pm 30\%$ | 0.013 | 65 | 6.00 | 4.58 |
| SLW6028S2R2NST | 2.2 $\pm 30\%$ | 0.015 | 56 | 5.10 | 4.09 |
| SLW6028S2R7NST | 2.7 $\pm 30\%$ | 0.020 | 48 | 3.80 | 3.75 |
| SLW6028S3R3NST | 3.3 $\pm 30\%$ | 0.025 | 41 | 3.63 | 3.48 |
| SLW6028S4R7NST | 4.7 $\pm 30\%$ | 0.030 | 35 | 3.00 | 3.08 |
| SLW6028S5R1NST | 5.1 $\pm 30\%$ | 0.035 | 33 | 3.55 | 2.89 |
| SLW6028S6R2MST | 6.2 $\pm 20\%$ | 0.040 | 30 | 3.05 | 2.58 |
| SLW6028S6R8MST | 6.8 $\pm 20\%$ | 0.047 | 27 | 2.85 | 2.40 |
| SLW6028S8R2MST | 8.2 $\pm 20\%$ | 0.055 | 24 | 2.60 | 2.25 |
| SLW6028S9R1MST | 9.1 $\pm 20\%$ | 0.060 | 24 | 2.55 | 2.15 |
| SLW6028S100MST | 10 $\pm 20\%$ | 0.072 | 23 | 2.04 | 1.95 |
| SLW6028S120MST | 12 $\pm 20\%$ | 0.080 | 18 | 1.80 | 1.85 |
| SLW6028S150MST | 15 $\pm 20\%$ | 0.125 | 18 | 1.75 | 1.45 |
| SLW6028S180MST | 18 $\pm 20\%$ | 0.120 | 15 | 1.52 | 1.45 |
| SLW6028S220MST | 22 $\pm 20\%$ | 0.140 | 14 | 1.60 | 1.40 |
| SLW6028S270MST | 27 $\pm 20\%$ | 0.155 | 13 | 1.50 | 1.32 |

◆ Specification

| Part Number | Inductance @100KHz,1V (μ H) | DC Resistance $\pm 30\%$ (Ω) | Min.Self-resonant Frequency (MHz) | Saturation Current(A) | Heat Rating Current (A) |
|------------------------|--|--|--------------------------------------|--------------------------|----------------------------|
| | | DCR | S.R.F | Isat | Irms |
| SLW6028S Series | | | | | |
| SLW6028S330MST | 33 $\pm 20\%$ | 0.185 | 12 | 1.35 | 1.22 |
| SLW6028S360MST | 36 $\pm 20\%$ | 0.215 | 11 | 1.25 | 1.13 |
| SLW6028S390MST | 39 $\pm 20\%$ | 0.225 | 11 | 1.25 | 1.10 |
| SLW6028S430MST | 43 $\pm 20\%$ | 0.235 | 11 | 1.20 | 1.07 |
| SLW6028S470MST | 47 $\pm 20\%$ | 0.245 | 9.5 | 1.15 | 1.06 |
| SLW6028S510MST | 51 $\pm 20\%$ | 0.265 | 9.5 | 1.05 | 1.01 |
| SLW6028S620MST | 62 $\pm 20\%$ | 0.345 | 7.7 | 0.95 | 0.89 |
| SLW6028S680MST | 68 $\pm 20\%$ | 0.360 | 7.7 | 0.95 | 0.86 |
| SLW6028S750MST | 75 $\pm 20\%$ | 0.410 | 7.7 | 0.90 | 0.81 |
| SLW6028S820MST | 82 $\pm 20\%$ | 0.445 | 7.7 | 0.90 | 0.78 |
| SLW6045S Series | | | | | |
| SLW6045SR82NST | 0.82 $\pm 30\%$ | 0.008 | 140 | 10.40 | 5.90 |
| SLW6045S1R0NST | 1.0 $\pm 30\%$ | 0.011 | 100 | 9.85 | 5.14 |
| SLW6045S1R2NST | 1.2 $\pm 30\%$ | 0.010 | 100 | 8.35 | 5.40 |
| SLW6045S1R5NST | 1.5 $\pm 30\%$ | 0.012 | 65 | 8.80 | 4.95 |
| SLW6045S1R8NST | 1.8 $\pm 30\%$ | 0.012 | 74 | 7.60 | 4.95 |
| SLW6045S2R2NST | 2.2 $\pm 30\%$ | 0.014 | 52 | 6.75 | 4.60 |
| SLW6045S2R3NST | 2.3 $\pm 30\%$ | 0.021 | 60 | 6.00 | 3.50 |
| SLW6045S2R7NST | 2.7 $\pm 30\%$ | 0.015 | 38 | 5.75 | 4.30 |
| SLW6045S3R0NST | 3.0 $\pm 30\%$ | 0.020 | 35 | 5.60 | 3.80 |
| SLW6045S3R3NST | 3.3 $\pm 30\%$ | 0.021 | 32 | 5.90 | 3.70 |
| SLW6045S3R6NST | 3.6 $\pm 30\%$ | 0.021 | 28 | 5.25 | 3.70 |
| SLW6045S4R3MST | 4.3 $\pm 20\%$ | 0.023 | 23 | 4.45 | 3.50 |
| SLW6045S4R7MST | 4.7 $\pm 20\%$ | 0.026 | 24 | 4.97 | 3.30 |
| SLW6045S5R1MST | 5.1 $\pm 20\%$ | 0.026 | 23 | 4.40 | 3.30 |
| SLW6045S5R6MST | 5.6 $\pm 20\%$ | 0.029 | 23 | 4.15 | 3.15 |
| SLW6045S6R2MST | 6.2 $\pm 20\%$ | 0.031 | 26 | 4.43 | 3.00 |
| SLW6045S6R8MST | 6.8 $\pm 20\%$ | 0.031 | 20 | 3.90 | 3.00 |
| SLW6045S7R5MST | 7.5 $\pm 20\%$ | 0.034 | 18 | 3.50 | 2.90 |
| SLW6045S8R2MST | 8.2 $\pm 20\%$ | 0.043 | 21 | 3.90 | 2.60 |
| SLW6045S9R1MST | 9.1 $\pm 20\%$ | 0.043 | 17 | 3.35 | 2.60 |
| SLW6045S100MST | 10 $\pm 20\%$ | 0.048 | 15 | 3.20 | 2.45 |
| SLW6045S120MST | 12 $\pm 20\%$ | 0.058 | 13 | 2.80 | 2.20 |
| SLW6045S150MST | 15 $\pm 20\%$ | 0.068 | 12 | 2.50 | 2.05 |

◆ Specification

| Part Number | Inductance @100KHz,1V (μ H) | DC Resistance $\pm 30\%$ (Ω) | Min.Self-resonant Frequency (MHz) | Saturation Current(A) | Heat Rating Current (A) |
|------------------------|--|--|--------------------------------------|--------------------------|----------------------------|
| | | DCR | S.R.F | Isat | Irms |
| SLW6045S Series | | | | | |
| SLW6045S180MST | 18 \pm 20% | 0.081 | 10 | 2.20 | 1.85 |
| SLW6045S220MST | 22 \pm 20% | 0.089 | 10 | 2.05 | 1.80 |
| SLW6045S270MST | 27 \pm 20% | 0.102 | 9.2 | 1.90 | 1.65 |
| SLW6045S300MST | 30 \pm 20% | 0.132 | 7.8 | 1.70 | 1.50 |
| SLW6045S330MST | 33 \pm 20% | 0.137 | 7.8 | 1.65 | 1.45 |
| SLW6045S360MST | 36 \pm 20% | 0.173 | 7.8 | 1.62 | 1.40 |
| SLW6045S390MST | 39 \pm 20% | 0.180 | 7.8 | 1.50 | 1.25 |
| SLW6045S430MST | 43 \pm 20% | 0.200 | 7.7 | 1.63 | 1.20 |
| SLW6045S470MST | 47 \pm 20% | 0.200 | 6.4 | 1.40 | 1.20 |
| SLW6045S510MST | 51 \pm 20% | 0.207 | 6.4 | 1.35 | 1.15 |
| SLW6045S560MST | 56 \pm 20% | 0.221 | 6.4 | 1.30 | 1.10 |
| SLW6045S620MST | 62 \pm 20% | 0.235 | 6.4 | 1.25 | 1.10 |
| SLW6045S680MST | 68 \pm 20% | 0.289 | 6.4 | 1.20 | 1.00 |
| SLW6045S750MST | 75 \pm 20% | 0.305 | 5 | 1.15 | 0.95 |
| SLW6045S820MST | 82 \pm 20% | 0.341 | 4.9 | 1.05 | 0.90 |
| SLW6045S910MST | 91 \pm 20% | 0.359 | 4.9 | 1.00 | 0.85 |
| SLW6045S101MST | 100 \pm 20% | 0.433 | 4.2 | 0.95 | 0.80 |
| SLW6045S121MST | 120 \pm 20% | 0.484 | 4.2 | 0.85 | 0.77 |
| SLW6045S151MST | 150 \pm 20% | 0.580 | 4.2 | 0.80 | 0.70 |
| SLW6045S221MST | 220 \pm 20% | 0.834 | 3.5 | 0.70 | 0.59 |
| SLW6045S331MST | 330 \pm 20% | 1.270 | 2.8 | 0.57 | 0.57 |
| SLW8040S Series | | | | | |
| SLW8040SR82NST | 0.82 \pm 30% | 0.008 | 94 | 13.80 | 6.30 |
| SLW8040S1R0NST | 1.0 \pm 30% | 0.008 | 89 | 9.85 | 6.30 |
| SLW8040S1R5NST | 1.5 \pm 30% | 0.010 | 67 | 8.15 | 5.65 |
| SLW8040S2R0NST | 2.0 \pm 30% | 0.012 | 43 | 9.25 | 5.15 |
| SLW8040S2R2NST | 2.2 \pm 30% | 0.012 | 41 | 7.10 | 5.15 |
| SLW8040S3R0NST | 3.0 \pm 30% | 0.014 | 32 | 6.10 | 4.70 |
| SLW8040S3R3NST | 3.3 \pm 30% | 0.017 | 27 | 6.50 | 4.40 |
| SLW8040S3R6NST | 3.6 \pm 30% | 0.017 | 30 | 7.52 | 4.35 |
| SLW8040S3R9NST | 3.9 \pm 30% | 0.017 | 26 | 5.75 | 4.35 |
| SLW8040S4R7NST | 4.7 \pm 30% | 0.019 | 24 | 5.90 | 4.10 |
| SLW8040S5R1NST | 5.1 \pm 30% | 0.019 | 22 | 4.70 | 4.05 |

◆ Specification

| Part Number | Inductance @100KHz,1V (μ H) | DC Resistance $\pm 30\%$ (Ω) | Min.Self-resonant Frequency (MHz) | Saturation Current(A) | Heat Rating Current (A) |
|------------------------|--|--|--------------------------------------|--------------------------|----------------------------|
| | | DCR | S.R.F | Isat | Irms |
| SLW8040S Series | | | | | |
| SLW8040S5R6NST | 5.6 \pm 30% | 0.021 | 24 | 6.00 | 3.85 |
| SLW8040S6R2NST | 6.2 \pm 30% | 0.021 | 20 | 4.45 | 3.85 |
| SLW8040S6R8MST | 6.8 \pm 20% | 0.024 | 20 | 4.55 | 3.60 |
| SLW8040S8R2MST | 8.2 \pm 20% | 0.026 | 17 | 4.20 | 3.45 |
| SLW8040S100MST | 10 \pm 20% | 0.029 | 15 | 3.60 | 3.30 |
| SLW8040S150MST | 15 \pm 20% | 0.047 | 12 | 2.95 | 2.60 |
| SLW8040S180MST | 18 \pm 20% | 0.053 | 11 | 2.70 | 2.40 |
| SLW8040S220MST | 22 \pm 20% | 0.069 | 9.5 | 2.40 | 2.10 |
| SLW8040S270MST | 27 \pm 20% | 0.078 | 9.2 | 2.15 | 2.00 |
| SLW8040S330MST | 33 \pm 20% | 0.097 | 7.8 | 2.05 | 1.80 |
| SLW8040S360MST | 36 \pm 20% | 0.102 | 7.8 | 2.00 | 1.75 |
| SLW8040S390MST | 39 \pm 20% | 0.107 | 7.8 | 1.95 | 1.70 |
| SLW8040S430MST | 43 \pm 20% | 0.113 | 7.8 | 1.90 | 1.65 |
| SLW8040S470MST | 47 \pm 20% | 0.136 | 6.4 | 1.75 | 1.55 |
| SLW8040S510MST | 51 \pm 20% | 0.142 | 6.4 | 1.70 | 1.50 |
| SLW8040S560MST | 56 \pm 20% | 0.148 | 6.4 | 1.55 | 1.45 |
| SLW8040S620MST | 62 \pm 20% | 0.182 | 6.4 | 1.50 | 1.30 |
| SLW8040S680MST | 68 \pm 20% | 0.196 | 4.9 | 1.45 | 1.25 |
| SLW8040S750MST | 75 \pm 20% | 0.211 | 4.9 | 1.35 | 1.20 |
| SLW8040S820MST | 82 \pm 20% | 0.225 | 5.9 | 1.30 | 1.15 |
| SLW8040S910MST | 91 \pm 20% | 0.272 | 4.9 | 1.20 | 1.05 |
| SLW8040S101MST | 100 \pm 20% | 0.290 | 4.2 | 1.15 | 1.00 |
| SLW8040S121MST | 120 \pm 20% | 0.334 | 3.5 | 1.05 | 0.95 |
| SLW8040S151MST | 150 \pm 20% | 0.410 | 3.5 | 1.10 | 0.85 |
| SLW8040S221MST | 220 \pm 20% | 0.599 | 3.5 | 0.85 | 0.80 |
| SLW8040S331MST | 330 \pm 20% | 0.889 | 2.8 | 0.68 | 0.64 |

◆ Note

- 1: All test data is referenced to 20°C ambient;
- 2: Rated current: Isat or Irms, whichever is smaller;
- 3: Isat: DC current at which the inductance drops approximate 30% from its value without current;
- 4: Irms: DC current that causes the temperature rise ($\Delta T = 40^\circ\text{C}$) from 20°C ambient.

◆ **TYPICAL ELECTRICAL CHARACTERISTICS**

SLW252010S Series

Temperature vs. DC Current Characteristics



Inductance vs. DC Current Characteristics



SLW252012S Series

Temperature vs. DC Current Characteristics

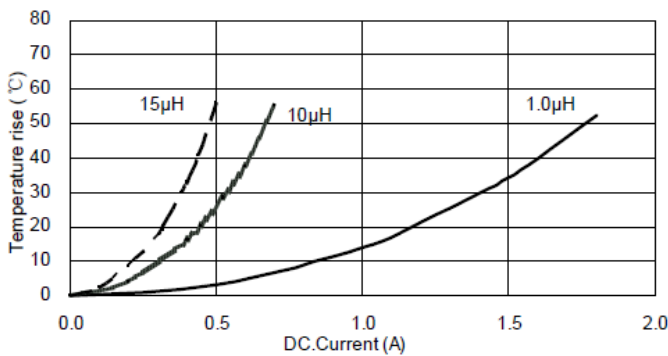

Inductance vs. DC Current Characteristics



SLW3010S Series

Temperature vs. DC Current Characteristics



Inductance vs. DC Current Characteristics



◆ TYPICAL ELECTRICAL CHARACTERISTICS

SLW3012S Series

Temperature vs. DC Current Characteristics



Inductance vs. DC Current Characteristics



SLW3015S Series

Temperature vs. DC Current Characteristics



Inductance vs. DC Current Characteristics

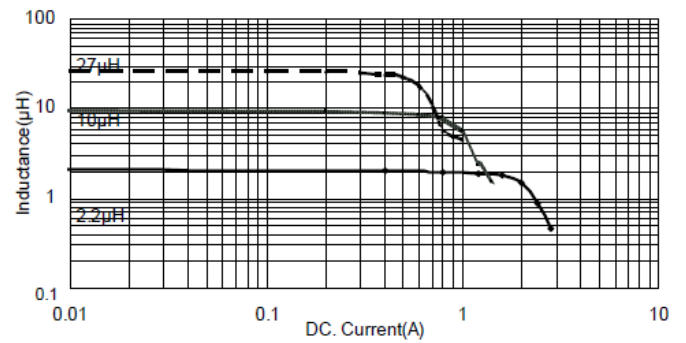

SLW4012S Series

Temperature vs. DC Current Characteristics



Inductance vs. DC Current Characteristic



◆ TYPICAL ELECTRICAL CHARACTERISTICS

SLW4018S Series

Temperature vs. DC Current Characteristics



Inductance vs. DC Current Characteristics



SLW4020S Series

Temperature vs. DC Current Characteristics



Inductance vs. DC Current Characteristics

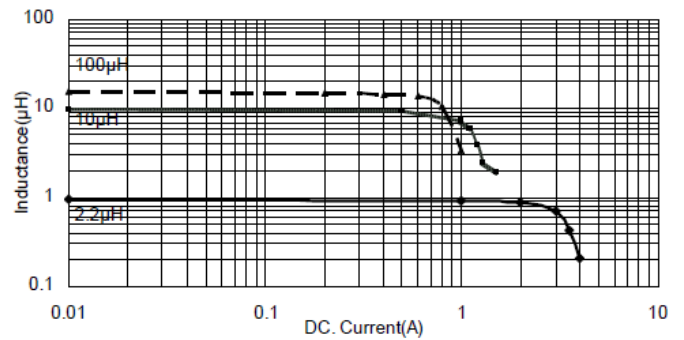

SLW4030S Series

Temperature vs. DC Current Characteristics



Inductance vs. DC Current Characteristics

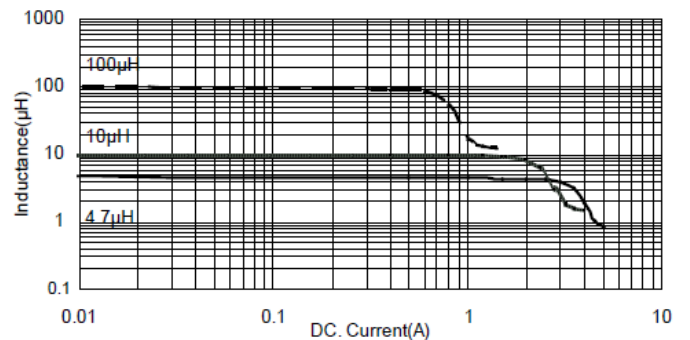

◆ **TYPICAL ELECTRICAL CHARACTERISTICS**

SLW5020S Series

Temperature vs. DC Current Characteristics



Inductance vs. DC Current Characteristics



SLW5040S Series

Temperature vs. DC Current Characteristics



Inductance vs. DC Current Characteristics



SLW6020S Series

Temperature vs. DC Current Characteristics



Inductance vs. DC Current Characteristics



◆ TYPICAL ELECTRICAL CHARACTERISTICS

SLW6028S Series

Temperature vs. DC Current Characteristics

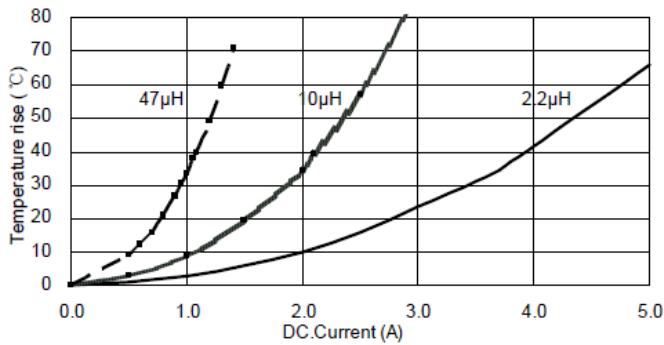

Inductance vs. DC Current Characteristics



SLW6045S Series

Temperature vs. DC Current Characteristics



Inductance vs. DC Current Characteristics

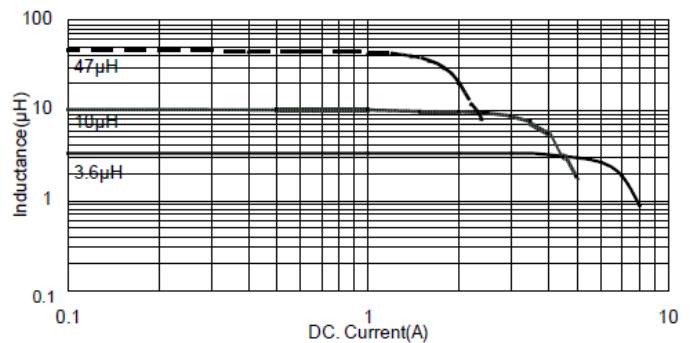

SLW8040S Series

Temperature vs. DC Current Characteristics

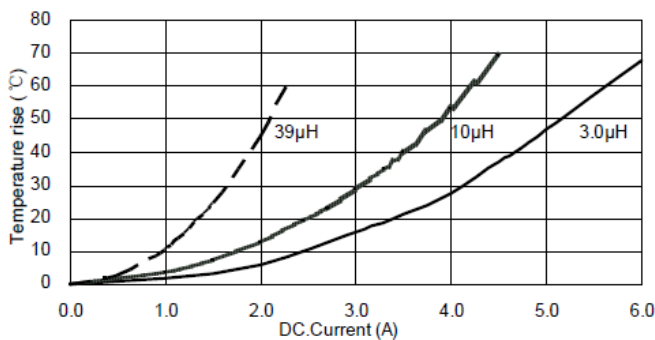

Inductance vs. DC Current Characteristics

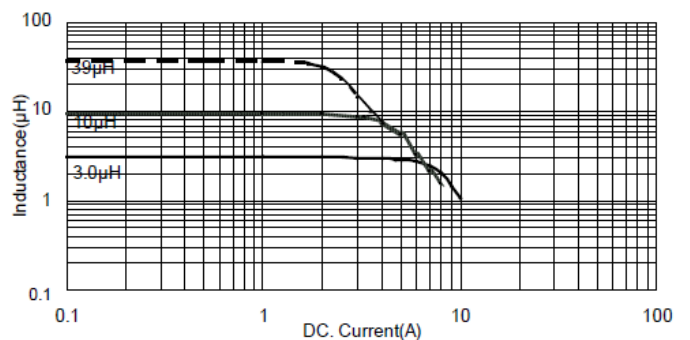

◆ Package

| Size EIA (EIA) | SLW2520S | SLW3010S | SLW3012S | SLW3015S | SLW4012S | SLW4018S | SLW4020S |
|---|----------|----------|----------|----------|----------|----------|----------|
| Standard Packing Quantity (pcs / reel) | 2,000 | 2,000 | 2,000 | 2,000 | 4,500 | 3,000 | 3,000 |
| | SLW4030S | SLW5020S | SLW5040S | SLW6020S | SLW6028S | SLW6045S | SLW8040S |
| | 2,000 | 2,500 | 1,500 | 2,500 | 2,000 | 1,500 | 1,000 |

X-ON Electronics

Largest Supplier of Electrical and Electronic Components

Click to view similar products for [Fixed Inductors](#) category:

Click to view products by [Sunltech](#) manufacturer:

Other Similar products are found below :

[CR32NP-100KC](#) [CR32NP-151KC](#) [CR32NP-180KC](#) [CR32NP-181KC](#) [CR32NP-1R5MC](#) [CR32NP-390KC](#) [CR32NP-3R9MC](#) [CR32NP-680KC](#) [CR32NP-820KC](#) [CR32NP-8R2MC](#) [CR43NP-390KC](#) [CR43NP-560KC](#) [CR43NP-680KC](#) [CR54NP-181KC](#) [CR54NP-470LC](#) [CR54NP-820KC](#) [CR54NP-8R5MC](#) [70F224AI](#) [MGDQ4-00004-P](#) [MHL1ECTTP18NJ](#) [MHQ1005P10NJ](#) [MHQ1005P1N0S](#) [MHQ1005P2N4S](#) [MHQ1005P3N6S](#) [MHQ1005P5N1S](#) [MHQ1005P8N2J](#) [PE-51506NL](#) [PE-53601NL](#) [PE-53602NL](#) [PE-53630NL](#) [PE-53824SNLT](#) [PE-92100NL](#) [PG0434.801NLT](#) [PG0936.113NLT](#) [9220-20](#) [9310-16](#) [PM06-2N7](#) [PM06-39NJ](#) [A01TK](#) [1206CS-471XJ](#) [HC2LP-R47-R](#) [HC2-R47-R](#) [HC3-2R2-R](#) [HCF1305-3R3-R](#) [1206CS-151XG](#) [RCH664NP-140L](#) [RCH664NP-4R7M](#) [RCH8011NP-221L](#) [RCP1317NP-332L](#) [RCP1317NP-391L](#)