

**VOLTAGE RANGE: 20 - 100V**  
**CURRENT: 2.0 A**

### Features

- Schottky Barrier Chip
- Ideally Suited for Automatic Assembly
- Low Power Loss, High Efficiency
- For Use in Low Voltage Application
- Guard Ring Die Construction
- Plastic Case Material has UL Flammability Classification Rating 94V-O

### Mechanical Data

- Case: SMA/DO-214AC, Molded Plastic
- Terminals: Solder Plated, Solderable per MIL-STD-750, Method 2026
- Polarity: Cathode Band or Cathode Notch
- Marking: Type Number
- Weight: 0.064 grams (approx.)

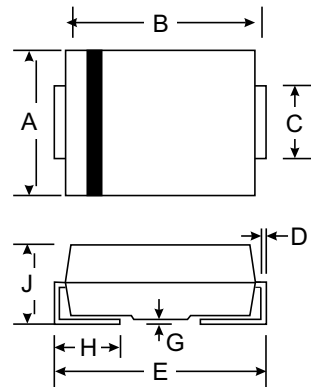

| SMA(DO-214AC)        |      |      |
|----------------------|------|------|
| Dim                  | Min  | Max  |
| A                    | 2.29 | 2.92 |
| B                    | 4.00 | 4.60 |
| C                    | 1.27 | 1.63 |
| D                    | 0.15 | 0.31 |
| E                    | 4.80 | 5.59 |
| G                    | 0.10 | 0.20 |
| H                    | 0.76 | 1.52 |
| J                    | 2.01 | 2.62 |
| All Dimensions in mm |      |      |

### Maximum Ratings and Electrical Characteristics T<sub>A</sub> = 25°C unless otherwise specified

Single phase, half wave, 60Hz, resistive or inductive load. For capacitive load, derate current by 20%.

| Characteristic  | Symbol            | SS22A       | SS23A | SS24A | SS25A       | SS26A | SS28A | SS210A | Unit |
|---|-------------------|-------------|-------|-------|-------------|-------|-------|--------|------|
| Maximum repetitive peak reverse voltage   | V <sub>RRM</sub>  | 20          | 30    | 40    | 50          | 60    | 80    | 100    | V    |
| Maximum RMS voltage   | V <sub>RMS</sub>  | 14          | 21    | 28    | 35          | 42    | 56    | 70     | V    |
| Maximum DC blocking voltage   | V <sub>DC</sub>   | 20          | 30    | 40    | 50          | 60    | 80    | 100    | V    |
| Maximum average forward rectified current at T <sub>L</sub> (see fig.1)                             | I <sub>(AV)</sub> | 2.0         |       |       |             |       |       |        | A    |
| Peak forward surge current<br>8.3ms single half sine-wave superimposed on rated load (JEDEC Method) | I <sub>FSM</sub>  | 50.0        |       |       |             |       |       |        | A    |
| Maximum instantaneous forward voltage at 2.0A   | V <sub>F</sub>    | 0.55        |       | 0.70  |             | 0.85  |       | V      |      |
| Maximum DC reverse current<br>at rated DC blocking voltage  | I <sub>R</sub>    | 0.5         |       |       |             |       |       |        | mA   |
| <small>T<sub>A</sub>=25°C</small><br><small>T<sub>A</sub>=100°C</small>                             |                   | 20          |       | 10    |             |       |       |        |      |
| Typical junction capacitance (NOTE 1)   | C <sub>J</sub>    | 220         |       | 180   |             | pF    |       |        |      |
| Typical thermal resistance (NOTE 2)   | R <sub>θJA</sub>  | 75.0        |       |       |             |       |       |        | °C/W |
| Operating junction temperature range  | T <sub>J</sub>    | -65 to +125 |       |       | -65 to +150 |       |       | °C     |      |
| Storage temperature range   | T <sub>STG</sub>  | -65 to +150 |       |       |             |       |       |        | °C   |

- Note:**
1. Measured at 1MHz and applied reverse voltage of 4.0V D.C.
  2. P.C.B. mounted with 0.2x0.2" (5.0x5.0mm) copper pad areas

## RATINGS AND CHARACTERISTIC CURVES SS22A THRU SS210A

AVERAGE FORWARD RECTIFIED CURRENT, AMPERES

FIG. 1- FORWARD CURRENT DERATING CURVE

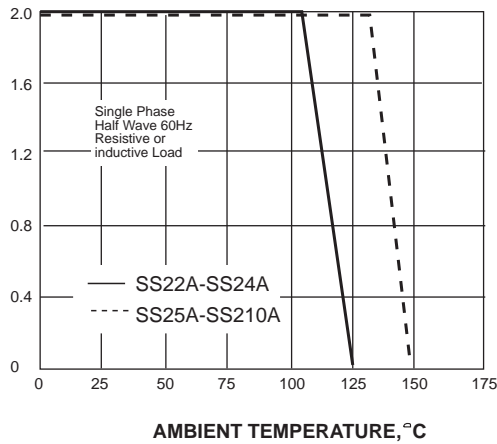

FIG. 2-MAXIMUM NON-REPETITIVE PEAK FORWARD SURGE CURRENT

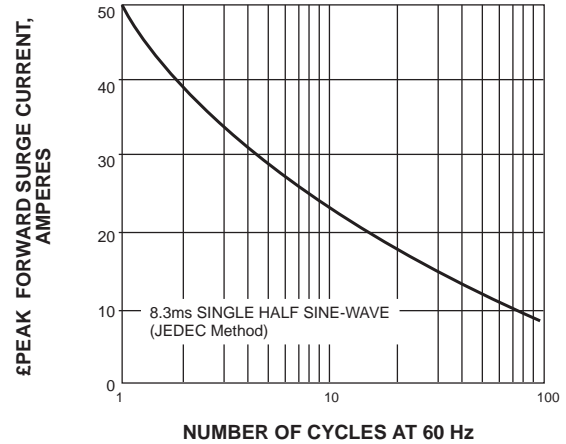

FIG. 3-TYPICAL INSTANTANEOUS FORWARD CHARACTERISTICS

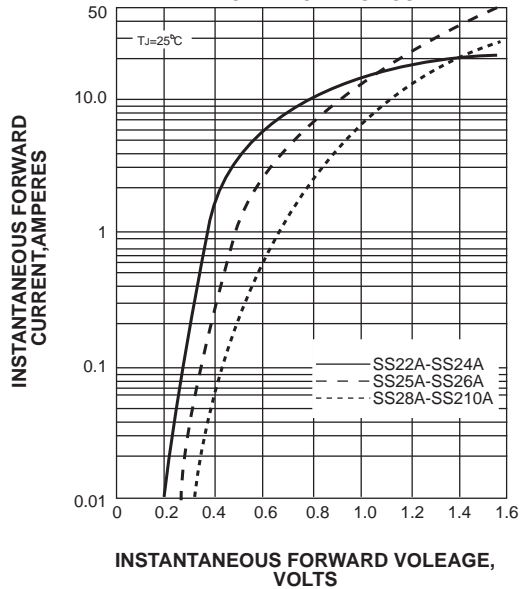

FIG. 4-TYPICAL REVERSE CHARACTERISTICS

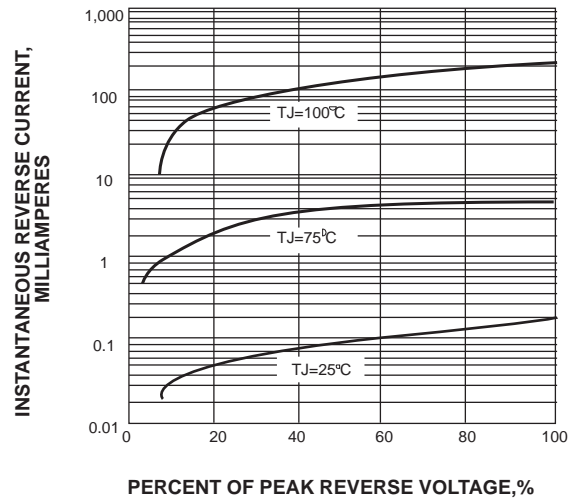

FIG. 5-TYPICAL JUNCTION CAPACITANCE

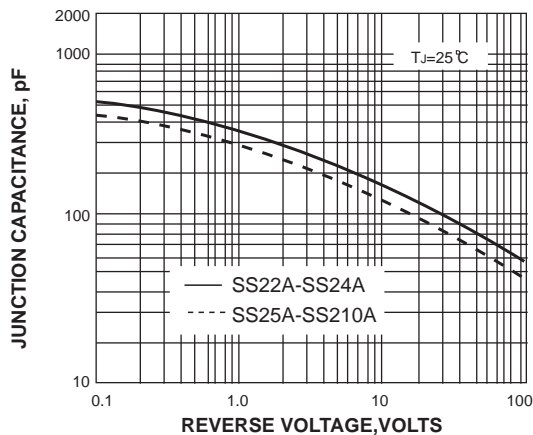
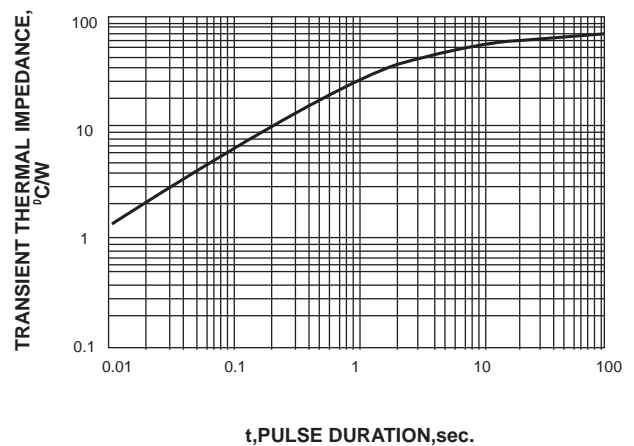

FIG. 6-TYPICAL TRANSIENT THERMAL IMPEDANCE



## X-ON Electronics

Largest Supplier of Electrical and Electronic Components

*Click to view similar products for [Schottky Diodes & Rectifiers](#) category:*

*Click to view products by [SUNMATE](#) manufacturer:*

Other Similar products are found below :

[MA4E2039](#) [MA4E2508M-1112](#) [MBR0530L-TP](#) [MBR10100CT-BP](#) [MBR1545CT](#) [MMBD301M3T5G](#) [RB160M-50TR](#)

[BAS16E6433HTMA1](#) [BAS 3010S-02LRH E6327](#) [BAT 54-02LRH E6327](#) [IDL02G65C5XUMA1](#) [NSR05F40QNXT5G](#) [NSVR05F40NXT5G](#)

[NTE555](#) [JANS1N6640](#) [SB07-03C-TB-H](#) [SK310-T](#) [SK33A-TP](#) [SK34B-TP](#) [SS3003CH-TL-E](#) [PDS3100Q-7](#) [GA01SHT18](#)

[CRS10I30A\(TE85L,QM](#) [MA4E2501L-1290](#) [MBRB30H30CT-1G](#) [JANTX1N5712-1](#) [SB007-03C-TB-E](#) [SK33B-TP](#) [SK35A-TP](#) [SK38B-LTP](#)

[NTE505](#) [NTSB30U100CT-1G](#) [VS-6CWQ10FNHM3](#) [CRG04\(T5L,TEMQ\)](#) [ACDBA1100LR-HF](#) [ACDBA1200-HF](#) [ACDBA240-HF](#)

[ACDBA3100-HF](#) [CDBQC0530L-HF](#) [ACDBA260LR-HF](#) [ACDBA1100-HF](#) [MA4E2502L-1246](#) [10BQ015-M3/5BT](#) [10BQ060-M3/5BT](#)

[NRVB130LSFT1G](#) [CRS08TE85LQM](#) [PMAD1108-LF](#) [B120Q-13-F](#) [1N5819T-G](#) [B0530WSQ-7-F](#)