

PART NUMBER: 356-22

CUSTOMER PRINT

NOTES:

1. MATERIAL: STAINLESS STEEL
2. ALL DIMENSION FOR REFERENCE ONLY

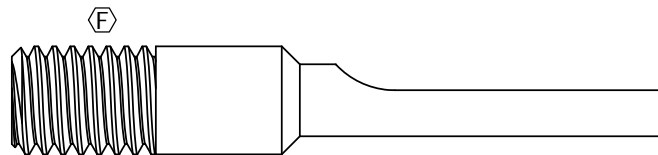
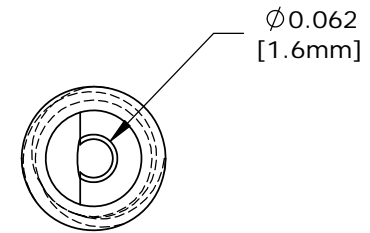
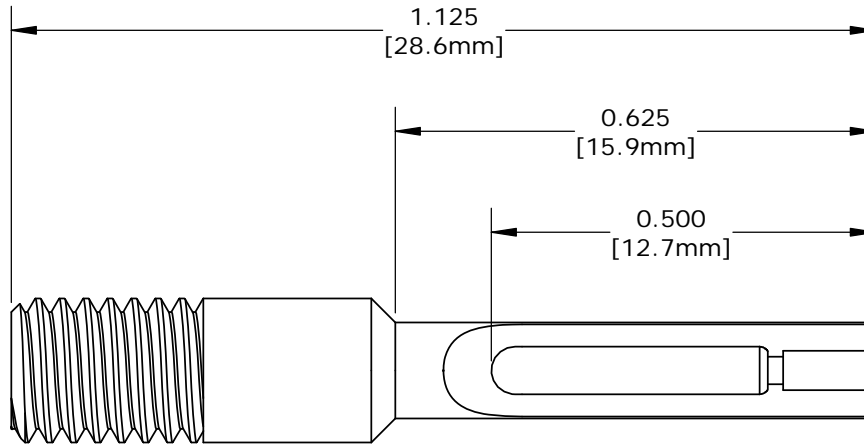

10-32 UNF-2A THREAD

PROPRIETARY

THIS DOCUMENT CONTAINS CONFIDENTIAL INFORMATION PROPRIETARY TO CONXALL CORPORATION. ANY REPRODUCTION, DISCLOSURE, OR USE OF THIS DOCUMENT /INFORMATION IS EXPRESSLY PROHIBITED UNLESS AUTHORIZED IN WRITING BY CONXALL CORPORATION.

DIMENSIONS IN BRACKETS [] ARE METRIC

F	SS	03-10-20	ADDED PROJECTED VIEW AND UPDATED MFG DRAWING PER ECR 9509
E	SS	07-16-19	UPDATED MATERIAL FOR NOTE 1 PER ECR 9429
D	AN	06-19-17	CREATED SHEET PER DOR 17-7819JS
REV.	INIT.	DATE	DESCRIPTION
<small>ALL INFORMATION ILLUSTRATED IS THE PROPERTY OF "CONXALL CORPORATION." UNAUTHORIZED DUPLICATION OR DISTRIBUTION OF THIS DOCUMENT IS PROHIBITED.</small>			<small>ORIG. DRAWN BY:</small> TAG <small>DATE:</small> 12-14-00
<small>ALL UNITS ARE IN FEET, INCHES, FRACTION OF INCHES AND DECIMALS.</small>			<small>CHECKED BY:</small> <small>APPROVED BY:</small>
<small>△ = CRITICAL CHARACTERISTIC FLAG PER SPEC. XXXX</small>		<small>SCALE</small> NTS A	<small>SHEET</small> 1 OF 1
<small>FILE:</small> 356-22		<small>DIRECTORY:</small> SLW	<small>TITLE:</small> CONTACT INSERTION BIT FOR SIZE #20 PIN-SOCKET 20 AWG TO 24 AWG <small>CUSTOMER:</small> STANDARD PRODUCT
<small>PART NUMBER:</small> 356-22		<small>REV</small> F	<small>REV</small> F



X-ON Electronics

Largest Supplier of Electrical and Electronic Components

Click to view similar products for [Standard Circular Connector](#) category:

Click to view products by [Switchcraft](#) manufacturer:

Other Similar products are found below :

[5M2530B10P](#) [600259N006](#) [600273N007](#) [6134-336-13149](#) [6134-337-11149](#) [6134-337-2390](#) [6134-341-17149](#) [6280-4SG-516](#) [6280-7SG-3DC](#)
[6290](#) [6291A](#) [66200A-10](#) [680-SMG](#) [681-PMG](#) [CXS3102A14S2P](#) [CXS3102A181S](#) [7251-5SG-300](#) [7271-6SG-300](#) [7282-3PG-300-CH3](#) [75-](#)
[474618-01S](#) [75-474618-04P](#) [75-474618-04S](#) [799539-000](#) [MI8-SE](#) [805-005-07NF11-19PC](#) [805-005-07NF15-7PA](#) [8280-4PG-516](#) [8280-7PG-](#)
[519](#) [8282-5PG-519](#) [836783-1](#) [MP-4102-25P-C](#) [862256-1](#) [864019-2](#) [866857-1](#) [867865-1](#) [PT01SP-14-18P](#) [PT08P-14-5S](#) [PTSF06SE-14-12S](#)
[120-1833-000](#) [QCM019PC2DC012B](#) [1-2069279-1](#) [121583-0217](#) [121667-0020](#) [129591AU](#) [1000B BULK](#) [RD10A16-19-P6CS051/1](#)
[RD10A20-31-P8CS051/1](#) [RD16A14-12-S6CS051/2](#) [1301240290](#) [1301240347](#) [1301860202](#)