

Small Signal Product

200mA, 120V - 250V Switching Diodes
FEATURES

- Fast Switching Speed
- Surface Mount Package Ideally Suited For Automatic Insertion
- High Conductance
- Packing code with suffix "G" means green compound (halogen-free)
- Compliant to RoHS Directive 2011/65/EU and in accordance to WEEE 2002/96/EC
- Halogen-free according to IEC 61249-2-21

SOD-323

APPLICATION

- Surface mount fast switching diode
- General purpose small signal switching

MECHANICAL DATA

- Case: SOD-323 small outline plastic package
- Moisture sensitivity level 1
- Polarity: Indicated by cathode band
- Weight: 4.36 ± 0.5 mg

MAXIMUM RATINGS AND ELECTRICAL CHARACTERISTICS (T _A =25°C unless otherwise noted)					
PARAMETER	SYMBOL	BAV19WS-G	BAV20WS-G	BAV21WS-G	UNIT
Average Rectified Output Current	I _O	200			mA
Repetitive Peak Reverse Voltage	V _{RRM}	120	200	250	V
DC Reverse Voltage	V _R	100	150	200	V
Non-Repetitive Peak Forward Surge Current	I _{FSM}	2.5			A
Surge Current		0.5			
Repetitive Peak Forward Surge Current	I _{FRM}	625			mA
Power Dissipation	P _D	200			mW
Thermal Resistance Junction to Ambient	R _{θJA}	625			°C/W
Junction and Storage Temperature Range	T _J , T _{STG}	-65 to 150			°C

PARAMETER	SYMBOL	MIN	MAX	UNIT	
Breakdown Voltage (Note 1)	V _{(BR)R}	BAV19WS-G	120	-	V
		BAV20WS-G	200	-	
		BAV21WS-G	250	-	
Forward Voltage	V _F	I _F =100mA	-	1.00	V
		I _F =200mA	-	1.25	
Reverse Leakage Current (Note 2)	I _R	BAV19WS-G	-	100	nA
		BAV20WS-G	-		
		BAV21WS-G	-		
Junction Capacitance	C _J	-	5	pF	
Reverse Recovery Time (Note 3)	t _{rr}	-	50	ns	

 Note 1: Test condition : I_R= 100μA

 Note 2: Test condition : BAV19WS-G @ V_R=100V, BAV20WS-G @ V_R=150V, BAV21WS-G @ V_R=200V

 Note 3: Test condition : I_F= I_R= 30mA , R_L=100Ω , I_{rr}=0.1xI_R

Small Signal Product

RATINGS AND CHARACTERISTICS CURVES

($T_A=25^\circ\text{C}$ unless otherwise noted)

Fig. 1 Typical Forward Characteristics

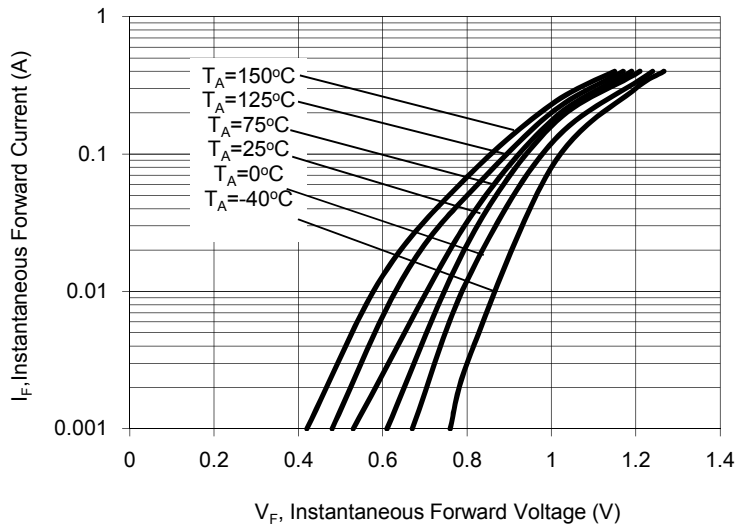

Fig. 2 Typical Reverse Characteristics

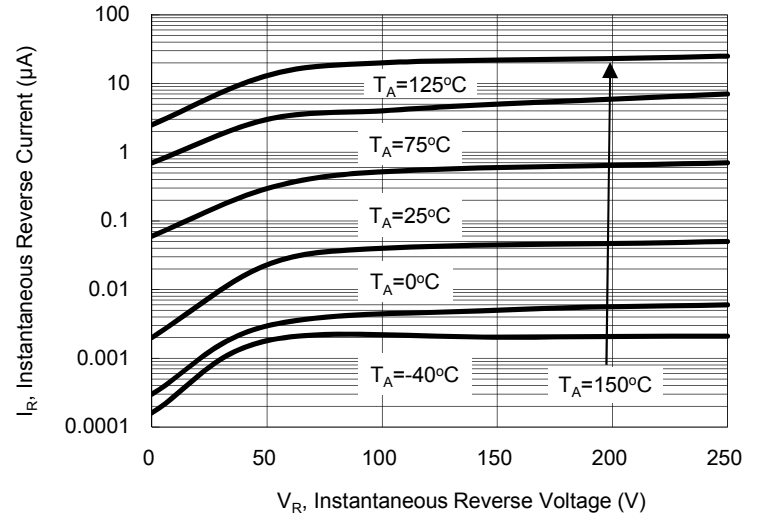

Fig. 3 Typical Capacitance VS. Reverse Voltage

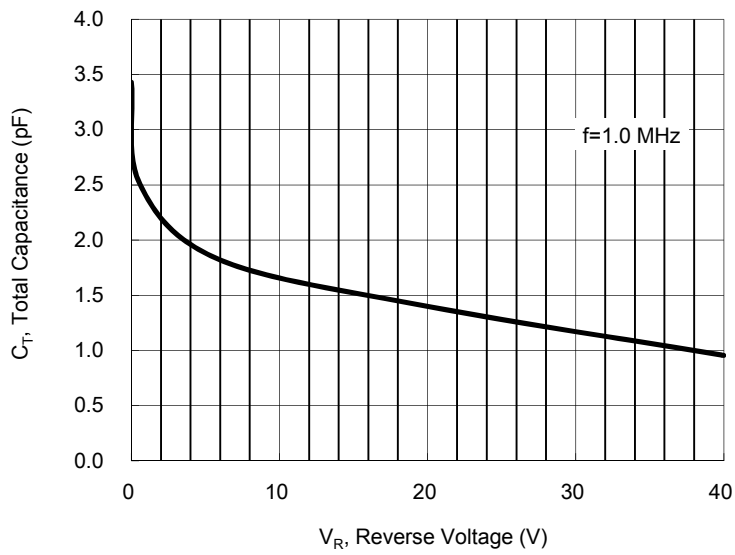
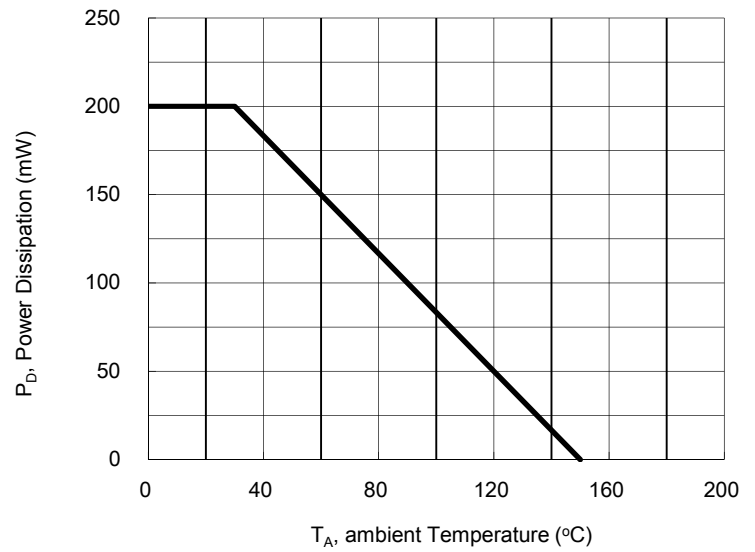

Fig. 4 Power Derating Curve



Small Signal Product

ORDERING INFORMATION				
PART NO.	PACKING CODE	PACKING CODE SUFFIX	PACKAGE	PACKING
BAVxxWS-G (Note 1, 2)	RR	G	SOD-323	3K / 7" Reel

Note 1: "xx" is Device Code from "BAV19WS-G" to "BAV21WS-G".

Note 2: Whole series with green compound

EXAMPLE				
PREFERRED P/N	PART NO.	PACKING CODE	PACKING CODE SUFFIX	DESCRIPTION
BAV19WS-G RRG	BAV19WS-G	RR	G	Green compound

DIMENSIONS

SOD-323

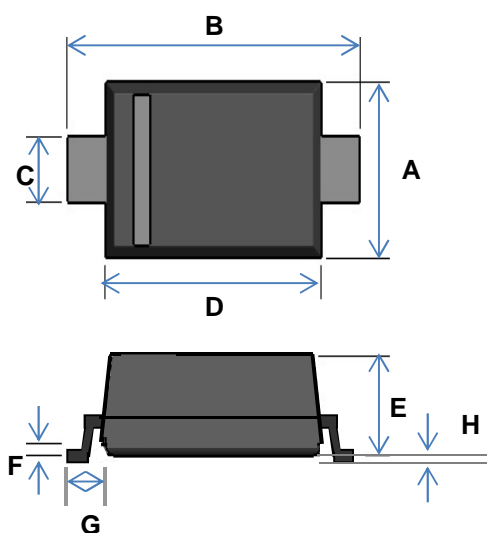

DIM.	Unit (mm)		Unit (inch)	
	Min	Max	Min	Max
A	1.150	1.400	0.045	0.055
B	2.300	2.700	0.091	0.106
C	0.250	0.450	0.010	0.018
D	1.600	1.800	0.063	0.071
E	0.800	1.000	0.031	0.039
F	0.050	0.177	0.002	0.007
G	0.475 REF		0.019 REF	
H	-	0.100	-	0.004

SUGGESTED PAD LAYOUT

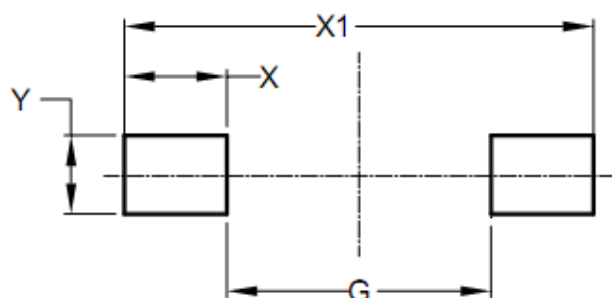

DIM.	Unit (mm)	Unit (inch)
	Typ.	Typ.
G	1.600	0.063
X	0.630	0.025
X1	2.850	0.112
Y	0.830	0.033

Note: The suggested land pattern dimensions have been provided for reference only, as actual pad layouts may vary depending on application

MARKING

Part No.	Marking
BAV19WS-G	A8
BAV20WS-G	T2
BAV21WS-G	T3

Small Signal Product

Notice

Specifications of the products displayed herein are subject to change without notice. TSC or anyone on its behalf, assumes no responsibility or liability for any errors or inaccuracies.

Information contained herein is intended to provide a product description only. No license, express or implied, to any intellectual property rights is granted by this document. Except as provided in TSC's terms and conditions of sale for such products, TSC assumes no liability whatsoever, and disclaims any express or implied warranty, relating to sale and/or use of TSC products including liability or warranties relating to fitness for a particular purpose, merchantability, or infringement of any patent, copyright, or other intellectual property right.

The products shown herein are not designed for use in medical, life-saving, or life-sustaining applications. Customers using or selling these products for use in such applications do so at their own risk and agree to fully indemnify TSC for any damages resulting from such improper use or sale.

X-ON Electronics

Largest Supplier of Electrical and Electronic Components

Click to view similar products for [Diodes - General Purpose, Power, Switching category:](#)

Click to view products by [Taiwan Semiconductor manufacturer:](#)

Other Similar products are found below :

[MCL4151-TR3](#) [MMBD3004S-13-F](#) [RD0306T-H](#) [RD0506LS-SB-1H](#) [RGP30G-E373](#) [DSE010-TR-E](#) [BAQ333-TR](#) [BAQ335-TR](#) [BAQ33-GS18](#) [BAS1602VH6327XT](#) [BAV17-TR](#) [BAV19-TR](#) [BAV301-TR](#) [BAW27-TAP](#) [HSC285TRF-E](#) [NSVBAV23CLT1G](#) [NTE525](#) [1SS181-TP](#) [1SS184-TP](#) [1SS193,LF](#) [1SS193-TP](#) [1SS400CST2RA](#) [SBAV99LT3G](#) [SDAA13](#) [LL4448-GS18](#) [SHN2D02FUTW1T1G](#) [LS4150GS18](#) [LS4151GS08](#) [SMMD7000LT3G](#) [FC903-TR-E](#) [1N4449](#) [1N4934-E3/73](#) [1SS226-TP](#) [APT100DL60HJ](#) [RFUH20TB3S](#) [RGP30G-E354](#) [RGP30M-E3/73](#) [D291S45T](#) [MCL4151-TR](#) [BAS 16-02V H6327](#) [BAS 21U E6327](#) [BAS 28 E6327](#) [BAS33-TAP](#) [BAS 70-02V H6327](#) [BAV300-TR](#) [BAV303-TR3](#) [BAW27-TR](#) [BAW56DWQ-7-F](#) [BAW56M3T5G](#) [BAW75-TAP](#)