

Surface Mount Ultrafast Power Rectifiers

FEATURES

- Glass passivated junction
- Ideal for automated placement
- Built-in strain relief
- Ultrafast recovery time for high efficiency
- Moisture sensitivity level: level 1, per J-STD-020
- Compliant to RoHS Directive 2011/65/EU and in accordance to WEEE 2002/96/EC
- Halogen-free according to IEC 61249-2-21 definition
- AEC-Q101 qualified



MECHANICAL DATA

Case: DO-214AB (SMC)

Molding compound, UL flammability classification rating 94V-0

Packing code with suffix "G" means green compound (halogen-free)

Terminal: Matte tin plated leads, solderable per JESD22-B102

Meet JESD 201 class 2 whisker test

Weight: 0.25 g (approximately)

DO-214AB (SMC)

| MAXIMUM RATINGS AND ELECTRICAL CHARACTERISTICS (T _A =25°C unless otherwise noted) | | | | | |
|--|--------------------|----------------|--------------|---------|------|
| PARAMETER | SYMBOL | MUR420S | MUR440S | MUR460S | UNIT |
| Maximum repetitive peak reverse voltage | V _{RRM} | 200 | 400 | 600 | V |
| Maximum RMS voltage | V _{RMS} | 140 | 280 | 420 | V |
| Maximum DC blocking voltage | V _{DC} | 200 | 400 | 600 | V |
| Maximum average forward rectified current | I _{F(AV)} | 4 | | | A |
| Peak forward surge current, 8.3 ms single half sine-wave superimposed on rated load | I _{FSM} | 75 | | | A |
| Maximum instantaneous forward voltage (Note 1) @ 4 A, 25°C @ 4 A, 150°C | V _F | 0.875 0.710 | 1.25 1.05 | | V |
| Maximum reverse current @ rated VR T _J =25 °C T _J =150 °C | I _R | 5 150 | 10 250 | | μA |
| Maximum reverse recovery time (Note 2) | t _{rr} | 25 | 50 | | ns |
| Typical junction capacitance (Note 3) | C _J | 65 | | | pF |
| Typical thermal resistance | R _{θJC} | 8.5 | | | °C/W |
| | R _{θJA} | 45 | | | |
| Operating junction temperature range | T _J | - 55 to +175 | | | °C |
| Storage temperature range | T _{STG} | - 55 to +175 | | | °C |

Note 1: Pulse Test with PW=300μs, 1% Duty Cycle

Note 2: Reverse Recovery Test Conditions: I_F=0.5A, I_R=1.0A, I_{RR}=0.25A

Note 3: Measured at 1 MHz and Applied Reverse Voltage of 4.0V DC

| ORDERING INFORMATION | | | | |
|----------------------|--------------|---------------------|---------|--------------------------|
| PART NO. | PACKING CODE | PACKING CODE SUFFIX | PACKAGE | PACKING |
| MUR4x0S (Note 1) | R7 | G | SMC | 850 / 7" Plastic reel |
| | R6 | | SMC | 3,000 / 13" Paper reel |
| | M6 | | SMC | 3,000 / 13" Plastic reel |

Note 1: "x" defines voltage from 200V (MUR420S) to 600V (MUR460S)

| EXAMPLE | | | | |
|--------------------|----------|--------------|---------------------|--------------------------------------|
| PREFERRED PART NO. | PART NO. | PACKING CODE | PACKING CODE SUFFIX | DESCRIPTION |
| MUR460S R7 | MUR460S | R7 | | AEC-Q101 qualified |
| MUR460S R7G | MUR460S | R7 | G | AEC-Q101 qualified Green compound |

RATINGS AND CHARACTERISTICS CURVES

($T_A=25^\circ\text{C}$ unless otherwise noted)

FIG. 1 MAXIMUM FORWARD CURRENT DERATING CURVE

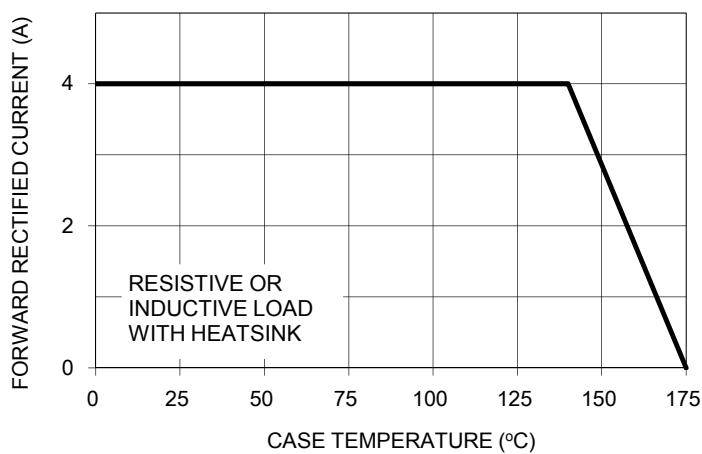

FIG. 2 MAXIMUM NON-REPETITIVE FORWARD SURGE CURRENT

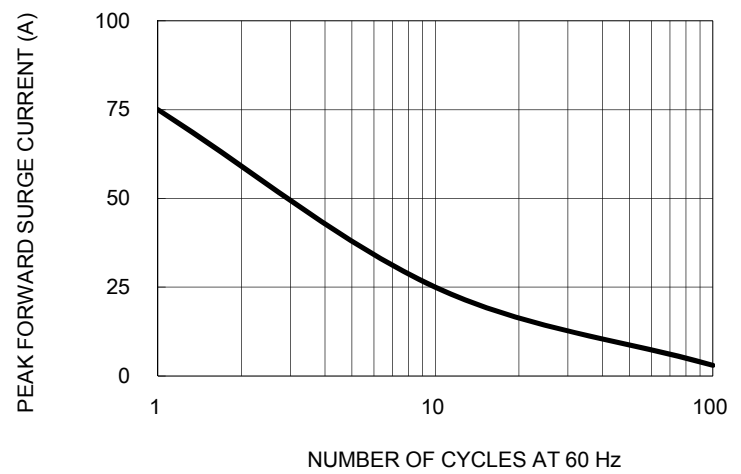

FIG. 3 TYPICAL INSTANTANEOUS FORWARD CHARACTERISTICS

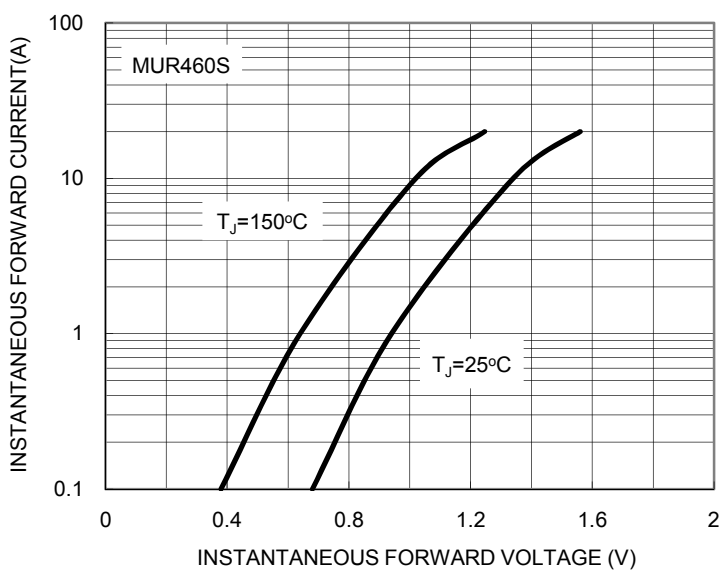

FIG. 4 TYPICAL REVERSE CHARACTERISTICS

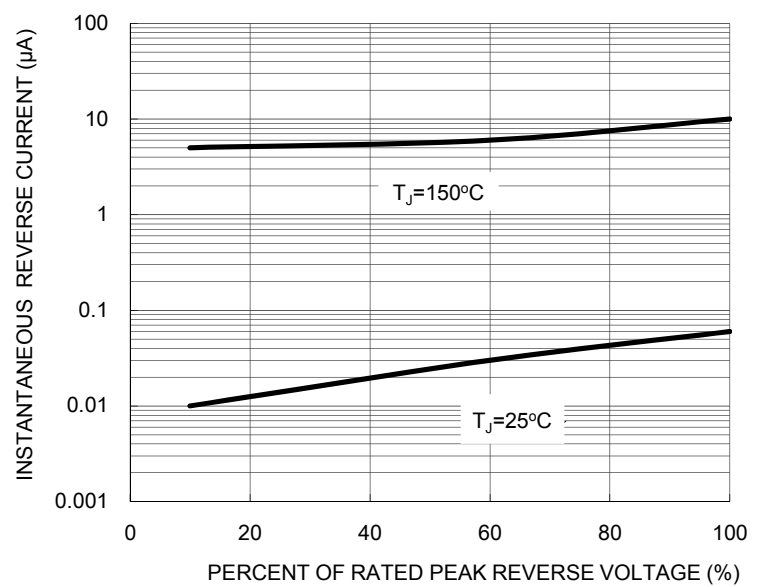

FIG. 5 TYPICAL JUNCTION CAPACITANCE

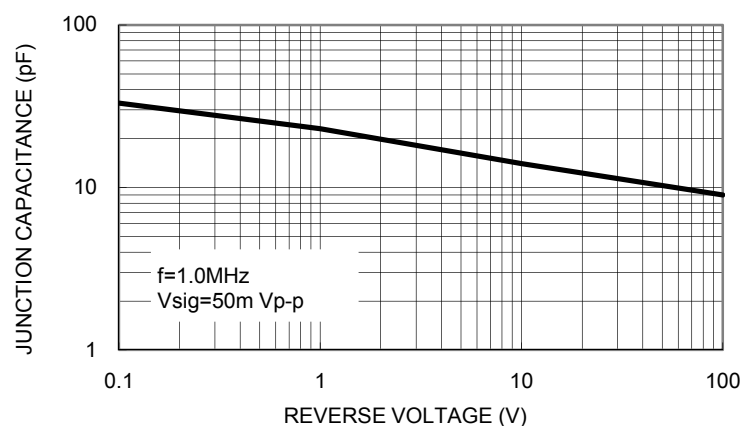
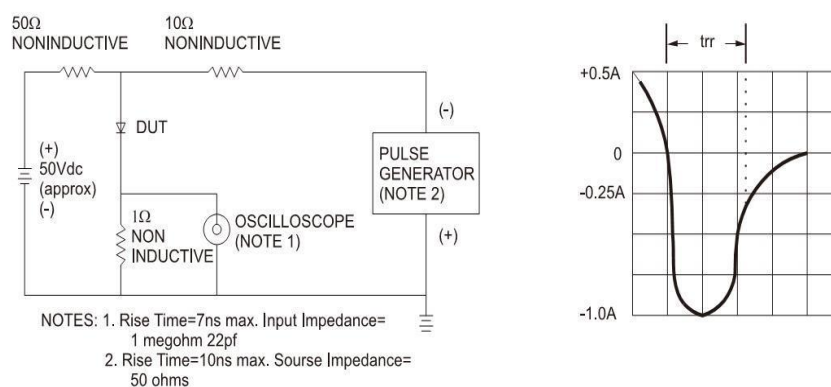
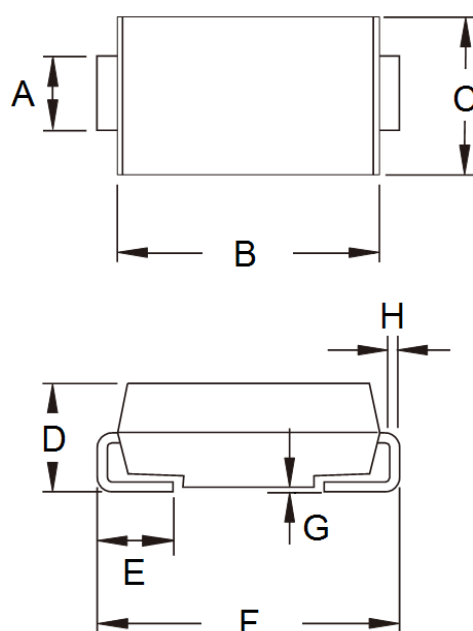

FIG.6 REVERSE RECOVERY TIME CHARACTERISTIC AND TEST CIRCUIT DIAGRAM



PACKAGE OUTLINE DIMENSIONS

DO-214AB (SMC)



| DIM. | Unit (mm) | | Unit (inch) | |
|------|-----------|------|-------------|-------|
| | Min | Max | Min | Max |
| A | 2.90 | 3.20 | 0.114 | 0.126 |
| B | 6.60 | 7.11 | 0.260 | 0.280 |
| C | 5.59 | 6.22 | 0.220 | 0.245 |
| D | 2.00 | 2.62 | 0.079 | 0.103 |
| E | 1.00 | 1.60 | 0.039 | 0.063 |
| F | 7.75 | 8.13 | 0.305 | 0.320 |
| G | 0.10 | 0.20 | 0.004 | 0.008 |
| H | 0.15 | 0.31 | 0.006 | 0.012 |

SUGGESTED PAD LAYOUT

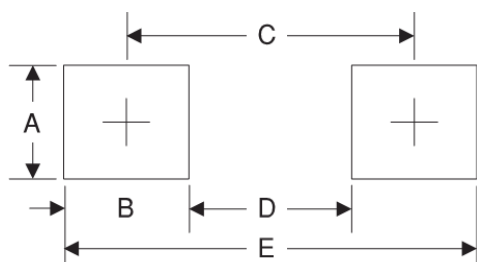

| Symbol | Unit (mm) | Unit (inch) |
|--------|-----------|-------------|
| A | 3.3 | 0.130 |
| B | 2.5 | 0.098 |
| C | 6.8 | 0.268 |
| D | 4.4 | 0.173 |
| E | 9.4 | 0.370 |

MARKING DIAGRAM



- P/N = Specific Device Code
- G = Green Compound
- YW = Date Code
- F = Factory Code

Notice

Specifications of the products displayed herein are subject to change without notice. TSC or anyone on its behalf, assumes no responsibility or liability for any errors or inaccuracies.

Information contained herein is intended to provide a product description only. No license, express or implied, to any intellectual property rights is granted by this document. Except as provided in TSC's terms and conditions of sale for such products, TSC assumes no liability whatsoever, and disclaims any express or implied warranty, relating to sale and/or use of TSC products including liability or warranties relating to fitness for a particular purpose, merchantability, or infringement of any patent, copyright, or other intellectual property right.

The products shown herein are not designed for use in medical, life-saving, or life-sustaining applications. Customers using or selling these products for use in such applications do so at their own risk and agree to fully indemnify TSC for any damages resulting from such improper use or sale.

X-ON Electronics

Largest Supplier of Electrical and Electronic Components

Click to view similar products for [Rectifiers](#) category:

Click to view products by [Taiwan Semiconductor](#) manufacturer:

Other Similar products are found below :

[70HFR40](#) [RL252-TP](#) [150KR30A](#) [1N5397](#) [NTE5841](#) [NTE6038](#) [SCF5000](#) [1N4002G](#) [1N4005-TR](#) [JANS1N6640US](#) [481235F](#)
[RRE02VS6SGTR](#) [067907F](#) [MS306](#) [70HF40](#) [T110HF60](#) [T85HFL60S02](#) [US2JFL-TP](#) [A1N5404G-G](#) [CRS04\(T5L,TEMQ\)](#) [ACGRA4007-HF](#)
[ACGRB207-HF](#) [CLH03\(TE16L,Q\)](#) [ACGRC307-HF](#) [ACEFC304-HF](#) [NTE6356](#) [NTE6359](#) [NTE6002](#) [NTE6023](#) [NTE6039](#) [NTE6077](#)
[85HFR60](#) [40HFR60](#) [1N1186RA](#) [70HF120](#) [85HFR80](#) [D126A45C](#) [SCF7500](#) [D251N08B](#) [SCHJ22.5K](#) [SM100](#) [SCPA2](#) [SCH10000](#) [SDHD5K](#)
[VS-12FL100S10](#) [ACGRA4001-HF](#) [D1821SH45T PR](#) [D1251S45T](#) [NTE5990](#) [NTE6358](#)