

5.00mm Pin Spacing – Fixed PCB Blocks

Pin Spacing: 5.00mm
 Orientation: Horizontal
 Clamp Type: Tubular Screw with Wire Protector
 Design: Modular

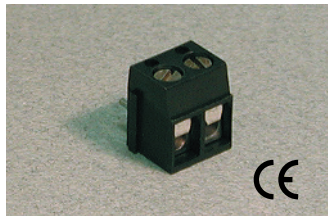

MHE-16xx

ELECTRICAL

| | Current | Voltage | Wire Range |
|--|---------|---------|------------|
| | 16A | 250V | 22-14AWG |

INSTALLATION DATA

| | | | |
|-------------------|------------------------|------------------------|-------|
| Screw Size | M3 | PCB Hole Size | 1.3mm |
| Torque | 0.5Nm (4.5 lbf-in.) | Stripping Lgth. | 5.8mm |

MATERIAL

| | | | |
|---------------------------|------------------------|-----------------------|------------------|
| Body | Glass-Filled Polyester | Screw | Galvanized Steel |
| Flammability Class | UL94V-0 | Terminal | Tin-Plated Brass |
| Temperature Limit | 130°C UL 125°C IEC | Wire Protector | CuSn6 |
| Color | Black | | |

| No. Poles | Cat. # | Length (mm) | Std. Pk. |
|-----------|----------|-------------|----------|
| 2 | MHE-162 | 10.0 | 100 |
| 3 | MHE-163 | 15.0 | 100 |
| 4 | MHE-164 | 20.0 | 50 |
| 5 | MHE-165 | 25.0 | 50 |
| 6 | MHE-166 | 30.0 | 50 |
| 7 | MHE-167 | 35.0 | 50 |
| 8 | MHE-168 | 40.0 | 50 |
| 9 | MHE-169 | 45.0 | 50 |
| 10 | MHE-1610 | 50.0 | 50 |
| 11 | MHE-1611 | 55.0 | 50 |
| 12 | MHE-1612 | 60.0 | 50 |
| 13 | MHE-1613 | 65.0 | 20 |
| 14 | MHE-1614 | 70.0 | 20 |
| 15 | MHE-1615 | 75.0 | 20 |
| 16 | MHE-1616 | 80.0 | 20 |
| 17 | MHE-1617 | 85.0 | 20 |
| 18 | MHE-1618 | 90.0 | 20 |
| 19 | MHE-1619 | 95.0 | 20 |
| 20 | MHE-1620 | 100.0 | 20 |
| 21 | MHE-1621 | 105.0 | 20 |
| 22 | MHE-1622 | 110.0 | 20 |
| 23 | MHE-1623 | 115.0 | 20 |
| 24 | MHE-1624 | 120.0 | 20 |

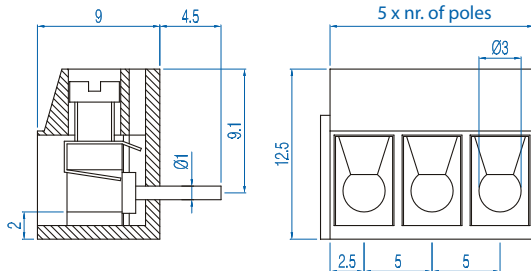

Pin Spacing: 5.00mm
 Orientation: Vertical
 Clamp Type: Box with Wire Protector
 Design: Modular

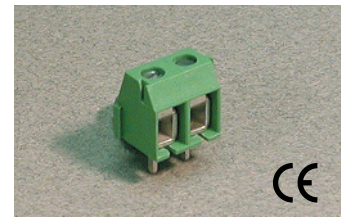

MBE-15xx

ELECTRICAL

| | Current | Voltage | Wire Range |
|--|---------|---------|---------------------------------|
| | 10A | 300V | 30-16AWG |
| | 17.5A | 450V | 1.5mm² Stranded 2.5mm² Solid |

INSTALLATION DATA

| | | | |
|-------------------|------------------------|------------------------|-------|
| Screw Size | M2.5 | PCB Hole Size | 1.5mm |
| Torque | 0.4Nm (3.6 lbf-in.) | Stripping Lgth. | 7.1mm |

MATERIAL

| | | | |
|---------------------------|-----------------------|-----------------------|-------------------|
| Body | Polyamide | Screw | Galvanized Steel |
| Flammability Class | UL94V-0 | Terminal | Tin-Plated Brass |
| Temperature Limit | 105°C UL 125°C IEC | Wire Protector | Tin-Plated Bronze |
| Color | Green | | |

| No. Poles | Cat. # | Length (mm) | Std. Pk. |
|-----------|----------|-------------|----------|
| 2 | MBE-152 | 10.0 | 100 |
| 3 | MBE-153 | 15.0 | 100 |
| 4 | MBE-154 | 20.0 | 50 |
| 5 | MBE-155 | 25.0 | 50 |
| 6 | MBE-156 | 30.0 | 50 |
| 7 | MBE-157 | 35.0 | 50 |
| 8 | MBE-158 | 40.0 | 50 |
| 9 | MBE-159 | 45.0 | 50 |
| 10 | MBE-1510 | 50.0 | 50 |
| 11 | MBE-1511 | 55.0 | 50 |
| 12 | MBE-1512 | 60.0 | 50 |
| 13 | MBE-1513 | 65.0 | 20 |
| 14 | MBE-1514 | 70.0 | 20 |
| 15 | MBE-1515 | 75.0 | 20 |
| 16 | MBE-1516 | 80.0 | 20 |
| 17 | MBE-1517 | 85.0 | 20 |
| 18 | MBE-1518 | 90.0 | 20 |
| 19 | MBE-1519 | 95.0 | 20 |
| 20 | MBE-1520 | 100.0 | 20 |
| 21 | MBE-1521 | 105.0 | 20 |
| 22 | MBE-1522 | 110.0 | 20 |
| 23 | MBE-1523 | 115.0 | 20 |
| 24 | MBE-1524 | 120.0 | 20 |

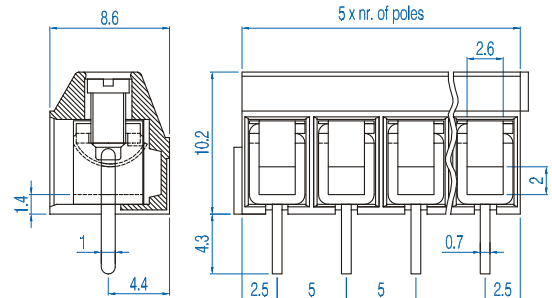

X-ON Electronics

Largest Supplier of Electrical and Electronic Components

Click to view similar products for [Fixed Terminal Blocks](#) category:

Click to view products by [Altech](#) manufacturer:

Other Similar products are found below :

[00175550202](#) [MBE-1512](#) [MBE-1520](#) [MBE-154](#) [MBE-156](#) [MBES-1510](#) [MBES-153](#) [MBES-156](#) [MH-2512](#) [MHE-132](#) [MHE-133](#) [MHE-163](#)
[MI-254 \(35\)](#) [MI-272](#) [8739](#) [880507](#) [880508](#) [MPT-275](#) [1546551-6](#) [ELM023100](#) [ELM10110G](#) [ELVD12100](#) [BA311TU](#) [BA411SU](#) [MV-152](#)
[MV-253/NCNOC](#) [MV-254-D](#) [MV-255](#) [MV-462](#) [MV-472](#) [MV-493](#) [MVE-252](#) [MVE-253](#) [MVE-258](#) [MVE-273](#) [MVEB-153](#) [1700096](#)
[1702246](#) [1705142](#) [1712417](#) [1713020](#) [1713088](#) [1776118-2](#) [1790852](#) [1-796689-8](#) [1-796692-6](#) [1800001](#) [1800114](#) [1823215](#) [1838462](#)