

### Features

- Ultra Small mold type. (SOD323)
- Low VF; Low IR.
- High reliability.

### Applications

- Low current rectification

### Construction

- Silicon epitaxial planar

### Mechanical Characteristics

- Mounting position: Any

**SOD323**



**Pin Configuration**



**Circuit Diagram**

### Absolute Maximum Ratings(Tamb=25°C unless otherwise specified)

Parameter	Symbol	Value	Unit
Reverse voltage(repetitive peak)	V <sub>RM</sub>	45	V
Reverse voltage (DC)	V <sub>R</sub>	40	V
Average rectified forward current	I <sub>o</sub>	1	A
Peak forward current( Pulse Width=1us, Single Pulse)	I <sub>PK</sub>	25	A
Peak forward surge current(8.33ms 1/2sine waveform with single pulse)	I <sub>FSM</sub>	8	A
Power Dissipation	PD	500	mW
Operating Junction temperature Range	T <sub>J</sub>	-55 to +125	°C
Storage Temperature Range	T <sub>stg</sub>	-55 to +125	°C

**Electrical Characteristics** (TA=25°C unless otherwise specified)

Parameter	Symbol	Min	Typ	Max	Unit	Test Condition
Forward voltage	V <sub>F</sub>	--	0.5	0.55	V	I <sub>F</sub> = 1A
Forward voltage	V <sub>F</sub>	--	0.43	0.48	V	I <sub>F</sub> = 0.5A
Reverse current	I <sub>R</sub>	--	--	0.1	mA	V <sub>R</sub> =40V
Junction Capacitance	C <sub>j</sub>	--	120	--	PF	V <sub>R</sub> =0V f =1MHz

**Characteristic Curves**

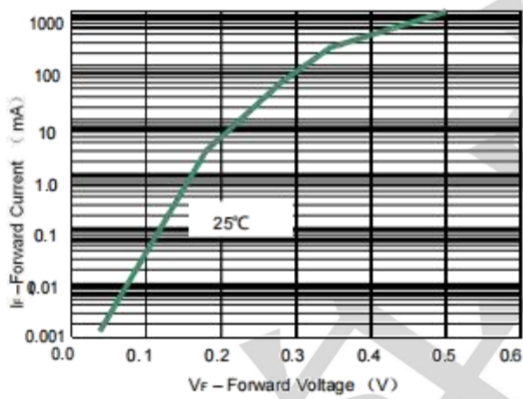

Fig 1. Forward Voltage

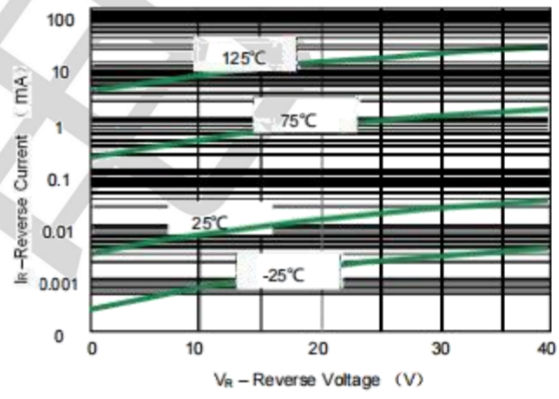
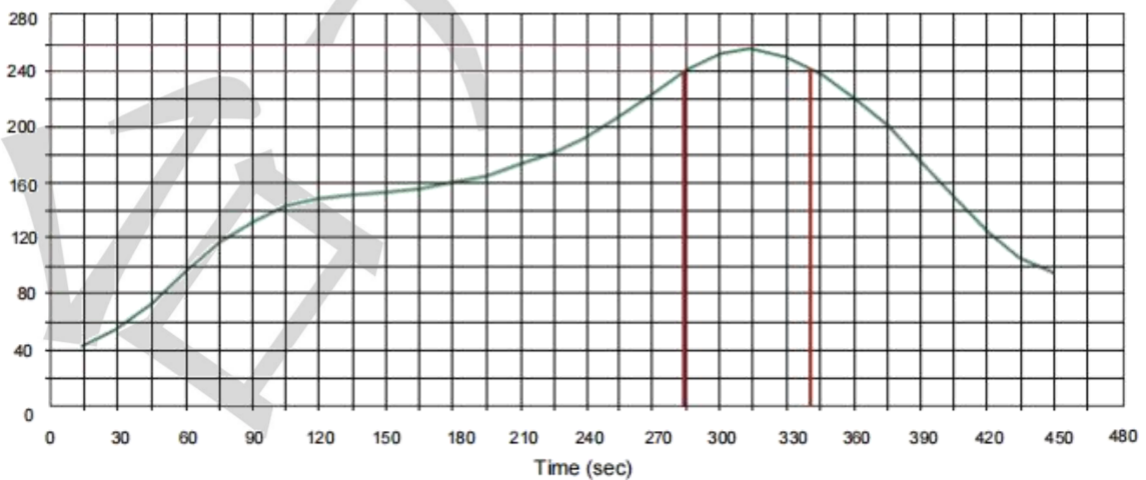

Fig 2. Leakage Current

**Solder Reflow Recommendation**

Peak Temp=257°C, Ramp Rate=0.802deg. °C/sec



**Package Outline & Dimensions**  
**SOD323**

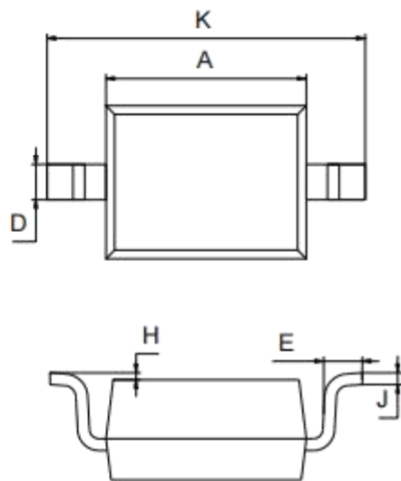

SOD-323		
Dim	Min	Max
A	1.60	1.80
B	1.20	1.40
C	0.80	0.90
D	0.25	0.35
E	0.22	0.42
H	0.02	0.10
J	0.05	0.15
K	2.55	2.75

**Mounting Pad Layout-SOD323 (unit: mm)**

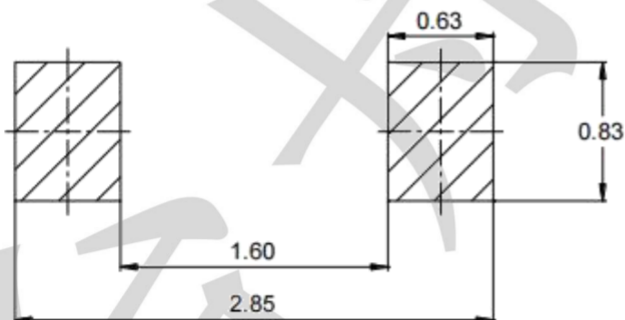

## X-ON Electronics

Largest Supplier of Electrical and Electronic Components

*Click to view similar products for* [Diodes - General Purpose, Power, Switching category:](#)

*Click to view products by* [TECH PUBLIC manufacturer:](#)

Other Similar products are found below :

[MMBD3004S-13-F](#) [1N3611](#) [NTE156A](#) [NTE6244](#) [1SS400CST2RA](#) [SDAA13](#) [SHN2D02FUTW1T1G](#) [1N4449](#) [1N456A](#) [1N914BTR](#)  
[D291S45T](#) [BAS 16-02L E6327](#) [BAS 16-02V H6327](#) [BAS 21U E6327](#) [BAS 28 E6327](#) [BAW56DWQ-7-F](#) [BAW56M3T5G](#) [BAW75-TAP](#)  
[MM230L-CAA](#) [IDW40E65D1](#) [JAN1N3600](#) [JAN1N4454UR-1](#) [SMMSD4148T3G](#) [BYW95B/A52A](#) [NSVDAN222T1G](#) [CDSZC01100-HF](#)  
[BAV70HDW-7](#) [BAS28-7](#) [JANTX1N6640](#) [BAW56HDW-13](#) [BAS28 TR](#) [VS-HFA04SD60STR-M3](#) [1SS388-TP](#) [BAV99TQ-13-F](#)  
[BAV99HDW-13](#) [1N4004](#) [MMDB30-E28X](#) [LS4148](#) [IDV15E65D2](#) [W0503RH200S0L](#) [M0268SJ200NLF](#) [M0268RJ200NLF](#) [S3MBF](#) [US1J](#)  
[DAN217U-TP](#) [SHV-06JNS-Q](#) [IDW30C65D1](#) [IDW80C65D1](#) [VS-HFA30TA60CSR-M3](#) [M1MA152WAT1](#)