

PROPERTY OF DEUTSCH E.C.D.
 This drawing contains proprietary information that shall not be disclosed, duplicated,
 nor used in whole or in part for any purpose other than to evaluate this drawing.

A 0810-201-2001

REVISIONS			
REV	DESCRIPTION	DATE	APPROVED
A	REVISED PER E.O. D1083	7/6/01	J.H.

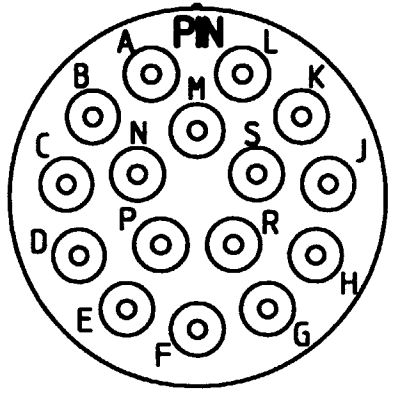

GROMMET
PIN SIDE

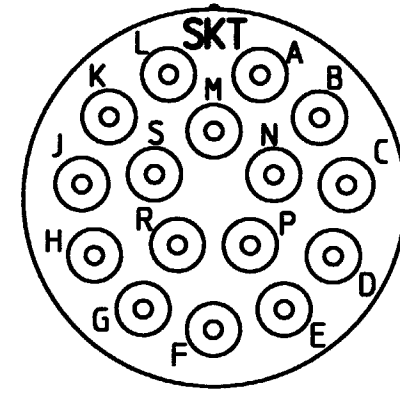
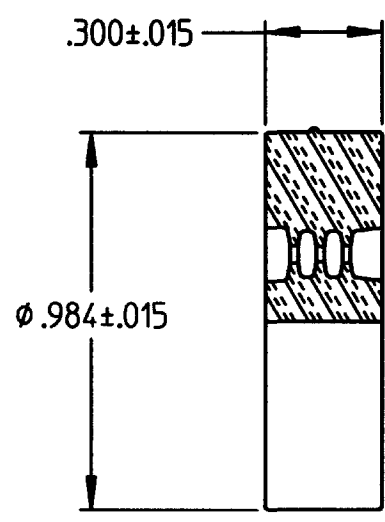

GROMMET
SOCKET SIDE

5. ALLISON PART NUMBER WTA10-20-03 REF.
4. GROMMET IS USED WITH BOTH SIZE 20 FOLLOWERS FOR 16 MM AND 19 MM SPLIT CONVOLUTED TUBING.
3. GROMMET ARRANGEMENT IS 20-16 PER MIL-STD-1669.
2. MATERIAL: SILICONE ELASTOMER (RED).
1. ALL DIMENSIONS ARE IN INCHES UNLESS OTHERWISE SPECIFIED.

SIGNATURE & DATE	
DR	R. GROSS 11-1-94
CHK	JP 11/9/94
PE	R. Doss 11-1-94
APPD	APD
SCALE	NONE WT

SECONDARY GROMMET
 ALLISON WTA10-20-00
 BACKSHELL SYSTEM
 SIZE 20
 16 SIZE 16 CAVITIES
 ENVELOPE

CP	PART CODE
	DEUTSCH ENGINEERED CONNECTING DEVICES 5733 W. Whittier Ave. Hemet, California
A	0810-201-2001
DWG SIZE	CODE SHEET 1 OF 1

0810-201-2001.dwg

X-ON Electronics

Largest Supplier of Electrical and Electronic Components

Click to view similar products for [Automotive Connectors](#) category:

Click to view products by [TE Connectivity](#) manufacturer:

Other Similar products are found below :

[003-018-000](#) [60403001](#) [60993906-B](#) [M902-2131](#) [M902-2161](#) [M902-2344](#) [72.330.1035.1](#) [73.353.4028.0](#) [F119300-B](#) [F166900](#) [F258300-B](#)
[F358300-B](#) [F407400](#) [F444110](#) [F487000](#) [F509500B-B](#) [827153-1](#) [8N1515-32-24P](#) [9-1326729-8](#) [925474-1](#) [928905-1](#) [964562-4](#) [968782-1](#)
[GT17SA-8DS-HU](#) [98891-1012](#) [98947-1016](#) [12004147](#) [12004475-L](#) [12010290](#) [12010309-B](#) [12015454](#) [12020219-B](#) [12041318-B](#) [12052225-](#)
[L](#) [12052466](#) [12064869](#) [12004327-B](#) [12015308](#) [12015384](#) [12015909](#) [1-21030-1](#) [12041254](#) [12041318](#) [12047946-B](#) [12047957](#) [12047957-L](#)
[12059473](#) [12066261](#) [12110546](#) [12110546-B](#)