

NOTES:

1. ALL DIMENSIONS ARE IN INCHES [MILLIMETERS] [GRAMS] LBS

2. DIMENSIONS APPEARING IN TABLE ARE AS FOLLOWS:

a AS SUPPLIED
b AFTER UNRESTRICTED RECOVERY

3. COATING (ADHESIVE) IS OPTIONAL AS SUPPLIED DIMENSIONS APPEARING IN TABLE ARE FOR UNCOATED PARTS.

DIAMETERS WILL BE REDUCED BY .06 MAX. WHEN COATING IS ADDED, ENTRY MOLDING PORTS ARE OPTIONAL.

4. WHEN -00 MODIFICATION NUMBER IS SPECIFIED MOLDING PORTS WILL BE LOCATED AS SHOWN.

ON SIZES 222A111 AND 222A121 THE 0.18 INCH DIAMETER MOLDING PORT AT "T" WILL BE ELIMINATED. THE 0.12" DIA MOLDING PORT WILL BE ENLARGED TO 0.18 INCHES

5. WEIGHT SHOWN IN TABLE OF DIMENSIONS IS BASED ON POLYOLEFIN PART

6. ORDERING INFORMATION

222A1XX -XX -XX /XXX /0

BASE PART NUMBER

MATERIAL DASH NUMBER

-3 POLYOLEFIN, SEMI RIGID (RT-301)

-4 POLYOLEFIN, FLEXIBLE (RT-1304)

-5 ELASTOMER, FLEXIBLE (RT-501)

-6 SILICONE (RT-602)

-12 FLUORO ELASTOMER, FLEXIBLE (RT-1312)

-25 ELASTOMER, FLUID RESISTANT (RW-2070)

-100 POLYOLEFIN, SEMI-FLEXIBLE ZEROHAL (RT-1323)

MODIFICATION NUMBER

ADHESIVE SLASH NUMBER

SEE COMPATIBILITY CHART BELOW

COLOR DESIGNATOR

IF THIS DOCUMENT IS PRINTED IT BECOMES UNCONTROLLED. CHECK FOR THE LATEST REVISION.

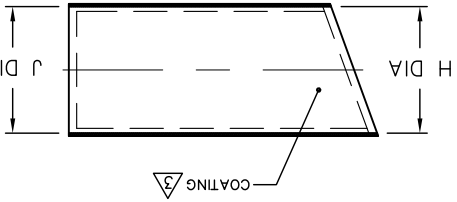

AS SUPPLIED

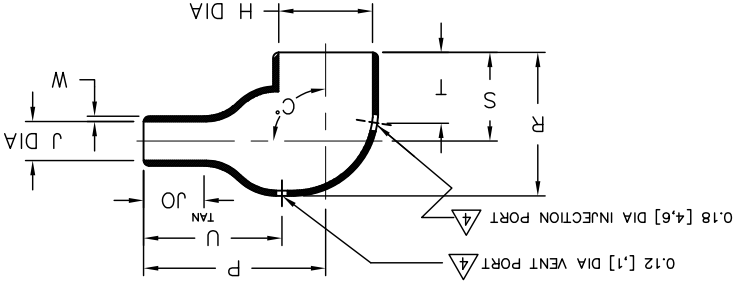

AFTER UNRESTRICTED RECOVERY

TABLE OF DIMENSIONS

PART DESCRIPTION	H		J		P	R	S	T	U	JO	W	C.	
	MIN	MAX	MIN	MAX	b	b	b	b	b	b	b	b	b
222A111	.70	.31	.70	.39	.15	.68	.79	.61	N/A	.45	.17	.04	.002
222A121	.98	.40	.98	.21	.84	.21	.89	.65	N/A	.58	.23	.05	.003
222A132	1.18	.56	1.18	.81	.25	1.06	1.05	.73	.75	.70	.28	.06	.006
222A142	1.28	.68	1.28	.27	1.44	1.20	1.20	.81	.75	.98	.40	.07	.014
222A152	1.42	.86	1.42	.33	1.72	1.38	.90	.75	1.18	.50	.07	.019	.014
222A163	1.73	1.08	1.73	.37	2.11	1.73	1.15	.75	1.34	.68	.08	.029	.014
222A174	2.09	1.33	2.09	.59	2.98	2.08	1.34	1.00	1.26	.13	.077	.077	.014
222A185	2.66	1.74	2.66	.80	3.84	2.60	1.66	1.00	1.60	.15	.143	.143	.014
222A196	3.45	2.18	3.45	1.28	5.04	3.12	1.93	1.00	2.22	.18	.310	.310	.014

CUSTOMER DRAWING

UNLESS OTHERWISE SPECIFIED DIMENSIONS ARE IN INCHES. METRIC DIMENSIONS ARE IN BRACKETS.

APPROVED: YUNGUEN

TE CONNECTIVITY

305 Constitution Dr
Menlo Park, CA 94025

BOOT, 90 DEGREE, THIN WALL

DO NOT SCALE THIS DRAWING

222A111 thru 196

06090

TE CONNECTIVITY RESERVES THE RIGHT TO CHANGE THIS DRAWING AT THE DISCRETION OF THE USER

THIRD ANGLE PROJECTION

SIZE B

CODE IDENT. NO. 06090

© 2015 Tyco Electronics Corporation, a TE Connectivity Company. All rights reserved.

SHEET 1 OF 1

COMPATIBILITY CHART

MATERIAL DASH NO.	ADHESIVE (COATING) SLASH NO.
-3; -4	/42; /86
-5	/42
-6; -12	NOT APPLICABLE
-25	S-1017; S-1048; S-1206
-100	/86; /180; /184

X-ON Electronics

Largest Supplier of Electrical and Electronic Components

Click to view similar products for [Heat Shrink Cable Boots & End Caps](#) category:

Click to view products by [TE Connectivity](#) manufacturer:

Other Similar products are found below :

[577159N001](#) [007758-000](#) [610368N003](#) [645494-000](#) [M85049/141-02HU](#) [M85049/141-03HU](#) [M85049/141-04HU](#) [687025-000](#) [705331-000](#)
[718446-000](#) [725666N001](#) [729257-000](#) [F21914-000](#) [F27131-000](#) [F85868-000](#) [770-006A103R](#) [770-006A304W1](#) [770-006A305W1](#) [770-](#)
[006A308W1](#) [770-011T303W1](#) [770-011T304W1](#) [770-020S702W1](#) [770-020S704W1](#) [806138-000](#) [806542N001](#) [807507-000](#) [808059-000](#)
[808296-000](#) [808362-000](#) [808828-000](#) [809125-000](#) [809130-000](#) [809218-000](#) [811218-000](#) [811288-000](#) [812014-000](#) [812047-000](#) [813166-000](#)
[813767N002](#) [814417-000](#) [819115N001](#) [819117N001](#) [823026-000](#) [823070-000](#) [825002-000](#) [841189N001](#) [861471-000](#) [866647-000](#) [937577-](#)
[000](#) [950764-000](#)