

THIS DRAWING IS UNPUBLISHED. RELEASED FOR PUBLICATION  
 © COPYRIGHT - By - ALL RIGHTS RESERVED.

LOC	DIST	REVISIONS			
P	LTR	DESCRIPTION	DATE	DWN	APVD
AD	39	J	REVISED PER ECO-15-008006	17NOV2015	NK MM

- 1 NO OF POSITIONS INDICATED PERTAINS TO THE HOUSING.
- 2 THIS COVER IS TO BE USED WITH 102536 .
- 3 MATERIAL: FLAME RETARDANT THERMOPLASTIC, COLOR-BLACK.

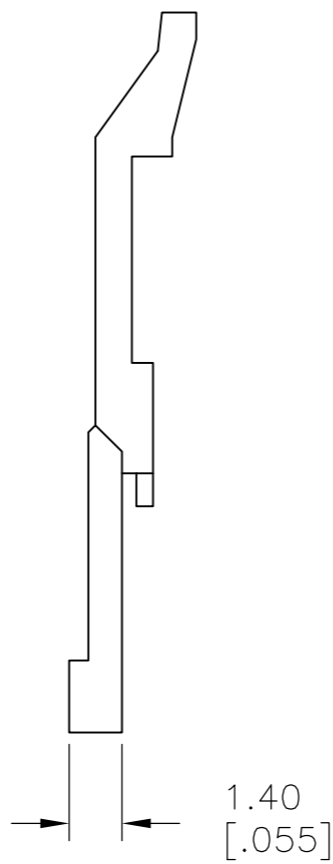
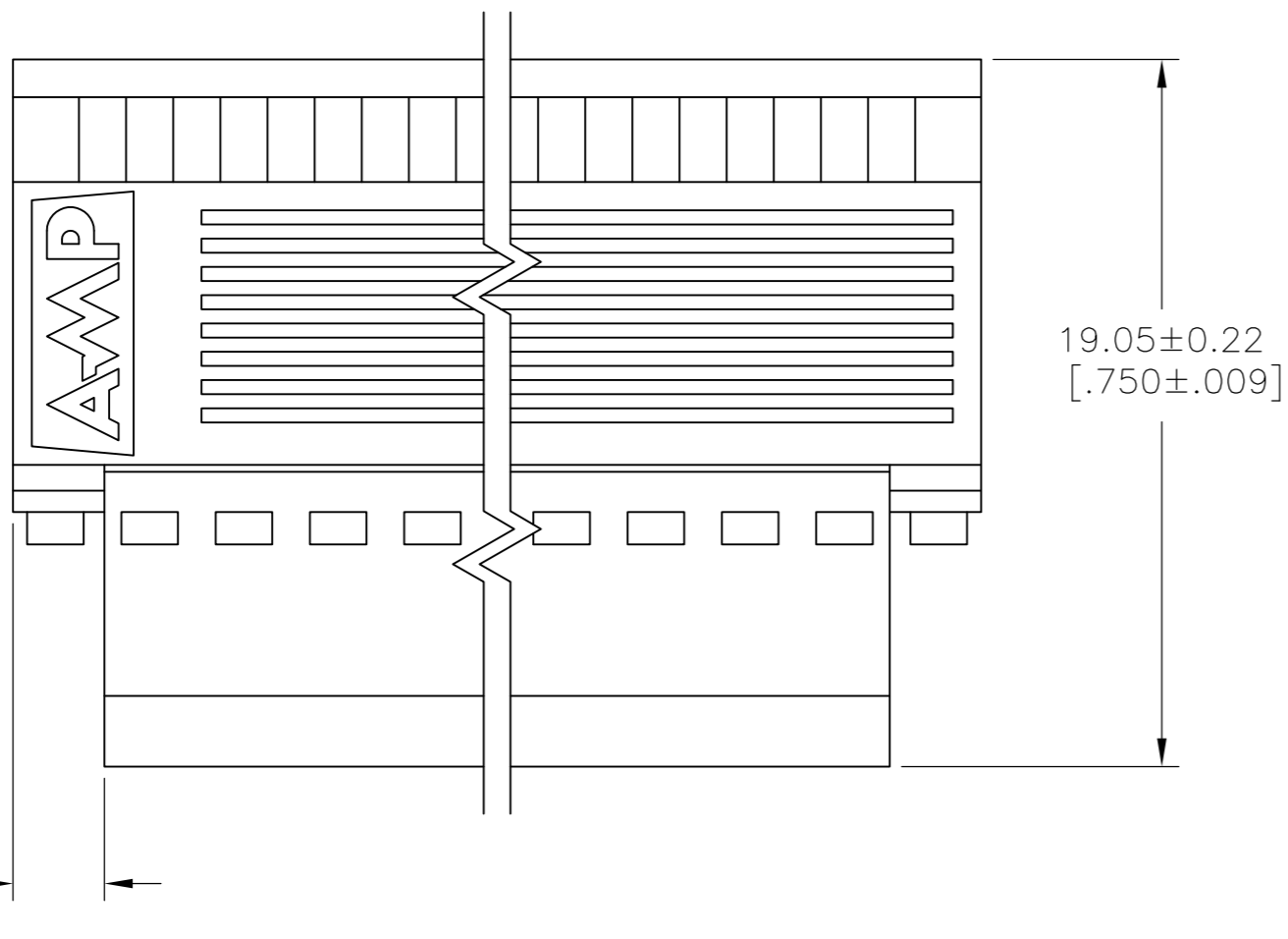
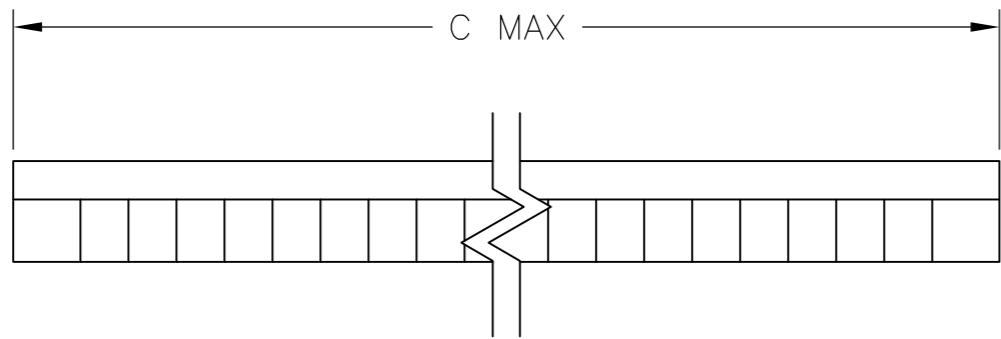
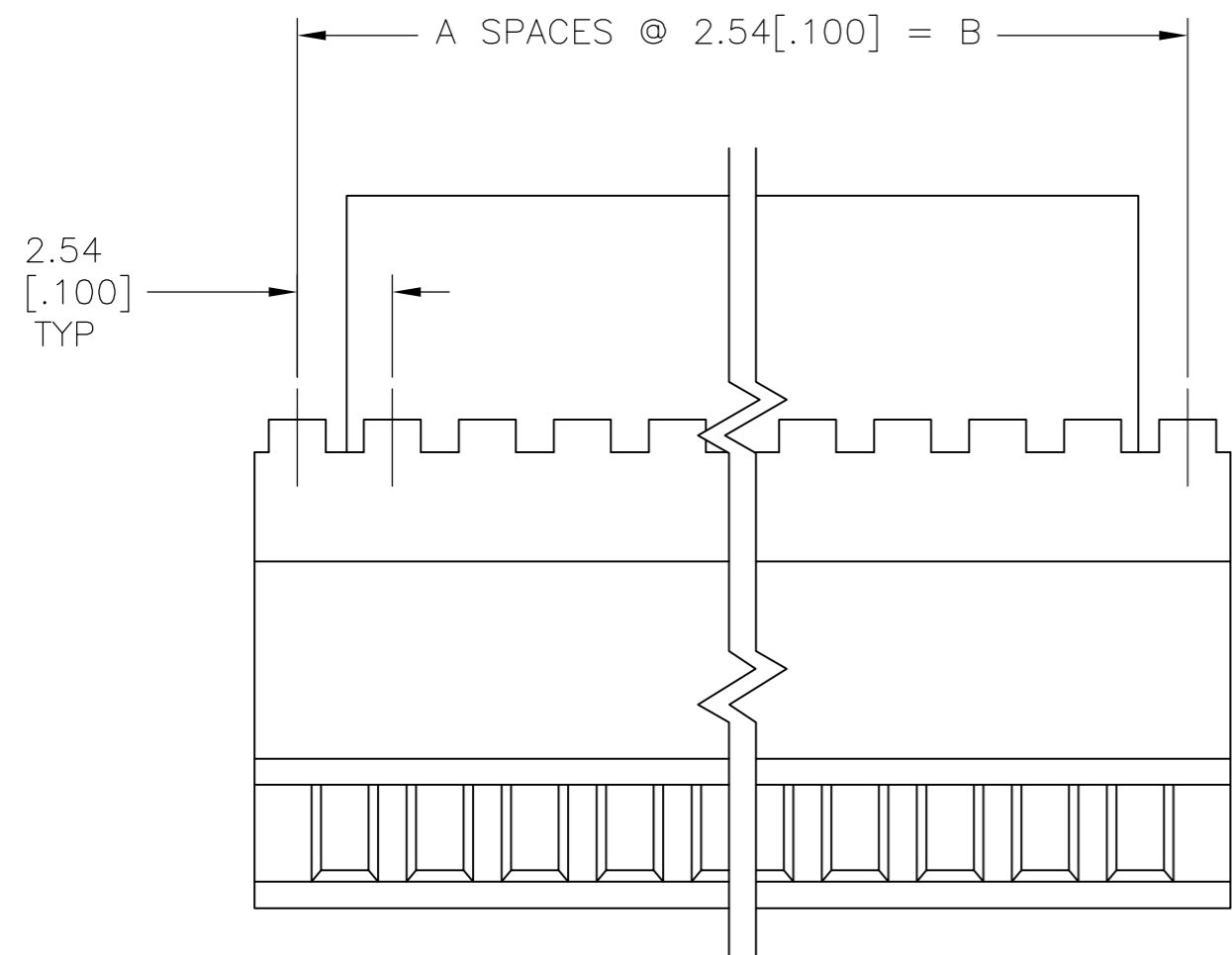

OBSOLETE	91.44[3.600]	88.90[3.500]	35	72	-3-102540-4
OBSOLETE	88.90[3.500]	86.36[3.400]	34	70	-3-102540-3
OBSOLETE	86.36[3.400]	83.82[3.300]	33	68	-3-102540-2
OBSOLETE	83.82[3.300]	81.28[3.200]	32	66	-3-102540-1
OBSOLETE	81.28[3.200]	78.74[3.100]	31	64	-3-102540-0
OBSOLETE	78.74[3.100]	76.20[3.000]	30	62	-2-102540-9
OBSOLETE	76.20[3.000]	73.66[2.900]	29	60	-2-102540-8
OBSOLETE	73.66[2.900]	71.12[2.800]	28	58	-2-102540-7
OBSOLETE	71.12[2.800]	68.58[2.700]	27	56	-2-102540-6
OBSOLETE	68.58[2.700]	66.04[2.600]	26	54	-2-102540-5
OBSOLETE	66.04[2.600]	63.50[2.500]	25	52	-2-102540-4
OBSOLETE	63.50[2.500]	60.96[2.400]	24	50	-2-102540-3
OBSOLETE	60.96[2.400]	58.42[2.300]	23	48	-2-102540-2
OBSOLETE	58.42[2.300]	55.88[2.200]	22	46	-2-102540-1
OBSOLETE	55.88[2.200]	53.34[2.100]	21	44	-2-102540-0
OBSOLETE	53.34[2.100]	50.80[2.000]	20	42	-1-102540-9
OBSOLETE	50.80[2.000]	48.26[1.900]	19	40	-1-102540-8
OBSOLETE	48.26[1.900]	45.72[1.800]	18	38	-1-102540-7
OBSOLETE	45.72[1.800]	43.18[1.700]	17	36	-1-102540-6
OBSOLETE	43.18[1.700]	40.64[1.600]	16	34	-1-102540-5
OBSOLETE	40.64[1.600]	38.10[1.500]	15	32	-1-102540-4
	38.10[1.500]	35.56[1.400]	14	30	1-102540-3
	35.56[1.400]	33.02[1.300]	13	28	1-102540-2
	33.02[1.300]	30.48[1.200]	12	26	1-102540-1
	30.48[1.200]	27.94[1.100]	11	24	1-102540-0
	27.94[1.100]	25.40[1.000]	10	22	102540-9
	25.40[1.000]	22.86[.900]	9	20	102540-8
	22.86[.900]	20.32[.800]	8	18	102540-7
	20.32[.800]	17.78[.700]	7	16	102540-6
	17.78[.700]	15.24[.600]	6	14	102540-5
	15.24[.600]	12.70[.500]	5	12	102540-4
	12.70[.500]	10.16[.400]	4	10	102540-3
	10.16[.400]	7.62[.300]	3	8	102540-2
	7.62[.300]	5.08[.200]	2	6	102540-1
	C MAX	B	A	REF. 1	PART NUMBER
	COVER DIMENSIONS			NO OF POSN	

THIS DRAWING IS A CONTROLLED DOCUMENT.

DIMENSIONS: mm [INCHES]	TOLERANCES UNLESS OTHERWISE SPECIFIED: 0 PLC ± - 1 PLC ± - 2 PLC ± - 3 PLC ± 0.13[.005] 4 PLC ± - ANGLES ± - FINISH	DWN RAGHAVENDRA 06MAR09 CHK JEFFREY GESFORD 06MAR09 APVD JEFFREY GESFORD 06MAR09 PRODUCT SPEC - APPLICATION SPEC - WEIGHT -	NAME TE Connectivity COVER - HALF, LOW PROFILE MASS TERMINATION AMPMODU, .100CL, FULL BAR POLARIZATION
MATERIAL 3		CUSTOMER DRAWING	SIZE A2 CAGE CODE 00779 DRAWING NO C=102540 RESTRICTED TO - SCALE 5:1 SHEET 1 of 1 REV J

## X-ON Electronics

Largest Supplier of Electrical and Electronic Components

*Click to view similar products for [Headers & Wire Housings](#) category:*

*Click to view products by [TE Connectivity](#) manufacturer:*

Other Similar products are found below :

[892-18-020-10-001101](#) [58102-G61-06LF](#) [582553-1](#) [0009485154](#) [009176003701906](#) [0050291907](#) [LY20-4P-DT1-P1E-BR](#) [02.125.8002.8](#)  
[609-3404](#) [61062-3](#) [61082-181009](#) [622-3653LF](#) [63453-116](#) [636-1030](#) [636-1427](#) [636-3427](#) [636-4007](#) [641938-9](#) [641991-4](#) [644827-2](#) [65817-](#)  
[010LF](#) [65817-015LF](#) [65863-015LF](#) [66207-023LF](#) [67095-007LF](#) [67601157](#) [68645-018](#) [68648-049](#) [70.362.1628.0](#) [70-4210](#) [70-4226B](#) [70-](#)  
[4853B](#) [707-5020](#) [707-5028](#) [71.350.2428.0](#) [71918-208LF](#) [71961-016LF](#) [733-134](#) [733-162](#) [754199-000](#) [760-3052](#) [787-8014-00](#) [79531-3000](#)  
[FCN-360C032-B](#) [FCN-367T-T012/H](#) [FCN-723D010/2](#) [80.063.4001.1](#) [800-90-001-10-001000](#) [800-90-010-10-002000](#) [801-43-002-10-013000](#)