

REV	109026-31	REVISION HISTORY			
-		REV	DESCRIPTION	DATE	APPROVED
		-	NEW RELEASE PER E.O. C7809	100315	A.R.

DEUTSCH PART NUMBER	SIZE	WIRE GAGE RANGE	RECOMMENDED STRIP LENGTH	CRIMP TOOLS - MS	
				BASIC TOOL	POSITIONER
109026-31	16	20 TO 24	.273 TO .303	MIL-C-22520/7-01	MIL-C-22520/7-03

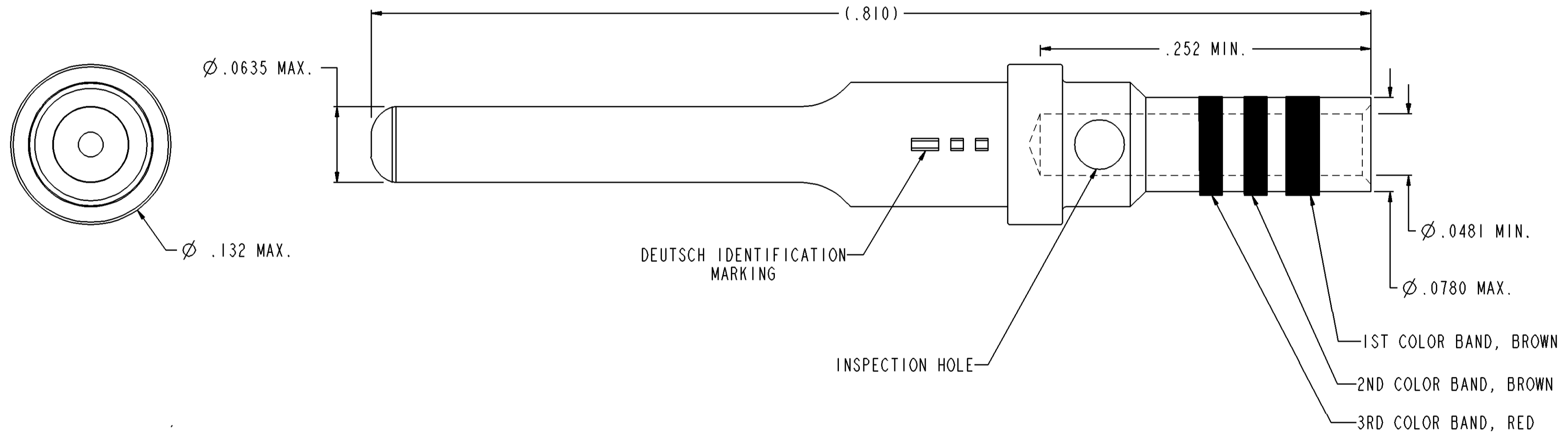

- 3. MATERIAL: COPPER ALLOY
- 2. FINISH: GOLD OVER NICKEL
- 1. DIMENSIONS ARE IN INCHES

NOTES: UNLESS OTHERWISE SPECIFIED.

PROPERTY OF DEUTSCH E.C.D. THIS DRAWING CONTAINS PROPRIETARY INFORMATION THAT SHALL NOT BE DISCLOSED, DUPLICATED, NOR USED IN WHOLE OR IN PART FOR ANY PURPOSE OTHER THAN TO EVALUATE THIS DRAWING

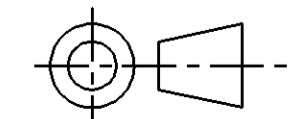

SIGNATURE & DATE	
DR	M. A. 100308
CHK	A. R. 100315
PE	M. A. 100308
APPD	A. R. 100315
MATERIAL	
FINISH	
MATERIAL CODE	

ALL SHEETS ARE THE SAME REVISION STATUS			
 DEFENSE/AEROSPACE OPERATION 250 EDDIE JONES WAY OCEANSIDE, CA 92058			
TITLE CONTACT, PIN			
SIZE 16 CONTACT, SIZE 20-24 GAGE WIRE DBA SERIES ENVELOPE			
SIZE	CAGE CODE	DWG NO	
C	11139	109026-31	
SCALE	NONE	WEIGHT	NONE
SHEET		1 OF 1	

NBO

X-ON Electronics

Largest Supplier of Electrical and Electronic Components

Click to view similar products for [Circular MIL Spec Contacts](#) category:

Click to view products by [TE Connectivity](#) manufacturer:

Other Similar products are found below :

[006-1189-20](#) [71-VEAM](#) [809-023](#) [809-111](#) [811393-000](#) [850-014](#) [97-45-1418P-4\(0920\)](#) [97-45-1418S-4](#) [D-602-0106CS076](#) [AIC12-14P](#)
[AIC16-16PG](#) [AIC8-12P](#) [AIC8-8SG](#) [AIC8-8SRAD](#) [1495044-1](#) [BACC47CP2T](#) [BACC47DP4](#) [BACC47GC1A](#) [BACC47GN1](#) [16968/2C](#) [21-](#)
[033909-028](#) [241611N001](#) [2560-220-2031](#) [27964-38T112](#) [2M809-118](#) [97-67-36-20](#) [AIC12-16P](#) [AIC16-18PG](#) [AIC16-20PG](#) [AIC4-4PG](#)
[CE102S-18](#) [M39029/30-221](#) [M39029/30-222](#) [M39029/77-430](#) [416-2020-088I](#) [MDM-21SH003B-F222](#) [48-100-5014P-02](#) [BA-4020-50LD](#)
[BA-4120-50LD](#) [BACC47CN2](#) [BACC47CN3S](#) [BACC47GC3A](#) [BACC47GD3A](#) [BACC47GM1](#) [52G137 REV A](#) [CB2-18-21PS](#) [D-602-](#)
[1116CS2727](#) [D-602-1117CS2727](#) [419-2082-102](#) [419-2085-102](#)