

THIS DRAWING IS UNPUBLISHED. RELEASED FOR PUBLICATION
 © COPYRIGHT - By - ALL RIGHTS RESERVED.

| REVISIONS | | | | |
|-----------|-----|---------------------------|----------|---------|
| P | LTR | DESCRIPTION | DATE | APVD |
| | D3 | REVISED PER ECO-17-008188 | 4JAN2018 | C.X D.Z |

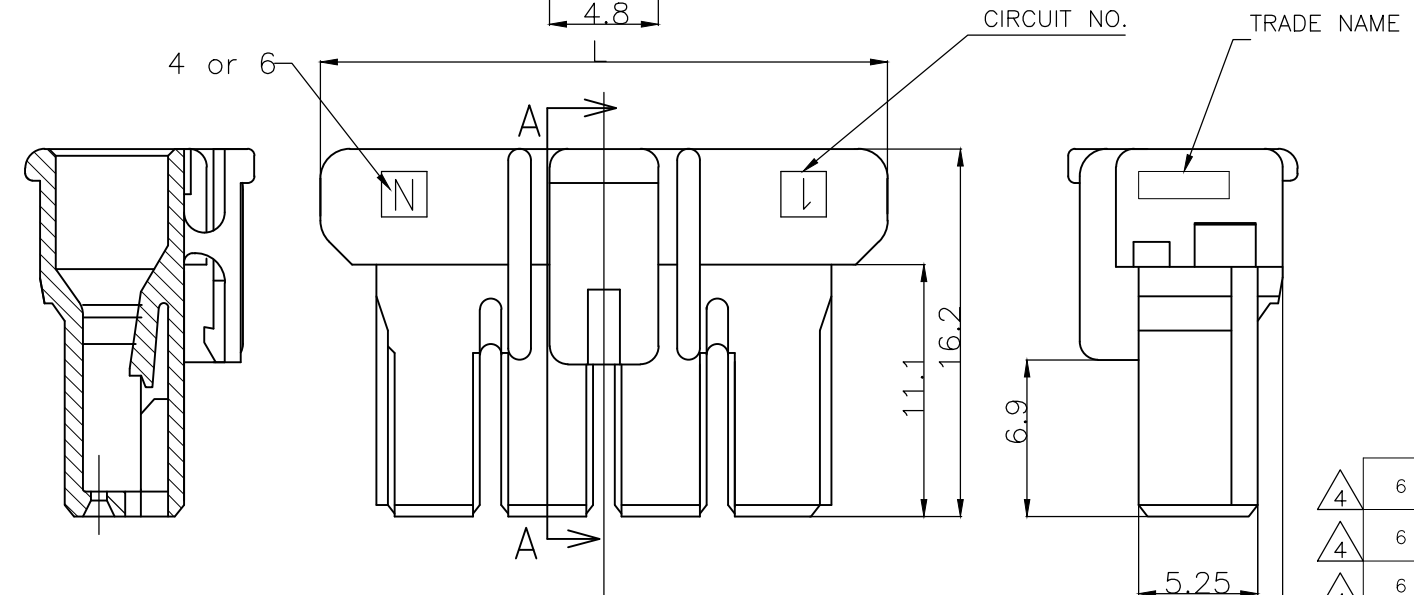

THE TYPE OF KEYING

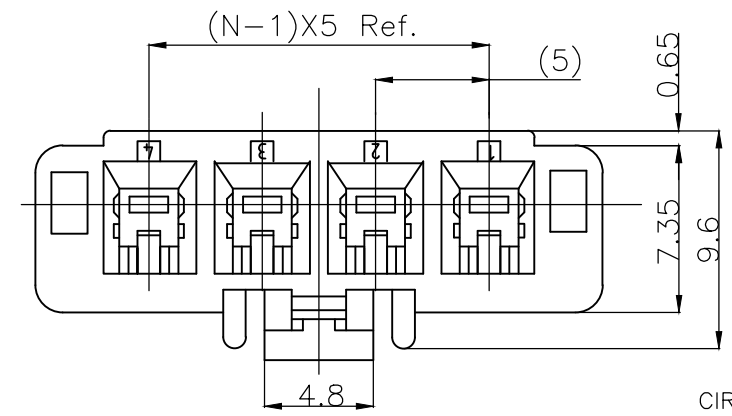
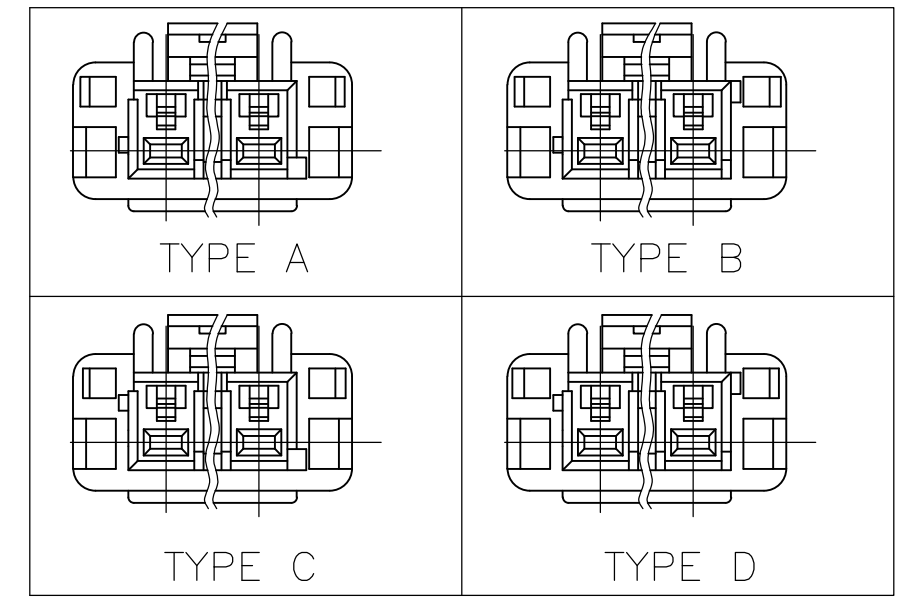

| | |
|--------|--------------------------------------|
| HOSING | 6 / 6 NYLON GRASS FILLED/ NYLON 6 |
| NAME | MATERIAL |

SECT A-A

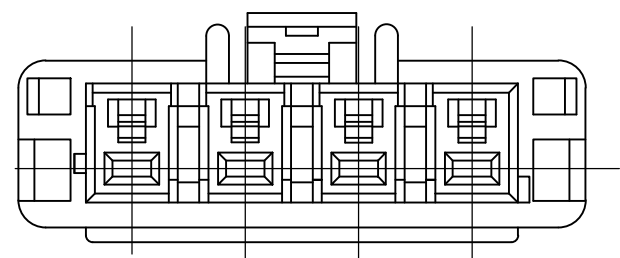

| 4 | 6 | 25 | 35 | 1376397-1 | 3-1376385-4 | TYPE D | YELLOW | 6Pos | 3-1376391-4 | | | |
|-----------|---|----|----|-----------|-------------|--------|-----------------------|------------------|--------------------|-------|-----|----------|
| 4 | 6 | 25 | 35 | 1376397-1 | 2-1376385-3 | TYPE C | BLUE | 6Pos | 2-1376391-3 | | | |
| 4 | 6 | 25 | 35 | 1376397-1 | 1-1376385-2 | TYPE B | RED | 6Pos | 1-1376391-2 | | | |
| 4 | 6 | 25 | 35 | 1376397-1 | 1376385-1 | TYPE A | NATURAL | 6Pos | 1376391-1 | | | |
| 3 | 4 | 15 | 25 | 1376396-1 | 1-1376384-5 | TYPE B | RED | 4Pos | 1-1376390-5 | | | |
| 3 | 4 | 15 | 25 | 1376396-1 | 1-1376384-6 | TYPE A | NATURAL | 4Pos | 1376390-5 | | | |
| 4 | 4 | 15 | 25 | 1376396-1 | 3-1376384-4 | TYPE D | YELLOW | 4Pos | 3-1376390-4 | | | |
| 4 | 4 | 15 | 25 | 1376396-1 | 2-1376384-3 | TYPE C | BLUE | 4Pos | 2-1376390-3 | | | |
| 4 | 4 | 15 | 25 | 1376396-1 | 1-1376384-2 | TYPE B | RED | 4Pos | 1-1376390-2 | | | |
| 4 | 4 | 15 | 25 | 1376396-1 | 1376384-1 | TYPE A | NATURAL | 4Pos | 1376390-1 | | | |
| DIMENSION | | | | N | M | L | APPLICABLE PLATE. P/N | MATING CONN. P/N | THE TYPE OF KEYING | Color | Pos | PART NO. |

1 MATING CONN. P/N
 HEADER ASS'Y :SEE TABLE
 REC CONTACT ;1376347-1,1376348-1

2 PARTS COMPLY WITH GLOW WIRE
 REQUIREMENT FOR PARTS OF NON-METALLIC
 MATERIAL SUPPORTING A CURRENT-CARRYING
 CONNECTION DETAILED IN IEC 60335-1,
 SECTION 30 (GWT) .

- 3 NYLON 6, GWT, V-2.
- 4 NYLON 66, GWT, V-0.

| | | | | |
|--|--|-------------------------------|--|--------------------|
| THIS DRAWING IS A CONTROLLED DOCUMENT. | | DWN A.OISHI 31AUG00 | TE Connectivity | |
| DIMENSIONS: mm | | CHK Y.KASHIWA 28AUG'00 | | |
| TOLERANCES UNLESS OTHERWISE SPECIFIED: | | APVD Y.KASHIWA 28AUG'00 | NAME 5.0 POWER KEY CONNECTOR 4P PLUG HOUSING | |
| 0 PLC ± 0.2 1 PLC ± 0.2 2 PLC ± 0.2 3 PLC ± 4 PLC ± ANGLES ± 1° | | PRODUCT SPEC 108-5699 | SIZE A3 | |
| MATERIAL SEE TABLE | | FINISH SEE TABLE | APPLICATION SPEC 104-5292 | CAGE CODE 00779 |
| | | WEIGHT | DRAWING NO C-1376390 | |
| | | CUSTOMER DRAWING | | RESTRICTED TO - |
| | | SCALE 3:1 | | SHEET 1 OF 1 |
| | | | | REV D3 |

X-ON Electronics

Largest Supplier of Electrical and Electronic Components

Click to view similar products for [Automotive Connectors](#) category:

Click to view products by [TE Connectivity](#) manufacturer:

Other Similar products are found below :

[003-018-000](#) [60403001](#) [60993906-B](#) [M902-2131](#) [M902-2161](#) [M902-2344](#) [72.330.1035.1](#) [73.353.4028.0](#) [F119300-B](#) [F166900](#) [F258300-B](#)
[F358300-B](#) [F407400](#) [F444110](#) [F487000](#) [F509500B-B](#) [827153-1](#) [8N1515-32-24P](#) [9-1326729-8](#) [925474-1](#) [928905-1](#) [964562-4](#) [968782-1](#)
[GT17SA-8DS-HU](#) [98891-1012](#) [98947-1016](#) [12004147](#) [12004475-L](#) [12010290](#) [12010309-B](#) [12015454](#) [12020219-B](#) [12041318-B](#) [12052225-](#)
[L](#) [12052466](#) [12064869](#) [12004327-B](#) [12015308](#) [12015384](#) [12015909](#) [1-21030-1](#) [12041254](#) [12041318](#) [12047946-B](#) [12047957](#) [12047957-L](#)
[12059473](#) [12066261](#) [12110546](#) [12110546-B](#)