

THIS DRAWING IS UNPUBLISHED. RELEASED FOR PUBLICATION
 © COPYRIGHT BY TYCO ELECTRONICS CORPORATION. ALL RIGHTS RESERVED.

LOC	DIST	REVISIONS					
		P	LTR	DESCRIPTION	DATE	DWN	APVD
AD	OO	B		ECO 06 000585	07AUG06	BSV	MZ

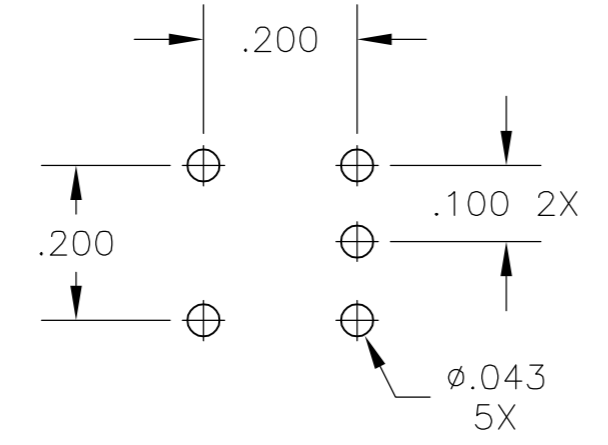
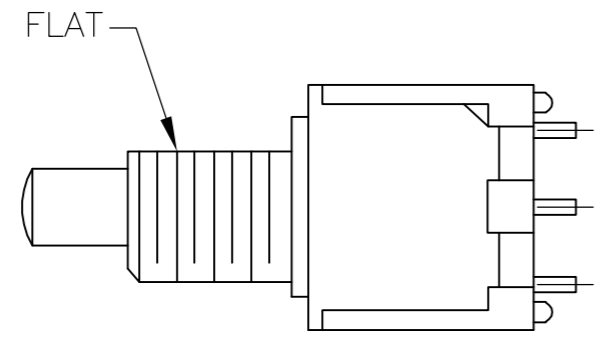
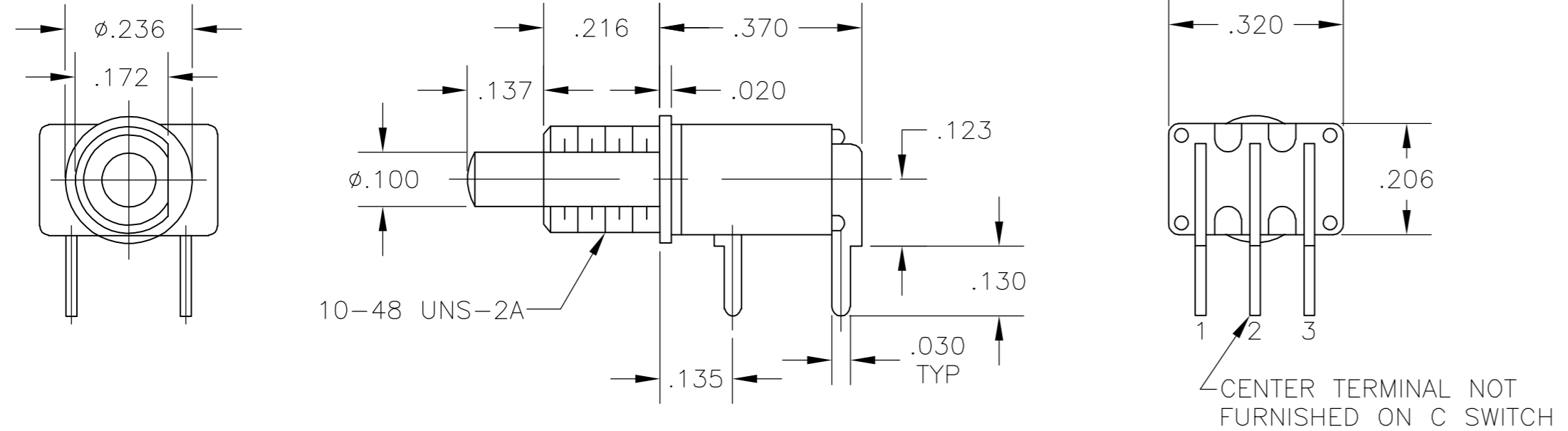

RECOMMENDED HOLE LAYOUT
 TOLERANCE $\pm.002$ UNLESS
 OTHERWISE NOTED

(*)	BUTTON COLOR
0	BLACK
2	RED
6	BLUE

SPECIFICATIONS:

MATERIALS:
 CASE: HIGH TEMPERATURE POLYESTER, UL 94V-0
 ACTUATOR BUTTON: THERMOPLASTIC, COLORS: SEE CHART BELOW
 MOVING CONTACT: COPPER ALLOY, GOLD PLATED
 FIXED CONTACT: COPPER ALLOY, GOLD PLATED
 TERMINALS: COPPER ALLOY, TIN LEAD PLATED
 TERMINAL SEAL: SP EPOXY
 DP EPOXY OPTIONAL

ELECTRICAL:
 CONTACT RATING: GOLD=0.4VA MAX. @20VDC OR PEAK AC
 INITIAL CONTACT RESISTANCE: 20 MILLIOHMS MAX.
 INSULATION RESISTANCE: 1,000 MEGOHMS @500VDC MIN
 DIELECTRIC STRENGTH: 1,000VAC @SEA LEVEL
 LIFE EXPECTANCY: GOLD: 1 POLE = 100,000 CYCLES
 2 POLES = 80,000 CYCLES

MECHANICAL:
 ACTUATION FORCE: 50 TO 400g
 ACTUATION TRAVEL: .030 APPROX.

ENVIRONMENTAL:
 OPERATING TEMPERATURE: -22°F TO $+149^{\circ}\text{F}$ (-30°C TO $+65^{\circ}\text{C}$)
 STORAGE TEMPERATURE: -22°F TO $+149^{\circ}\text{F}$ (-30°C TO $+65^{\circ}\text{C}$)

- NOTES:**
- INTERPRET DRAWING PER ASME Y14.5M-1994
 - SUPPLIED WITH MOUNTING HARDWARE.
 - \triangle SPECIFICATIONS ARE SUBJECT TO CHANGES WITHOUT NOTICE.

TERMINALS CONNECTED WITH BUTTON IN POSITIONS SHOWN		
MODEL NO.	FLAT	FLAT
TPC11CG-RA (*)	OFF	1-3 (MOM)
TPC11FG-RA (*)	2-1	2-3 (MOM)

NOTE:
 TERMINAL DESIGNATION NUMBERS ARE FOR
 REFERENCE ONLY AND DO NOT APPEAR ON
 SWITCHES.

AUGAT D/N 40046

THIS DRAWING IS A CONTROLLED DOCUMENT.		DWN R.WINGROVE 10NOV80	Tyco Electronics Corporation Harrisburg, Pa 17105-3608	
DIMENSIONS: INCHES		CHK B.BUCKHEIT 11NOV80		
TOLERANCES UNLESS OTHERWISE SPECIFIED:		APVD RD 11NOV80	NAME PUSH BUTTON SWITCH TPC11*G-RA(*)	
0 PLC \pm - 1 PLC \pm - 2 PLC \pm - 3 PLC \pm .010 4 PLC \pm - ANGLES \pm 1'		PRODUCT SPEC -	SIZE A2	
MATERIAL SEE SPECIFICATIONS		FINISH SEE SPECIFICATIONS	WEIGHT -	CAGE CODE 00779
		DRAWING NO C=1437572-7		RESTRICTED TO -
		CUSTOMER DRAWING		SCALE 4:1
		SHEET 1 OF 1		REV B

1437572-7

X-ON Electronics

Largest Supplier of Electrical and Electronic Components

Click to view similar products for [Pushbutton Switches](#) category:

Click to view products by [TE Connectivity](#) manufacturer:

Other Similar products are found below :

[LW1L-M1C10V-A](#) [LW2L-A1C20M-GD](#) [LW2L-M1C20M-A](#) [60324L](#) [M7E-HRN2](#) [67021K512](#) [67081K512X](#) [701PB580](#) [719-5504-000](#)
[MDPSSGLFS](#) [810KSV30B](#) [FLT 2U EE 01A](#) [MML21KA3ABK](#) [MML23KA3AC05K-001](#) [MML23KW3AA01W](#) [8418K2](#) [8646AB6X718UL](#)
[8646ABUL](#) [FSDWH](#) [9001KXRK](#) [9001T8BK](#) [9533CD4+U574+U4922](#) [1203MRA](#) [A22EM01S](#) [A595](#) [12037A2ULCSA](#) [1203A2UL](#)
[ABD122N-B](#) [1211390004](#) [ABN111-Y](#) [ABN400-R](#) [1211500044](#) [1211580012](#) [1212MRA](#) [1232A6NF](#) [1241.1183.7047](#) [1241.2511](#) [1241.3428](#)
[1223A2ULCSA](#) [1223MRA](#) [1232AX2119](#) [1241.1183.8000](#) [1241.1183.8029](#) [1241.2506](#) [1241.2606](#) [12MA6](#) [1301940184](#)
[RELBARF6X10\(PLASTIC\)](#) [13435AG](#) [13440AD2G25X822+U4546](#)