

LOC	DIST	REVISIONS	DATE	DMN	APVD
E	B				
P	LTR	DESCRIPTION			
A		RELEASE FOR PRODUCTION	6-9-01	RG	FWK

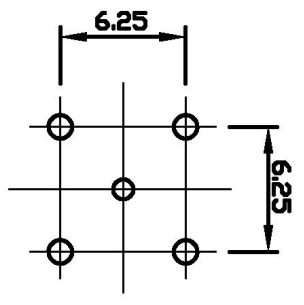
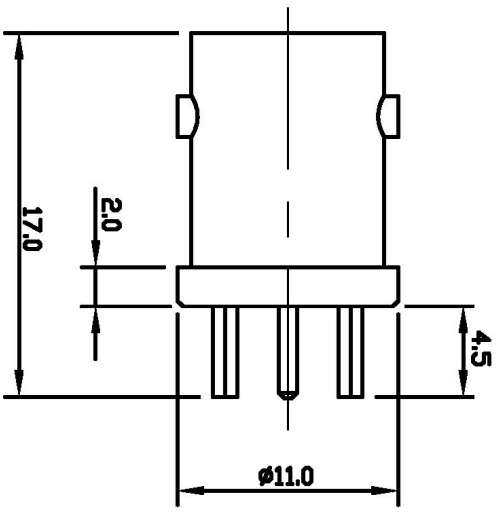

(4) Ø1.2 MIN
 (1) Ø1 MIN

MOUNTING HOLE

ALL DIMENSIONS ARE NOMINAL, FOR REFERENCE ONLY.

DIE SET PART NUMBER	N/A
HANDTOOL PART NUMBER	N/A
FOR USE ON CABLES	N/A
CONNECTOR PLATING DETAIL	SILVER
CONTACT PLATING DETAIL	SILVER
DIELECTRIC MATERIAL	PTFE
GASKET MATERIAL	N/A

THIS DRAWING IS A CONTROLLED DOCUMENT.	
DIMENSIONS: MM	TOLERANCES UNLESS OTHERWISE SPECIFIED:
	0 P/LC ±
	1 P/LC ±
	2 P/LC ±
	3 P/LC ±
	4 P/LC ±
	5 P/LC ±
	FINISH
	-

DMN	R. GOODALL	6-9-01			
CHK	F. W-KING	07-SEP-00			
APVD	F. W-KING	6-9-01			
PRODUCT SPEC	108-3435				
APPLICATION SPEC					
WEIGHT					
CUSTOMER DRAWING					
SIZE	A3	CAGE CODE	00779	DRAWING NO	1478204
RESTRICTED TO					

BAG	SINGLE ITEM	1-1478204-0
PACK TYPE	DESCRIPTION	PART NUMBER

Tyco
 Tyco Electronics Corporation
 Stonnmore, Middlesex, HA7 4RS

BNC STRAIGHT PCB SOCKET 50 Ohm

X-ON Electronics

Largest Supplier of Electrical and Electronic Components

Click to view similar products for [RF Connectors](#) / [Coaxial Connectors](#) category:

Click to view products by [TE Connectivity](#) manufacturer:

Other Similar products are found below :

[R125315120](#) [8915-1511-000](#) [89674-0827](#) [5916-1103-603](#) [0106-001-000](#) [6-0001-3](#) [6001-7071-019](#) [6002-7051-003](#) [6002-7551-202](#) [6059674-1](#) [619550-1](#) [630059-000](#) [M39012/25-0021](#) [M39012/79-3008](#) [M39030/3-01N](#) [M39030/3-03N](#) [M3933/25-36N](#) [6500-7071-046](#) [6501-1071-002](#) [M83723/72W2457N](#) [6769](#) [CX050L2AQ](#) [7002-1541-010](#) [7002-1572-002](#) [7003-1572-002](#) [7004-1512-000](#) [7009-1511-004](#) [7010-1511-000](#) [7029-1511-060](#) [7101-1541-010](#) [7101-1571-002](#) [7105-1521-002](#) [7145-1521-002](#) [7209-1511-011](#) [7210-1511-012](#) [7210-1511-015](#) [7210-1511-019](#) [7210-1511-040](#) [7225-1512-050](#) [7242-1511-000](#) [73137-5015](#) [73251-0111](#) [73251-0672](#) [73276-1501](#) [73366-0013](#) [73404-2300](#) [73413-6080](#) [734151610](#) [73415-5721](#) [7405-1521-005](#)