

SCALA NON IMPEGNATIVA  
(DO NOT SCALE)  
DIMENSIONI IN mm  
(DIMENSIONS IN mm)

**METRIC**

THIRD ANGLE  
PROJECTION

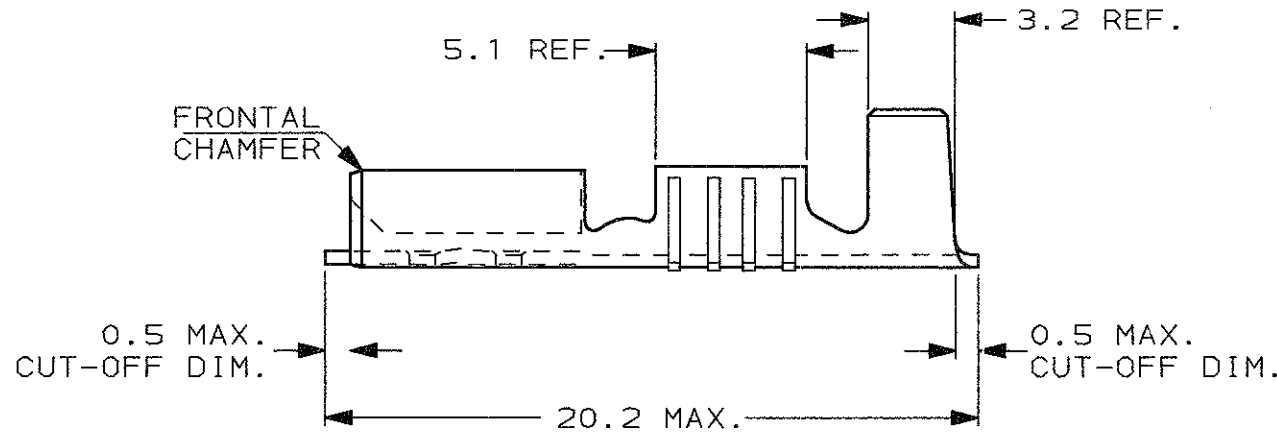
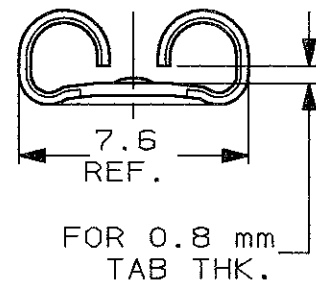
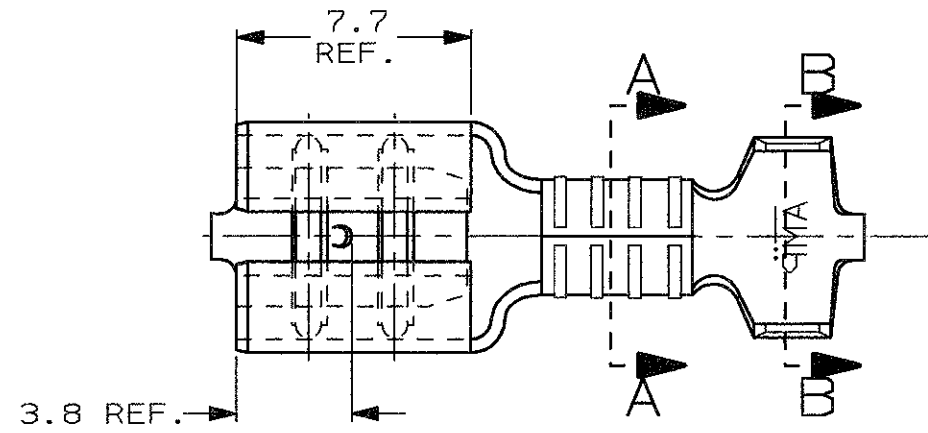

1) PER LE VERSIONI IN NASTRO  
VEDERE DISEGNO 160256  
(FOR STRIP FORM VERSION SEE DRAWING 160256)

SEZIONE A-A  
SECTION A-A

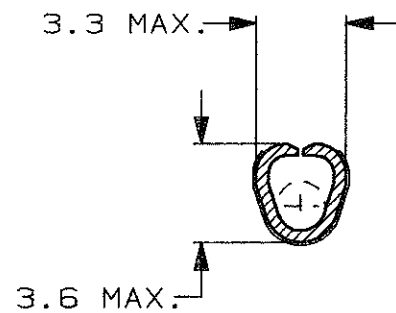

SEZIONE B-B  
SECTION B-B

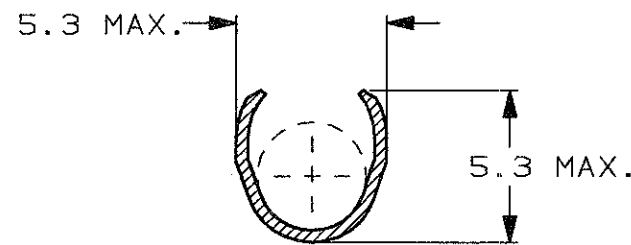

**OBSOLETE**

PRE NICHELATO (PRE NICKELPLATED)	ACCIAIO (STEEL)	2-160304-4	Y
STAGNATO (TIN PLATED)	BRONZO FOS. (PHOS. BRONZE)	1-160304-8	Y
ARGENTATO (SILVER PLATED)	OTTONE (BRASS)	<del>1-160304-7</del>	Y
NUDO (PLAIN)	BRONZO FOS. (PHOS. BRONZE)	1-160304-5	Y
STAGNATO (TIN PLATED)	OTTONE (BRASS)	1-160304-2	Y
NUDO (PLAIN)	OTTONE (BRASS)	1-160304-0	Y
FINITURA / COLORE (FINISH / COLOUR)	MATERIALE (MATERIAL)	NUMERO (PART NUMBER)	REV

CUSTOMER DWG. FOR REFERENCE ONLY      DISEGNO PER CLIENTE SOLO PER RIFERIMENTO

THIS DRAWING IS UNPUBLISHED. RELEASE FOR PUBLICATION 19  
© COPYRIGHT 19 BY TE INCORPORATED, HARRISBURG, PA. ALL INTERNATIONAL RIGHTS RESERVED. TE PRODUCTS MAY BE COVERED BY U.S. AND FOREIGN PATENT AND/OR PATENT PENDING

TOLLERANZE: SE NON DIVERSAMENTE SPECIFICATO (TOLERANCES, UNLESS OTHERWISE SPECIFIED)	DIAM. ISOLANTE (INS. DIA. RANGE)	RANGO FILO (WIRE RANGE) mm2	SCALA (SCALE)
± 0.3	3.0-4.3	1.0-2.5	4:1

ANGOLI (ANGLES) ± 2°      **TE** TE Connectivity

DIS. H. YAALI (DR.) 15 SEP 2000      DESCRIZIONE (DESCRIPTION) FASTON® Connector, .250" sr. REC. CONTACT. (LOOSE PIECE VERSION)

Y1 ECR-10-022530	KK 02FEB11	CONT. C. TARTARI (CHK) 15 SEP 2000	LOC. SIZE NUMERO (DWG NO)	REV. FOGLIO (SHEET)
Y OBSOLETE PARTS & REDRAWN ET00-0246-00	H. Y. 02 JAN 2001	APP. (APP.)	I A3 C-160304	Y1 1 DI (OF) 1
REV. (REV.)	DIS. DATA (DR) (DATE)	APP. (APP.)		

DISTRIBUZIONE (PRINT DIST.)

## X-ON Electronics

Largest Supplier of Electrical and Electronic Components

*Click to view similar products for [Terminals](#) category:*

*Click to view products by [TE Connectivity](#) manufacturer:*

Other Similar products are found below :

[00-054007-01074-6](#) [00-054007-70206-1](#) [00-054007-70210-8](#) [00-054007-70217-7](#) [00-054007-70226-9](#) [00-054007-70228-3](#) [00-054007-70248-1](#) [00-054007-70256-6](#) [00-054007-70301-3](#) [00-054007-70316-7](#) [00-054007-49560-4](#) [00-054007-70209-2](#) [00-054007-70225-2](#) [00-054007-70227-6](#) [00-054007-70231-3](#) [00-054007-70241-2](#) [00-054007-70242-9](#) [00-054007-70244-3](#) [00-054007-70246-7](#) [00-054007-70263-4](#) [00-054007-70288-7](#) [00-054007-70290-0](#) [00-054007-70300-6](#) [00-054007-70304-4](#) [01-2065-1-0216](#) [01-2900-1-04412](#) [00581P0075](#) [600TS-10](#) [60205-1](#) [604200-1](#) [605601-1](#) [60598-1-CUT-TAPE](#) [61314-6-C](#) [61810-3](#) [61-S](#) [61-SN](#) [626-0194](#) [62-NBM-A](#) [62-SN](#) [62-SP](#) [63-S](#) [640179-1](#) [M55155/059I03](#) [M55155/079C01](#) [M55155/099H02](#) [M55155/109H01](#) [M55155/109H02](#) [M55155/12XH05](#) [M55155/16XH02](#) [M55155/29-5S](#)