



Introducing Corcom CU Series 1U Height Power Entry Modules

The CU series joins the Corcom product family of Power Entry Modules, filling the need for smaller versions of our switched inlet filters and unfiltered power inlets. This series provides power entry for equipment designed for popular 1U (1.75") height equipment racks. The filtered versions provide complete shielding, shrouded quick connect terminals and basic filtering for 1A to 15A applications, in an extremely compact size.





KEY FEATURES

- Compact 1U (1.75”) Design
- 1A-15A*
- Filtered and Unfiltered
- SPST Switch
- Shrouded Quick-Connect Terminals
- Various Mounting Styles
- Lower Power Dissipation
- Higher System Efficiency
- Lower Cooling Demand
- UL Recognized, CSA Certified and VDE Approved*

* 15A versions tested by Underwriters Laboratories to US and Canadian requirements and are VDE approved at 10A @ 250 VAC.

STANDARDS AND SPECIFICATIONS



- UL Recognized
- CSA Certified
- VDE Approved

APPLICATIONS

- Rack mounted equipment
- Telecom
- Consumer electronics
- Power supplies
- Routers
- PCs
- TVs
- Lighting
- Imaging equipment
- Set-top boxes
- Other applications with limited panel space.

ELECTRICAL SPECIFICATIONS

		Filtered	Unfiltered
Maximum leakage current each Line to Ground:	@120 VAC 60 Hz:	.25 mA	2 µA
	@ 250 VAC 50 Hz:	.40 mA	5 µA
Hipot rating (one minute):	Line to Ground:	2250 VDC	
	Line to Line:	1450 VDC	
Operating Voltage:		120/250 VAC	
Operating Frequency:		50/60 Hz	
Rated Current:		1 to 15A*	
Switch:		50A inrush capable SPST	
Terminal Push-on Force:		15lb. /67N (max.)	

ELECTRICAL SCHEMATIC

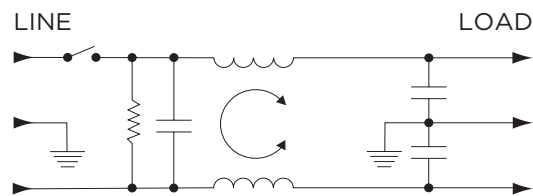

ORDERING INFORMATION

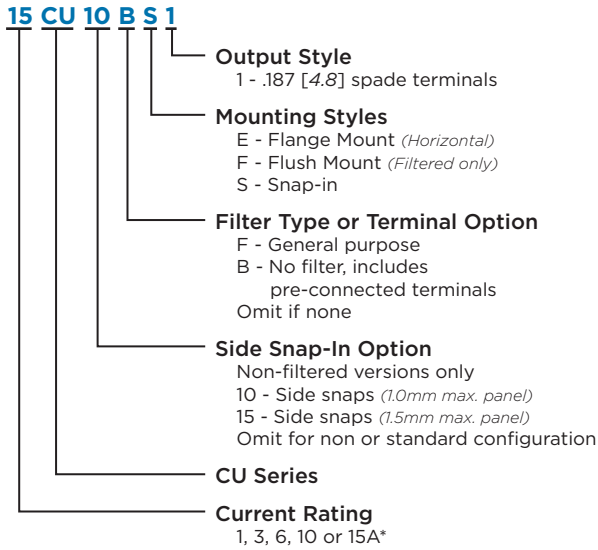

PRODUCT OFFERING

Filtered Versions					
Flange Mount		Flush Mount (rear)		Snap-In	
2-1609113-2:	1CUFE1	2-1609114-2:	1CUFF1	2-1609113-7:	1CUFS1
2-1609113-3:	3CUFE1	2-1609114-3:	3CUFF1	2-1609113-8:	3CUFS1
2-1609113-4:	6CUFE1	2-1609114-4:	6CUFF1	2-1609113-9:	6CUFS1
2-1609113-5:	10CUFE1	2-1609114-5:	10CUFF1	2-1609114-0:	10CUFS1
2-1609113-6:	15CUFE1	2-1609114-6:	15CUFF1	2-1609114-1:	15CUFS1

Non-filtered Versions			
Standard Terminals		Pre-connected Terminals	
2-1609114-7:	15CUE1	2-1609114-8:	15CUBE1
2-1609114-9:	15CUS1	1-1609112-5:	15CUBS1
1-1609112-6:	15CU10S1	1-1609112-7:	15CU10BS1
1-1609112-8:	15CU15S1	1-1609112-9:	15CU15BS1

RECOMMENDED PANEL CUTOUT

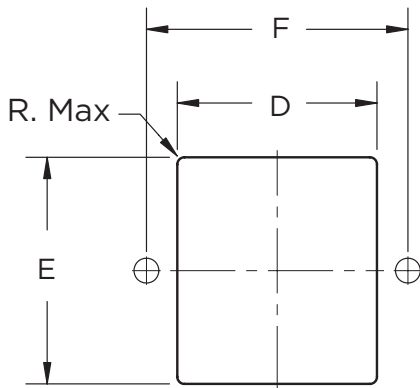

Model	Panel Thickness	R Dim.
CUFF1	.157 [4.00] max.	1.8 [45.72]
CUFS1, CUS1	.025 – .082 [0.63 – 2.1]	1.0 [25.4]
CUFS1, CUS1	.028 – .039 [0.7 – 1.0]	1.0 [25.4]
CUFS1, CUS1	.047 – .059 [1.2 – 1.5]	1.0 [25.4]

Note 1: CUFF1 allows for back mounting only
 Note 2: All other models allow for front mounting only

PERFORMANCE DATA

Minimum Insertion Loss - Measured in closed 50 Ohm system

Common Mode / Asymmetrical (Line to Ground)

Current Rating	Frequency – MHz						
	0.05	0.15	0.05	1	5	10	30
1A	19	30	44	49	47	44	45
3A	13	23	37	43	47	44	49
6A	5	14	28	34	43	43	48
10A	1	7	19	25	35	36	52
15A	-	1	10	13	25	27	42

Differential Mode / Symmetrical (Line to Line)

Current Rating	Frequency – MHz						
	0.05	0.15	0.05	1	5	10	30
1A	1	10	21	26	48	51	60
3A	1	10	20	26	42	45	65
6A	1	10	20	23	38	41	65
10A	1	10	20	23	29	34	56
15A	1	10	20	23	28	39	54

CASE STYLES

CUE1

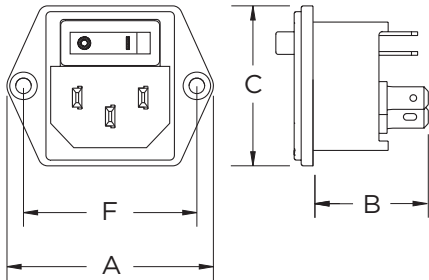

Typical Dimensions:
 Mounting holes (2): .183 [3.5] Dia. with .228 [5.8] Dia. x 90° countersink for M3 flathead screw
 Line Inlet (1): IEC 60320-1 C14
 Terminals (2): .187 [4.8] with .055 [1.4] Dia. hole
 Ground Terminal (1): .187 [4.8] with .112 x .06 [2.8 x 1.5] slot

CUBE1 Pre-connected Terminals

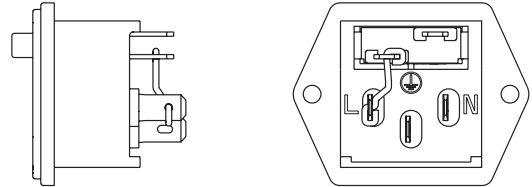

CUS1

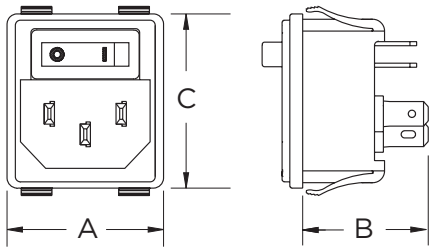

Typical Dimensions:
 Line Inlet (1): IEC 60320-1 C14
 Terminals (2): .187 [4.8] with .055 [1.4] Dia. hole
 Ground Terminal (1): .187 [4.8] with .112 x .06 [2.8 x 1.5] slot

CUBS1 Pre-connected Terminals

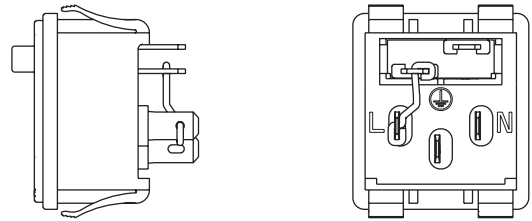

CU10S1 & CU15S1

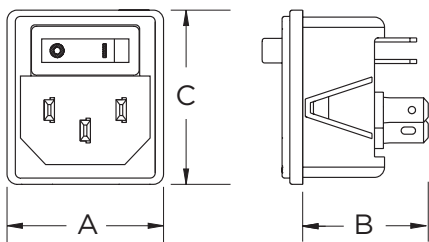

Available for panel thickness .07 - 1.0mm (CU10S1) or 1.2 - 1.55mm (CU15S1)

Typical Dimensions:
 Line Inlet (1): IEC 60320-1 C14
 Terminals (2): .187 [4.8] with .055 [1.4] Dia. hole
 Ground Terminal (1): .187 [4.8] with .112 x .06 [2.8 x 1.5] slot

CU10BS1 & CU15BS1 Pre-connected Terminals

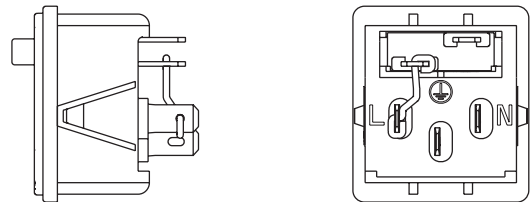

NOTE: Switch output terminal configurations for any unfiltered version may vary from that shown here. Dimensions are not affected.

CASE STYLES

CUFE1

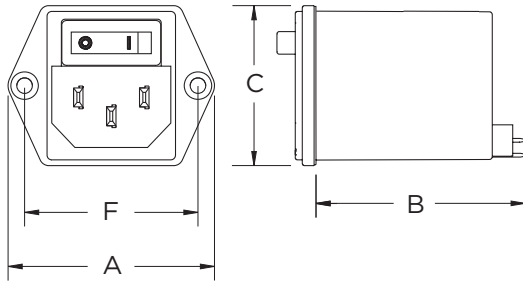

Typical Dimensions:
 Mounting holes (2): .183 [3.5] Dia. with .228 [5.8] Dia. x 90° countersink for M3 flathead screw IEC 60320-1 C14
 Line Inlet (1): .187 [4.8] with .055 [1.4] Dia. hole
 Terminals (2): .187 [4.8] with .112 x .06 [2.8 x 1.5] slot
 Ground Terminal (1): .187 [4.8] with .112 x .06 [2.8 x 1.5] slot
 Output Shroud: .21 x .34 [5.2 x 8.6] inside dimension

CUFF1

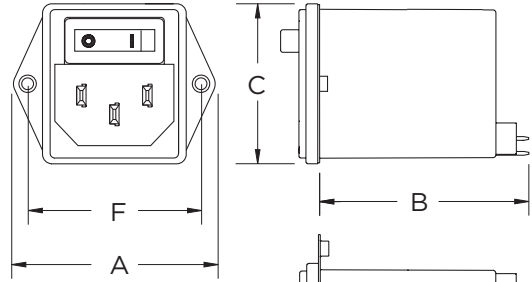

Typical Dimensions:
 Mounting holes (2): .183 [3.5] Dia. with .228 [5.8] Dia. x 90° countersink for M3 flathead screw IEC 60320-1 C14
 Line Inlet (1): .187 [4.8] with .055 [1.4] Dia. hole
 Terminals (2): .187 [4.8] with .112 x .06 [2.8 x 1.5] slot
 Ground Terminal (1): .187 [4.8] with .112 x .06 [2.8 x 1.5] slot
 Output Shroud: .21 x .34 [5.2 x 8.6] inside dimension

Note: For rear mounted applications only. Max. panel thickness: .157 [4.0]

CUFS1

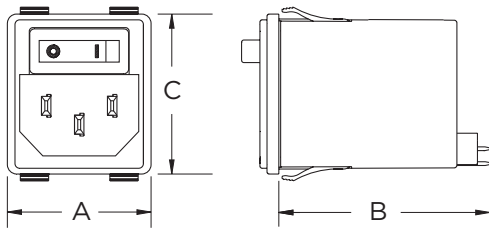

Typical Dimensions:
 Line Inlet (1): IEC 60320-1 C14
 Terminals (2): .187 [4.8] with .055 [1.4] Dia. hole
 Ground Terminal (1): .187 [4.8] with .112 x .06 [2.8 x 1.5] slot
 Output Shroud: .21 x .34 [5.2 x 8.6] inside dimension

CASE DIMENSIONS

Part Numbers	A (max)	B (max)	C (max)	D ±0.004 ±0.100	E ±0.004 ±0.100	F ±0.004 ±0.100
CUFE1	1.73	1.75	1.34	1.11	1.26	1.45
	43.9	44.5	34.1	28.1	31.9	36.8
CUFF1	1.7	1.8	1.34	1.21	1.35	1.45
	43.1	45	34.1	30.8	34.3	36.8
CUFS1	1.2	1.8	1.34	1.11	1.26	-
	30.6	45	34.1	28.1	32	-
CUE1, CUBE1	1.73	0.96	1.34	1.06	1.09	1.45
	43.9	24.6	34.1	26.9	27.6	36.8
CUS1, CUBS1	1.2	0.97	1.34	1.04	1.26	-
	30.6	24.6	34.1	26.4	32	-
10CUS1, 10CUBS1	1.2	0.97	1.34	1.05	1.24	-
	30.6	24.6	34.1	26.7	31.6	-
15CUS1, 15CUBS1	1.2	0.97	1.34	1.05	1.24	-
	30.6	24.6	34.1	26.7	31.6	-

FOR MORE INFORMATION

corcom.com

TE Technical Support Center

Internet: te.com/help
USA: +1 (800) 522-6752
Canada: +1 (905) 475-6222
Mexico: +52 (0) 55-1106-0800
Latin/S. America: +54 (0) 11-4733-2200
Germany: +49 (0) 6251-133-1999
UK: +44 (0) 800-267666
France: +33 (0) 1-3420-8686
Netherlands: +31 (0) 73-6246-999
China: +86 (0) 400-820-6015

Part numbers in this brochure are RoHS Compliant*, unless marked otherwise.

*as defined www.te.com/leadfree

te.com

© 2011 Tyco Electronics Corporation, a TE Connectivity Ltd. company. All Rights Reserved.
1773455-1 CIS JG 06/2011

TE Connectivity, TE connectivity (logo) and TE (logo) are trademarks. Other logos, product and/or company names might be trademarks of their respective owners.

While TE has made every reasonable effort to ensure the accuracy of the information in this brochure, TE does not guarantee that it is error-free, nor does TE make any other representation, warranty or guarantee that the information is accurate, correct, reliable or current. TE reserves the right to make any adjustments to the information contained herein at any time without notice. TE expressly disclaims all implied warranties regarding the information contained herein, including, but not limited to, any implied warranties of merchantability or fitness for a particular purpose. The dimensions in this catalog are for reference purposes only and are subject to change without notice. Specifications are subject to change without notice. Consult TE for the latest dimensions and design specifications.



X-ON Electronics

Largest Supplier of Electrical and Electronic Components

Click to view similar products for [AC Power Entry Modules](#) category:

Click to view products by [TE Connectivity](#) manufacturer:

Other Similar products are found below :

[0098.0050](#) [6-1609987-9](#) [6167.0002](#) [7-6609955-2](#) [FN389-4-22](#) [FN9233ER-12-06](#) [FN9233S1-10-06](#) [FN9233S1-8-06](#) [FN9233S1B-8-06](#)
[FN9233S1R-1-06](#) [FN9233S1R-12-06](#) [FN9233SB-1-06](#) [FN9233SB-12-06](#) [FN9233SB-8-06](#) [FN9233SR-10-06](#) [FN9233SR-3-06](#) [FN9244B-15-06](#)
[HI](#) [FN9244EB-3-06](#) [FN9244EB-8-06](#) [FN9244ER-15-06](#) [FN9244ER-8-06](#) [FN9244ES1-8-06](#) [FN9244ESB-8-06](#) [FN9244EU-6-06](#)
[FN9244R-12-06](#) [FN9244R-3-07](#) [FN9244R-8-06](#) [FN9244S1-10-06](#) [FN9244S1-12-06](#) [FN9244S1-3-06](#) [FN9244S1B-6-06](#) [FN9244S1R-3-06](#)
[FN9244S-6-06](#) [FN9244SB-10-06](#) [FN9244SB-6-06](#) [FN9244SB-8-06](#) [FN9244SR-10-06](#) [FN9244SR-6-06](#) [FN9244U-3-06](#) [FN9244U-8-06](#)
[FN9260A-6-06](#) [PE00SSSXB](#) [Fuse-H-EUR-1](#) [Fuse-H-USA-1](#) [PM00XD000](#) [PS0SSDBX0](#) [PS0SXSH3B](#) [A-0701-HT-H](#) [RAPC3FG](#) [15EJMS8](#)