

LOC	DIST	REVISIONS					
		P	LTN	DESCRIPTION	DATE	DWN	APVD
CM	00	E		REVISE PER ECR-13-003272	18JUN2013	KH	TM

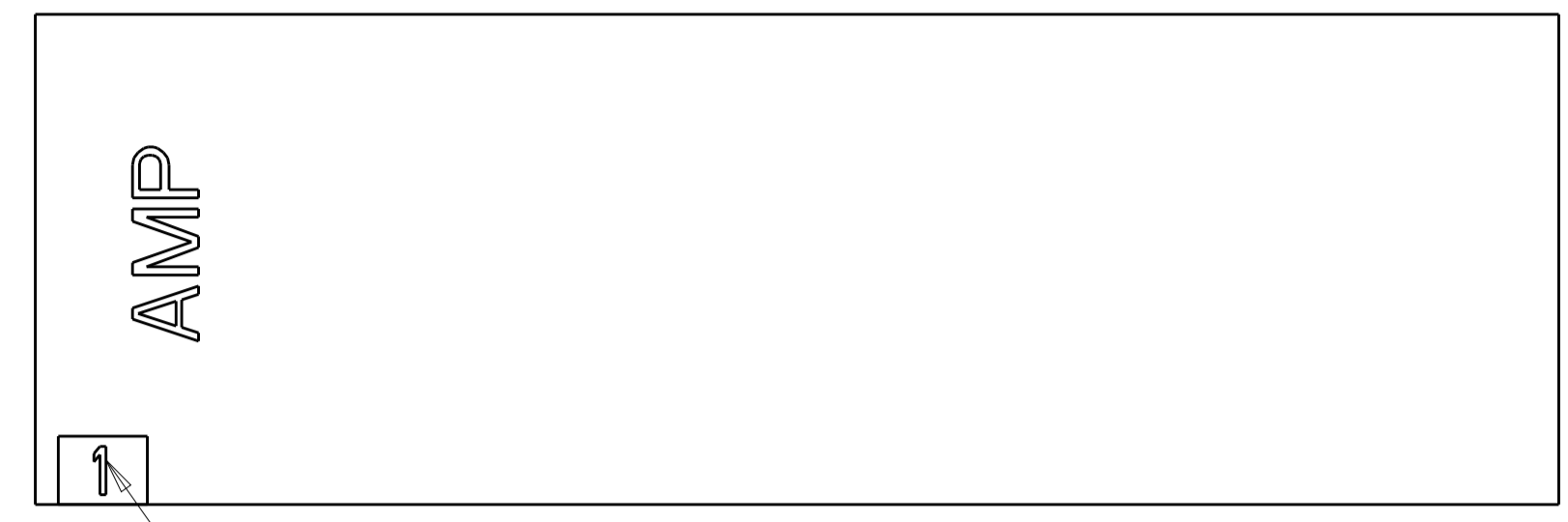

- UNIT ACCEPTS 1.14 [.045] SQUARE OR ROUND POST.
- UNIT ACCEPTS STANDARD SL-156 CONTACTS.
- UNIT ACCEPTS KEYING PLUG 640254-1 AND KEYING PIN 640255-1.
- △ CIRCUIT I.D. NUMBER(S) TO BE LOCATED SEQUENTIALLY AS SHOWN OR ONLY NO. 1 CIRCUIT PLACED ON LOCKING RAMP.
- DIMENSION IN BRACKETS ARE IN INCHES.
- ACCEPTS UP TO 2.79 [.110] INSULATION WIRE.
- △ THIS HOUSING CANNOT BE USED WITH SL-156 HOODED CONTACT PART NUMBERS 770476-X.
- △ CORING BETWEEN CIRCUITS ALLOWABLE WHERE SHOWN AS NEEDED TO PREVENT SINK MARKS. MIN WALL THICKNESS BETWEEN CIRCUIT AND CORING TO BE 0.64 [.025].

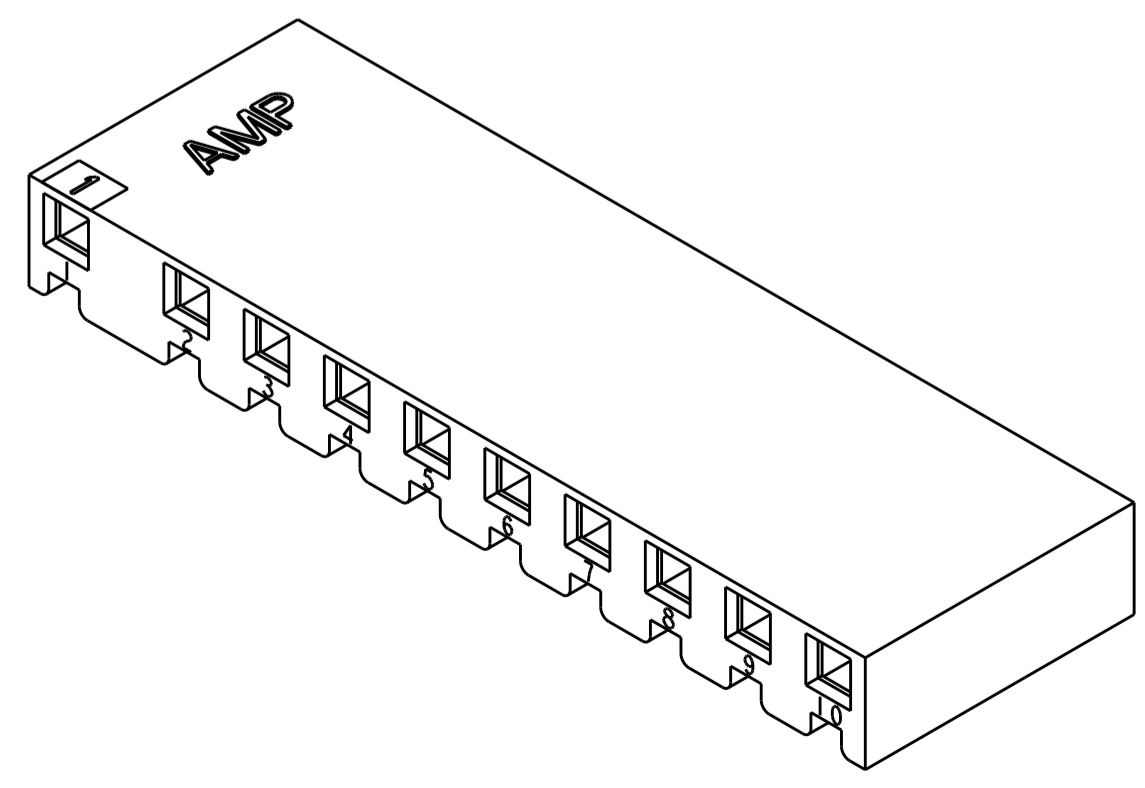
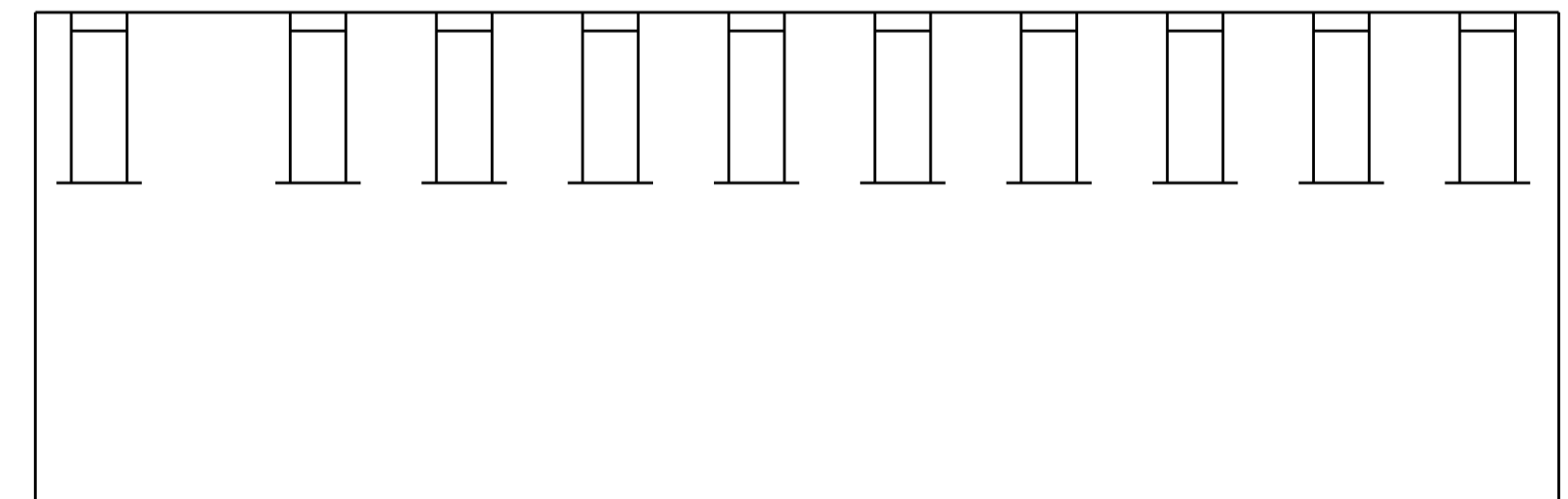
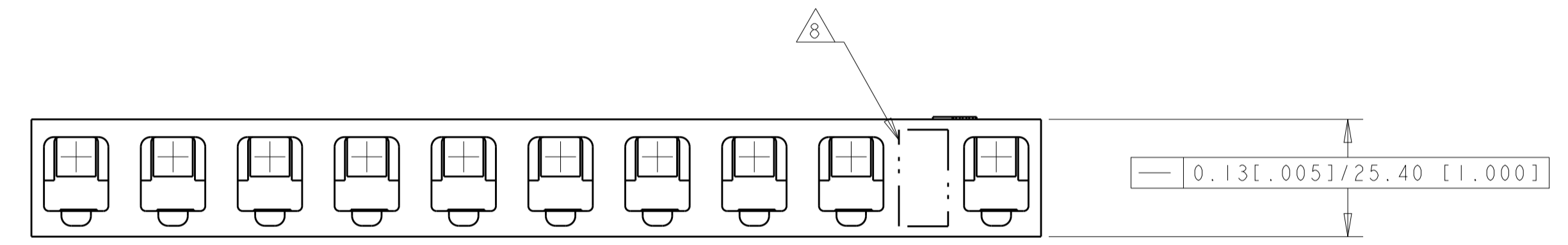
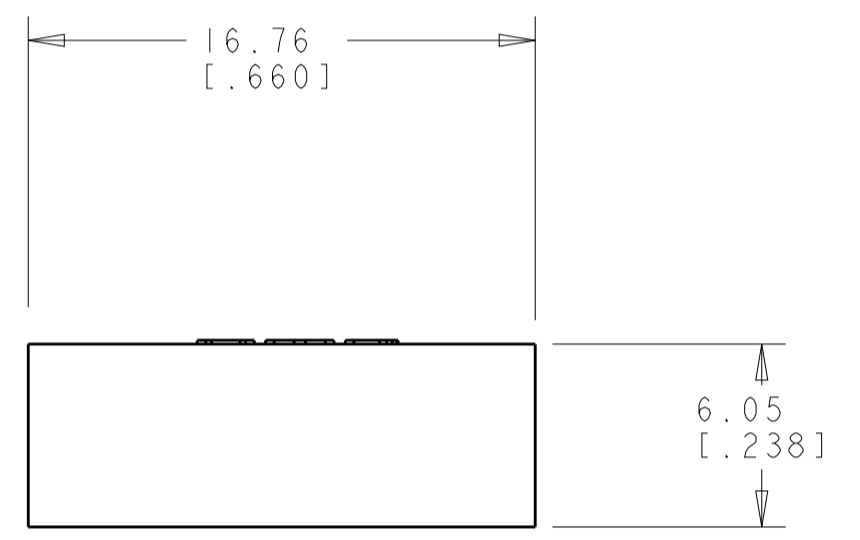
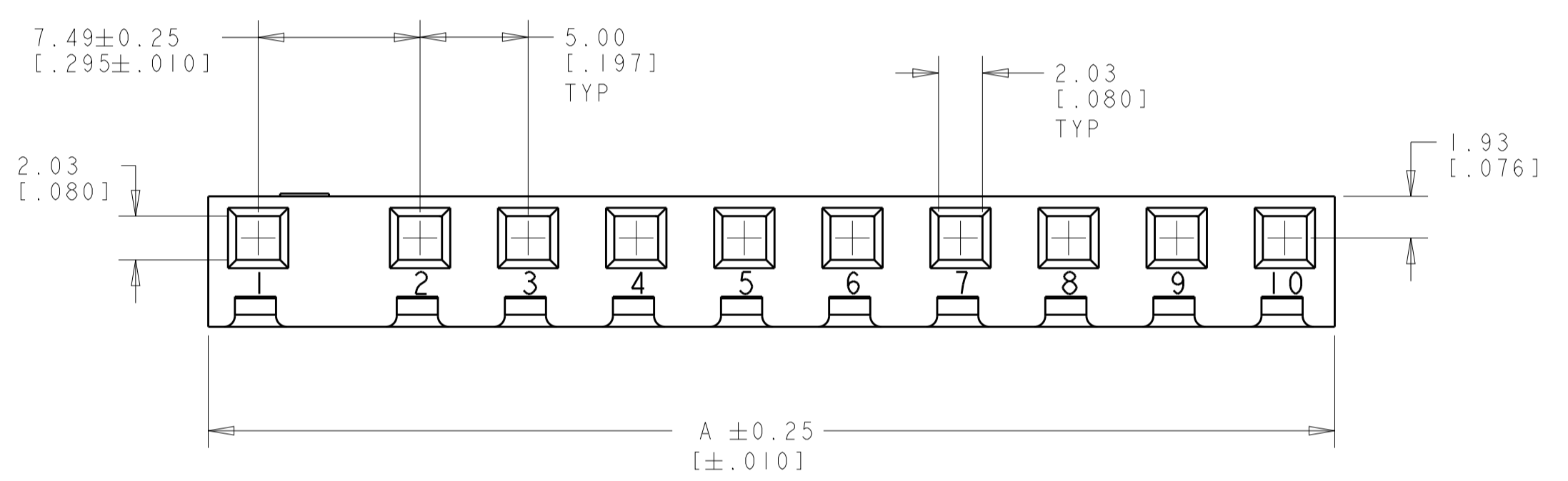

3-DIMENSIONAL MODEL
SCALE 3:1

1-1744074-0 SHOWN

PRELIMINARY - NOT FOR PRODUCTION	0.215	57.15 [2.250]	11	1-1744074-1
	0.196	52.15 [2.053]	10	1-1744074-0
	VOLUME (IN ³)	DIM A	NO OF POSN	PART NUMBER

THIS DRAWING IS A CONTROLLED DOCUMENT.		DWN	R. WHITAKER	14MAR2005	
DIMENSIONS: mm [INCHES]		CHK	J. ELLIS	14MAR2005	
TOLERANCES UNLESS OTHERWISE SPECIFIED:		APVD	J. ELLIS	14MAR2005	
0 PLC ± 1 PLC ± 2 PLC ±0.13 [.005] 3 PLC ± 4 PLC ±		NAME	HOUSING, WITH LOCKING RAMP, SL-156, FOR LARGE WIRE INSULATION, SPECIAL		
MATERIAL: NYLON, UL 94V-0 NATURAL FINISH: - ANGLES: 40°/30°		PRODUCT SPEC	-		RESTRICTED TO
		APPLICATION SPEC	-		SIZE
		WEIGHT	SEE TABLE		CAGE CODE
		CUSTOMER DRAWING	A100779		DRAWING NO
		SCALE	4:1		DRAWING NO
		SHEET	1 OF 1		REV
		REV	E		

X-ON Electronics

Largest Supplier of Electrical and Electronic Components

Click to view similar products for [Headers & Wire Housings](#) category:

Click to view products by [TE Connectivity](#) manufacturer:

Other Similar products are found below :

[892-18-020-10-001101](#) [58102-G61-06LF](#) [582553-1](#) [0009485154](#) [009176003701906](#) [0050291907](#) [LY20-4P-DT1-P1E-BR](#) [02.125.8002.8](#)
[609-3404](#) [61062-3](#) [61082-181009](#) [622-3653LF](#) [63453-116](#) [636-1030](#) [636-1427](#) [636-3427](#) [636-4007](#) [641938-9](#) [641991-4](#) [644827-2](#) [65817-010LF](#) [65817-015LF](#) [65863-015LF](#) [66207-023LF](#) [67095-007LF](#) [67601157](#) [68645-018](#) [68648-049](#) [70.362.1628.0](#) [70-4210](#) [70-4226B](#) [70-4853B](#) [707-5020](#) [707-5028](#) [71.350.2428.0](#) [71918-208LF](#) [71961-016LF](#) [733-134](#) [733-162](#) [754199-000](#) [760-3052](#) [787-8014-00](#) [79531-3000](#)
[FCN-360C032-B](#) [FCN-367T-T012/H](#) [FCN-723D010/2](#) [80.063.4001.1](#) [800-90-001-10-001000](#) [800-90-010-10-002000](#) [801-43-002-10-013000](#)