

REVISIONS					
P	LTR	DESCRIPTION	DATE	DWN	APVD
	L1	REVISED PER ECO-20-014158	07OCT20	RK	MZ

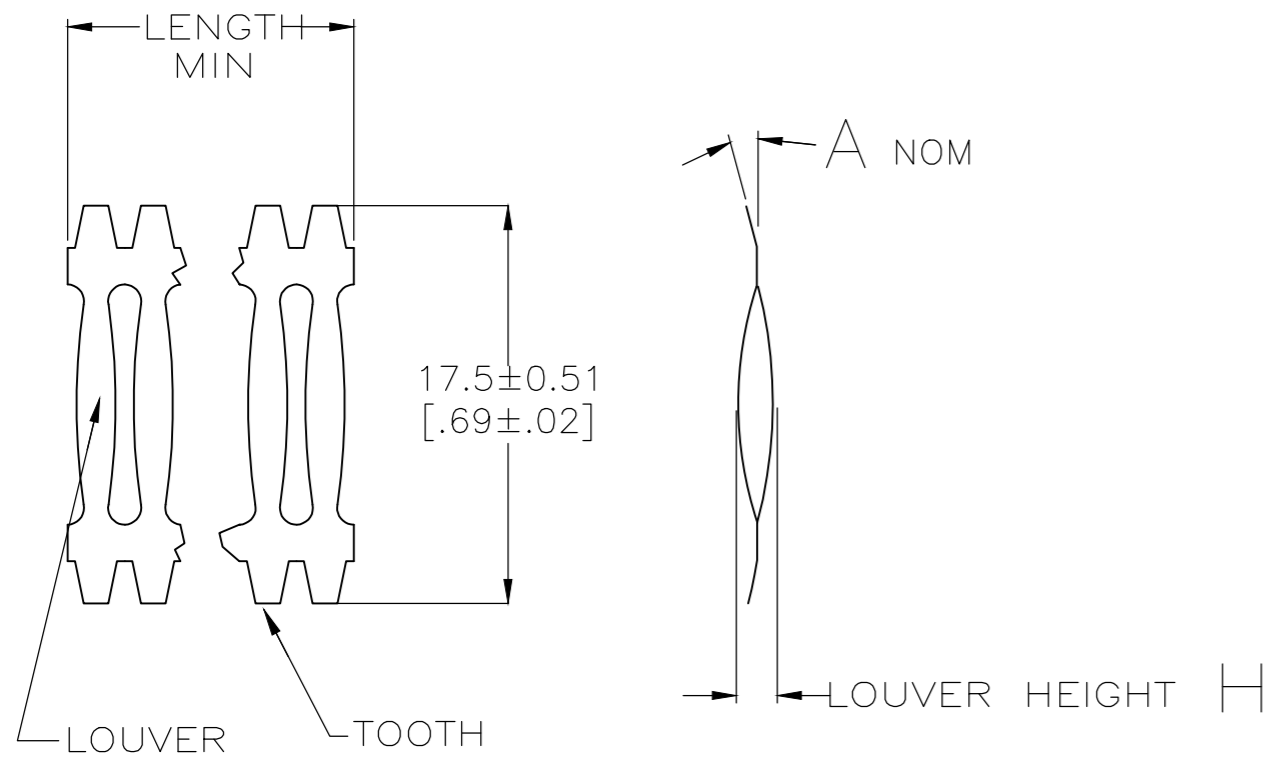

- 1 FINISH-SILVER PLATE 2.54µm[100µ"] THICK MIN
- 2 FINISH-SILVER PLATE 5.08µm[200µ"] THICK MIN
- 3 FINISH-NICKEL PLATE 2.54µm[100µ"] THICK MIN
- 4 FINISH-NICKEL PLATE 1.02µm[40µ"] THICK MIN
- 5 FINISH-GOLD PLATE .25µm[10µ"] THICK MIN
- 6 FINISH-GOLD PLATE 1.27µm[50µ"] THICK MIN
- 7 FINISH-TIN PLATE 7.62µm[300µ"] THICK MIN
- 8 LENGTH-23 LOUVERS (2.3 INCHES).
- 9
- 10
- 11 PLATING NOTES TO BE INTERPRETED AS FOLLOWS: 1-4 AS 1 OVER 4.
- 12 PRODUCT IS SOLD BY THE FOOT.
- 14 10 LOUVERS 25.4mm (1.0).
- 15 PRELIMINARY PART NUMBER.
- 16 P/N 3-192004-0 IS CUT TO A LENGTH OF 19.50 INCHES
- 17 6 LOUVERS 15.2mm(.60 IN)
- 18 OBSOLETE PARTS: OBSOLETE CIS STREAMLINING PER D.RENAUD/D.SINISI
- 19 3 LOUVERS 7.62±0.25[.300±.010] IN LENGTH. EDGES OF CONTACT WHERE STRIPS WERE CUT TO LENGTH WILL BE PLATED.

LOUVER HEIGHT H	LENGTH	MAT'L	PLATING (NOTE NO.)	TOOTH ANGLE A	MAT'L THK T	REF	PART NUMBER
OBSOLETE	1.19/1.34 [.047/.053]	SEE NOTE 19	BeCu	6-4	15°	0.15 [.006]	-- 3-192004-2
OBSOLETE	1.19/1.34 [.047/.053]	SEE NOTE 17	BeCu	2-4	15°	0.15 [.006]	-- 3-192004-1
OBSOLETE	1.19/1.34 [.047/.053]	SEE NOTE 16	BeCu	2-4	45°	0.15 [.006]	-- 3-192004-0
OBSOLETE	1.19/1.34 [.047/.053]	SEE NOTE 12	BeCu	7	15°	0.15 [.006]	-- 2-192004-9
OBSOLETE	1.19/1.34 [.047/.053]	SEE NOTE 14	BeCu	2-4	15°	0.15 [.006]	-- 2-192004-8
OBSOLETE	1.24/1.40 [.049/.055]	SEE NOTE 8	BeCu	2-4	15°	0.20 [.008]	-- 2-192004-7
OBSOLETE	1.24/1.40 [.049/.055]	SEE NOTE 12	BeCu	7	15°	0.20 [.008]	-- 2-192004-6
OBSOLETE	1.19/1.34 [.047/.053]	20.1m[792"]	BeCu	1-4	15°	0.10 [.004]	-- 2-192004-5
OBSOLETE	1.19/1.34 [.047/.053]	20.1m[792"]	BeCu	1-4	15°	0.15 [.006]	-- 2-192004-4
OBSOLETE	1.19/1.34 [.047/.053]	20.1m[792"]	BeCu	UNPL	15°	0.15 [.006]	-- 2-192004-3
OBSOLETE	--	--	--	--	--	--	-- 2-192004-2
OBSOLETE	--	--	--	--	--	--	-- 2-192004-1
OBSOLETE	1.19/1.34 [.047/.053]	20.1m[792"]	BeCu	UNPL	15°	0.10 [.004]	01323 2-192004-0
OBSOLETE	1.24/1.40 [.049/.055]	SEE NOTE 12	BeCu	2-4	15°	0.20 [.008]	01029 1-192004-9
OBSOLETE	1.24/1.40 [.049/.055]	SEE NOTE 12	BeCu	UNPL	15°	0.20 [.008]	01322 1-192004-8
OBSOLETE	1.14 [.045] MIN	SEE NOTE 12	CNCL	UNPL	45°	0.15 [.006]	01066 1-192004-7
OBSOLETE	1.19/1.34 [.047/.053]	SEE NOTE 12	BeCu	6-4	45°	0.15 [.006]	01023 1-192004-6
OBSOLETE	1.19/1.34 [.047/.053]	SEE NOTE 12	BeCu	5-4	45°	0.15 [.006]	01037 1-192004-5
OBSOLETE	1.19/1.34 [.047/.053]	SEE NOTE 12	BeCu	2-4	45°	0.15 [.006]	01013 1-192004-4
OBSOLETE	1.19/1.34 [.047/.053]	SEE NOTE 12	BeCu	UNPL	45°	0.15 [.006]	01011 1-192004-3
OBSOLETE	1.14 [.045] MIN	SEE NOTE 12	CNCL	UNPL	15°	0.15 [.006]	01022 1-192004-2
OBSOLETE	1.19/1.34 [.047/.053]	SEE NOTE 12	BeCu	6-4	15°	0.15 [.006]	01015 1-192004-1
OBSOLETE	1.19/1.34 [.047/.053]	SEE NOTE 12	BeCu	5-4	15°	0.15 [.006]	01036 1-192004-0
OBSOLETE	1.19/1.34 [.047/.053]	SEE NOTE 12	BeCu	3	15°	0.15 [.006]	01020 192004-9
OBSOLETE	1.19/1.34 [.047/.053]	SEE NOTE 12	BeCu	2-4	15°	0.15 [.006]	01005 192004-8
OBSOLETE	1.19/1.34 [.047/.053]	SEE NOTE 12	BeCu	UNPL	15°	0.15 [.006]	01003 192004-7
OBSOLETE	1.19/1.34 [.047/.053]	SEE NOTE 12	BeCu	2-4	45°	0.10 [.004]	01049 192004-6
OBSOLETE	1.19/1.34 [.047/.053]	SEE NOTE 12	BeCu	3	15°	0.10 [.004]	01058 192004-5
OBSOLETE	1.19/1.34 [.047/.053]	SEE NOTE 12	BeCu	2-4	15°	0.10 [.004]	01002 192004-4
OBSOLETE	1.19/1.34 [.047/.053]	SEE NOTE 12	BeCu	UNPL	15°	0.10 [.004]	01017 192004-3
OBSOLETE	1.09/1.24 [.043/.049]	SEE NOTE 12	BeCu	2-4	15°	0.08 [.003]	01001 192004-2
OBSOLETE	1.09/1.24 [.043/.049]	SEE NOTE 12	BeCu	UNPL	15°	0.08 [.003]	01021 192004-1

THIS DRAWING IS A CONTROLLED DOCUMENT.

DWN	08-12-91	RA JAYNE
CHK	08-12-91	RA JAYNE
APVD	-	-
PRODUCT SPEC	-	-
APPLICATION SPEC	-	-
WEIGHT	-	-
CUSTOMER DRAWING	SCALE NTS	SHEET 1 OF 1

TE Connectivity

CONTACT BAND, FEM STRIP

SIZE A2 CAGE CODE 00779 DRAWING NO C=192004 RESTRICTED TO -

REV L1

X-ON Electronics

Largest Supplier of Electrical and Electronic Components

Click to view similar products for [Heavy Duty Power Connectors](#) category:

Click to view products by [TE Connectivity](#) manufacturer:

Other Similar products are found below :

[647757-1](#) [6643411-1](#) [6646058-2](#) [6646137-1](#) [6646138-1](#) [6646479-1](#) [6646608-1](#) [6646786-1](#) [6646940-1](#) [6651091-1](#) [6651525-1](#) [6651529-1](#)
[6651788-1](#) [696475-1](#) [702-32-01109](#) [703-25-02205](#) [73000005059](#) [73000005642](#) [73080255059](#) [73080965046](#) [765-15-0080A](#) [765-16-0080B](#)
[765-18-0080D](#) [829992-1](#) [902-77-02113](#) [PS00/A0620/6300](#) [PS25/A0420/63](#) [129-1J](#) [1409400](#) [AN0024023](#) [E6374G1](#) [e6389g2](#) [157-43GW8](#)
[MS3117-14AC](#) [1643543-1](#) [1650540-1](#) [1651811-2](#) [1766260-1](#) [1766282-1](#) [1766966-1](#) [1791340000](#) [NLDFT-3-BL-L-S120-M40A](#) [NLDFT-N-](#)
[W-L-C240-M40B](#) [NLS-2-R-C240-M40B](#) [NLS-N-W-C240-M40B](#) [NPS-3-BL-T6](#) [1986615-1](#) [2-1589900-8](#) [2199314-1](#) [KA8102](#)