

THIS DRAWING IS UNPUBLISHED.

RELEASED FOR PUBLICATION

© COPYRIGHT 20

ALL RIGHTS RESERVED.

LOC	DIST
-	00

REVISIONS

P	LTR	DESCRIPTION	DATE	DWN	APVD
E		PER ECR-12-003178	04JUN12	AZ	AC
F		REVISED PER ECR-13-019886	24DEC2013	FL	FY
-	-	-	-	-	-
-	-	-	-	-	-

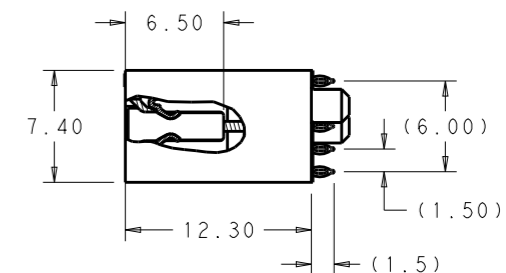
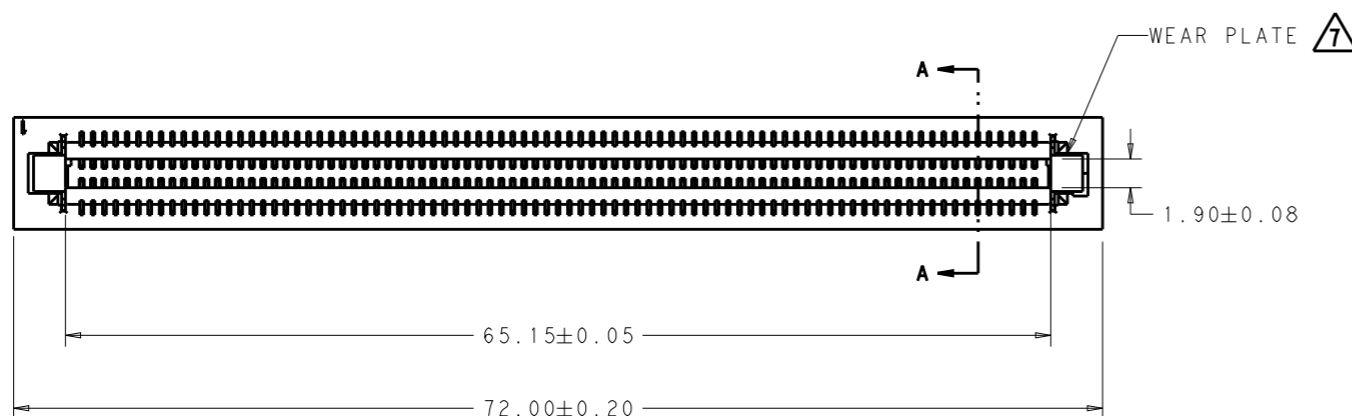

SECTION A-A

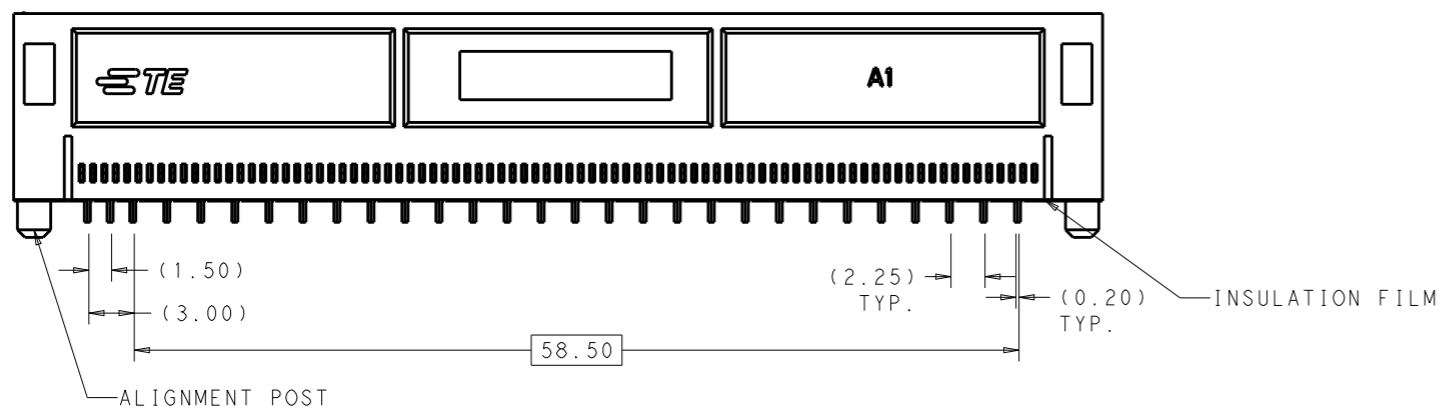

YES	1-1932632-2
NO	1-1932632-1
INSULATION FILM	PART NUMBER

THIS DRAWING IS A CONTROLLED DOCUMENT.

DIMENSIONS:
mm

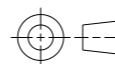

TOLERANCES UNLESS OTHERWISE SPECIFIED:

- 0 PLC ±-
- 1 PLC ±0.5
- 2 PLC ±0.25
- 3 PLC ±-
- 4 PLC ±-
- ANGLES ±3°

MATERIAL



FINISH



DWN JEFF GONG 26-Oct-10

CHK ALEX SHOAT 27-Oct-10

APVD MANQIAN WANG 27-Oct-10

PRODUCT SPEC 108-60091

APPLICATION SPEC 114-

WEIGHT -

CUSTOMER DRAWING



TE Connectivity

NAME CARD EDGE CONNECTOR, VERTICAL ENHANCED MICRO TCA

SIZE	CAGE CODE	DRAWING NO	RESTRICTED TO
------	-----------	------------	---------------

A300779	C=1932632		
---------	-----------	--	--

SCALE	SHEET	OF	REV
N/A	1	2	F

THIS DRAWING IS UNPUBLISHED. RELEASED FOR PUBLICATION
 © COPYRIGHT 20 ALL RIGHTS RESERVED.

LOC	DIST	REVISIONS			
P	LTR	DESCRIPTION	DATE	DWN	APVD
-	00	SEE SHEET 1	-	-	-

- NOTES, UNLESS OTHERWISE SPECIFIED:
- ⚠ MATERIAL:
HOUSING- LCP, UL94-0 RATED, BLACK.
CONTACTS- PHOSPHOR BRONZE
WEAR PLATE- STAINLESS STEEL
 - ⚠ RECOMMENDED PCB HOLE DIMENSIONS;
DRILLED HOLE: 0.64±0.02mm.
FINISHED HOLE: 0.55mm REF
Cu THICKNESS: 25-50um WITH EITHER PLATING THICKNESS
 - 1). HASL Sn Pb: 4-10um.
 - 2). IMMERSION Sn: MIN 0.5um
 - 3). OSP: 0.2~0.5um
 - 4). IMMERSION Au/Ni: 0.5~1.2um Au OVER 3.0~7.0um Ni
 - 5). IMMERSION Ag: 0.1um MIN
 - ⚠ FINISH:
 - 1). MATING AREA: 0.76um MIN GOLD OR 0.64um MIN PALLADIUM-NICKEL OVER 1.27um NICKEL
 - 2). COMPLIANT PIN AREA: 0.5um MATTE TIN OVER 1.27um NICKEL.
 - 4. CONNECTOR MARKED WITH PART NUMBER AND DATE CODE.
 - 5. CONTACT AREA LUBRICATED WITH BELLCORE APPROVED LUBRICANT. TECHNICAL REFERENCE GR1217-CORE ISSUE I, NOVEMBER 1995.
 - 6. REFER TO TYCO ELECTRONICS APPLICATION SPECIFICATION 114-13180 FOR SPECIFIC APPLICATION RELATED INFORMATION
 - ⚠ WEAR PLATE EXTENDE FROM TOP OF CONNECTOR TO BOTTOM OF SLOT AND IS USED TO ELIMINATE WEAR OF THE HOUSING CAUSED BY THE EDGE OF THE PCB CARD.
 - 8. INSULATION FILM USED WHEN ADDITIONAL INSULATION SPACING IS NEEDED BETWEEN PCB TRACES AND CONTACTS.

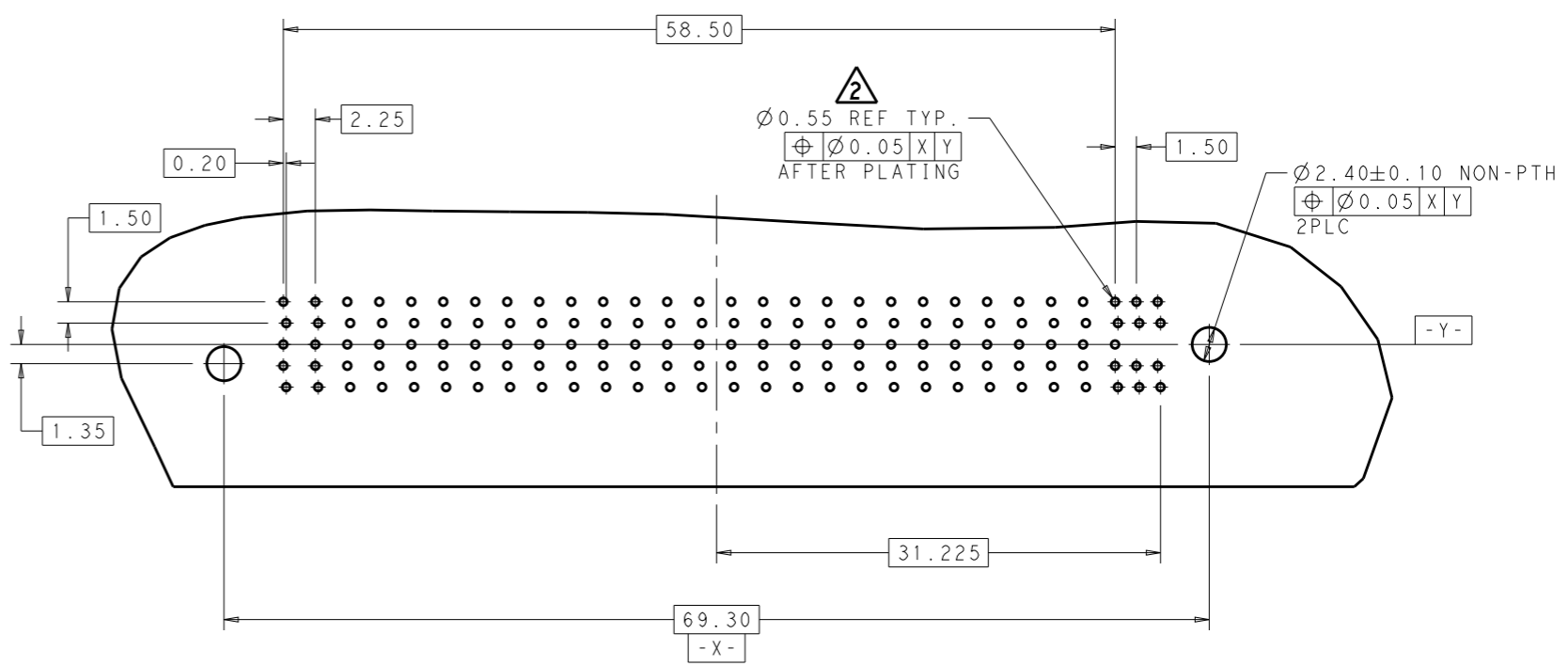

THIS DRAWING IS A CONTROLLED DOCUMENT.		DWN JEFF GONG 26-Oct-10	TE Connectivity	
DIMENSIONS: mm		CHK ALEX SHOAT 27-Oct-10		
TOLERANCES UNLESS OTHERWISE SPECIFIED:		APVD MANQIAN WANG 27-Oct-10	NAME CARD EDGE CONNECTOR, VERTICAL ENHANCED MICRO TCA	
0 PLC ±- 1 PLC ±0.5 2 PLC ±0.25 3 PLC ±- 4 PLC ±- ANGLES ±3°		PRODUCT SPEC 108-	RESTRICTED TO	
MATERIAL		APPLICATION SPEC 114-	SIZE A300779	CAGE CODE C=1932632
FINISH		WEIGHT	DRAWING NO	
⚠		CUSTOMER DRAWING		SCALE N/A
		SHEET 2 OF 2		REV F

X-ON Electronics

Largest Supplier of Electrical and Electronic Components

Click to view similar products for [Standard Card Edge Connectors](#) category:

Click to view products by [TE Connectivity](#) manufacturer:

Other Similar products are found below :

[CR7E-30DB-3.96E\(72\)](#) [6364499-1](#) [6565204-6](#) [PKC-156](#) [1437274-4](#) [147889-1](#) [1489165-4](#) [EBT15622B2X](#) [1-582587-1](#) [284-0102-12100](#)
[286-0052-12101A](#) [306022901000000](#) [307-012-502-202](#) [307-056-520-300](#) [2129318-1](#) [245-062-520-350](#) [287-0032-12101](#) [306-028-525-102](#)
[307-072-526-202](#) [345-060-559-303](#) [392-008-559-201](#) [534671-1](#) [341-240-317](#) [345-044-500-300](#) [346-240-318](#) [395-100-524-300](#) [09-07-2032](#)
[10035388-802LF](#) [10115859-011LF](#) [10122859-009LF](#) [10127905-B04B24BLF](#) [530555-1](#) [5-678046-1](#) [73726-0005](#) [66308-1](#) [1-1437275-6](#)
[PEC-07-02-T-S-A](#) [346-014-520-801](#) [307-048-502-202](#) [CE100F22-9-C](#) [CE100F26-7-C](#) [CE100F28-3-D](#) [CE156F18-9-C](#) [CE156F22-5-D](#)
[CE156F22-9-C](#) [CT100F22-2-D](#) [CT100F22-3-D](#) [CT100F24-2-D](#) [CT100F24-3-D](#) [CT100F24-6-C](#)