

THIS DRAWING IS UNPUBLISHED. RELEASED FOR PUBLICATION 20
 © COPYRIGHT 20 BY - ALL RIGHTS RESERVED.

| LOC | | DIST | | REVISIONS | | | |
|-----|-----|---------------------------|---------|-----------|------|--|--|
| P | LTR | DESCRIPTION | DATE | DWN | APVD | | |
| | A1 | REVISED PER ECR-15-006926 | 05MAY15 | JR | KR | | |
| | | | | | | | |
| | | | | | | | |

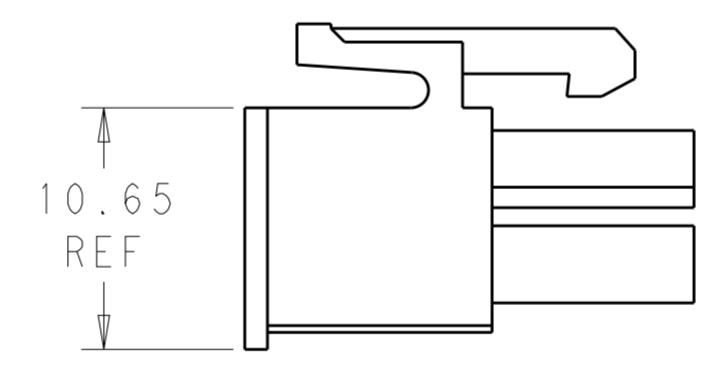

SCALE 3:1
FOR -2 PART ONLY

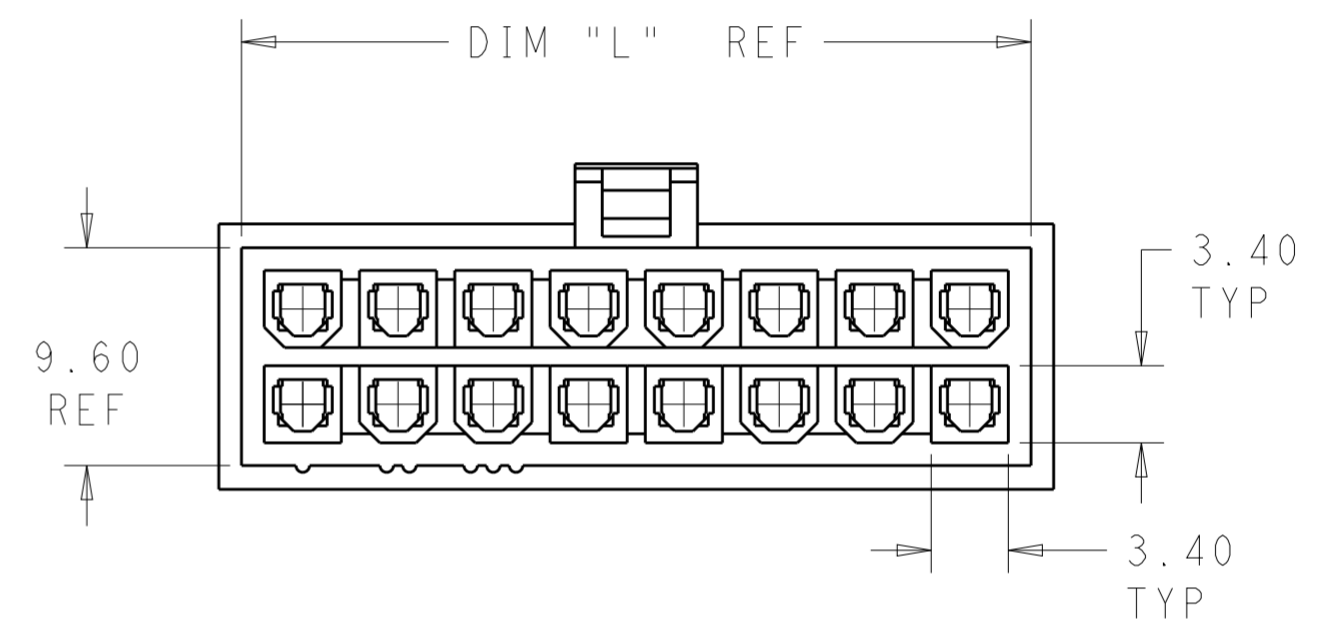
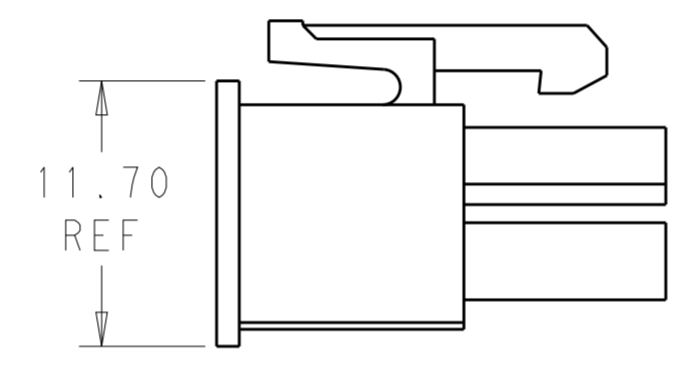
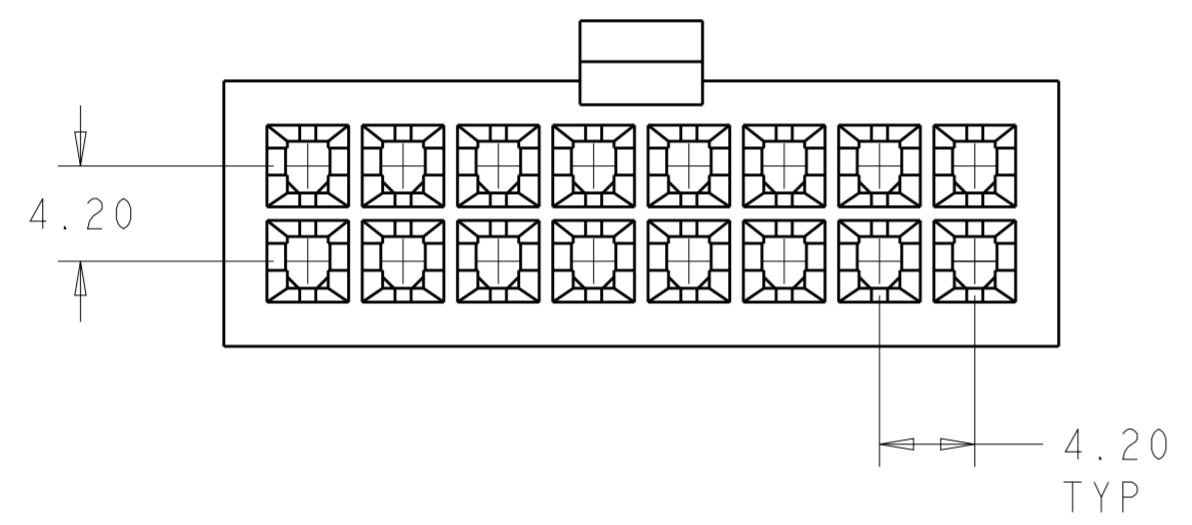
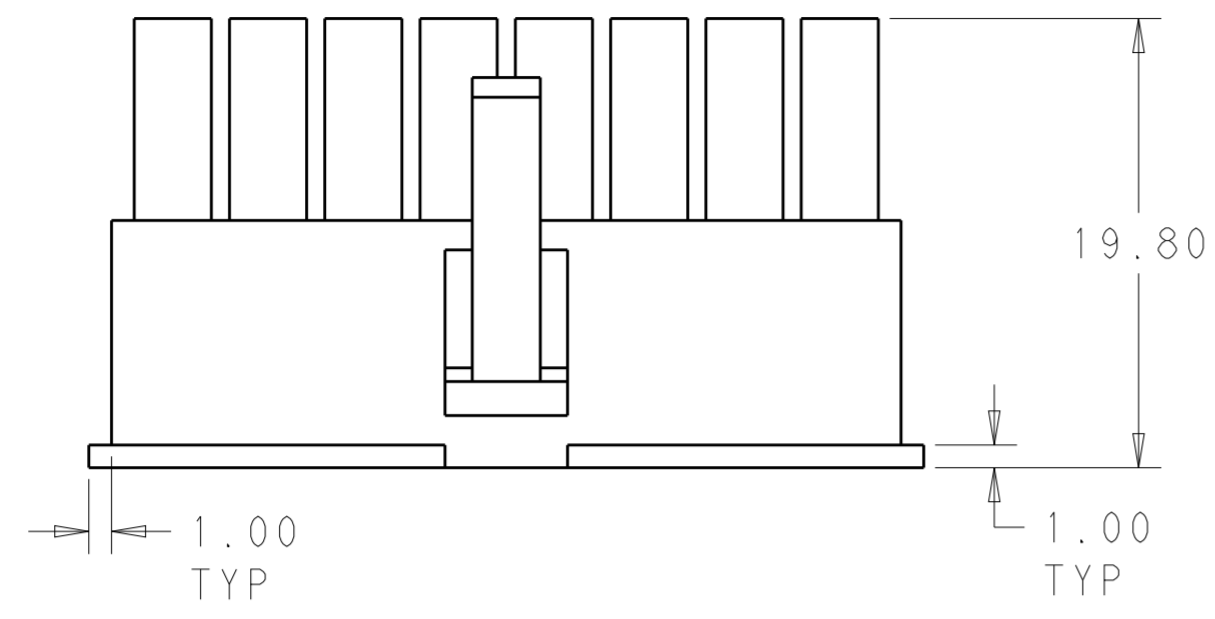
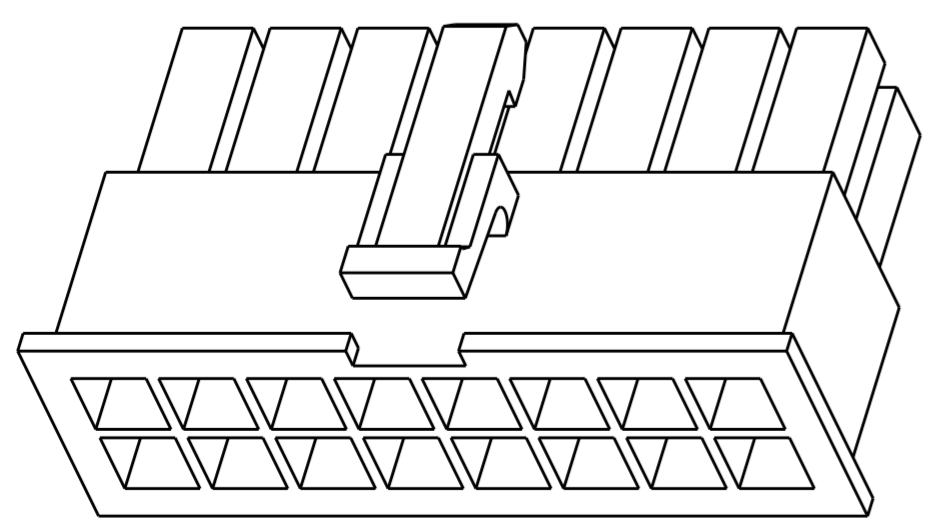

| | | |
|-------|------------|-------------|
| 51.60 | 24 | 2-1969597-4 |
| 47.40 | 22 | 2-1969597-2 |
| 43.20 | 20 | 2-1969597-0 |
| 39.00 | 18 | 1-1969597-8 |
| 34.80 | 16 | 1-1969597-6 |
| 30.60 | 14 | 1-1969597-4 |
| 26.40 | 12 | 1-1969597-2 |
| 22.20 | 10 | 1-1969597-0 |
| 18.00 | 8 | 1969597-8 |
| 13.80 | 6 | 1969597-6 |
| 9.60 | 4 | 1969597-4 |
| 5.40 | 2 | 1969597-2 |
| DIM L | NO. OF POS | PART NO. |

| | | | | | | | | | | | | | | | | | | |
|---|-------|------------------------------------|--|---------------------|---|-------|-------|-------|---|-------|---|--------|---|--------|---|-------------------|-----------------|--|
| THIS DRAWING IS A CONTROLLED DOCUMENT. | | DWN JR RUTH 12DEC2012 | TE Connectivity | | | | | | | | | | | | | | | |
| DIMENSIONS: mm | | CHK KURT RANDOLPH 12DEC2012 | | | | | | | | | | | | | | | | |
| TOLERANCES UNLESS OTHERWISE SPECIFIED: | | APVD KURT RANDOLPH 12DEC2012 | NAME RECEPTACLE HOUSING, VAL-U-LOK | | | | | | | | | | | | | | | |
| <table border="0"> <tr><td>0 PLC</td><td>±</td></tr> <tr><td>1 PLC</td><td>±</td></tr> <tr><td>2 PLC</td><td>±0.25</td></tr> <tr><td>3 PLC</td><td>±</td></tr> <tr><td>4 PLC</td><td>±</td></tr> <tr><td>ANGLES</td><td>±</td></tr> <tr><td>FINISH</td><td>±</td></tr> </table> | | 0 PLC | ± | 1 PLC | ± | 2 PLC | ±0.25 | 3 PLC | ± | 4 PLC | ± | ANGLES | ± | FINISH | ± | PRODUCT SPEC - | SIZE A200779 | |
| 0 PLC | ± | | | | | | | | | | | | | | | | | |
| 1 PLC | ± | | | | | | | | | | | | | | | | | |
| 2 PLC | ±0.25 | | | | | | | | | | | | | | | | | |
| 3 PLC | ± | | | | | | | | | | | | | | | | | |
| 4 PLC | ± | | | | | | | | | | | | | | | | | |
| ANGLES | ± | | | | | | | | | | | | | | | | | |
| FINISH | ± | | | | | | | | | | | | | | | | | |
| MATERIAL NYLON 6/6, V2 | | APPLICATION SPEC - | DRAWING NO C-1969597 | | | | | | | | | | | | | | | |
| COLOR-NATURAL | | WEIGHT - | RESTRICTED TO - | | | | | | | | | | | | | | | |
| Customer Drawing | | SCALE 3:1 | | SHEET 1 OF 1 REV A1 | | | | | | | | | | | | | | |

X-ON Electronics

Largest Supplier of Electrical and Electronic Components

Click to view similar products for [Headers & Wire Housings](#) category:

Click to view products by [TE Connectivity](#) manufacturer:

Other Similar products are found below :

[892-18-020-10-001101](#) [58102-G61-06LF](#) [582553-1](#) [0009485154](#) [009176003701906](#) [0050291907](#) [LY20-4P-DT1-P1E-BR](#) [02.125.8002.8](#)
[609-3404](#) [61062-3](#) [61082-181009](#) [622-3653LF](#) [63453-116](#) [636-1030](#) [636-1427](#) [636-3427](#) [636-4007](#) [641938-9](#) [641991-4](#) [644827-2](#) [65817-](#)
[010LF](#) [65817-015LF](#) [65863-015LF](#) [66207-023LF](#) [67095-007LF](#) [67601157](#) [68645-018](#) [68648-049](#) [70.362.1628.0](#) [70-4210](#) [70-4226B](#) [70-](#)
[4853B](#) [707-5020](#) [707-5028](#) [71.350.2428.0](#) [71918-208LF](#) [71961-016LF](#) [733-134](#) [733-162](#) [754199-000](#) [760-3052](#) [787-8014-00](#) [79531-3000](#)
[FCN-360C032-B](#) [FCN-367T-T012/H](#) [FCN-723D010/2](#) [80.063.4001.1](#) [800-90-001-10-001000](#) [800-90-010-10-002000](#) [801-43-002-10-013000](#)