

THIS DRAWING IS UNPUBLISHED. RELEASED FOR PUBLICATION 20
 © COPYRIGHT 20 BY - ALL RIGHTS RESERVED.

| LOC | DIST | REVISIONS | | | |
|-----|------|-------------|---------------|-----------|-------|
| P | LTR | DESCRIPTION | DATE | DWN | APVD |
| - | - | A8 | ECR-18-004630 | 29MAR2018 | SC BH |

TABLE 1

| NO. | NAME | MATERIAL |
|-----|--------------|----------------------------|
| 1 | POST CONTACT | BRASS, FINISH; TIN PLATING |
| 2 | HDR HOUSING | PA 66 GF UL94 V-0 |

KINK POSITION TABLE 2

| POSITION | KINK A | KINK B |
|----------|--------|--------|
| 4 | 1,2 | 3,4 |
| 6 | 1,3 | 4,6 |
| 8 | 1,4 | 5,8 |
| 10 | 1,5 | 6,10 |
| 12 | 1,6 | 7,12 |
| 14 | 1,7 | 8,14 |

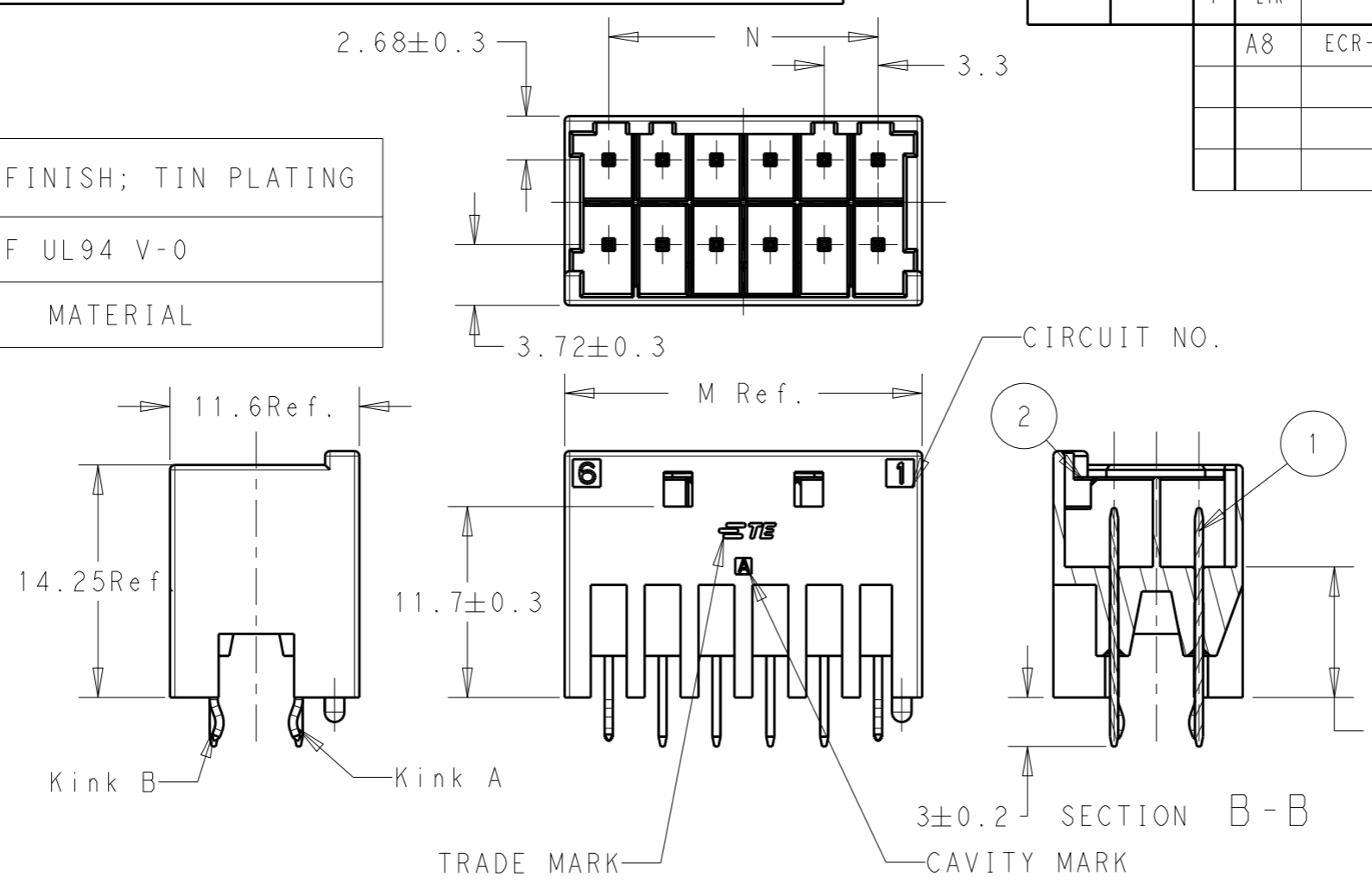

- NOTES:
- 1. RECOMMENDED PCB LAYOUT
 - 2. APPLICABLE PCB THICKNESS 1.6MM
 - 3. MATERIAL SEE TABLE 1
 - 4. KINK FORM SEE TABLE 2
 - 5. MATING PLUG HOUSING SEE TABLE 3
 - 6. PIN DIMENSION
 - 7. ADDITIONAL REQUESTS FOR P/N: 5-1971906-7, 6-1971906-7, 5-1971906-6
 - 8. ADDITIONAL REQUESTS FOR P/N: 5-1971906-3, 5-1971906-5, 6-1971906-5:
 - 9. PRELIMINARY-NOT FOR PRODUCTION

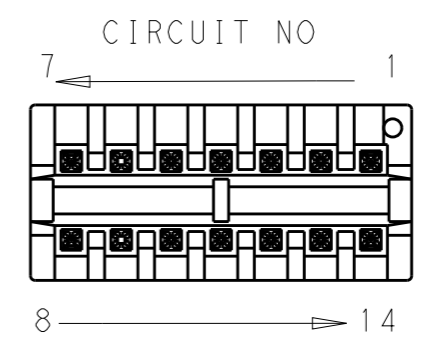
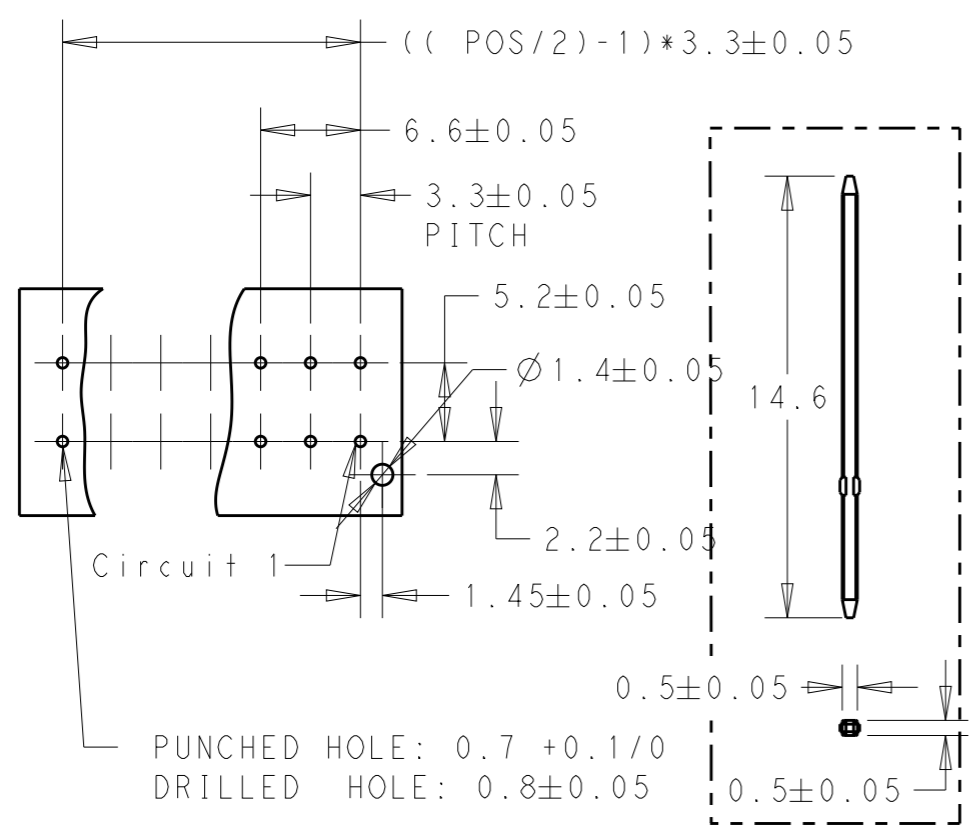

PUNCHED HOLE: 0.7 +0.1/0
 DRILLED HOLE: 0.8±0.05

1 RECOMMENDED PCB LAYOUT

6 Pin

| | | | | | | | | | | | | |
|---|--|--------------|------------|-----------|----------------------------|---|-----------|-------|------------|---------|---------------|---|
| THIS DRAWING IS A CONTROLLED DOCUMENT. | | DWN | LZH | 08JAN2013 | STE TE Connectivity | | | | | | | |
| DIMENSIONS: mm | | CHK | HAPYE.WU | 08JAN2013 | | | | | | | | |
| TOLERANCES UNLESS OTHERWISE SPECIFIED: | | APVD | YH.MAO | 08JAN2013 | | | | | | | | |
| 0 PLC ±- 1 PLC ±0.5 2 PLC ±0.13 3 PLC ±0.013 4 PLC ±0.0001 ANGLES ±- | | PRODUCT SPEC | 108-106094 | | | | | | | | | |
| MATERIAL | | FINISH | | - | NAME | NEXT GENERATION G13.3 HEADER ASSEMBLY 2 ROW | | | | | | |
| | | WEIGHT | | - | SIZE | A3 | CAGE CODE | 00779 | DRAWING NO | 1971906 | RESTRICTED TO | - |
| Customer Drawing | | SCALE | | 5:2 | SHEET | | 1 | OF | 3 | REV | A8 | |

| P | LTR | DESCRIPTION | DATE | DWN | APVD |
|---|-----|-------------|------|-----|------|
| | | SEE SHEET 1 | | | |

5-1971906-7:
KEY A, NATURAL

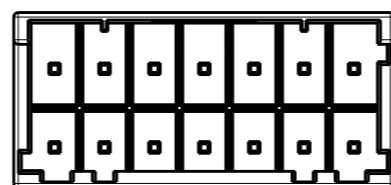
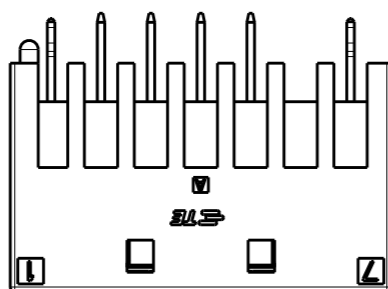

KEYING A

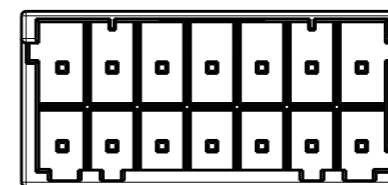

KEYING B

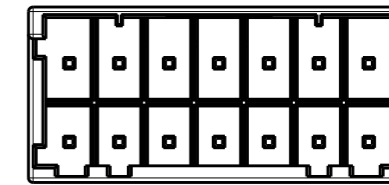

KEYING C

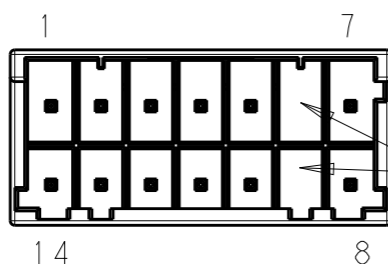

KEYING D

NO PIN
7

6-1971906-7:
KEY B, BLUE

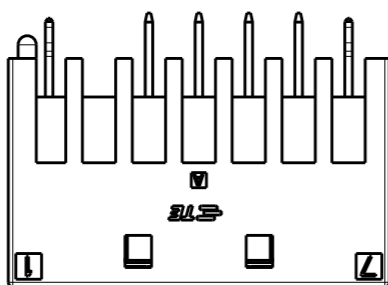

5-1971906-6:
KEY A, NATURAL

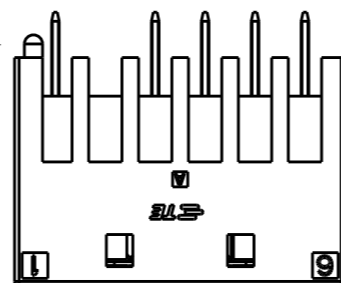

NO PIN
7

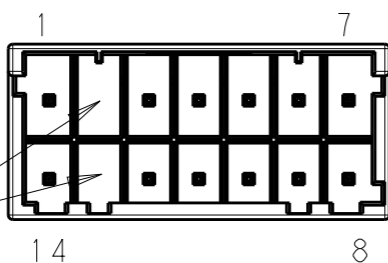

NO PIN
7

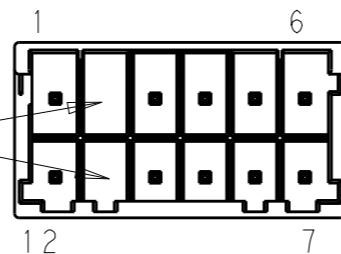
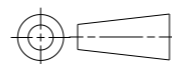

TABLE 3 5

| MATING PLUG P/N | COLOR | KEYING | N | M | POS | PART NO. |
|-----------------|---------|--------|------|------|-----|-------------|
| 2-1971905-7 | BLUE | B | 19.8 | 25.2 | 14 | 6-1971906-7 |
| 1-1971905-7 | NATURAL | A | | | 14 | 5-1971906-7 |
| 4-1971905-7 | YELLOW | D | | | 14 | 4-1971906-7 |
| 3-1971905-7 | RED | C | | | 14 | 3-1971906-7 |
| 2-1971905-7 | BLUE | B | 16.5 | 21.9 | 14 | 2-1971906-7 |
| 1-1971905-7 | NATURAL | A | | | 14 | 1-1971906-7 |
| 1-1971905-6 | NATURAL | A | | | 12 | 5-1971906-6 |
| 4-1971905-6 | YELLOW | D | | | 12 | 4-1971906-6 |
| 3-1971905-6 | RED | C | 16.5 | 21.9 | 12 | 3-1971906-6 |
| 2-1971905-6 | BLUE | B | | | 12 | 2-1971906-6 |
| 1-1971905-6 | NATURAL | A | | | 12 | 1-1971906-6 |
| 4-1971905-5 | YELLOW | D | | | 10 | 4-1971906-5 |
| 3-1971905-5 | RED | C | 13.2 | 18.6 | 10 | 3-1971906-5 |
| 1-1971905-5 | BLUE | B | | | 10 | 2-1971906-5 |
| 1-1971905-5 | NATURAL | A | | | 10 | 1-1971906-5 |
| 4-1971905-4 | YELLOW | D | | | 8 | 4-1971906-4 |
| 3-1971905-4 | RED | C | 9.9 | 15.3 | 8 | 3-1971906-4 |
| 2-1971905-4 | BLUE | B | | | 8 | 2-1971906-4 |
| 1-1971905-4 | NATURAL | A | | | 8 | 1-1971906-4 |
| 4-1971905-3 | YELLOW | D | | | 6 | 4-1971906-3 |
| 3-1971905-3 | RED | C | 6.6 | 12 | 6 | 3-1971906-3 |
| 2-1971905-3 | BLUE | B | | | 6 | 2-1971906-3 |
| 1-1971905-3 | NATURAL | A | | | 6 | 1-1971906-3 |
| 4-1971905-2 | YELLOW | D | | | 4 | 4-1971906-2 |
| 3-1971905-2 | RED | C | 3.3 | 8.7 | 4 | 3-1971906-2 |
| 2-1971905-2 | BLUE | B | | | 4 | 2-1971906-2 |
| 1-1971905-2 | NATURAL | A | | | 4 | 1-1971906-2 |

THIS DRAWING IS A CONTROLLED DOCUMENT.

DIMENSIONS:
mm



TOLERANCES UNLESS OTHERWISE SPECIFIED:

- 0 PLC ±-
- 1 PLC ±0.5
- 2 PLC ±0.13
- 3 PLC ±0.013
- 4 PLC ±0.0001
- ANGLES ±-

MATERIAL -

FINISH -

DWN 08JAN2013

LZH

CHK 08JAN2013

HAPYE.WU

APVD 08JAN2013

YH.MAO

PRODUCT SPEC

108-106094

APPLICATION SPEC

114-106094

WEIGHT -

Customer Drawing



TE Connectivity

NAME
NEXT GENERATION G13.3
HEADER ASSEMBLY 2 ROW

SIZE CAGE CODE DRAWING NO RESTRICTED TO

A3 00779 C-1971906

SCALE - SHEET 2 OF 3 REV A8

THIS DRAWING IS UNPUBLISHED. RELEASED FOR PUBLICATION 20
 © COPYRIGHT 20 BY - ALL RIGHTS RESERVED.

| LOC | DIST | REVISIONS | | | |
|-----|------|-------------|------|-----|------|
| P | LTR | DESCRIPTION | DATE | DWN | APVD |
| - | - | SEE SHEET 1 | | | |

5-1971906-3:
KEY A, NATURAL

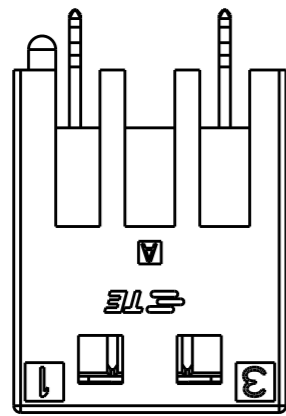

1 3

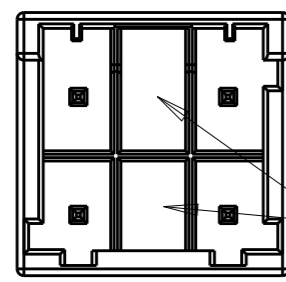

6 4

NO PIN
8

5-1971906-5:
KEY A, NATURAL

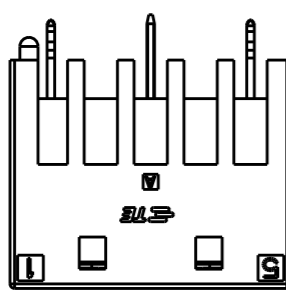

1 5

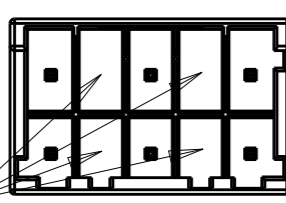

10 6

NO PIN
8

6-1971906-5:
KEY B, BLUE

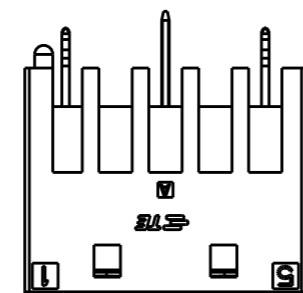

1 5

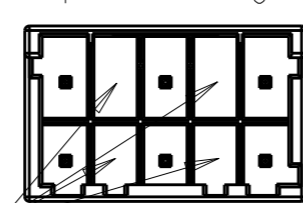

NO PIN
8

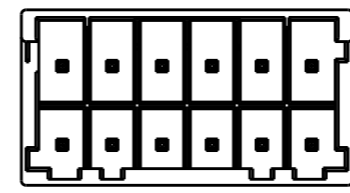

KEYING A

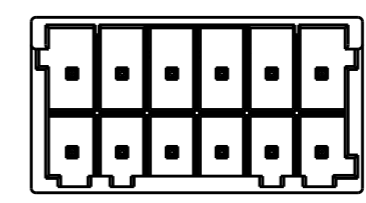

KEYING B

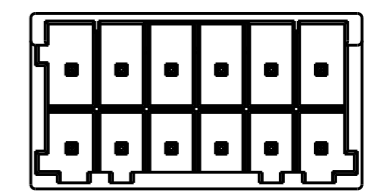

KEYING C

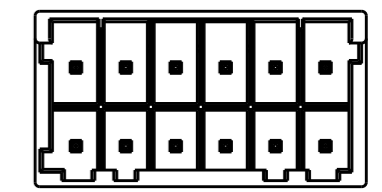

KEYING D

TABLE 3 5

| | | | | | | | | |
|--------------------|-----------------|---------|--------|------|------|-----|-------------|-----|
| 2, 4, 7, 9 | 2-1971905-5 | BLUE | B | 13.2 | 18.6 | 10 | 6-1971906-5 | 8 9 |
| 2, 4, 7, 9 | 1-1971905-5 | NATURAL | A | 13.2 | 18.6 | 10 | 5-1971906-5 | 8 9 |
| 2, 5 | 1-1971905-3 | NATURAL | A | 6.6 | 12 | 6 | 5-1971906-3 | 8 |
| POS NUMBER REMOVED | MATING PLUG P/N | COLOR | KEYING | N | M | POS | PART NO. | |

THIS DRAWING IS A CONTROLLED DOCUMENT.

| DIMENSIONS: | TOLERANCES UNLESS OTHERWISE SPECIFIED: |
|-------------|--|
| mm | |
| | 0 PLC ±- |
| | 1 PLC ±0.5 |
| | 2 PLC ±0.13 |
| | 3 PLC ±0.013 |
| | 4 PLC ±0.0001 |
| | ANGLES ±- |

| MATERIAL | FINISH |
|----------|--------|
| - | - |

| | | |
|------|----------|-----------|
| DWN | LZH | 08JAN2013 |
| CHK | HAPYE.WU | 08JAN2013 |
| APVD | YH.MAO | 08JAN2013 |



| NAME | | | |
|--|-----------|------------|---------------------|
| NEXT GENERATION G13.3 HEADER ASSEMBLY 2 ROW | | | |
| SIZE | CAGE CODE | DRAWING NO | RESTRICTED TO |
| A3 | 00779 | C-1971906 | - |
| Customer Drawing | | SCALE 5:2 | SHEET 3 OF 3 REV A8 |

X-ON Electronics

Largest Supplier of Electrical and Electronic Components

Click to view similar products for [Headers & Wire Housings](#) category:

Click to view products by [TE Connectivity](#) manufacturer:

Other Similar products are found below :

[892-18-020-10-001101](#) [58102-G61-06LF](#) [582553-1](#) [0009485154](#) [009176003701906](#) [0050291907](#) [LY20-4P-DT1-P1E-BR](#) [02.125.8002.8](#)
[609-3404](#) [61062-3](#) [61082-181009](#) [622-3653LF](#) [63453-116](#) [636-1030](#) [636-1427](#) [636-3427](#) [636-4007](#) [641938-9](#) [641991-4](#) [644827-2](#) [65817-](#)
[010LF](#) [65817-015LF](#) [65863-015LF](#) [66207-023LF](#) [67095-007LF](#) [67601157](#) [68645-018](#) [68648-049](#) [70.362.1628.0](#) [70-4210](#) [70-4226B](#) [70-](#)
[4853B](#) [707-5020](#) [707-5028](#) [71.350.2428.0](#) [71918-208LF](#) [71961-016LF](#) [733-134](#) [733-162](#) [754199-000](#) [760-3052](#) [787-8014-00](#) [79531-3000](#)
[FCN-360C032-B](#) [FCN-367T-T012/H](#) [FCN-723D010/2](#) [80.063.4001.1](#) [800-90-001-10-001000](#) [800-90-010-10-002000](#) [801-43-002-10-013000](#)