

THIS DRAWING IS UNPUBLISHED. RELEASED FOR PUBLICATION
 © COPYRIGHT BY TYCO ELECTRONICS CORPORATION. ALL RIGHTS RESERVED.

LOC	DIST	REVISIONS					
CM	00	P	LTR	DESCRIPTION	DATE	DWN	APVD
		A1		REVISED PER ECR-10-008344	30APR10	HMR	KR

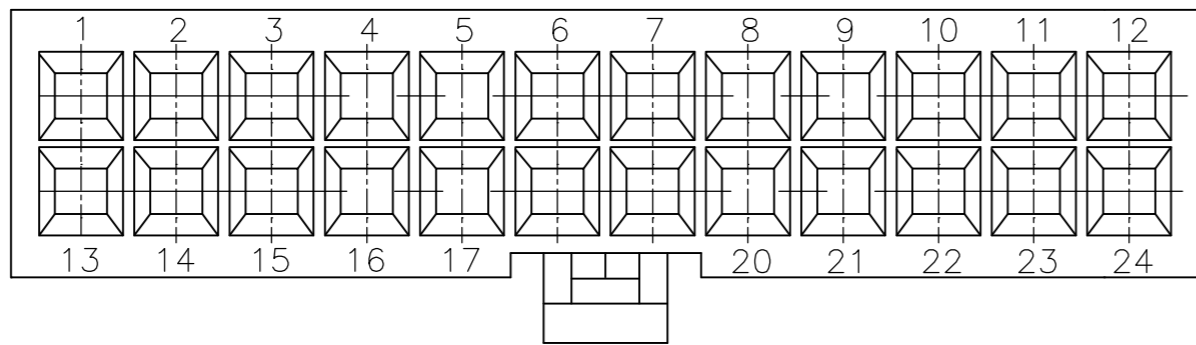

1 MATERIAL: NYLON, UL94V-2, RED.

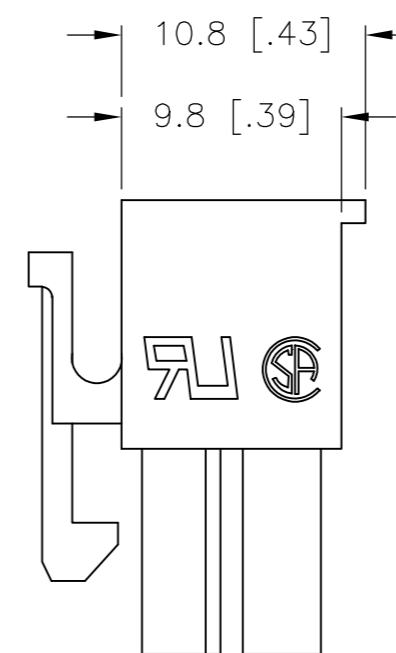
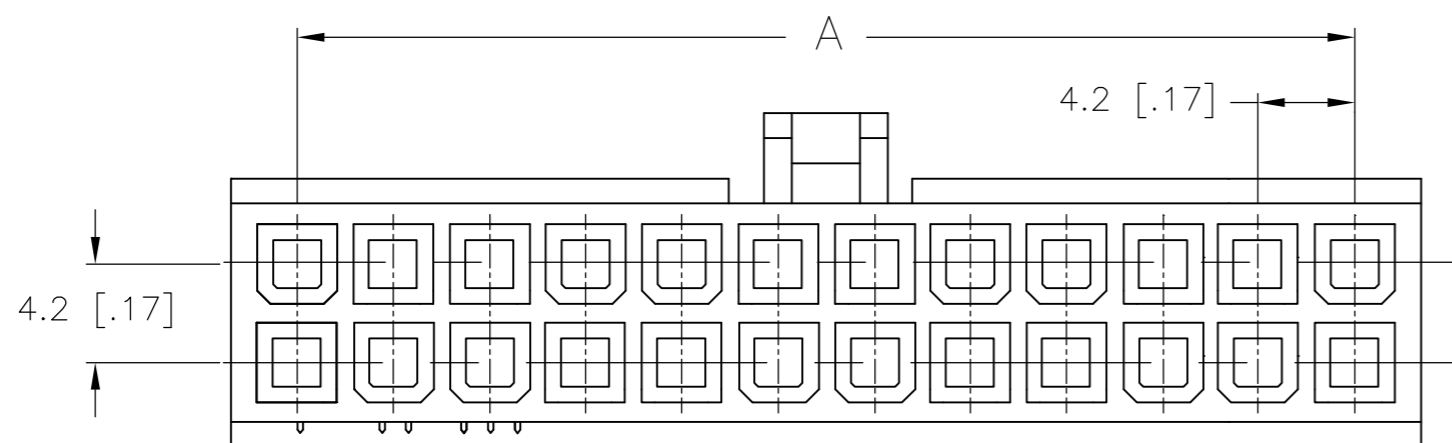
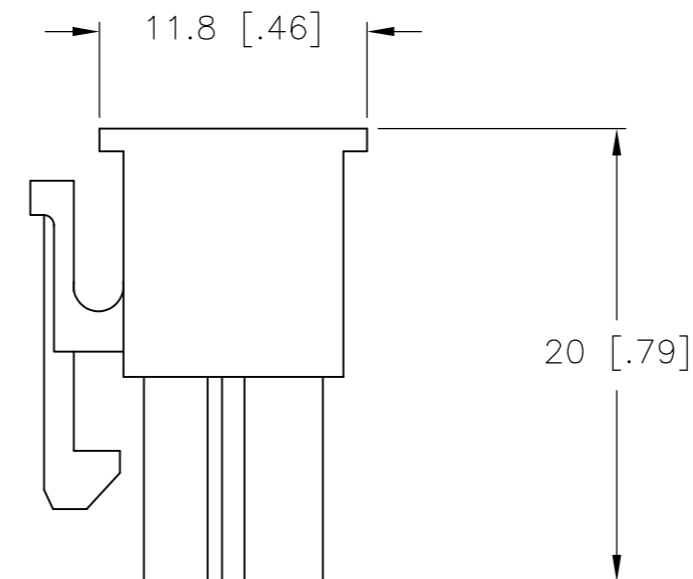
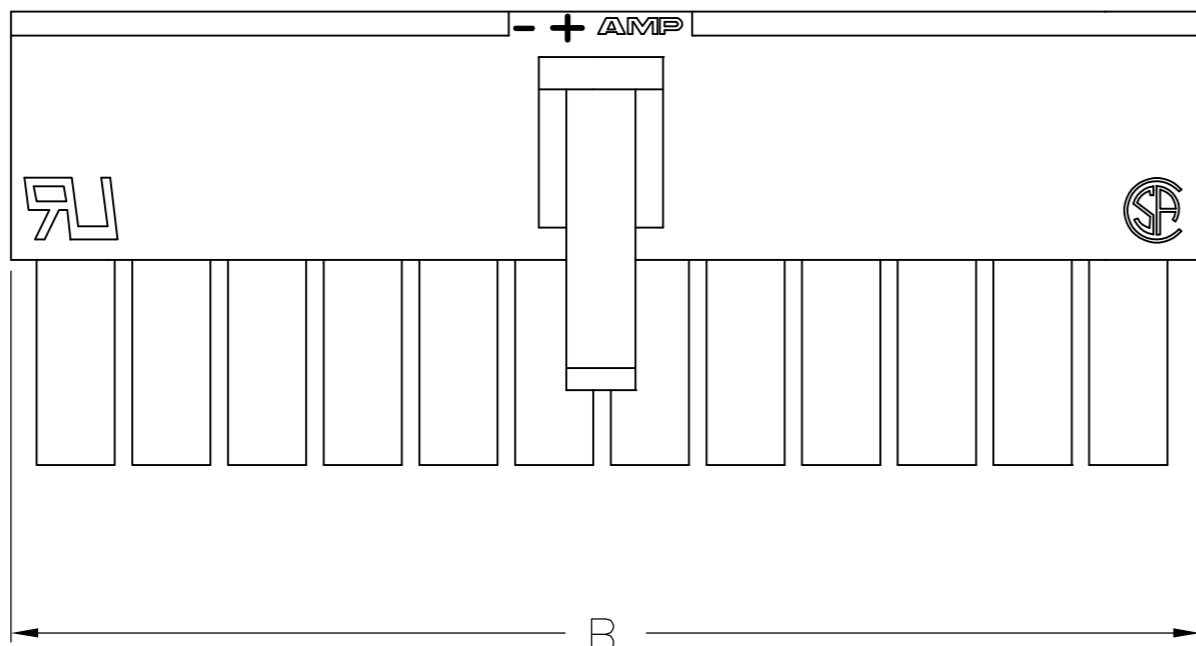

ONLY FOR 2029091-2

51.6	46.2	24	2-2029091-4
47.4	42.0	22	2-2029091-2
43.2	37.8	20	2-2029091-0
39.0	33.6	18	1-2029091-8
34.8	29.4	16	1-2029091-6
30.6	25.2	14	1-2029091-4
26.4	21.0	12	1-2029091-2
22.2	16.8	10	1-2029091-0
18.0	12.6	8	2029091-8
13.8	8.4	6	2029091-6
9.6	4.2	4	2029091-4
5.4	-	2	2029091-2
DIM B	DIM A	POS.	PART NUMBER

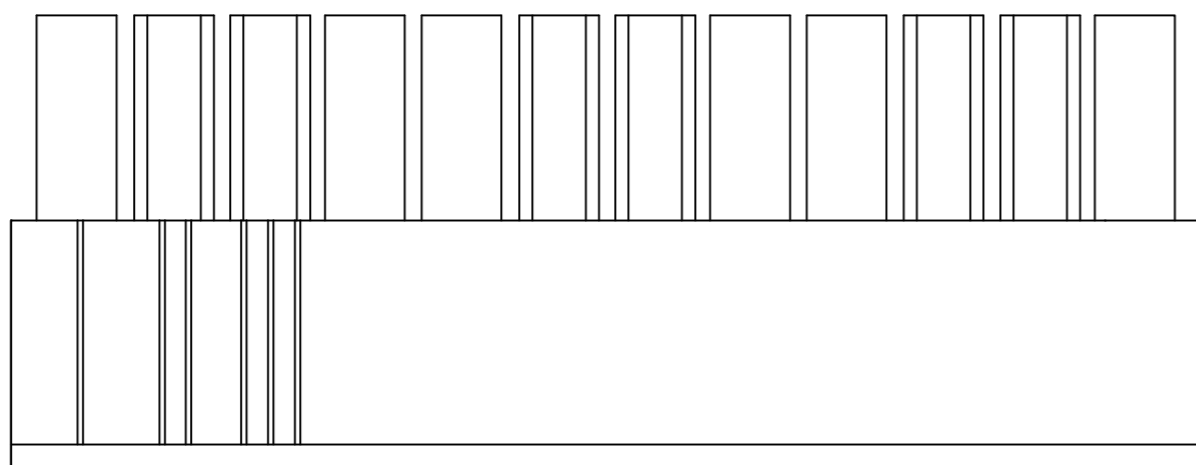

THIS DRAWING IS A CONTROLLED DOCUMENT.		DWN K. WHITAKER 08APR2008	Tyco Electronics Corporation Harrisburg, PA 17105-3608	
DIMENSIONS: mm [INCHES]		CHK C. CASH 08APR2008	NAME RECEPTACLE HOUSING, RED, VAL-U-LOK(TM)	
TOLERANCES UNLESS OTHERWISE SPECIFIED: 0 PLC ± 1 PLC ± 0.4 [.02] 2 PLC ± 0.25 [.010] 3 PLC ± 0.150 [.0059] 4 PLC ± ANGLES ± FINISH		APVD C. CASH 08APR2008	APPLICATION SPEC	
MATERIAL 1		PRODUCT SPEC	SIZE A2	CAGE CODE 00779
METRIC		WEIGHT	DRAWING NO C=2029091	RESTRICTED TO -
CUSTOMER DRAWING		SCALE 3:1	SHEET 1 of 1	REV A1

X-ON Electronics

Largest Supplier of Electrical and Electronic Components

Click to view similar products for [Headers & Wire Housings](#) category:

Click to view products by [TE Connectivity](#) manufacturer:

Other Similar products are found below :

[892-18-020-10-001101](#) [58102-G61-06LF](#) [582553-1](#) [0009485154](#) [009176003701906](#) [0050291907](#) [LY20-4P-DT1-P1E-BR](#) [02.125.8002.8](#)
[609-3404](#) [61062-3](#) [61082-181009](#) [622-3653LF](#) [63453-116](#) [636-1030](#) [636-1427](#) [636-3427](#) [636-4007](#) [641938-9](#) [641991-4](#) [644827-2](#) [65817-](#)
[010LF](#) [65817-015LF](#) [65863-015LF](#) [66207-023LF](#) [67095-007LF](#) [67601157](#) [68645-018](#) [68648-049](#) [70.362.1628.0](#) [70-4210](#) [70-4226B](#) [70-](#)
[4853B](#) [707-5020](#) [707-5028](#) [71.350.2428.0](#) [71918-208LF](#) [71961-016LF](#) [733-134](#) [733-162](#) [754199-000](#) [760-3052](#) [787-8014-00](#) [79531-3000](#)
[FCN-360C032-B](#) [FCN-367T-T012/H](#) [FCN-723D010/2](#) [80.063.4001.1](#) [800-90-001-10-001000](#) [800-90-010-10-002000](#) [801-43-002-10-013000](#)