

REVISIONS

P	LTR	DESCRIPTION	DATE	DWN	APVD
B		REVISED PER ECR-10-003329	16FEB2010	HMR	DD
B1		REVISED PER ECR-19-015136	27SEP2019	SB	DD
B2		REVISED PER ECR-20-007067	24JUN2020	SB	DD

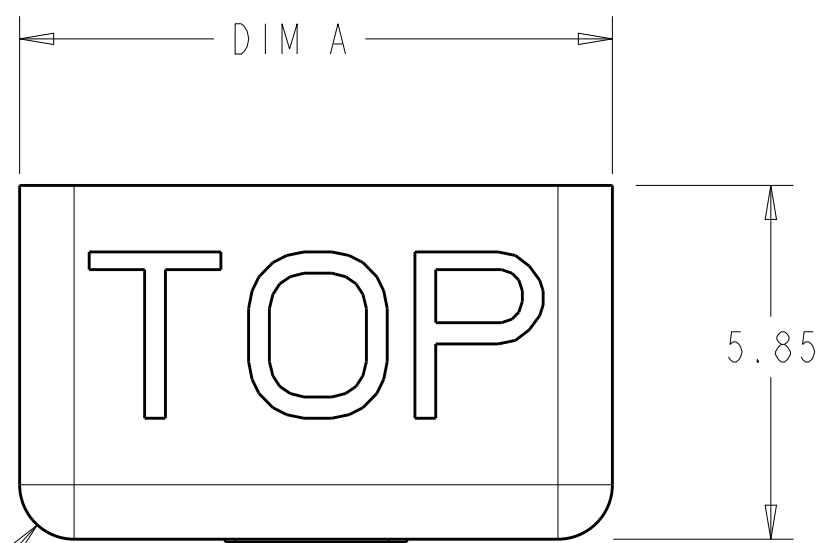

R0.90
TYP

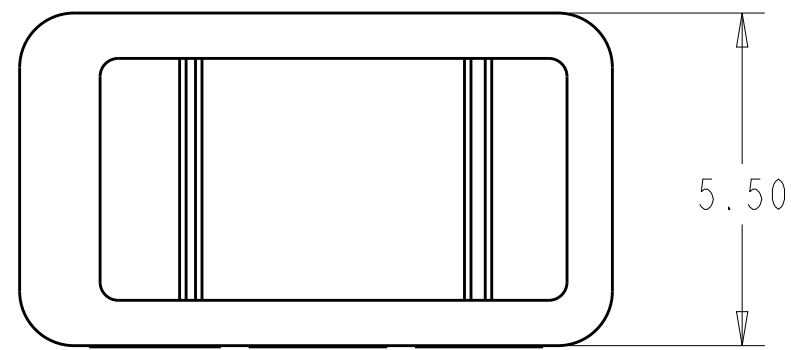
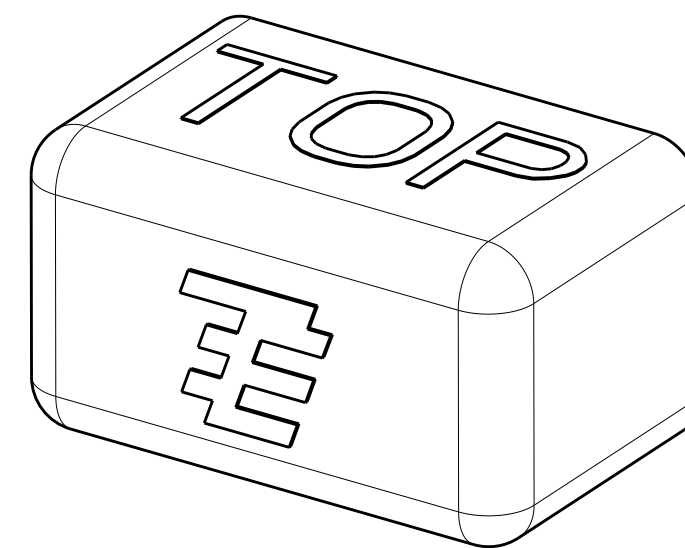
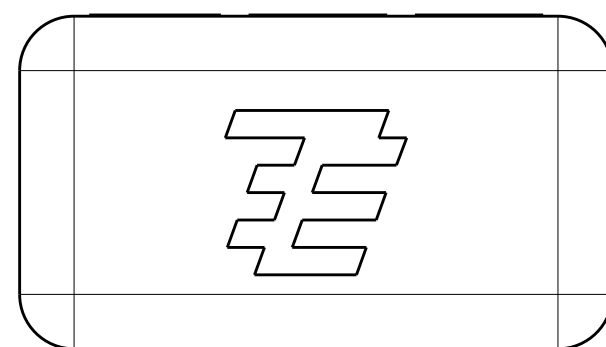

2058128-1
SHOWN

- 1 MATERIAL : PBT
- 2. PRODUCT TO COMPLY WITH DIRECTIVE 2002/95/EC(ROHS)
- 3 PRELIMINARY
- 4. FOR USE WITH TE P/N 1954289-X AND 2058703-X

	BLACK	25.80	6	1-2058128-3
	BLACK	17.80	4	1-2058128-2
	BLACK	9.80	2	1-2058128-1
	NATURAL	25.80	6	2058128-3
	NATURAL	17.80	4	2058128-2
	NATURAL	9.80	2	2058128-1
	COLOR	DIM A	POSN	PART NO.

THIS DRAWING IS A CONTROLLED DOCUMENT.		DWN R BROWN 26NOV2008	TE Connectivity	
		CHK R NARANG 26NOV2008		
DIMENSIONS:	TOLERANCES UNLESS OTHERWISE SPECIFIED:	APVD -	NAME DUSTCAP BLADE AND RECEPTACLE	
mm	0 PLC ± 1 PLC ±0.2 2 PLC ±0.13 3 PLC ± 4 PLC ±	PRODUCT SPEC -	SIZE A2	
	ANGLES ±2° FINISH -	APPLICATION SPEC 114-13225	CAGE CODE 00779	DRAWING NO C-2058128
MATERIAL		WEIGHT -	RESTRICTED TO	
		CUSTOMER DRAWING	SCALE 8:1	SHEET 1 OF 1
			REV B2	

X-ON Electronics

Largest Supplier of Electrical and Electronic Components

Click to view similar products for [Lighting Connectors](#) category:

Click to view products by [TE Connectivity](#) manufacturer:

Other Similar products are found below :

[293300-7](#) [293660-5](#) [CNX_H03_NTP](#) [30-9767-BU](#) [3605](#) [3-21030-1](#) [ZCH-110-RGB-I](#) [503471-0290](#) [ZCH-110-RGB-J](#) [217-0716-200](#)
[1954563-1](#) [1-293657-2](#) [2834036-1](#) [2834037-1](#) [1-2213222-4](#) [2-2213222-4](#) [2213222-4](#) [2834122-3](#) [2834122-5](#) [2834135-2](#) [FLA-R4142-30](#)
[FLA-R4162-30](#) [FLA-R2142-30](#) [FLA-R2141-30](#) [FLA-R2162-30](#) [FLA-R2161-30](#) [FLA-R0161-30](#) [FLA-R0141-30](#) [FLA-R0142-30](#) [FLA-](#)
[R0162-30](#) [FLA-C00-00](#) [DGA00010553](#) [CNXV04NTP](#) [104128-0610](#) [503485-0000 \(Cut Strip\)](#) [503485-0000 \(Loose Piece\)](#) [503485-0000](#)
[\(MINI Reel\)](#) [1-2834074-2](#) [1-2834074-3](#) [1357-AC PLUG W2C \(CHINA\)](#) [1357-AC PLUG W2 \(USA\)](#) [104266-0110](#) [2106212-1](#) [2-2834074-2](#)
[104266-0210](#) [293470-1](#) [293651-2](#) [293651-4](#) [1-2834006-2](#) [293651-1](#)