

THIS DRAWING IS UNPUBLISHED. RELEASED FOR PUBLICATION  
 © COPYRIGHT - By - ALL RIGHTS RESERVED.

REVISIONS				
P	LTR	DESCRIPTION	DATE	APVD
	D3	REVISED PER ECO-17-008188	4JAN2018	C.X D.Z

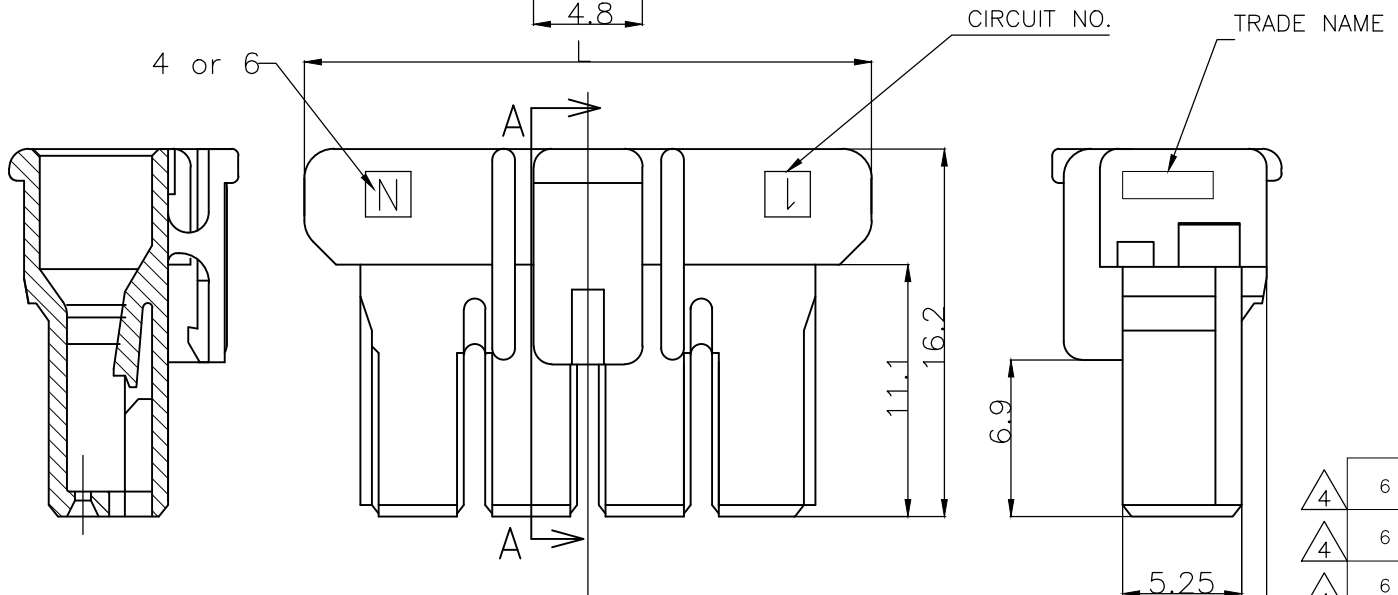

THE TYPE OF KEYING

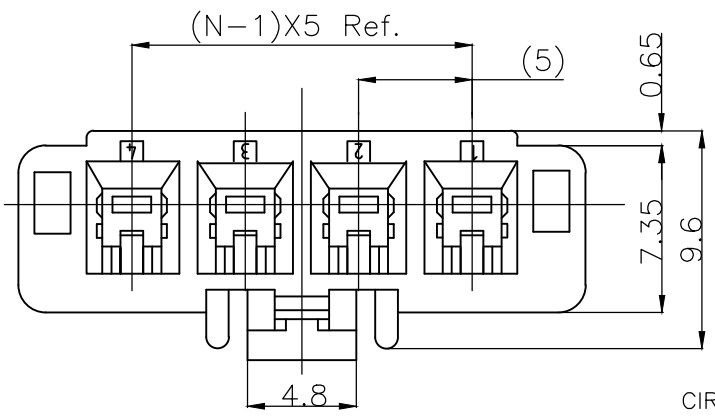
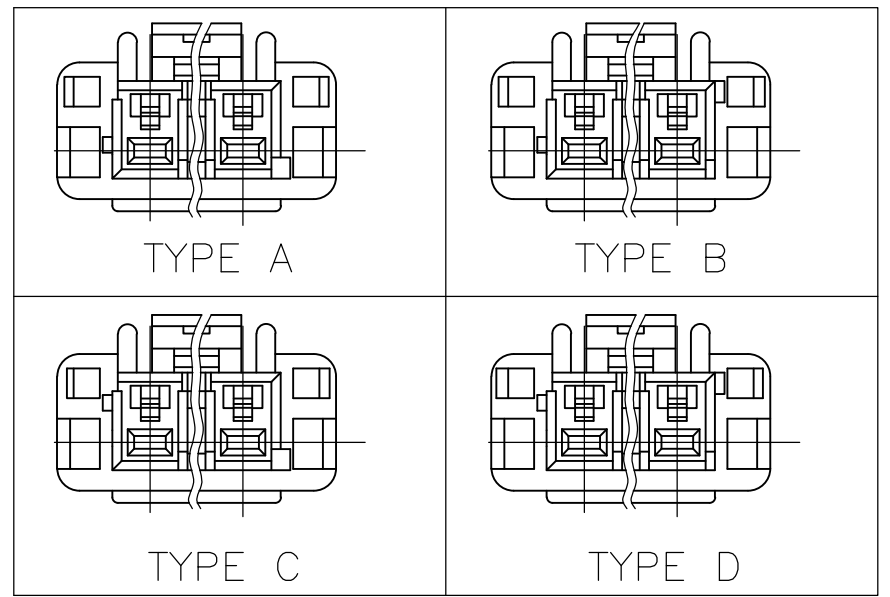

HOSING	6 / 6 NYLON GRASS FILLED/ NYLON 6
NAME	MATERIAL

SECT A-A

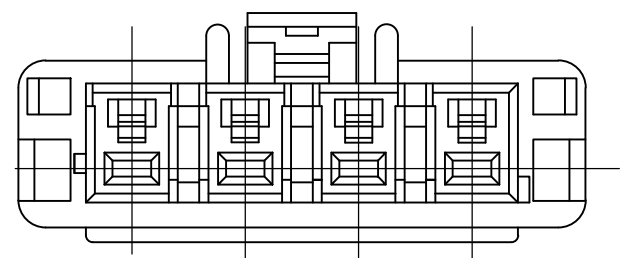

4	6	25	35	1376397-1	3-1376385-4	TYPE D	YELLOW	6Pos	3-1376391-4			
4	6	25	35	1376397-1	2-1376385-3	TYPE C	BLUE	6Pos	2-1376391-3			
4	6	25	35	1376397-1	1-1376385-2	TYPE B	RED	6Pos	1-1376391-2			
4	6	25	35	1376397-1	1376385-1	TYPE A	NATURAL	6Pos	1376391-1			
3	4	15	25	1376396-1	1-1376384-5	TYPE B	RED	4Pos	1-1376390-5			
3	4	15	25	1376396-1	1-1376384-6	TYPE A	NATURAL	4Pos	1376390-5			
4	4	15	25	1376396-1	3-1376384-4	TYPE D	YELLOW	4Pos	3-1376390-4			
4	4	15	25	1376396-1	2-1376384-3	TYPE C	BLUE	4Pos	2-1376390-3			
4	4	15	25	1376396-1	1-1376384-2	TYPE B	RED	4Pos	1-1376390-2			
4	4	15	25	1376396-1	1376384-1	TYPE A	NATURAL	4Pos	1376390-1			
DIMENSION				N	M	L	APPLICABLE PLATE. P/N	MATING CONN. P/N	THE TYPE OF KEYING	Color	Pos	PART NO.

1 MATING CONN. P/N  
 HEADER ASS'Y :SEE TABLE  
 REC CONTACT ;1376347-1,1376348-1

2 PARTS COMPLY WITH GLOW WIRE  
 REQUIREMENT FOR PARTS OF NON-METALLIC  
 MATERIAL SUPPORTING A CURRENT-CARRYING  
 CONNECTION DETAILED IN IEC 60335-1,  
 SECTION 30 (GWT) .

- 3 NYLON 6, GWT, V-2.
- 4 NYLON 66, GWT, V-0.

THIS DRAWING IS A CONTROLLED DOCUMENT.		DWN A.OISHI 31AUG00	<b>TE Connectivity</b>	
DIMENSIONS: mm		CHK Y.KASHIWA 28AUG'00		
TOLERANCES UNLESS OTHERWISE SPECIFIED:		APVD Y.KASHIWA 28AUG'00	NAME 5.0 POWER KEY CONNECTOR 4P PLUG HOUSING	
0 PLC ± 0.2 1 PLC ± 0.2 2 PLC ± 0.2 3 PLC ± 4 PLC ± ANGLES ± 1°		PRODUCT SPEC 108-5699	SIZE A3	
MATERIAL SEE TABLE		APPLICATION SPEC 104-5292	CAGE CODE 00779	DRAWING NO C-1376390
FINISH SEE TABLE		WEIGHT	RESTRICTED TO -	
CUSTOMER DRAWING			SCALE 3:1	SHEET 1 OF 1
			REV D3	

## X-ON Electronics

Largest Supplier of Electrical and Electronic Components

*Click to view similar products for [Headers & Wire Housings](#) category:*

*Click to view products by [TE Connectivity](#) manufacturer:*

Other Similar products are found below :

[892-18-020-10-001101](#) [58102-G61-06LF](#) [582553-1](#) [0009485154](#) [009176003701906](#) [0050291907](#) [LY20-4P-DT1-P1E-BR](#) [02.125.8002.8](#)  
[609-3404](#) [61062-3](#) [61082-181009](#) [622-3653LF](#) [63453-116](#) [636-1030](#) [636-1427](#) [636-3427](#) [636-4007](#) [641938-9](#) [641991-4](#) [644827-2](#) [65817-](#)  
[010LF](#) [65817-015LF](#) [65863-015LF](#) [66207-023LF](#) [67095-007LF](#) [67601157](#) [68645-018](#) [68648-049](#) [70.362.1628.0](#) [70-4210](#) [70-4226B](#) [70-](#)  
[4853B](#) [707-5020](#) [707-5028](#) [71.350.2428.0](#) [71918-208LF](#) [71961-016LF](#) [733-134](#) [733-162](#) [754199-000](#) [760-3052](#) [787-8014-00](#) [79531-3000](#)  
[FCN-360C032-B](#) [FCN-367T-T012/H](#) [FCN-723D010/2](#) [80.063.4001.1](#) [800-90-001-10-001000](#) [800-90-010-10-002000](#) [801-43-002-10-013000](#)