

REVISIONS				
REV	DATE	DESCRIPTION	BY	APP'D
F1	29AUG2020	ECO-18-014918	RR	SH

- △ MATERIAL:
HOUSING - HIGH TEMPERATURE THERMOPLASTIC, BLACK, UL94V-0; IR REFLOW SOLDERING PROCESS COMPATIBLE.
TERMINALS - .36[.014] THICK PHOS BRONZE PLATED WITH 3.8 μ m[.000150] MINIMUM THICK (SEE P/N TABLE) IN SOLDER AREA. 1.27 μ m [0.00050] MINIMUM GOLD IN LOCALIZED PLATE AREA. ENTIRE TERMINAL PLATED WITH 1.27 μ m [0.00050] MINIMUM THICK NICKEL.
- 2. JACK CAVITY CONFORMS TO FCC RULES AND REGULATIONS PART 68, SUBPART F.
- △ SUGGESTED PANEL OPENING DIMENSIONS.
- △ SUGGESTED CLEARANCE BETWEEN BOTTOM OF CONNECTOR AND BOTTOM PANEL OPENING.
- △ PACKAGED 35 PIECES PER TUBE, SEE DETAIL "A".
- △ 80 PIECES/TRAY, 10 TRAYS/BOX.
- △ MANUFACTURING DATE CODE:
INK STAMP, LOCATED APPROX. AS SHOWN.
FIRST 2 DIGITS = LAST 2 DIGITS OF YEAR.
NEXT 2 DIGITS = MANUFACTURING WORK WEEK.
LAST DIGIT = DAY OF WEEK WITH SUNDAY = 1.

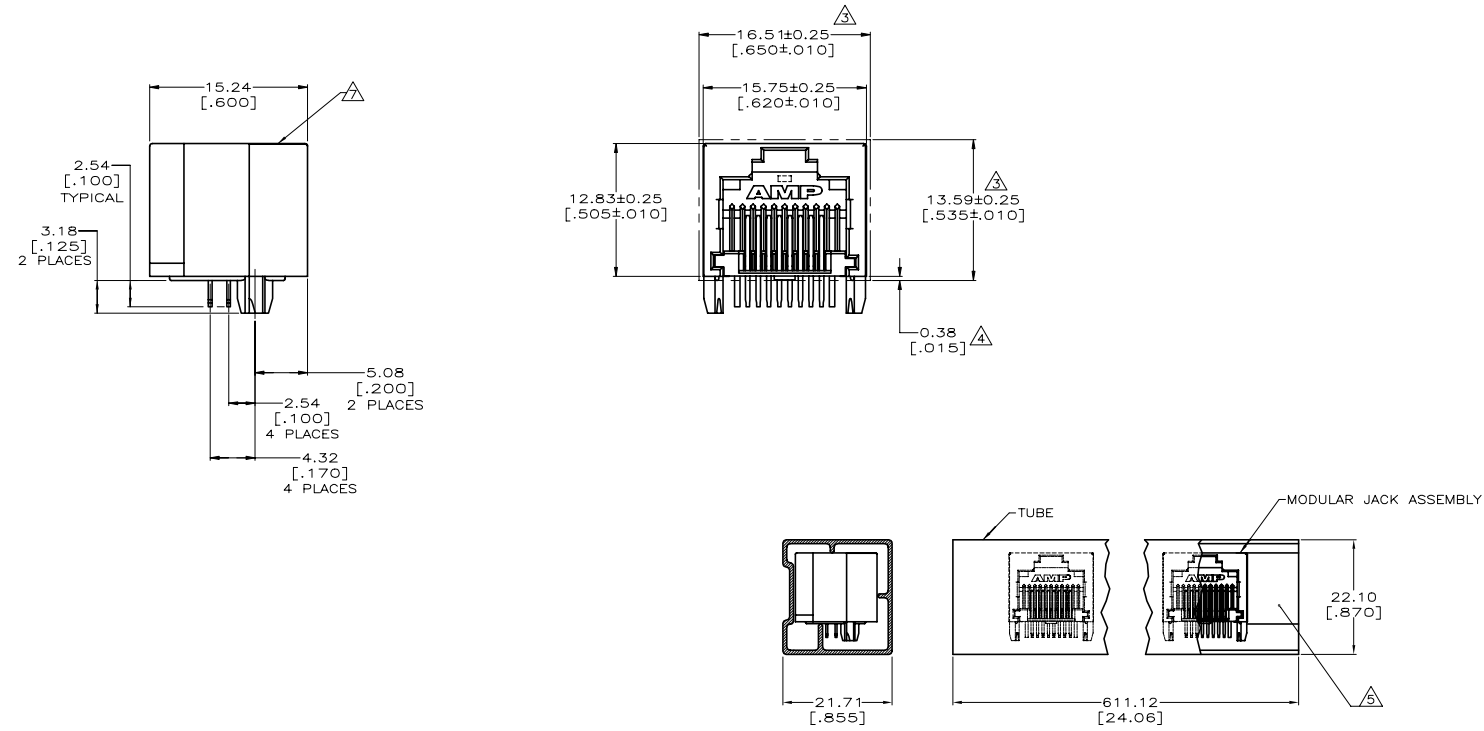

DETAIL A
TUBE PACKAGING
SCALE 2:1

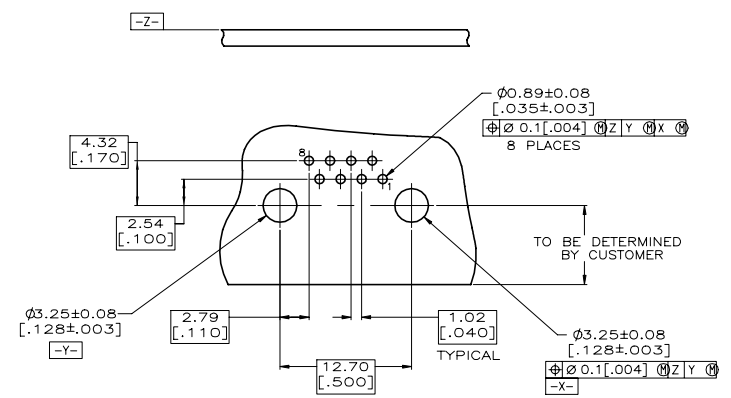

SUGGESTED PRINTED CIRCUIT BOARD LAYOUT
(COMPONENT SIDE)

OBSOLETE	MATTE TIN	△ TUBE	1-406525-3
	MATTE TIN	△ TRAY, PICK & PLACE COMPATIBLE	1-406525-2
		TRAY	1-406525-1
OBSOLETE	BRIGHT TIN-LEAD	△ TUBE	406525-3
OBSOLETE	BRIGHT TIN-LEAD	△ TRAY, PICK & PLACE COMPATIBLE	406525-2
OBSOLETE	BRIGHT TIN-LEAD	TRAY	406525-1
	△ TERMINAL PLATING	PACKAGING	PART NUMBER
THIS DRAWING IS A CONTROLLED DOCUMENT.		DATE: 17SEP97	TE Connectivity
DRAWN BY: S. GARBETT		DATE: 17SEP97	
CHECKED BY: S. GARBETT		DATE: 17SEP97	
APPROVED BY: M. BERSTINE		DATE: 17SEP97	
DIMENSIONS: mm (INCHES)		PRODUCT SPEC	INVERTED MODULAR JACK ASSEMBLY, 1X1
0 PLG ± -	1 PLG ± -	108-1163-4	
2 PLG ± 0.25(.010)	3 PLG ± 0.38(.015)	APPLICATION SPEC	
4 PLG ± 0.51(.020)	5 PLG ± 0.64(.025)	114-2154	
6 PLG ± 0.76(.030)	7 PLG ± 0.89(.035)	SIZE DATE CODE DRAWING NO	RESTRICTED TO
8 PLG ± 1.02(.040)	9 PLG ± 1.27(.050)	A100779	C=406525
10 PLG ± 1.52(.060)	11 PLG ± 1.78(.070)	WEIGHT 0.000000	SCALE 4:1 SHEET 1 OF 1 REV F1
12 PLG ± 2.03(.080)	13 PLG ± 2.29(.090)	MATERIAL FINISH	
14 PLG ± 2.54(.100)	15 PLG ± 2.79(.110)	CUSTOMER DRAWING	

X-ON Electronics

Largest Supplier of Electrical and Electronic Components

Click to view similar products for [Modular Connectors / Ethernet Connectors](#) category:

Click to view products by [TE Connectivity](#) manufacturer:

Other Similar products are found below :

[8949-H88/06BLKA/SN](#) [74441-0010/BKN](#) [MP1010RX-1000](#) [MP44RX-1000](#) [PHJ-4P4C-1-V-4](#) [PHP-6P6C-5](#) [GAX-3-66](#) [GAX-8-62](#) [GDCX-PA-66-50](#) [GDCX-PN-64](#) [GDCX-PN-66](#) [GDCX-PN-66-50](#) [GDLX-A-66](#) [GDLX-N-66](#) [GDLX-S-66](#) [GDLX-S-88K](#) [GDLX-SMT-S-88](#) [GDTX-S-88-50](#) [GDX-PA-1010](#) [GLX-N-1010M-BLK](#) [GLX-S-88M-BLK](#) [GMX-N-1010](#) [GMX-S-1010](#) [GMX-S-66](#) [GMX-SMT4-N-88](#) [GPX-2-64](#) [GSGX-N-2-88](#) [GSGX-N-4-88](#) [GSX-NS2-88-3.05](#) [GSX-NS2-88-3.05-50](#) [GSX-NS-88-3.05-50](#) [PT-108A-8C-UL](#) [PT-J951-8C](#) [PTS-J531-8CS-50UL](#) [1-1775629-2](#) [A-2014-0-4](#) [GWLX-S-88-GR](#) [GWLX-S9-88-YG](#) [DC-1021-8-WH-6](#) [1300530003](#) [1324640-4](#) [RJ11FTVC2G](#) [RJ11FTVC2N](#) [RJFTVX2SA1G](#) [132764-001](#) [1413235](#) [MP88X-1000](#) [MPS88RX-5000](#) [E5288-S000K3-L](#) [E5908-15A242-L](#)