

THIS DRAWING IS UNPUBLISHED. RELEASED FOR PUBLICATION
 © COPYRIGHT BY TYCO ELECTRONICS CORPORATION. ALL RIGHTS RESERVED.

LOC	DIST	REVISIONS					
HC	00	P	LTR	DESCRIPTION	DATE	DWN	APVD
		0		RELEASE PER EC 0S14-0166-04	4/16/04	-	DCam

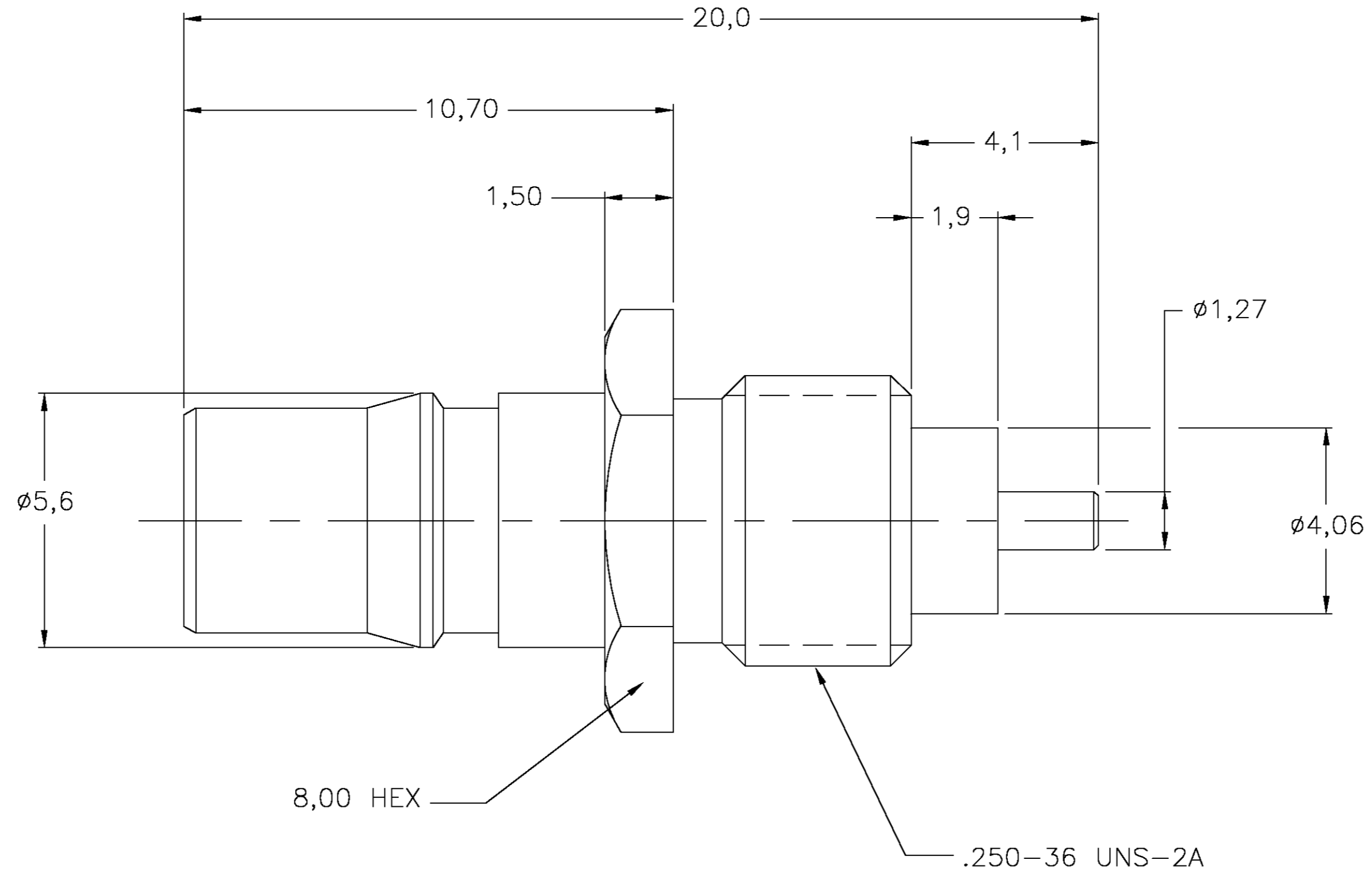

1408340-1
 PART NO.

CONTACT	BERYLLIUM COPPER	GOLD
HOUSING	BRASS	NICKEL
DIELECTRIC	PTFE	N/A
COMPONENT	MATERIAL	FINISH

THIS DRAWING IS A CONTROLLED DOCUMENT.		DWN DCam	04JUN2003	tyco Tyco Electronics Corporation	
DIMENSIONS: MM		CHK -	-	Norwood, MA 02052	
TOLERANCES UNLESS OTHERWISE SPECIFIED:		APVD DCam	4/16/04	NAME QMA FRONT MOUNT JACK RECEPTACLE STRAIGHT TERMINAL	
0 PLC ± -		PRODUCT SPEC 108-2087	-	SIZE A2	
1 PLC ± 0,3		APPLICATION SPEC -	-	CAGE CODE 00779	DRAWING NO C=1408340
2 PLC ± 0,10		WEIGHT -	-	RESTRICTED TO -	-
3 PLC ± -		CUSTOMER DRAWING			
4 PLC ± -		SCALE 10:1	SHEET 1	OF 1	REV 0
ANGLES ± 1					
FINISH -					

X-ON Electronics

Largest Supplier of Electrical and Electronic Components

Click to view similar products for [RF Connectors / Coaxial Connectors](#) category:

Click to view products by [TE Connectivity](#) manufacturer:

Other Similar products are found below :

[R125315120](#) [8915-1511-000](#) [89674-0827](#) [5916-1103-603](#) [6-0001-3](#) [6001-7071-019](#) [6002-7051-003](#) [6002-7551-202](#) [6059674-1](#) [619550-1](#)
[630059-000](#) [M39012/25-0021](#) [M39012/79-3008](#) [M39030/3-01N](#) [M39030/3-03N](#) [M3933/25-36N](#) [6500-7071-046](#) [M83723/72W24576](#)
[M83723/72W2457N](#) [6769](#) [CX050L2AQ](#) [7002-1541-010](#) [7002-1572-002](#) [7003-1572-002](#) [7010-1511-000](#) [7029-1511-060](#) [7101-1541-010](#)
[7101-1571-002](#) [7105-1521-002](#) [7145-1521-002](#) [7209-1511-011](#) [7210-1511-015](#) [7210-1511-019](#) [7225-1512-050](#) [7242-1511-000](#) [73137-5015](#)
[73251-0111](#) [73251-0672](#) [7325-1512-000](#) [73276-1501](#) [73366-0013](#) [73404-2300](#) [73413-6080](#) [73415-5721](#) [7405-1521-005](#) [7405-1521-802](#)
[7406-1521-005](#) [804S01D04M040](#) [8145-1521-002](#) [81590](#)