

1438129-1
SHOWN WITH SPACER
IN SEATED POSITION

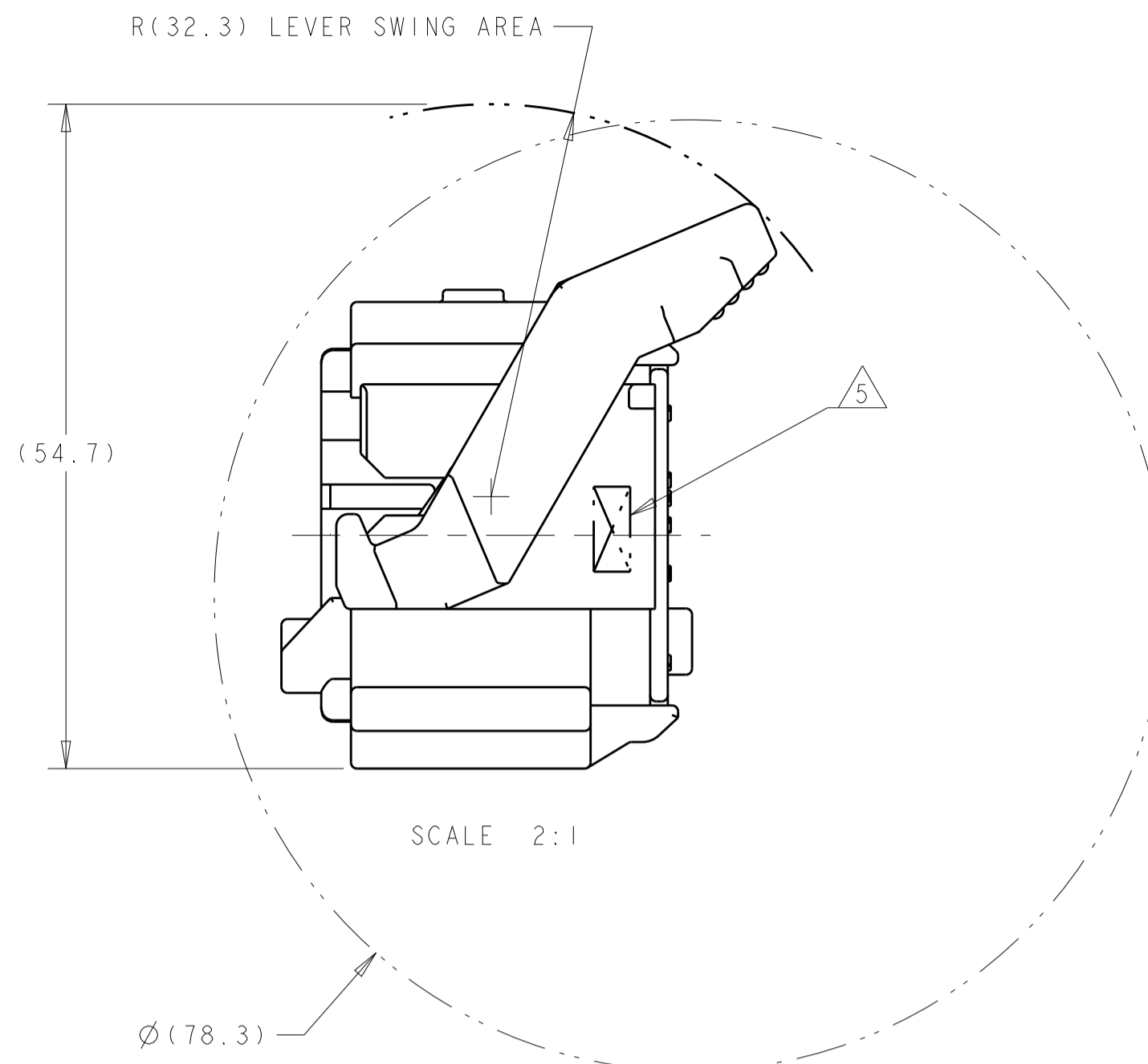

SCALE 2:1

MIN. FEED THRU
CONDITION WITH 1mm
CLEARANCE ALL AROUND
SHOWN WITH SPACER IN SEATED POSITION

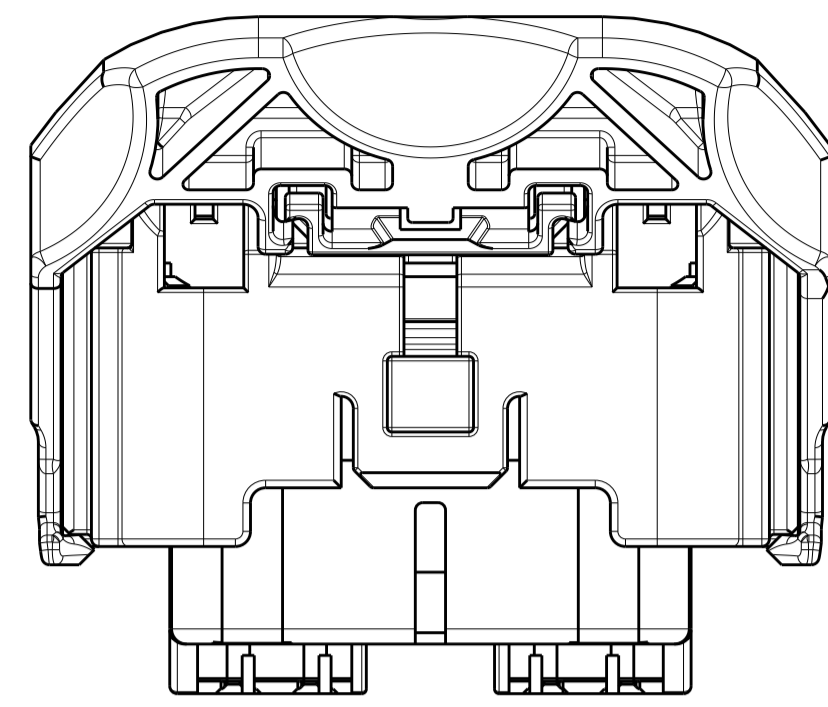
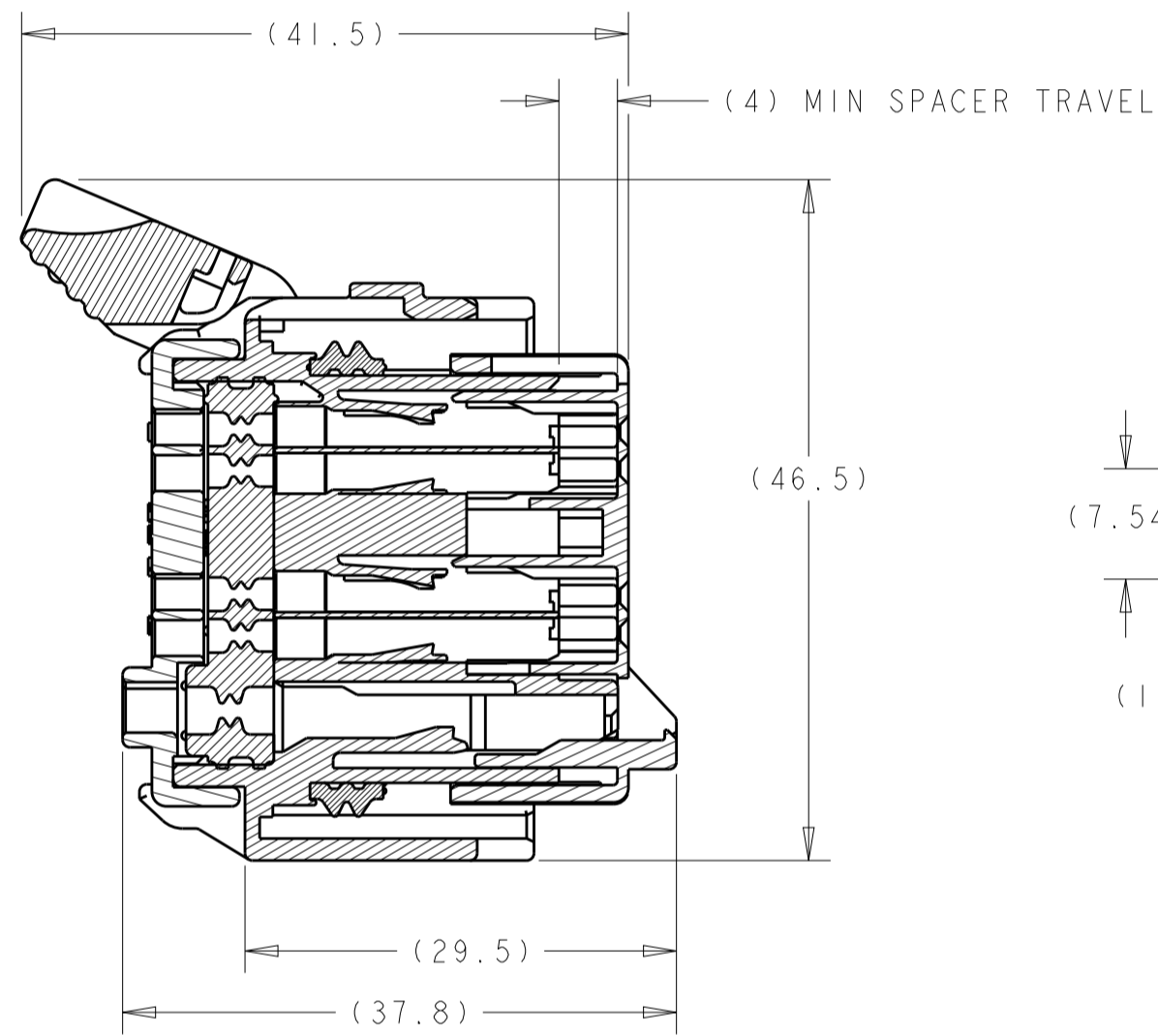

SECTION A-A
SPACER AND LEVER IN
PRE-SEATED POSITION
(DELIVERY CONDITION)

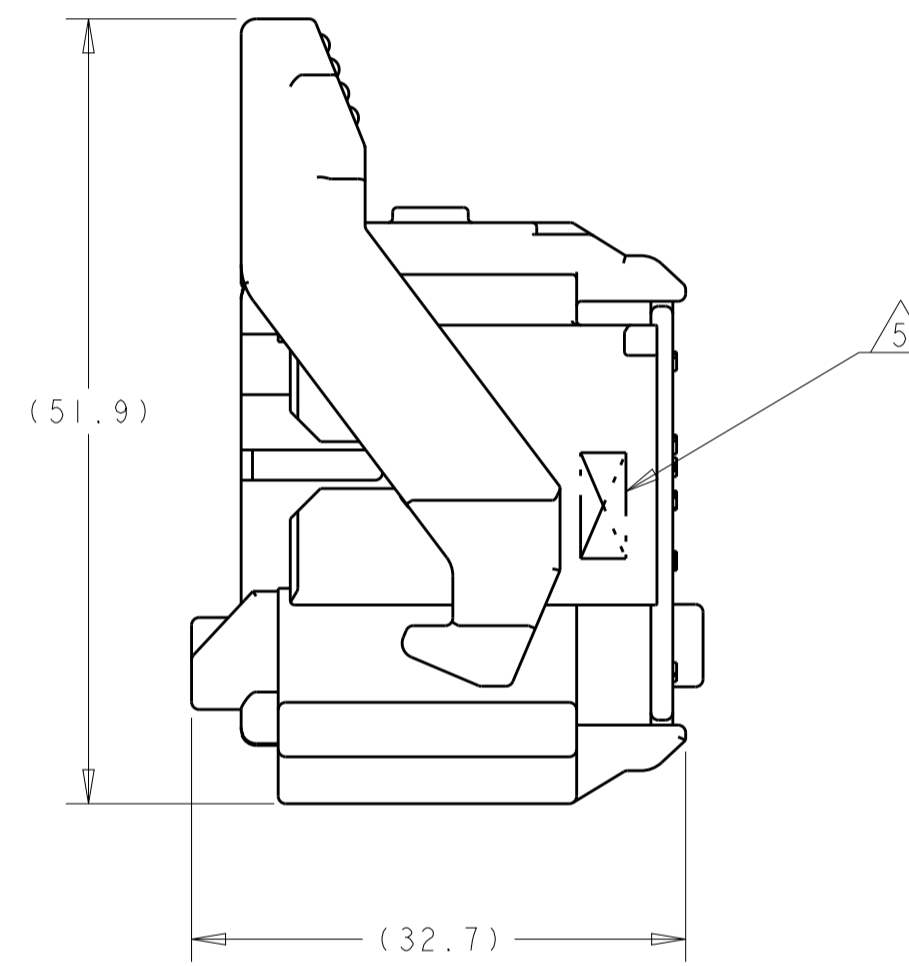
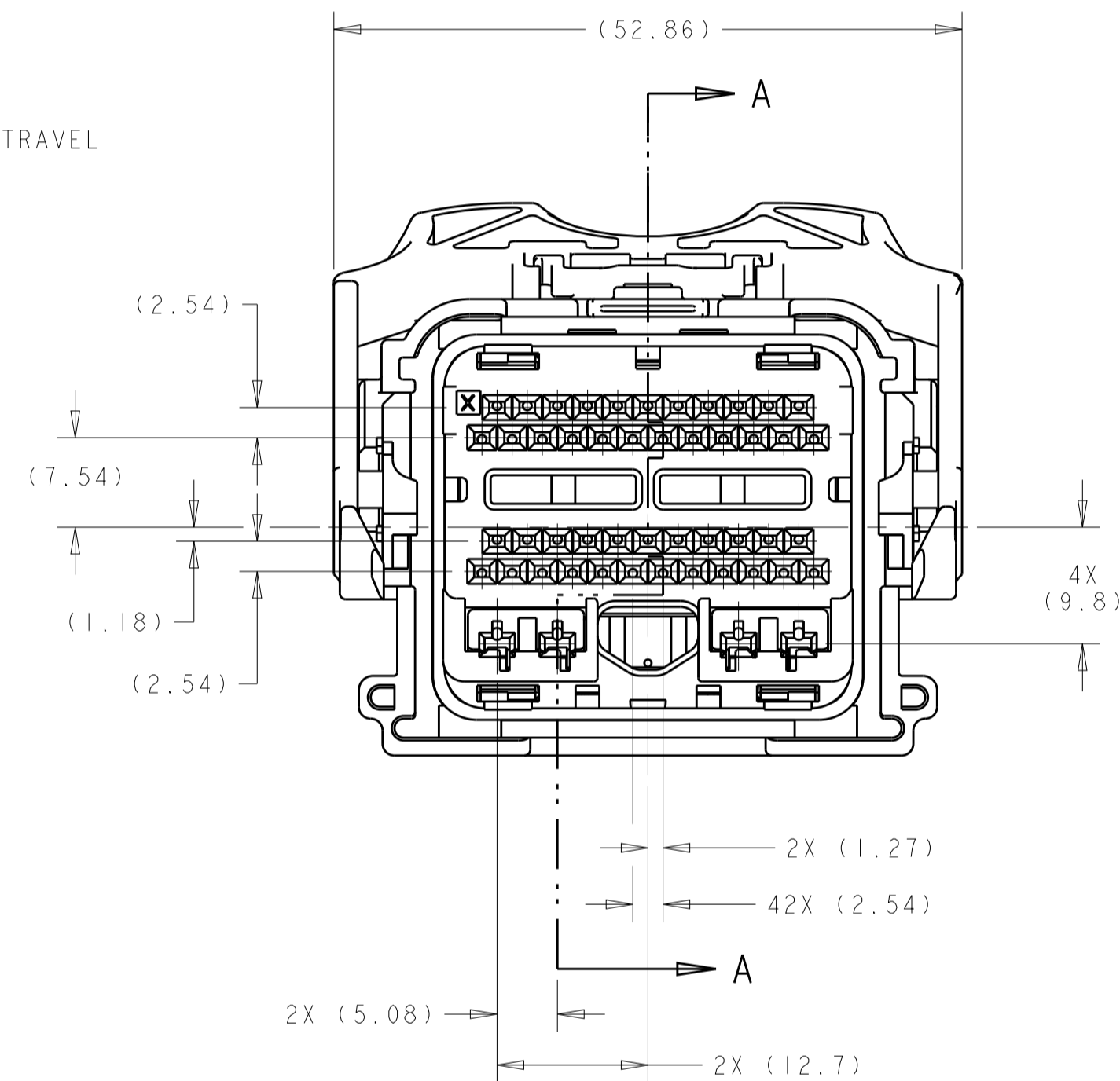

SHOWN WITH CAM
LEVER AND SPACER
IN LOADED POSITION

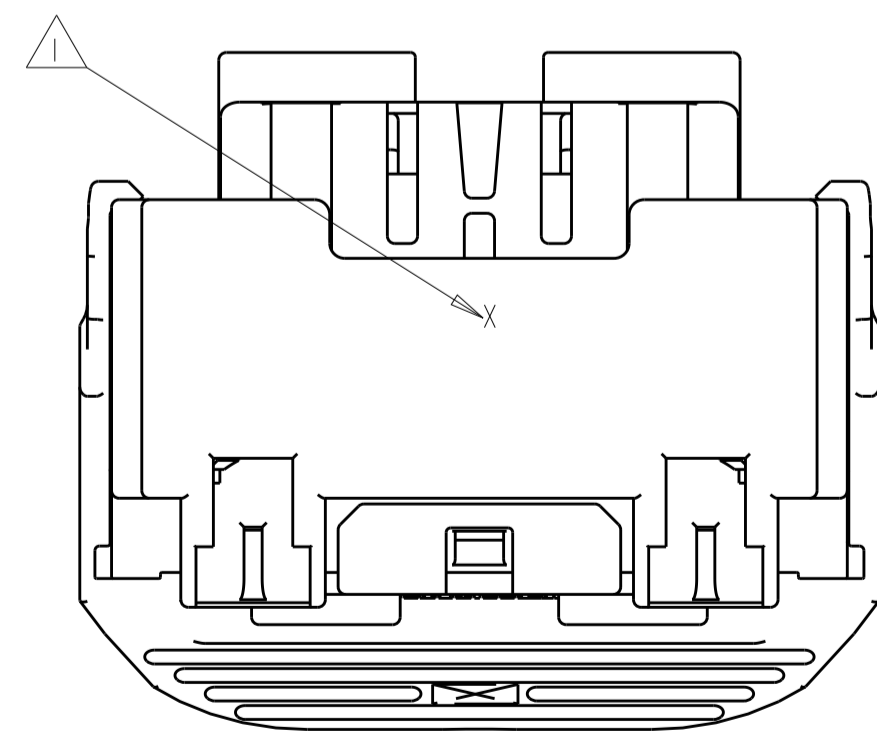

REVISIONS					
P.	LTN.	DESCRIPTION	DATE	OWN.	APVD.
F38		REVISED PER ECO-19-001669	19FEB2019	JMS	CM
F39		REVISED PER ECO-19-019471	08JAN2020	JMS	CM
F40		REVISED PER ECO-20-005499	21MAY2020	JMS	CM
F41		REVISED PER ECO-20-012739	05OCT2020	AP	CM

- 1. PRINT PART NUMBER (5S4T-14A464-L*-***, 5S4T-14A464-M*-***, 5S4T-14A464-N*-***) AND TRACEABILITY (YY : 2 DIGIT YEAR, JJJ = JULIAN DATE, HH = 2 DIGIT MILITARY HOUR CODE IN THE LOCATION AT ASSEMBLY. SEE SHEET 3 THRU 7 (-*) PART NUMBERS.
- 2. APPLICABLE MOLEX (1.5) POWER TERMINAL PART NUMBERS:
33012-0002 TIN 0.50-1.50mm²
- 3. CAM LEVER AND SPACER ARE SHIPPED IN THEIR PRE-ASSEMBLED POSITIONS.
- 4. REFERENCE TE CONNECTIVITY INSTRUCTION SHEET 408-8893.
- 5. COMPANY LOGO.
- 6. OBSOLETE PART.

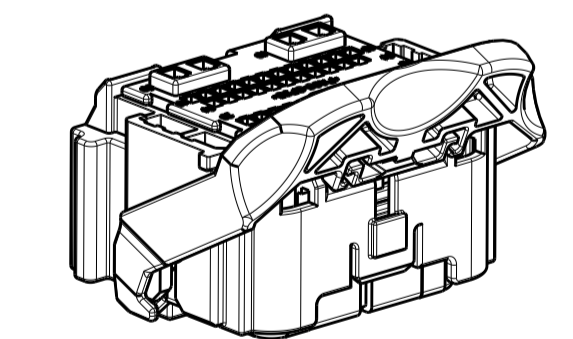

SCALE 1:1

APPLICABLE COMPONENTS (FOR REFERENCE ONLY)						
DESCRIPTION	NOMINAL TERMINAL SIZE	COLOR/PLATING	FORD COMPONENT PART NUMBER	SUPPLIER PART NUMBER	MATERIAL/SPECIFICATION NUMBER	SAE WIRE SIZE
TERMINAL - FEMALE (Ag)	0.64 (CAT. 0)	SILVER	7S4T-14474-AA	1393366-2	COPPER ALLOY/SILVER PLATE	20AWG
TERMINAL - FEMALE (Ag)	0.64 (CAT. 0)	SILVER	7S4T-14474-BA	1393367-2	COPPER ALLOY/SILVER PLATE	18AWG
TERMINAL - FEMALE (Sn)	0.64 (CAT. 0)	TIN	1L2T-14474-AA	1393366-1	COPPER ALLOY/TIN PLATE	20AWG
TERMINAL - FEMALE (Sn)	0.64 (CAT. 0)	TIN	1L2T-14474-BA	1393367-1	COPPER ALLOY/TIN PLATE	18AWG
TERMINAL - FEMALE (Au)	0.64 (CAT. 0)	GOLD	1L2T-14474-CA	1393365-1	COPPER ALLOY/GOLD PLATE	20AWG
TERMINAL - FEMALE (Au)	0.64 (CAT. 0)	GOLD	1L2T-14474-DA	1393364-1	COPPER ALLOY/GOLD PLATE	18AWG
TERMINAL - FEMALE (Au)	0.64 (CAT. 0)	GOLD	1L2T-14474-DA	1393364-1	COPPER ALLOY/GOLD PLATE	22AWG

ANY DESIGN CHANGES ON THIS ASSEMBLY MAY ALSO BE REQUIRED ON ASSEMBLY DRAWING 1438691

SEE TABLES
SHEETS 3 THRU 7
PART NUMBER

THIS DRAWING IS A CONTROLLED DOCUMENT.		OWN: R. VESTAL 15APR2005	
DIMENSIONS: mm		CHK: T. VALASEK 15APR2005	
TOLERANCES UNLESS OTHERWISE SPECIFIED:		APVD: T. VALASEK 15APR2005	NAME: 50-WAY HARNESS ASSEMBLY, PCM SIZE: CAGE CODE DRAWING NO: A100779C=1438129 WEIGHT: - CUSTOMER DRAWING
0 PLC ± 1 PLC ±0.3 2 PLC ±0.10 3 PLC ± 4 PLC ± ANGLES ±1°		PRODUCT SPEC: APPLICATION SPEC: SCALE: 1:1 SHEET 1 OF 10 REV: F41	

REVISIONS				
P.	LTN	DESCRIPTION	DATE	APPD
-	-	SEE SHEET 1	-	-

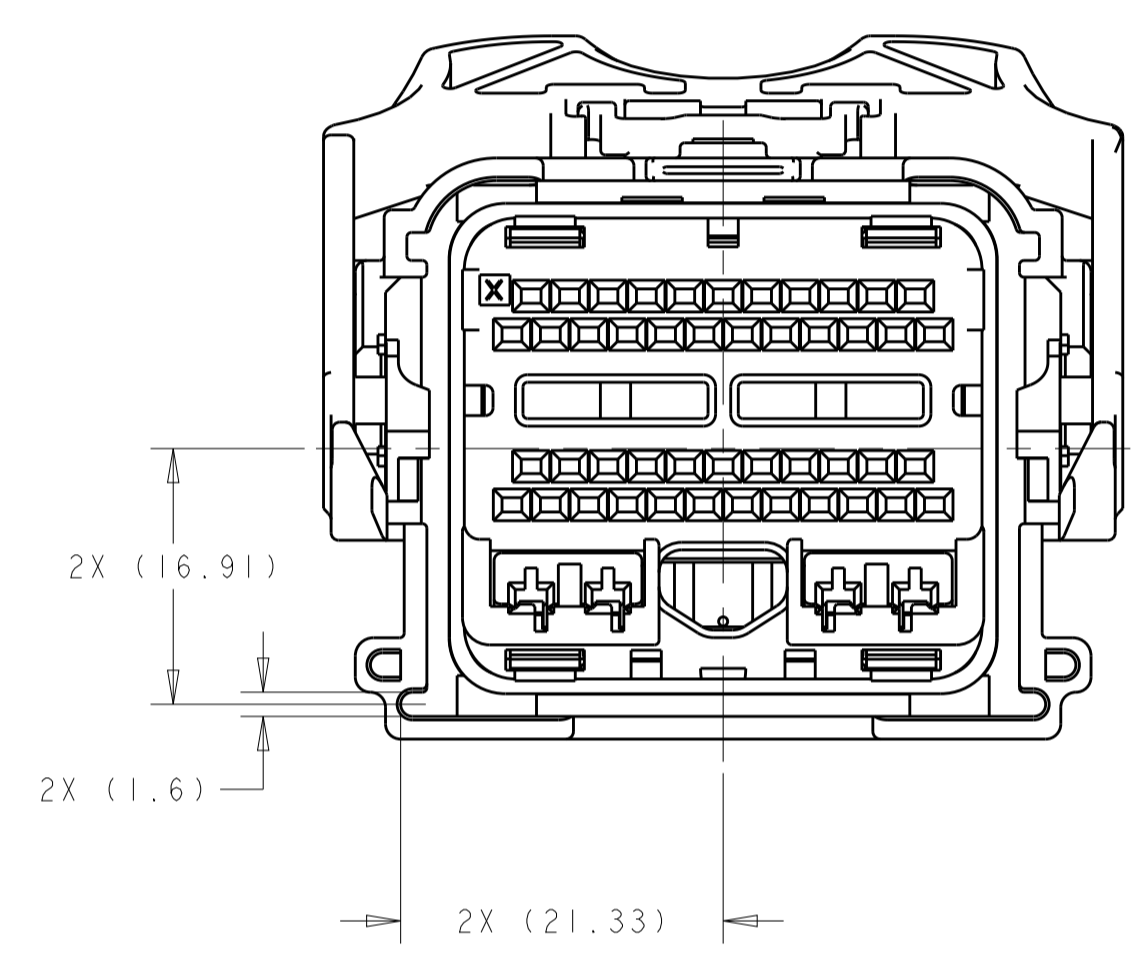
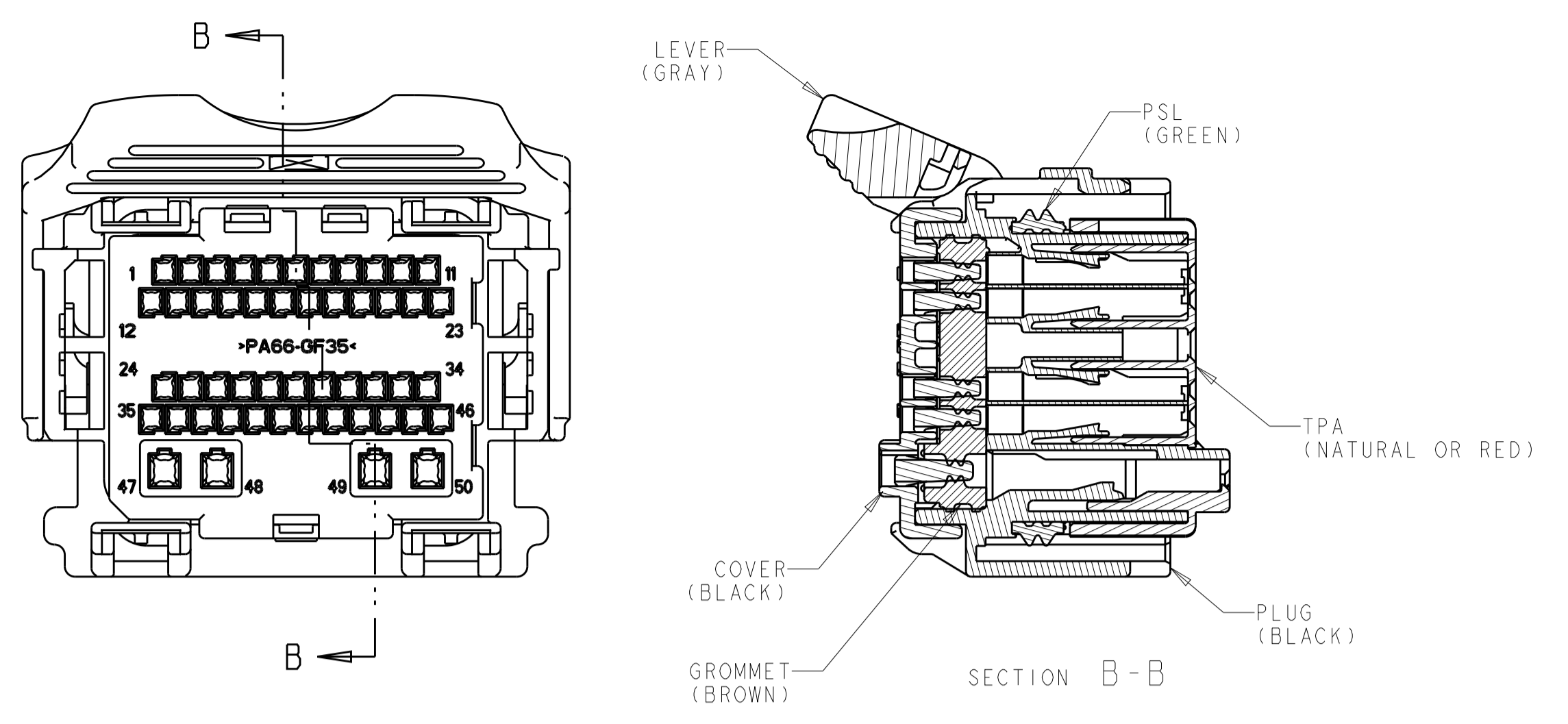

1438129-1
KEYING OPTION "A"

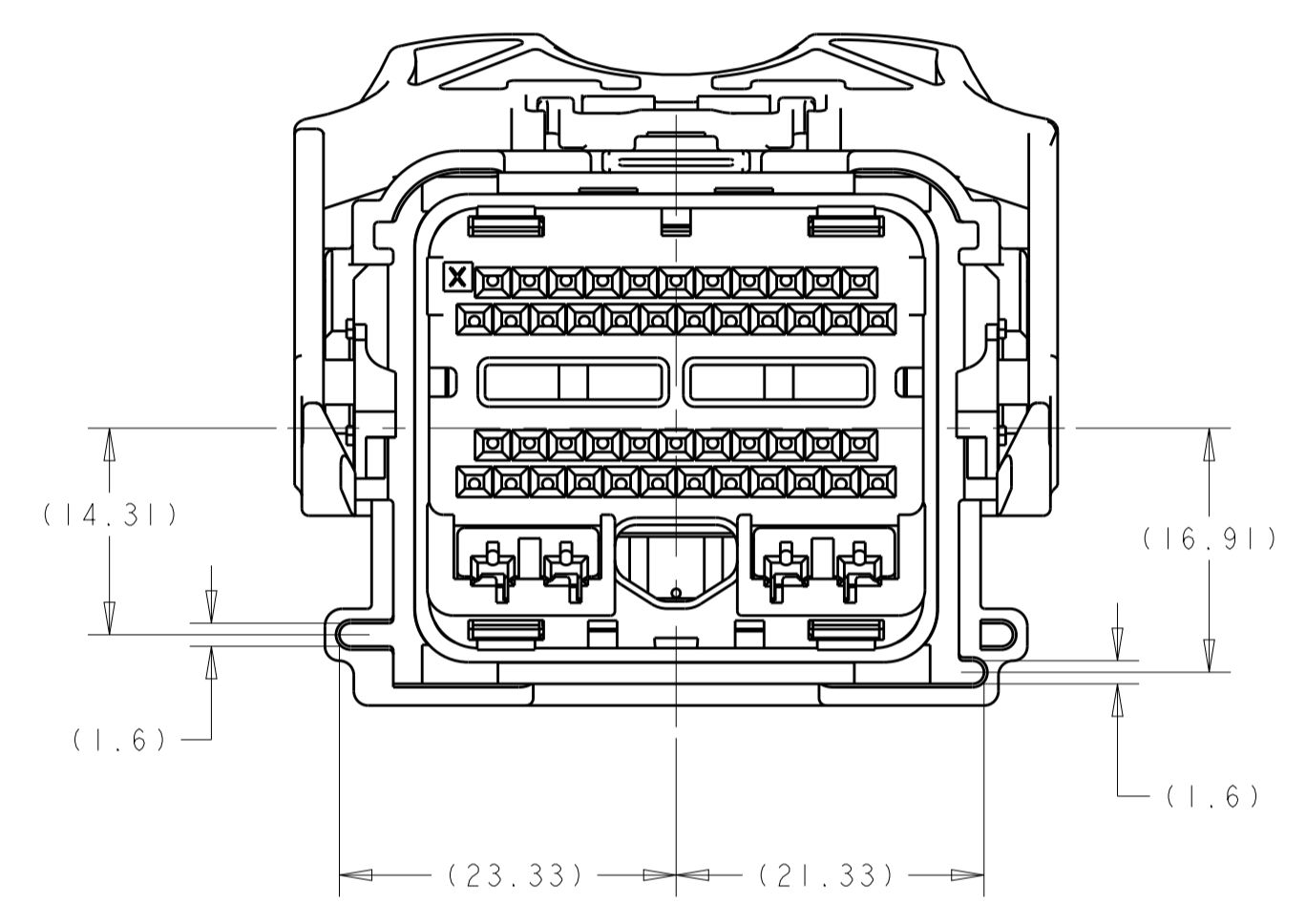

1438129-2
KEYING OPTION "B"

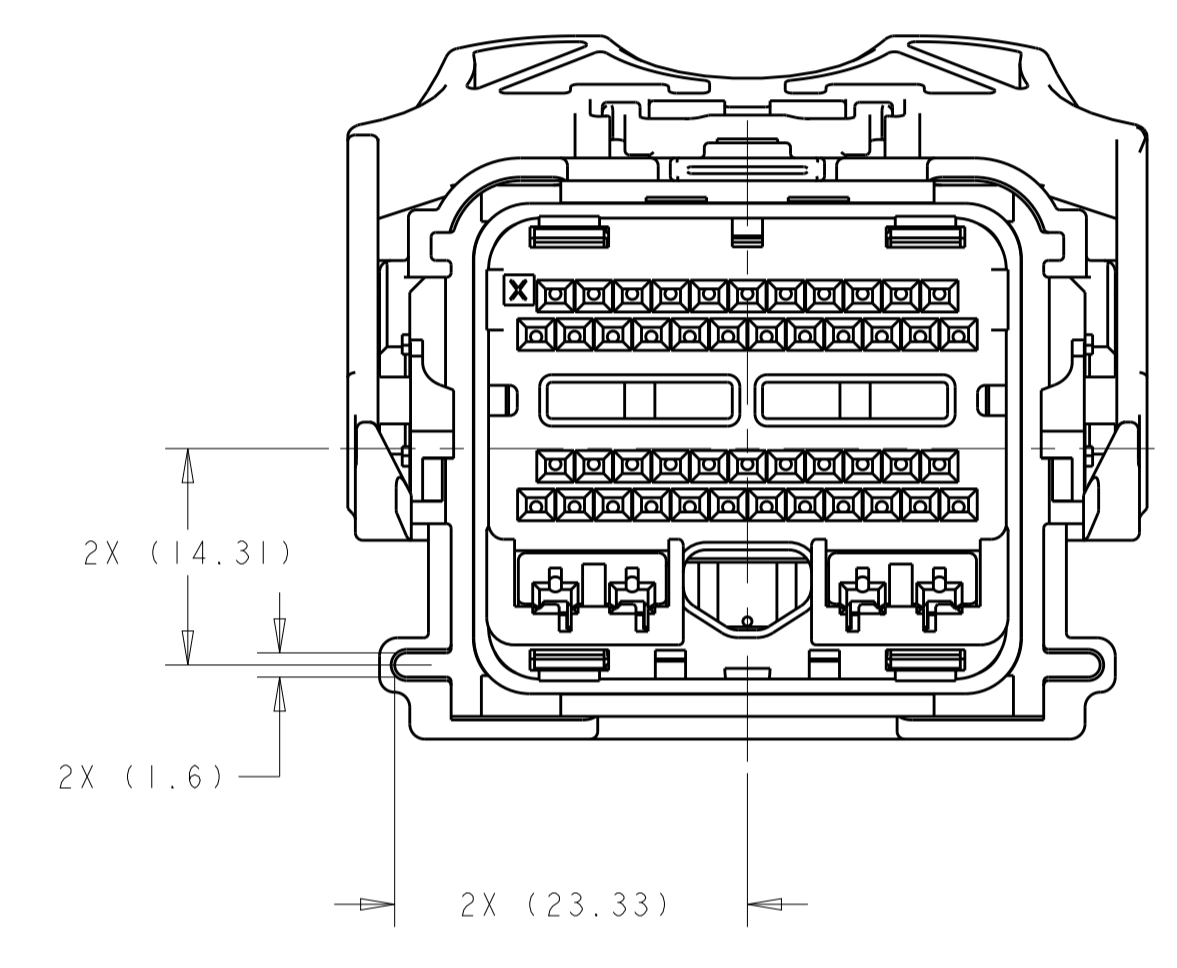

1438129-3
KEYING OPTION "C"

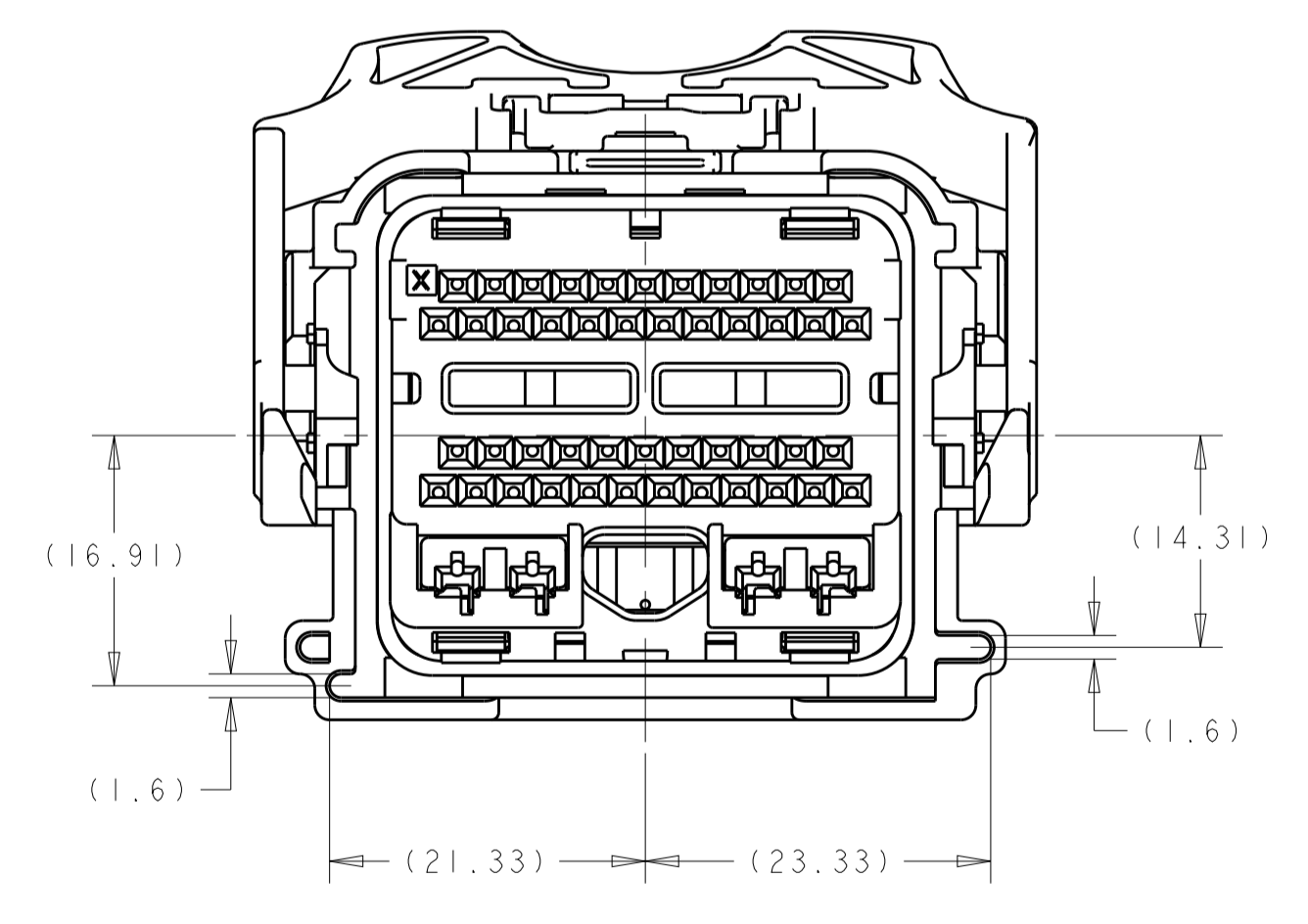

1438129-4
KEYING OPTION "D"

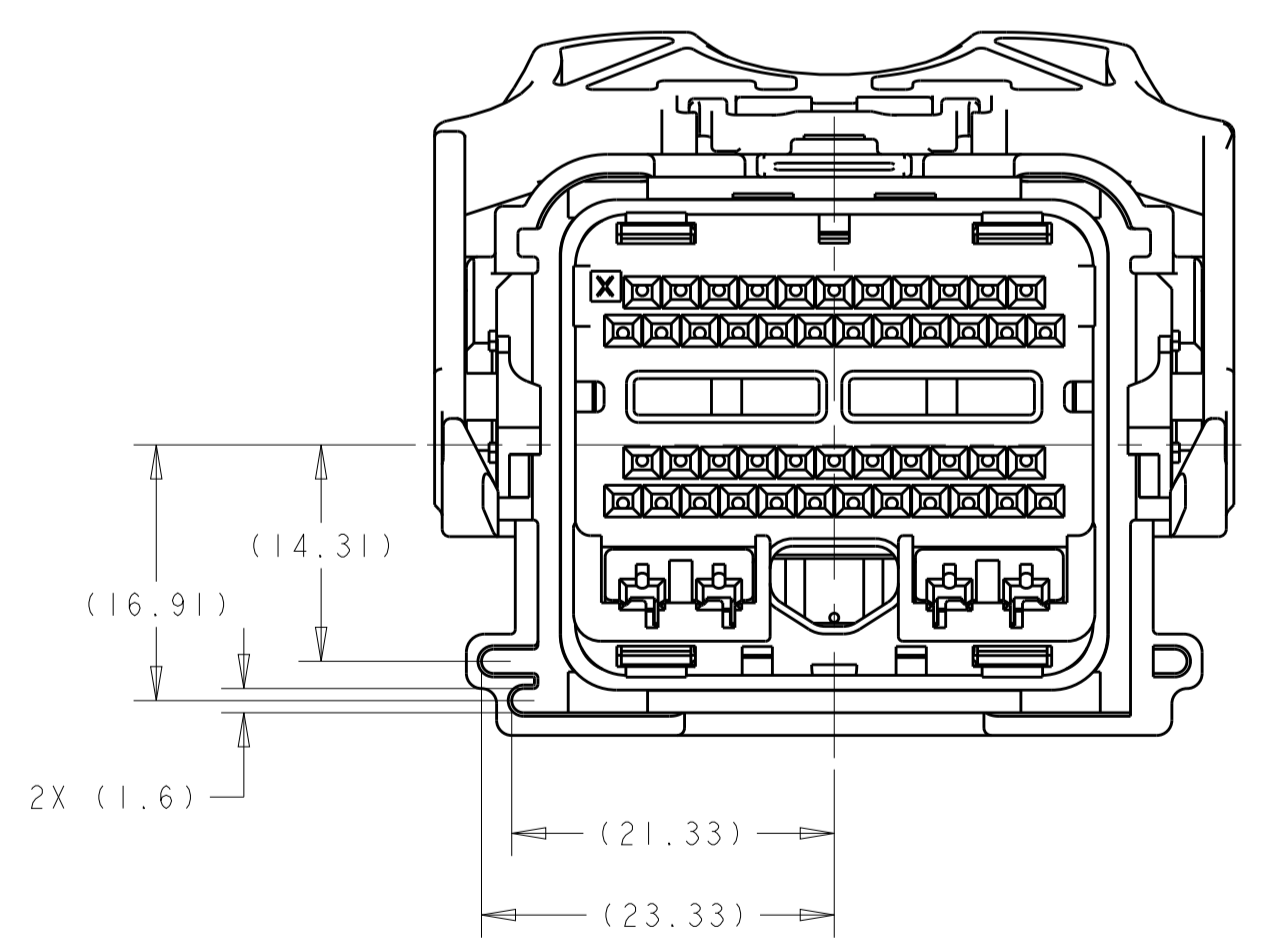

1438129-5
KEYING OPTION "E"

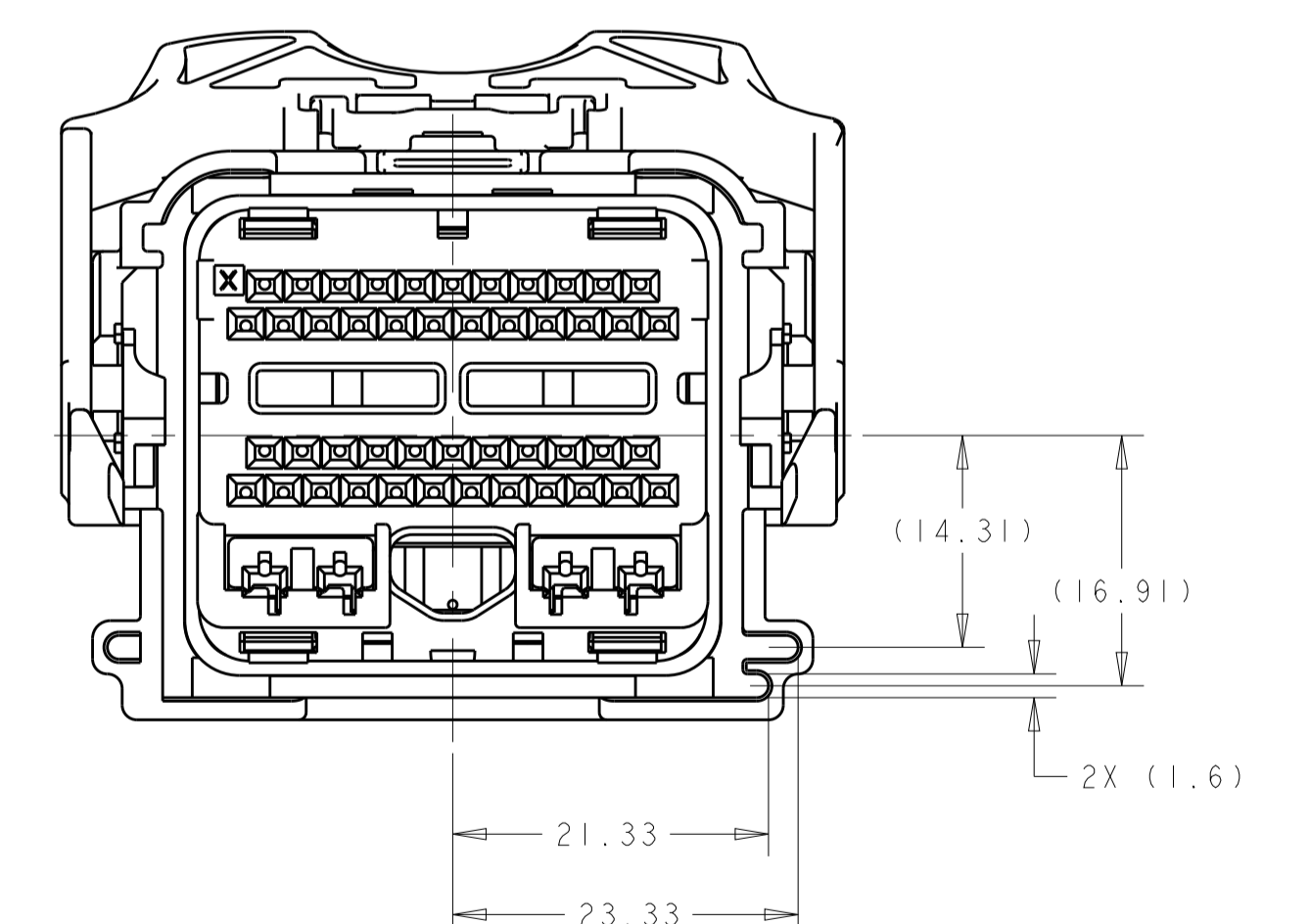

1438129-6
KEYING OPTION "F"

THIS DRAWING IS A CONTROLLED DOCUMENT.		OWN: R. VESTAL 15APR2005	
DIMENSIONS: mm		CHK: T. VALASEK 15APR2005	
TOLERANCES UNLESS OTHERWISE SPECIFIED:		APPD: T. VALASEK 15APR2005	NAME: 50-WAY HARNESS ASSEMBLY, PCM SIZE: CAGE CODE DRAWING NO. RESTRICTED TO A 00779 C=1438129
0 PLC ± 1 PLC ±0.3 2 PLC ±0.10 3 PLC ± 4 PLC ± ANGLES ± FINISH ±		PRODUCT SPEC	
MATERIAL: -		APPLICATION SPEC	SCALE: 2:1 SHEET 2 OF 10 REV: F41
WEIGHT: -		CUSTOMER DRAWING	

REVISIONS				
P.	LTN	DESCRIPTION	DATE	APVD
-	-	SEE SHEET 1	-	-

KEYING OPTION B	46	43	42	41	40	38	37	34	33	32	31	30	29	28	27	26	25	24	20	19	17	16	15	14	13	9	8	7	6	5	4	1	6-1924783-8	5S4T-14A464-MA-094							
	46	43	41	40	39	38	37	34	33	32	31	30	29	28	27	26	25	24	22	20	19	17	16	15	14	9	8	7	5	4	2	1	6-1924783-3	5S4T-14A464-MA-093							
									33	32					27												9				3	1	4-1924783-3	5S4T-14A464-MA-092							
			42	40	39				34	33	32		29		26						20			15	13			9	7		3	2	2-1924783-4	5S4T-14A464-MA-091							
	46	43	42		39				34	33	32		29		26	25		22						15	14			9	7			1	2-1924783-2	5S4T-14A464-MA-090							
			42		39				34	33	31				27	25		22	20														1	1-1924783-9	5S4T-14A464-MA-089						
			42		39				34	33	31					25		22	20														1	1-1924783-8	5S4T-14A464-MA-088						
	46	43	42		39				34	33	32		29		26	25		22						15	14			9	7				1	1-1924783-4	5S4T-14A464-MA-087						
		43			39				34	33	32		29											15	14								1	1-1924783-3	5S4T-14A464-MA-086						
		43	41	40	39	38	37		34	33	31		29								20			15	14	13						3	1	1-1924783-2	5S4T-14A464-MA-085						
		43	42								31		29		27	25		22	20	18	16	15										1	1-1924783-8	5S4T-14A464-MA-084							
		43	42								31		29		27	25		22	20	18	16	15									1	1-1924783-7	5S4T-14A464-MA-083								
		43	42								31		29		27	25		22		18	16	15									1	1-1924783-3	5S4T-14A464-MA-082								
		43	42								31		29		27	25		22		18	16	15									1	1-1924783-2	5S4T-14A464-MA-081								
	46													28	27													9				1	9-1438950-9	5S4T-14A464-MA-080							
			42		39				34	33	32	31				26	25		20														9	9-1438950-6	5S4T-14A464-MA-079						
			42		39				34	33	32	31			27	26	25		20														9	9-1438950-5	5S4T-14A464-MA-078						
		43							34	33	32		29											15	14			9				1	9-1438950-4	5S4T-14A464-MA-077							
	46													28										13			9				1	9-1438950-3	5S4T-14A464-MA-076								
	46	43	42		39	38	37		33	31				27	25		22			18	16										2	8-1438950-9	5S4T-14A464-MA-075								
	46	43			39	38	37		33					27	25		22			18	16										7	8-1438950-8	5S4T-14A464-MA-074								
		45	44		40	39	38	37	36	35	34	33	32	31	30	28	27	26	25	24	23	21	20	19	18	17	16		13	10	9	8	7	6	5	4	3	2	1	8-1438950-7	5S4T-14A464-MA-073
		43		39	38				33		30										20	19		15	14	13						7	7-1438950-6	5S4T-14A464-MA-072							
		43		39					33		30										20	19		15	13							7	7-1438950-5	5S4T-14A464-MA-071							
		43		39					34	33	32										20			15								7	7-1438950-4	5S4T-14A464-MA-070							
		42	41	40	39	38		34	33	32		29		26						20			15	14	13		9	7		3	6	6-1438950-9	5S4T-14A464-MA-069								
	43							34	33	32		29		27	25		22			18	16									1	6-1438950-5	5S4T-14A464-MA-068									
50	46		42					33	31	30	29	28	27		24	22			19	18	17	16	14							6	5	6-1438950-4	5S4T-14A464-MA-067								
	46		42					33	31	30	29	28			24	22			19	18	17	16	14							6	5	6-1438950-3	5S4T-14A464-MA-066								

KEYING OPTION B

CAVITIES WITH A NUMERIC SYMBOL INDICATES CLOSED TERMINAL LOCATIONS

BLANK CAVITIES INDICATES OPEN TERMINAL HOLE LOCATIONS

TERMINAL HOLE POSITION

5S4T-14A464-M* PIN-OUT CHART

ASSEMBLY PART NUMBER

PART NUMBER FOR PRINTING

THIS DRAWING IS A CONTROLLED DOCUMENT.

DIMENSIONS: mm

TOLERANCES UNLESS OTHERWISE SPECIFIED:

0 PLC ±0.3

1 PLC ±0.10

2 PLC ±0.10

3 PLC ±0.10

4 PLC ±0.10

ANGLES ±1°

MATERIAL: -

FINISH: -

WEIGHT: -

CUSTOMER DRAWING

OWN: R. VESTAL 15APR2005

CHK: T. VALASEK 15APR2005

APVD: T. VALASEK 15APR2005

PRODUCT SPEC: -

APPLICATION SPEC: -

WEIGHT: -

CUSTOMER DRAWING

SCALE: 1:1

SHEET: 5 OF 10

REV: F41

NAME: 50-WAY HARNESS ASSEMBLY, PCM

SIZE: A

CAGE CODE: 100779

DRAWING NO: C=1438129

RESTRICTED TO: -

TE Connectivity

REVISIONS				
P.	LTN	DESCRIPTION	DATE	APVD
-		SEE SHEET 1	-	-

KEYING OPTION D																																																				
CAVITIES WITH A NUMERIC SYMBOL INDICATES CLOSED TERMINAL LOCATIONS																																																				
BLANK CAVITIES INDICATES OPEN TERMINAL HOLE LOCATIONS																																																			1438129-4	NUST-14A464-LA-000
TERMINAL HOLE POSITION	50	49	48	47	46	45	44	43	42	41	40	39	38	37	36	35	34	33	32	31	30	29	28	27	26	25	24	23	22	21	20	19	18	17	16	15	14	13	12	11	10	9	8	7	6	5	4	3	2	1	ASSEMBLY PART NUMBER	PART NUMBER FOR PRINTING
5S4T-14A464-P* PIN-OUT CHART																																																				

KEYING OPTION C																																																				
CAVITIES WITH A NUMERIC SYMBOL INDICATES CLOSED TERMINAL LOCATIONS																																																				
BLANK CAVITIES INDICATES OPEN TERMINAL HOLE LOCATIONS																																																				
TERMINAL HOLE POSITION	50	49	48	47	46	45	44	43	42	41	40	39	38	37	36	35	34	33	32	31	30	29	28	27	26	25	24	23	22	21	20	19	18	17	16	15	14	13	12	11	10	9	8	7	6	5	4	3	2	1	ASSEMBLY PART NUMBER	PART NUMBER FOR PRINTING
5S4T-14A464-N* PIN-OUT CHART																																																				

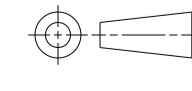
THIS DRAWING IS A CONTROLLED DOCUMENT.		DWN R. VESTAL CHK T. VALASEK APVD T. VALASEK	15APR2005 15APR2005 15APR2005	 TE Connectivity
DIMENSIONS: mm		TOLERANCES UNLESS OTHERWISE SPECIFIED: 0 PLC ±0.3 1 PLC ±0.10 2 PLC ±0.10 3 PLC ±0.10 4 PLC ±0.10 ANGLES ±1°		
		PRODUCT SPEC APPLICATION SPEC WEIGHT CUSTOMER DRAWING		SIZE CAGE CODE DRAWING NO A 100779 C=1438129
MATERIAL		FINISH		RESTRICTED TO SCALE 1:1 SHEET 8 OF 10 REV F 41

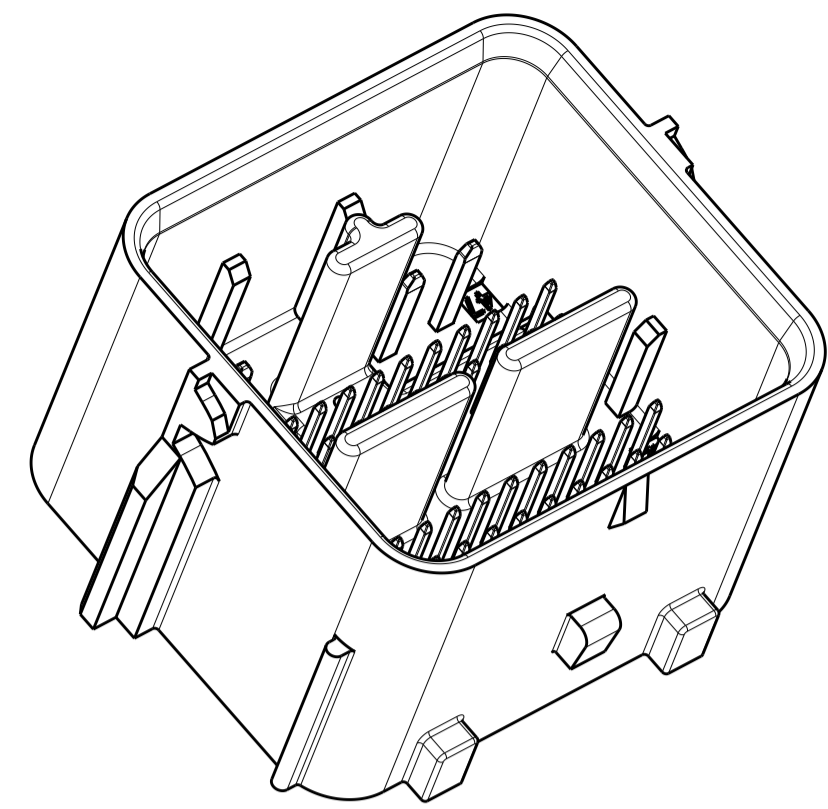

SCALE 2:1

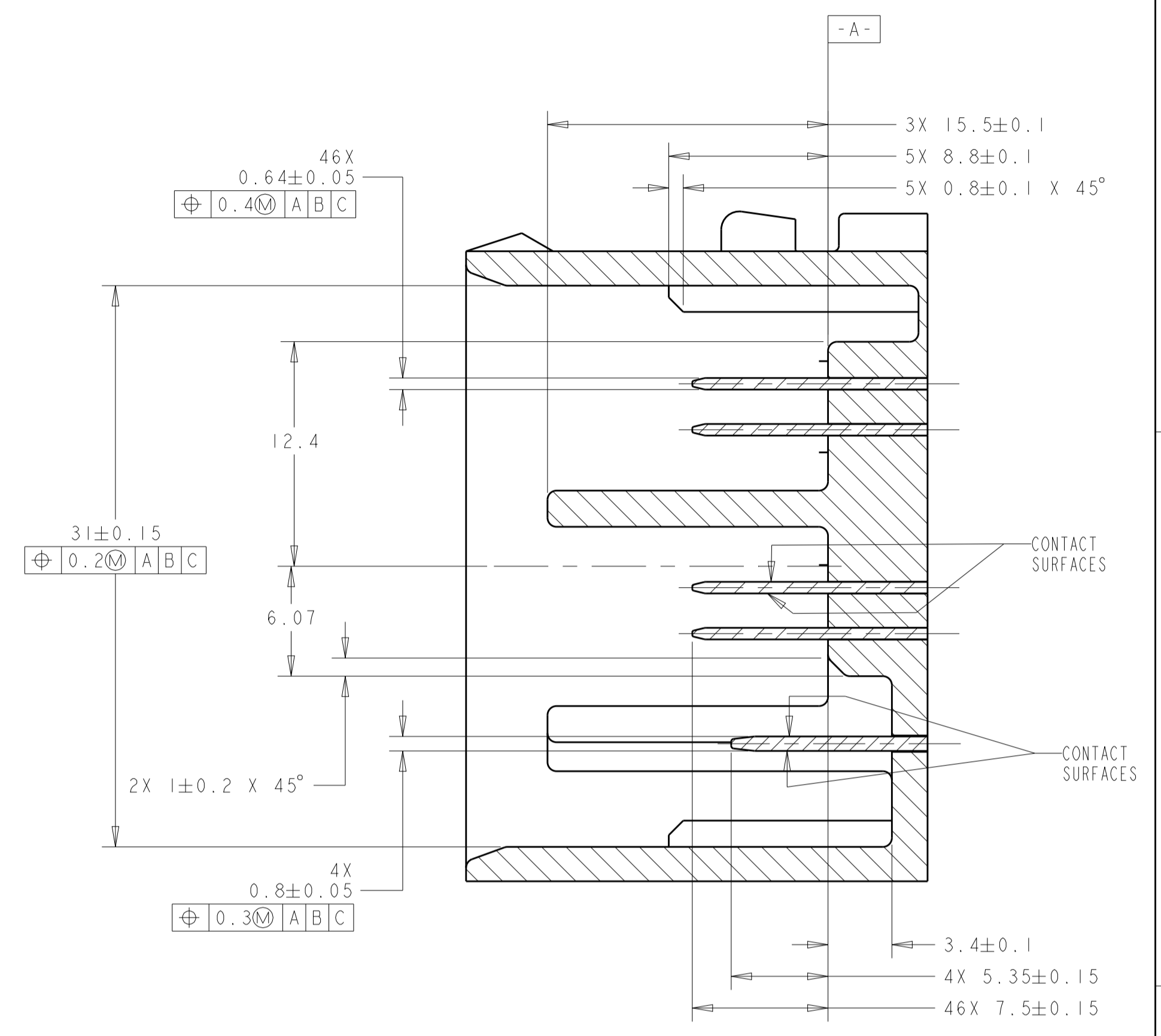
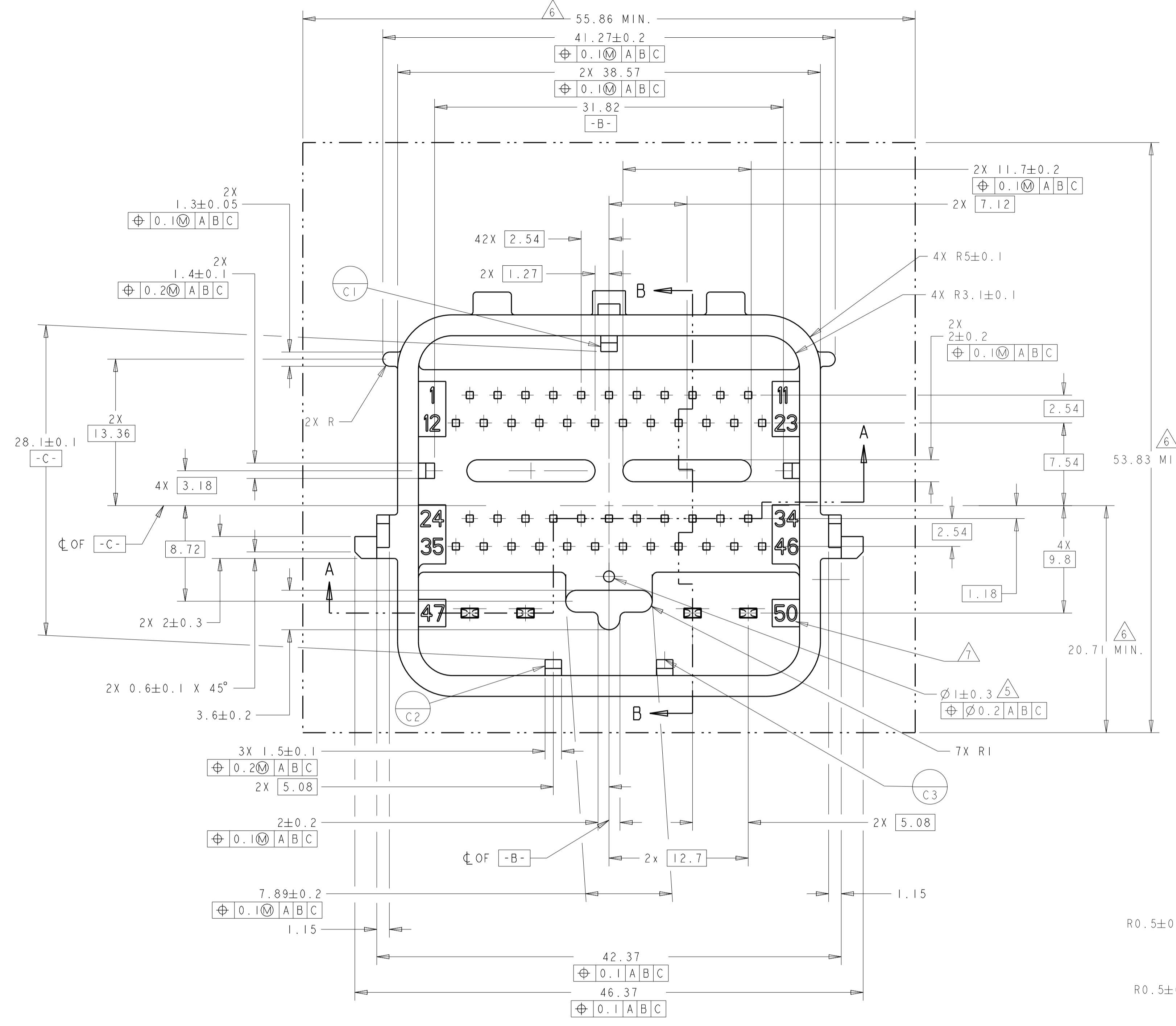

SECTION B-B

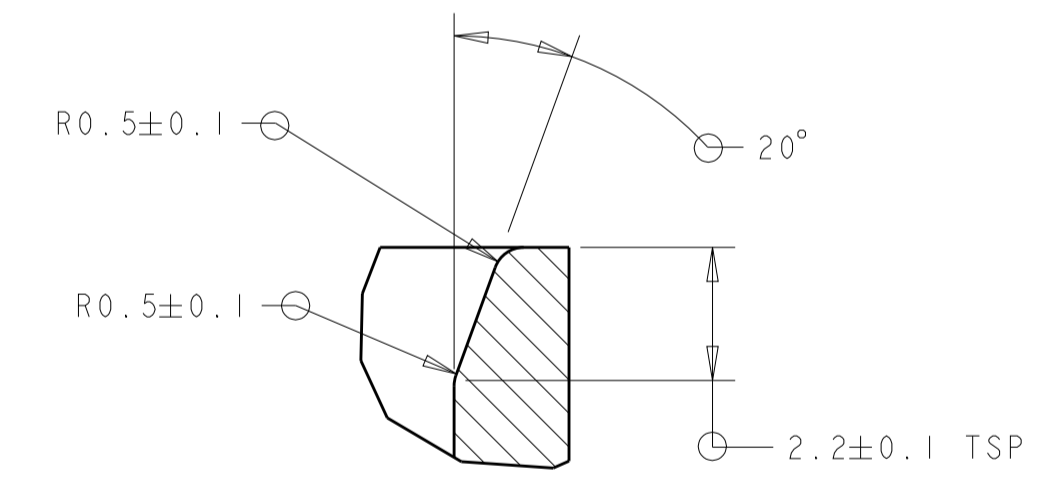

DETAIL E
SCALE 8:1

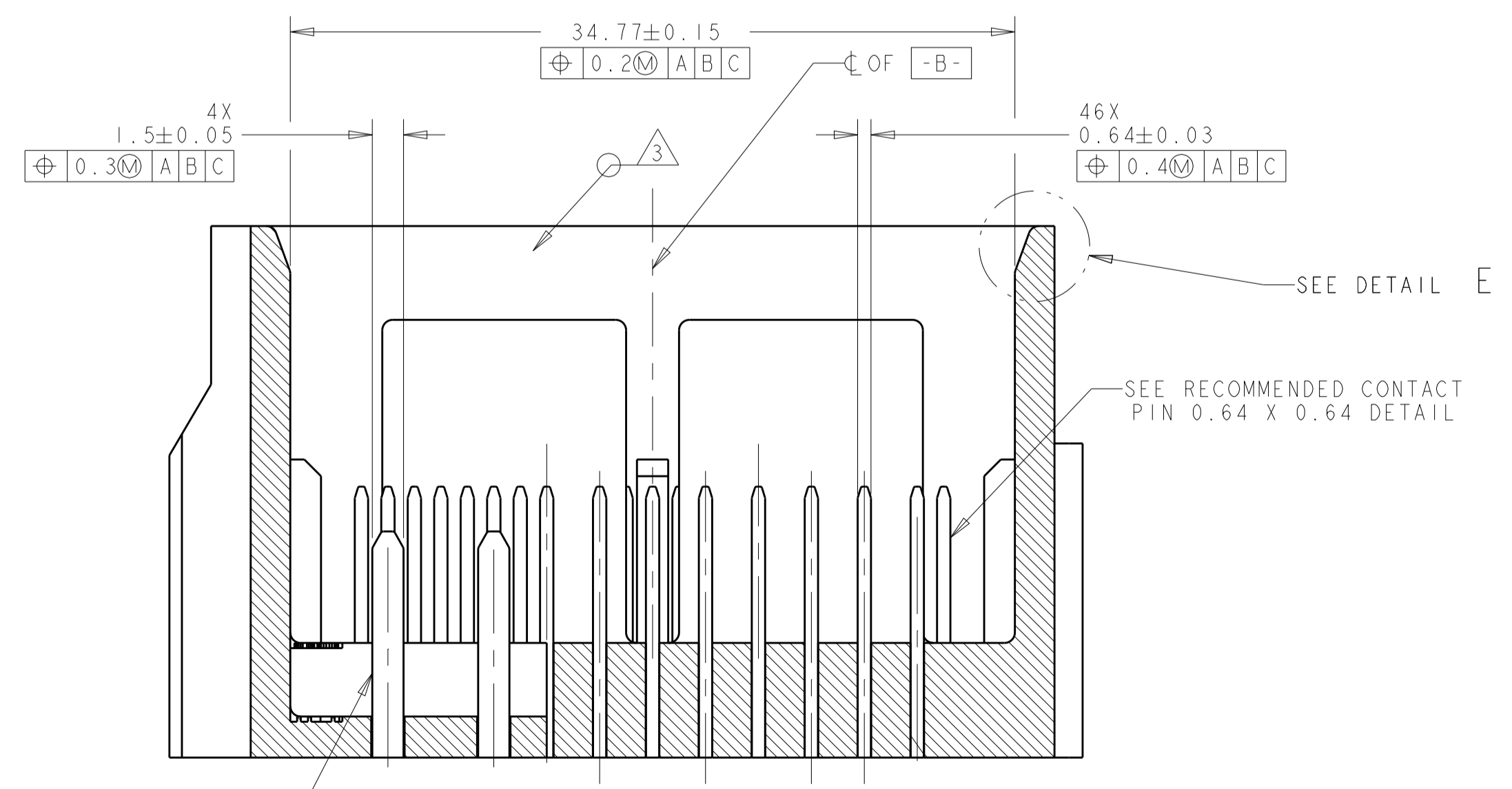

SECTION A-A

SEE RECOMMENDED CONTACT
PIN 0.8 X 1.5 DETAIL

NOTES: UNLESS OTHERWISE SPECIFIED

1. GENERAL TOLERANCE:
±0.3 ALL ONE PLACE DIMENSIONS
±0.10 ALL TWO PLACE DIMENSIONS
±1°00' ALL ANGULAR DIMENSIONS
2. DRAFT ANGLE PERMISSIBLE ONLY WITHIN DRAWING TOLERANCE.
3. SEALING SURFACE, NO WITNESS LINES OR DAMAGE PERMITTED.
4. ALL UNMARKED RADII TO BE 0.5 MAX., UNLESS OTHERWISE SPECIFIED.
5. VENT HOLE SIZE AND LOCATION IS OPTIONAL.
6. THIS AREA TO REMAIN CLEAR FOR THE HARNESS ASSEMBLY.
7. TERMINAL POSITION IDENTIFICATION.
8. MATES WITH TYCO ELECTRONICS PART NUMBERS 1438129-# & 1438950-#

REVISIONS				
P.	LTN.	DESCRIPTION	DATE	APPV.
-	-	SEE SHEET 1	-	-

THIS DRAWING IS A CONTROLLED DOCUMENT.		DWN: R. VESTAL 15APR2005 CHK: T. VALASEK 15APR2005 APVD: T. VALASEK 15APR2005	TE Connectivity
DIMENSIONS: mm	TOLERANCES UNLESS OTHERWISE SPECIFIED: 0 PLC ± 1 PLC ±0.3 2 PLC ±0.10 3 PLC ± 4 PLC ± ANGLES ±1°	NAME: 50-WAY HARNESS ASSEMBLY, PCM PRODUCT SPEC: APPLICATION SPEC: SIZE: CAGE CODE: DRAWING NO: A100779C=1438129	
MATERIAL:	FINISH:	WEIGHT:	RESTRICTED TO: CUSTOMER DRAWING SCALE: 1:1 SHEET 9 OF 10 REV: F41

HEADER INTERFACE KEYING OPTIONS

REVISIONS				
P.	LTN.	DESCRIPTION	DATE	OWN. / APVD.
-	-	SEE SHEET 1	-	-

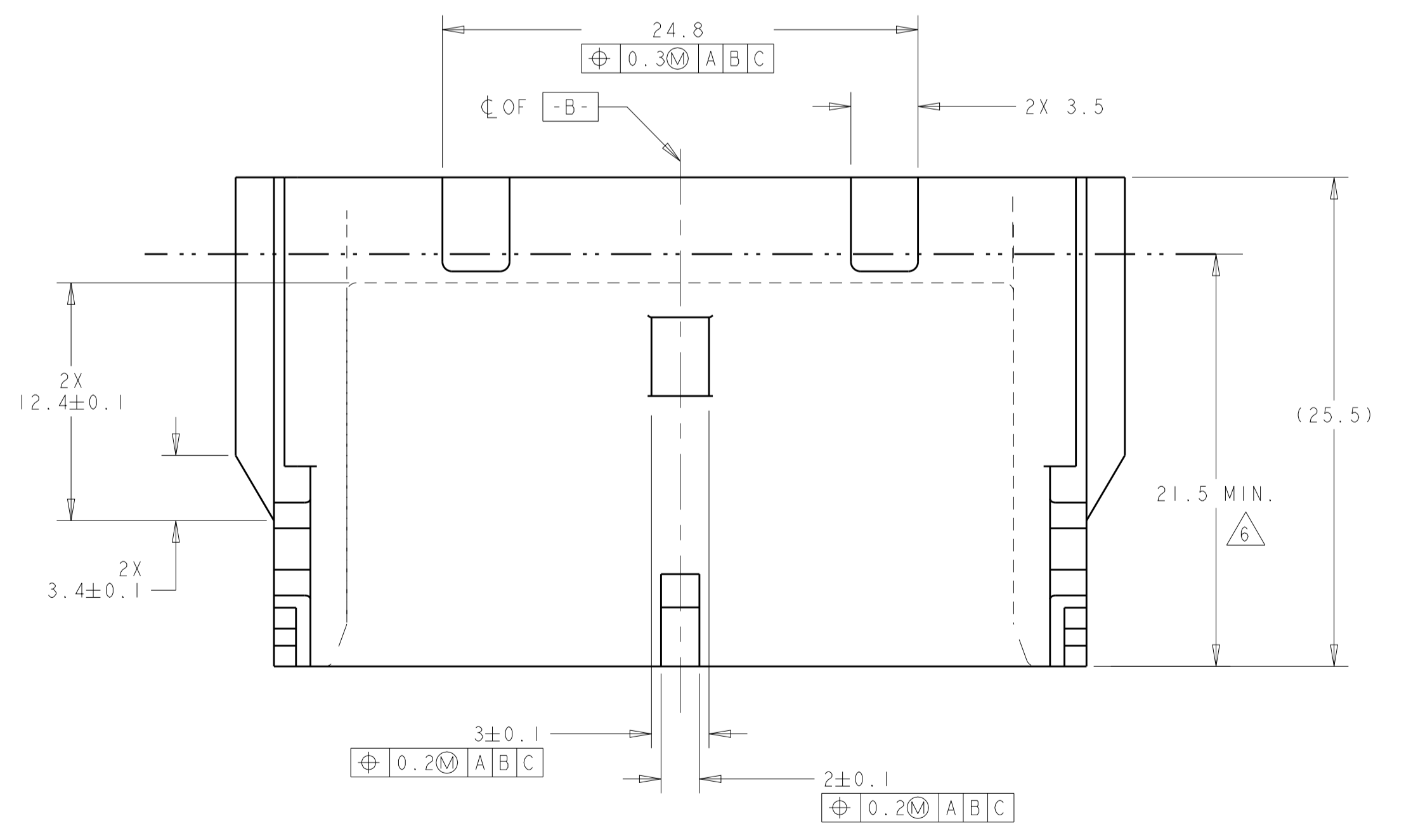
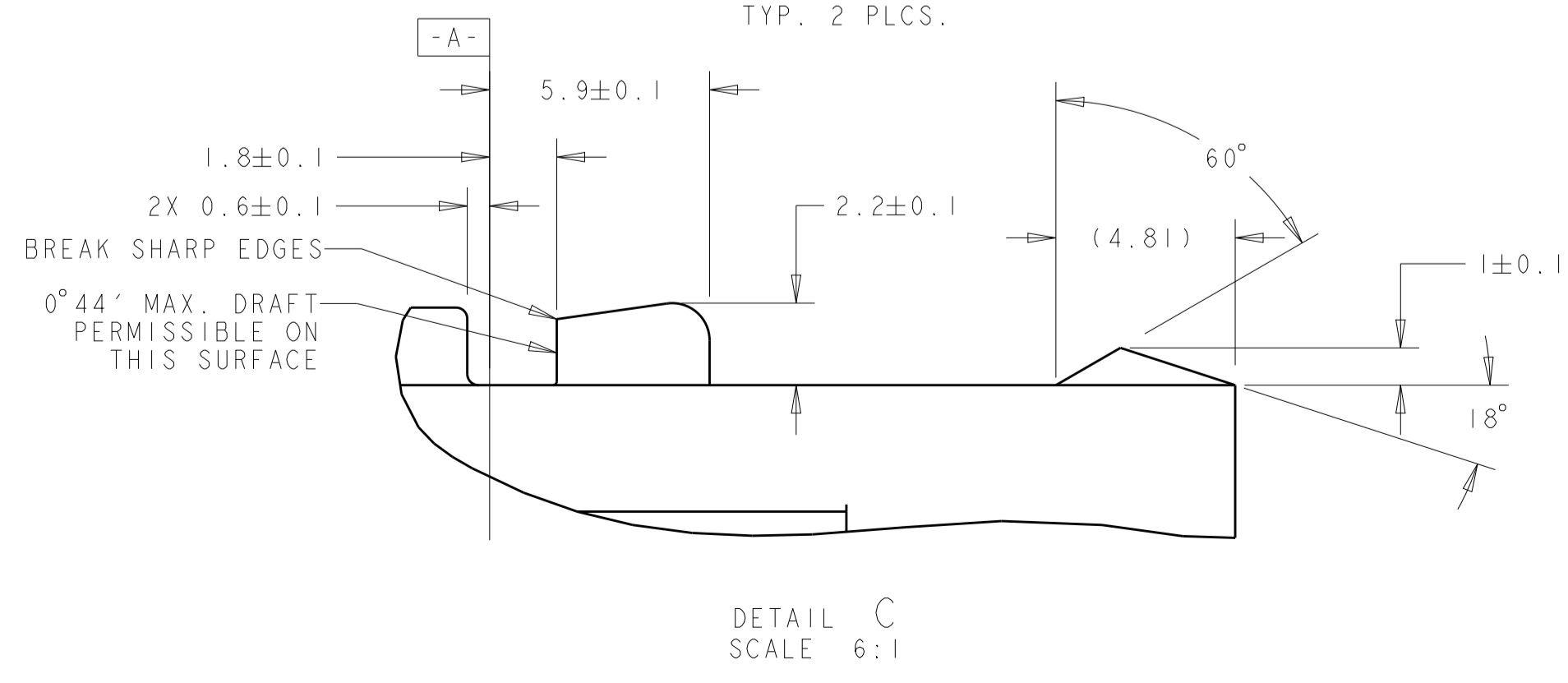
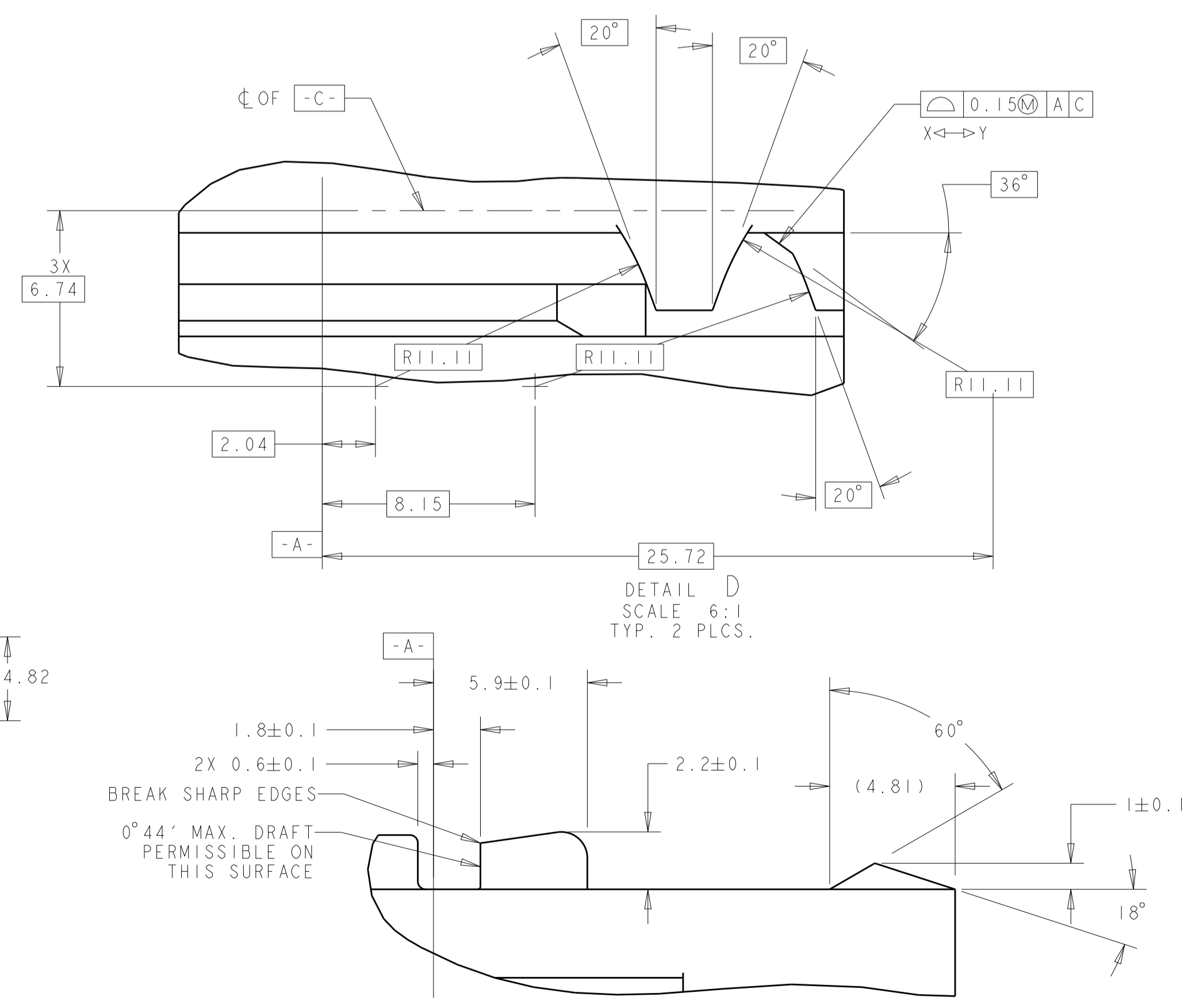
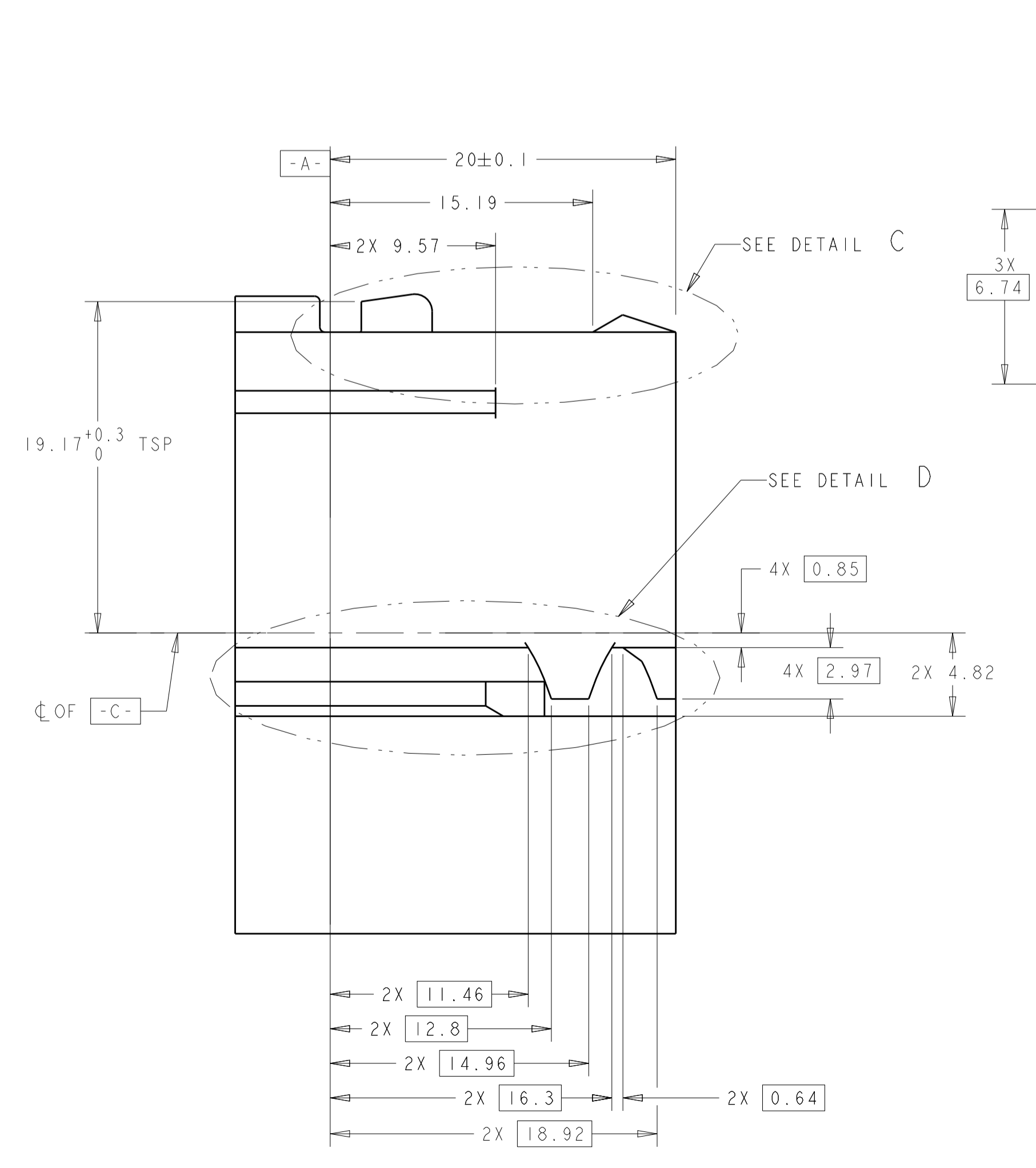
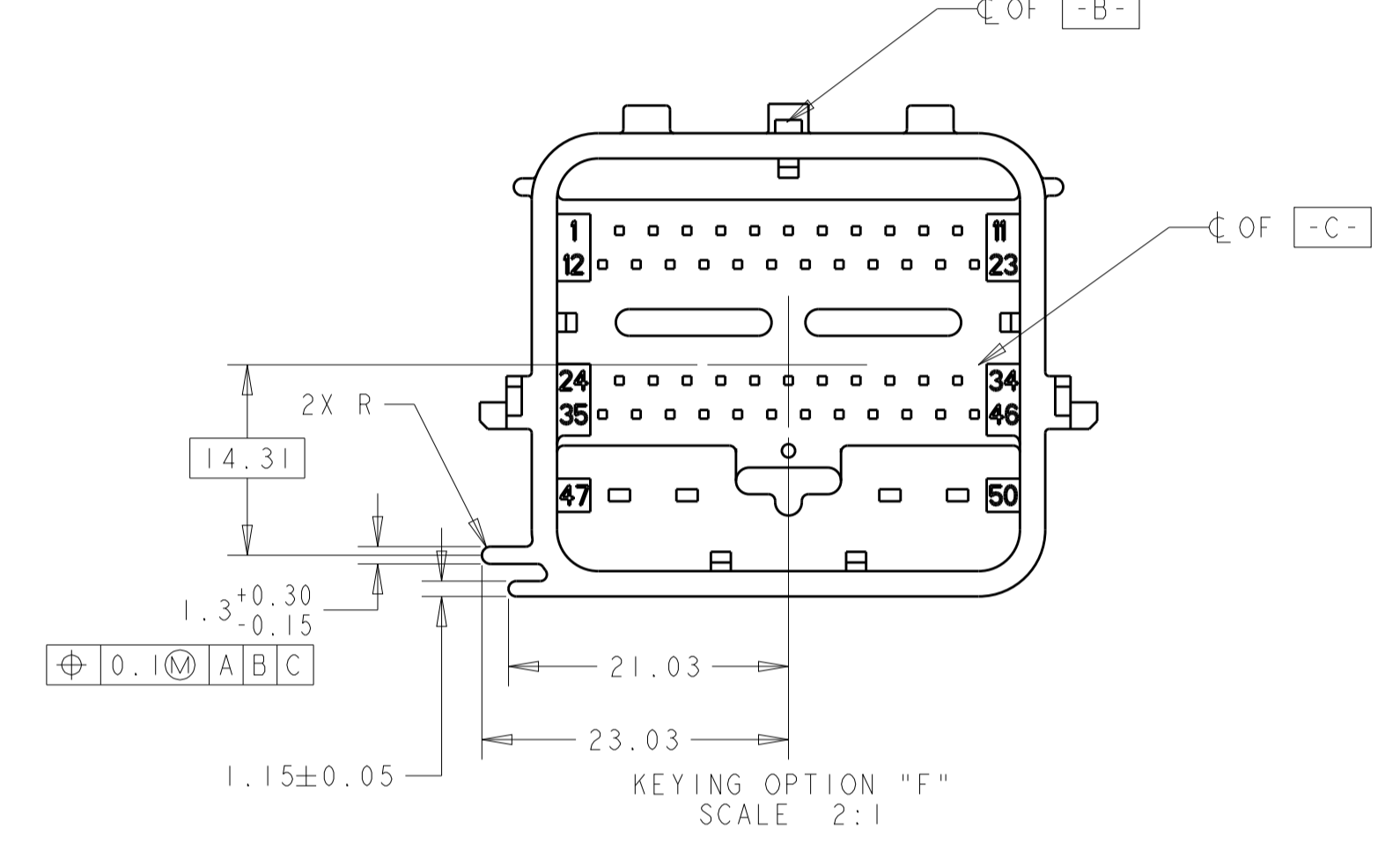
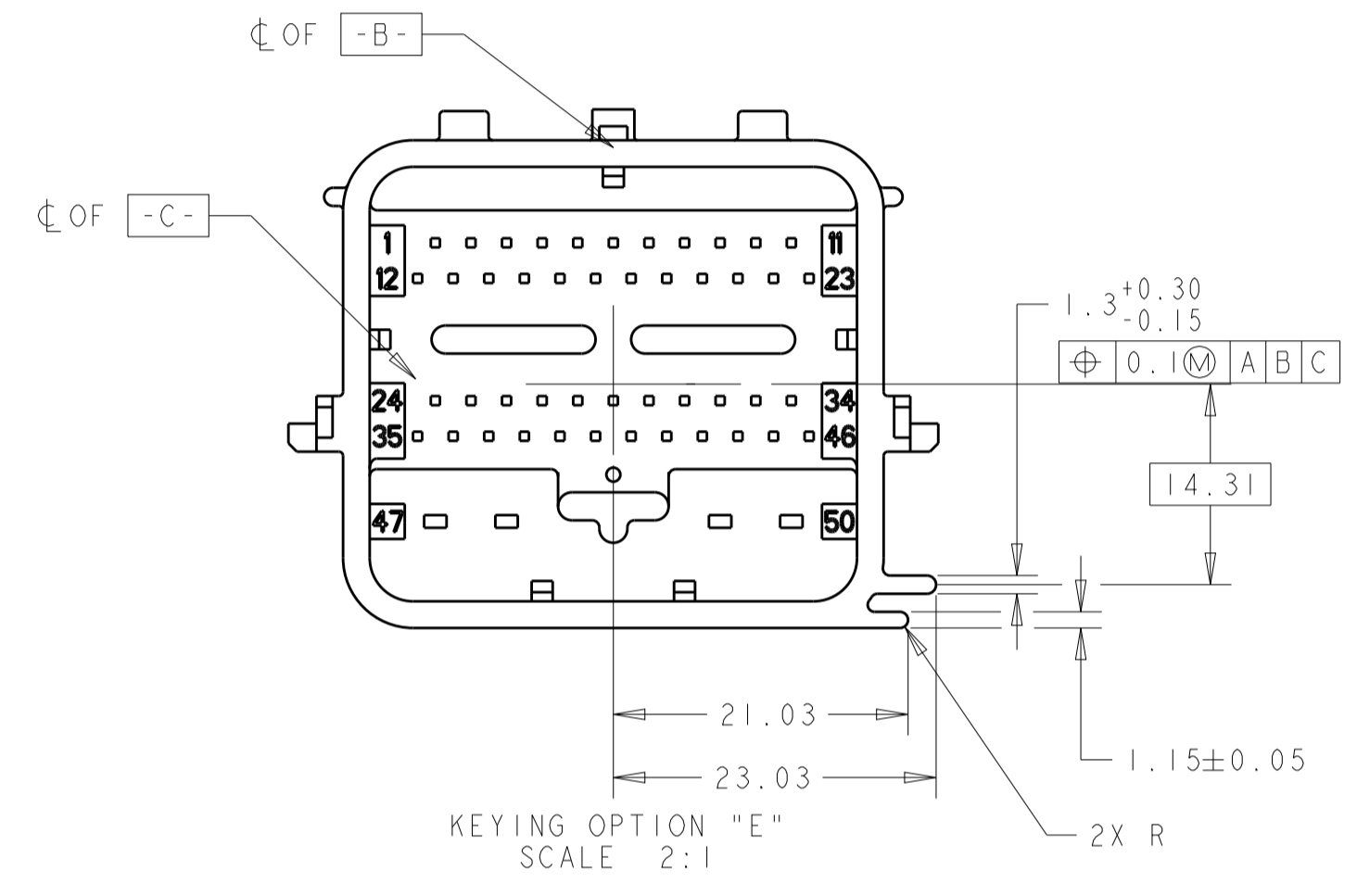
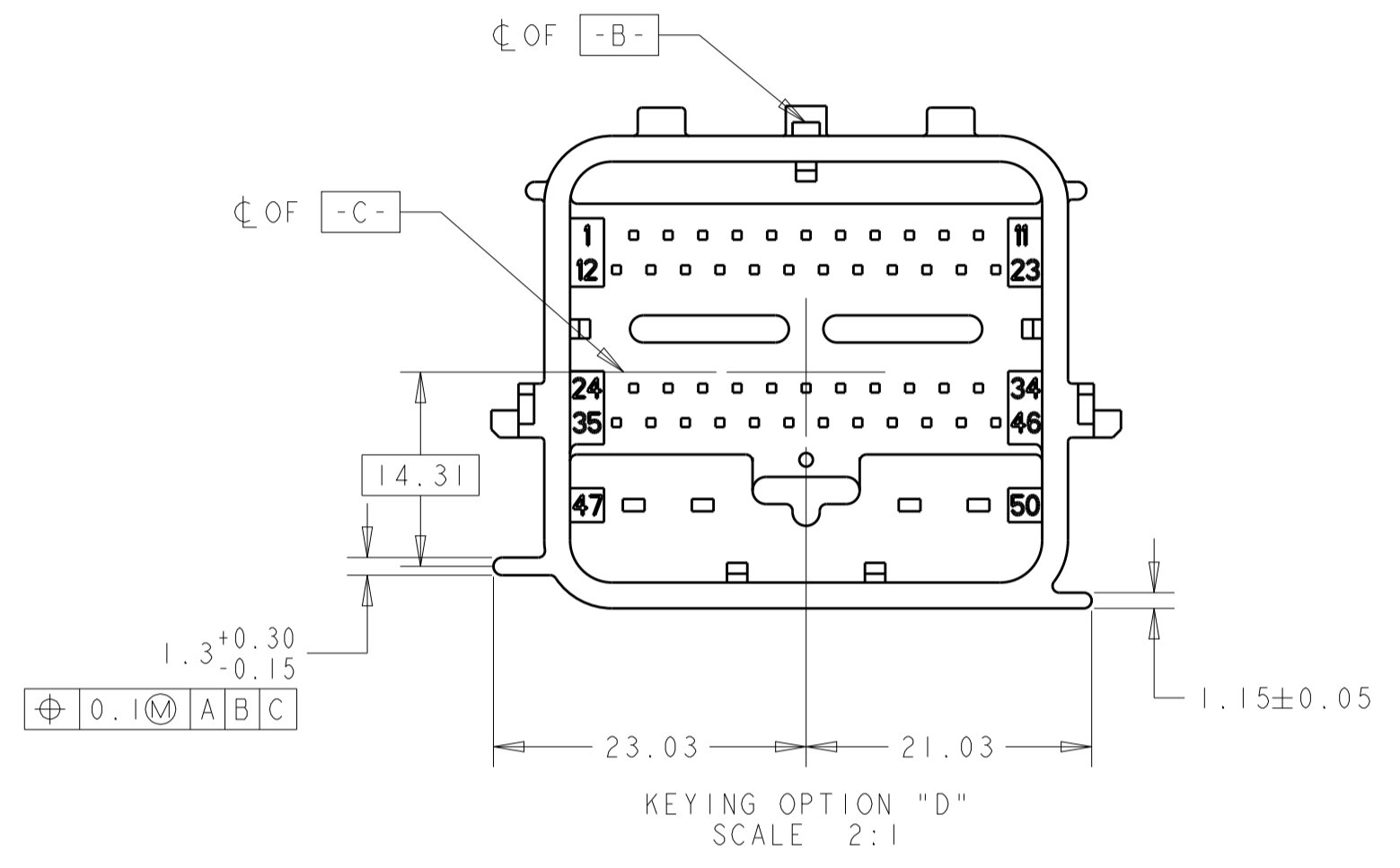
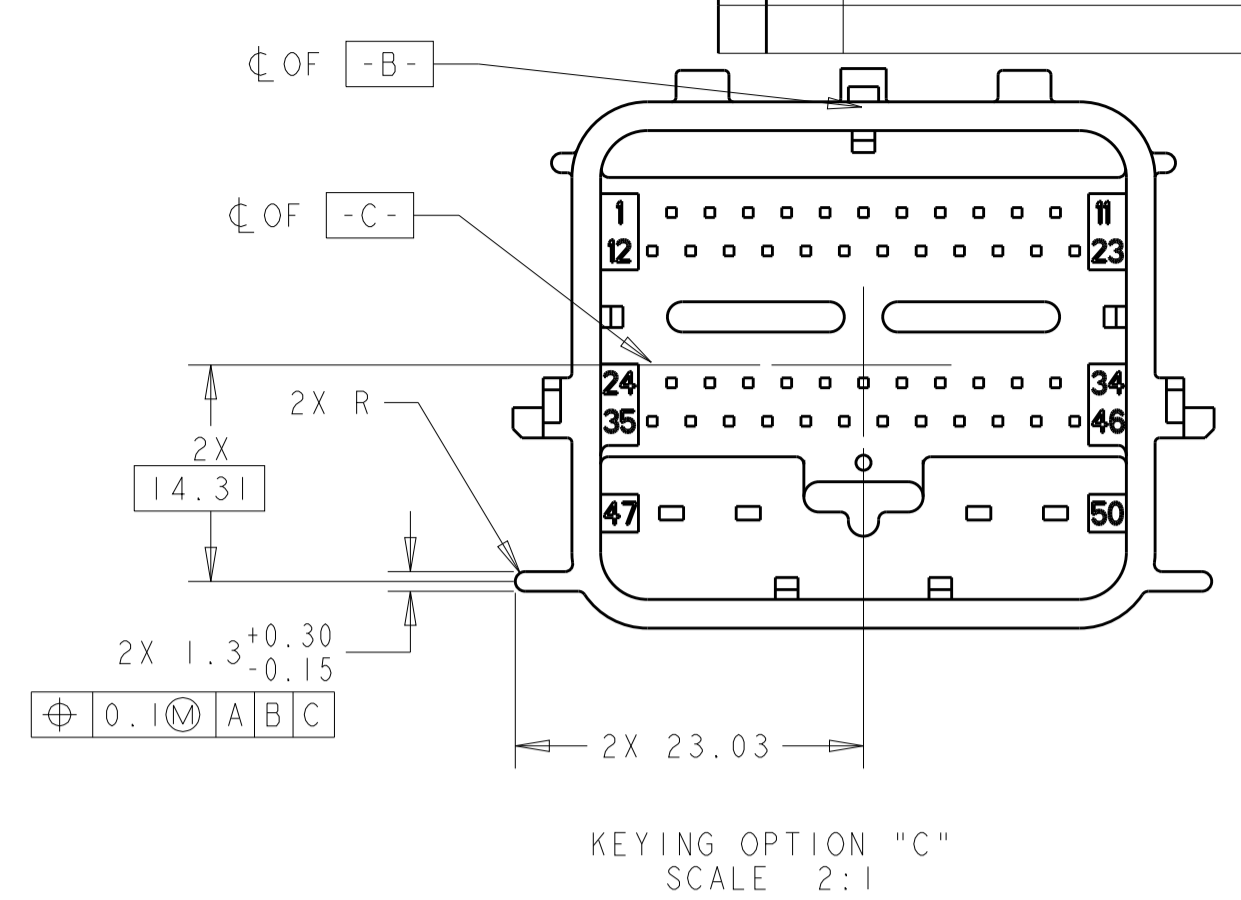
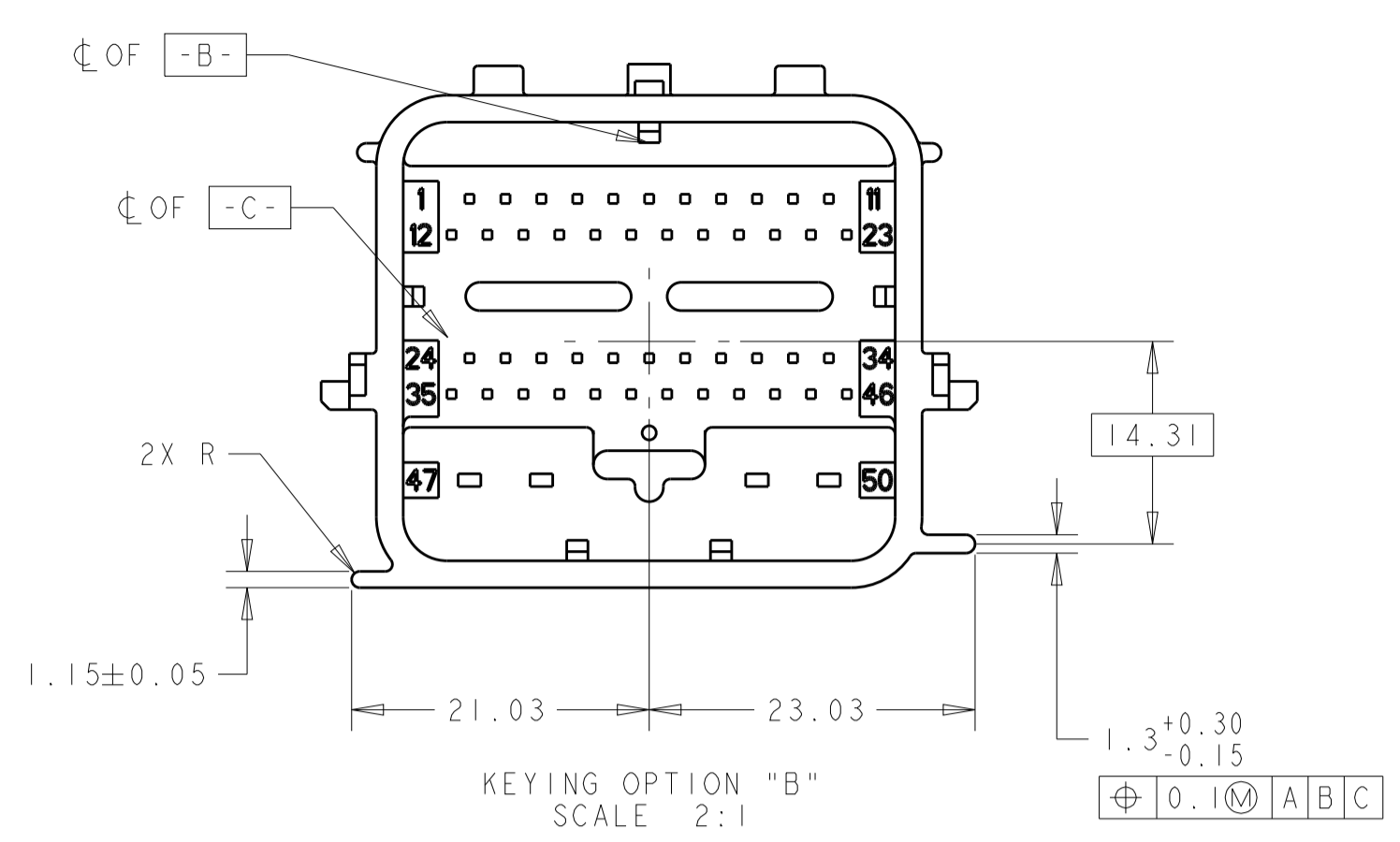
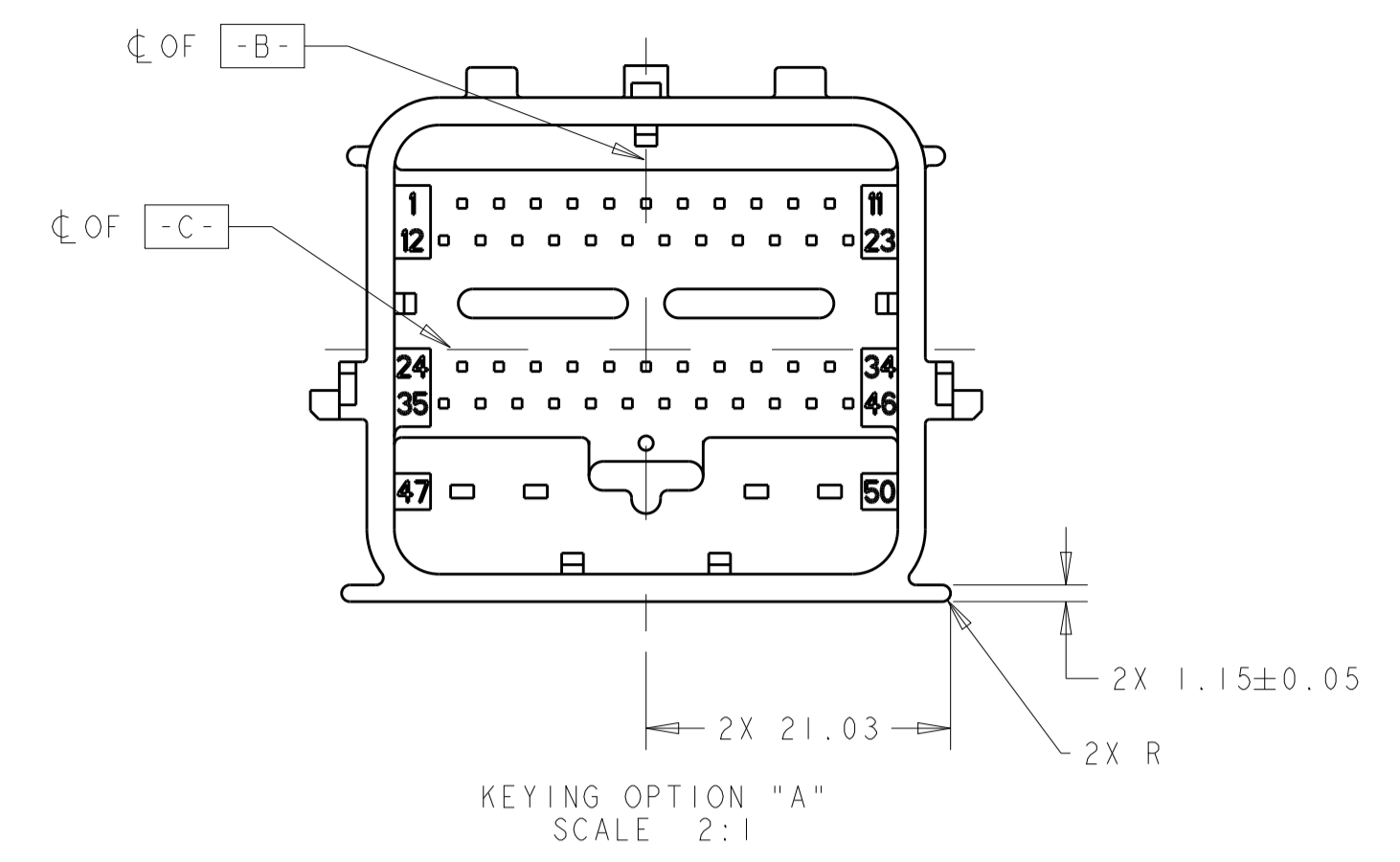

THIS DRAWING IS A CONTROLLED DOCUMENT.		OWN. R. VESTAL 15APR2005	TE Connectivity
DIMENSIONS: mm		CHK. T. VALASEK 15APR2005	
TOLERANCES UNLESS OTHERWISE SPECIFIED:		APVD. T. VALASEK 15APR2005	NAME 50-WAY HARNESS ASSEMBLY, PCM
0 PLC ±	1 PLC ±0.3	PRODUCT SPEC	SIZE CAGE CODE DRAWING NO
2 PLC ±0.10	3 PLC ±	APPLICATION SPEC	RESTRICTED TO
4 PLC ±	ANGLES ±*	WEIGHT	A100779C=1438129
MATERIAL	FINISH	CUSTOMER DRAWING	SCALE 1:1 SHEET 10 OF 10 REV F41

X-ON Electronics

Largest Supplier of Electrical and Electronic Components

Click to view similar products for [Automotive Connectors](#) category:

Click to view products by [TE Connectivity](#) manufacturer:

Other Similar products are found below :

[003-018-000](#) [60403001](#) [60993906-B](#) [M902-2131](#) [M902-2161](#) [72.330.1035.1](#) [73.353.4028.0](#) [F119300-B](#) [F166900](#) [F258300-B](#) [F358300-B](#)
[F407400](#) [F444110](#) [F487000](#) [F509500B-B](#) [827153-1](#) [8N1515-32-24P](#) [9-1326729-8](#) [925474-1](#) [928905-1](#) [964562-4](#) [968782-1](#) [GT17SA-8DS-](#)
[HU](#) [98891-1012](#) [98947-1016](#) [12004147](#) [12004475-L](#) [12010290](#) [12010309-B](#) [12015454](#) [12020219-B](#) [12020308](#) [12041318-B](#) [12052225-L](#)
[12052466](#) [12059125](#) [12064869](#) [12004327-B](#) [12010503-B](#) [12015308](#) [12015384](#) [12015909](#) [1-21030-1](#) [12041254](#) [12041318](#) [12047946-B](#)
[12047957](#) [12047957-L](#) [12059473](#) [12066261](#)