

THIS DRAWING IS UNPUBLISHED. RELEASED FOR PUBLICATION  
 © COPYRIGHT - By - ALL RIGHTS RESERVED.

LOC	DIST	REVISIONS			
P	LTR	DESCRIPTION	DATE	DWN	APVD
E		CHANGE DATE CODE & TE LOGO ECO-08-007869	16-APR-08	CY.Z	BH.Y
F		TE LOGO CHANGE; TERMINALS TOLERANCE CLARIFICATION; ADD LINE IDENTIFIER TO MARKING; PN OBSOLETE. ECO-12-008675	22-AUG-12	K.T	BH.Y

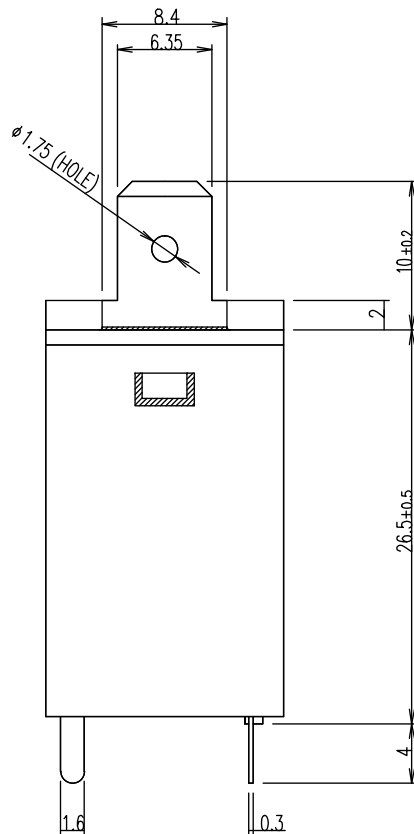

DRILLING DIAGRAM (BOTTOM VIEW)

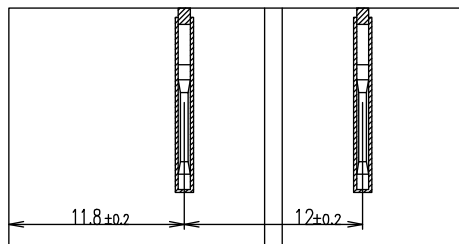
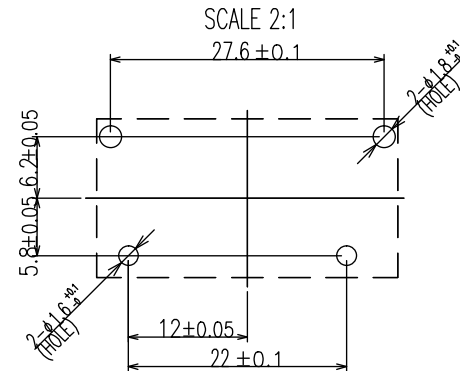

CONNECTION DIAGRAM (BOTTOM VIEW)

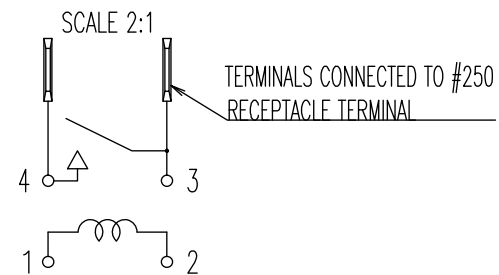
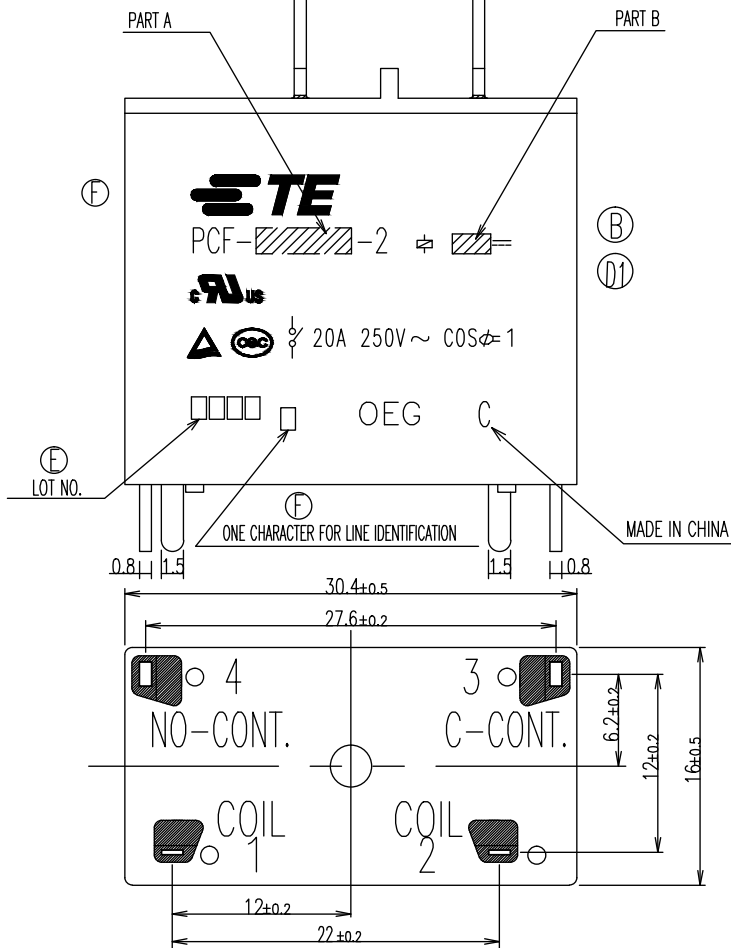
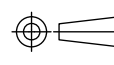

DIAGRAM DIMENSION	TOLERANCE
0.99mm MAX.	±0.1mm
1 - 2.99mm	±0.2mm
3mm MIN.	±0.3mm



THIS DRAWING IS A CONTROLLED DOCUMENT.

DIMENSIONS:  
mm



MATERIAL

TOLERANCES UNLESS OTHERWISE SPECIFIED:

0 PLC	±-
1 PLC	±-
2 PLC	±-
3 PLC	±-
4 PLC	±-
ANGLES	±-
FINISH	-

DWN  
K.OKADO  
CHK  
H.SASAKI  
APVD  
A.NAGAI

PRODUCT SPEC  
APPLICATION SPEC

WEIGHT

CUSTOMER DRAWING

**TE** TE Connectivity

NAME  
PCF-D1M-2(VA TYPE)

SEE PRODUCT SPEC

SIZE	CAGE CODE	DRAWING NO	RESTRICTED TO
A3	00779	C=1461477	-

SCALE	SHEET	REV
3:1	1 OF 2	F

4

3

2

1

THIS DRAWING IS UNPUBLISHED. RELEASED FOR PUBLICATION  
 © COPYRIGHT - By - ALL RIGHTS RESERVED.

LOC	DIST	REVISIONS			
P	LTR	DESCRIPTION	DATE	DWN	APVD
-	-	SEE SHEET 1	-	-	-

Ⓕ	OBSOLETE	1461477-8	PCF-112D1M-2,400	108-79550	107-79012	12	112D1M	h	Ⓐ
	ACTIVE	1461477-7	PCF-112D1M-2,000B	108-79550	107-79040	12	112D1M	g	Ⓐ
Ⓕ	OBSOLETE	1461477-6	PCF-148D1M-2,000	108-79552	107-79012	48	148D1M	f	
Ⓕ	OBSOLETE	1461477-5	PCF-124D1M-2,000	108-79551		24	124D1M	e	
	ACTIVE	1461477-4	PCF-112D1M-2,000	108-79550		12	112D1M	d	
Ⓕ	OBSOLETE	1461477-3	PCF-109D1M-2,000	108-79549		9	109D1M	c	
Ⓕ	OBSOLETE	1461477-2	PCF-106D1M-2,000	108-79548		6	106D1M	b	
Ⓕ	OBSOLETE	1461477-1	PCF-105D1M-2,000	108-79547		5	105D1M	a	
	PN STATUS	TE PART NO	DESCRIPTION	PRODUCT SPEC	PACKING SPEC	PART B	PART A	TYPE	

RELAY TYPE

NOTES:  
 Ⓕ 1. LOT NO. SYSTEM AS FOLLOWING:

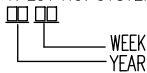

- Ⓕ 2. ONE CHARACTER DISTINGUISH THE LINE IDENTITY, SUCH AS: A, B..
- Ⓕ 3. TERMINAL DIMENSION IS BEFORE SOLDER DIP.
- Ⓕ 4. FOR THE TIN-PLATING OF THE PINS:  
 +0.1mm FOR WIDTH, THICKNESS AND DIAMETER.  
 +0.5mm FOR LENGTH.

P.B.T	CASE	ITEM
3JEW	MAGNETIC WIRE	16
EPOXY RESIN	SEAL	15
Cu ALLOY	HINGE SPRING	14
Cu ALLOY	COIL TERMINAL L	13
Cu ALLOY	COIL TERMINAL R	12
Ag ALLOY	C CONTACT	11
Ag ALLOY	M CONTACT	10
Cu ALLOY	C SPRING	9
Cu ALLOY	C TERMINAL (PLATED TYPE)	8
Cu ALLOY	C TERMINAL	
Cu ALLOY	M TERMINAL (PLATED TYPE)	7
Cu ALLOY	M TERMINAL	
P.P.S	CARD	6
P.B.T	BOBBIN	5
P.B.T	BASE	4
STEEL	CORE	3
STEEL	ARMATURE	2
STEEL	YOKE	1
MATERIAL	DESCRIPTION	ITEM

THIS DRAWING IS A CONTROLLED DOCUMENT.		DWN K.OKADO	TE Connectivity NAME PCF-D1M-2(VA TYPE)				
DIMENSIONS: mm		CHK H.SASAKI				APVD A.NAGAI	PRODUCT SPEC SEE PRODUCT SPEC
		TOLERANCES UNLESS OTHERWISE SPECIFIED:				APPLICATION SPEC -	
MATERIAL -		FINISH -				WEIGHT -	
		SIZE A3	CAGE CODE 00779	DRAWING NO C=1461477	RESTRICTED TO -		
CUSTOMER DRAWING			SCALE 3:1	SHEET 2 OF 2	REV F		

## X-ON Electronics

Largest Supplier of Electrical and Electronic Components

*Click to view similar products for [General Purpose Relays](#) category:*

*Click to view products by [TE Connectivity](#) manufacturer:*

Other Similar products are found below :

[PCN-105D3MH,000](#) [59641F200](#) [5JO-1000CD-SIL](#) [5X827E](#) [5X837F](#) [5X840F](#) [5X842F](#) [5X848E](#) [LY2N-AC120](#) [LY2S-AC220/240](#) [LY2-US-AC120](#) [LY2-US-DC24](#) [LY3-US-AC120](#) [LY4F-UA-DC12](#) [LY4F-UA-DC24](#) [LY4F-US-AC120](#) [LY4F-US-AC240](#) [LY4F-US-DC24](#) [LY4F-VD-AC110](#) [LYQ20DC12](#) [M115C60](#) [M115N010](#) [M115N0150](#) [603-12D](#) [60HE1-5DC](#) [60HE2S-12DC](#) [61211T0B4](#) [61212T400](#) [61222Q400](#) [61243B600](#) [61243C500](#) [61243Q400](#) [61311BOA2](#) [61311BOA6](#) [61311BOA8](#) [61311C0A2](#) [61311COA1](#) [61311COA6](#) [61311F0A2](#) [61311QOA1](#) [61311QOA4](#) [61311T0D6](#) [61311TOA6](#) [61311TOA7](#) [61311TOB3](#) [61311TOB4](#) [61311U0A6](#) [61312Q600](#) [61312T400](#) [61312T600](#)