

PART NUMBER	REV	FIRST USED	SIZE	A	B	C	D	E	F	G	H	J	K	R1	R2	R3
1490356-1	□	1490406-1	2	.625	0.156	.225	1.025	1.25	.180	.518	.625	.125	.08	.474	.03	-
1490356-2	□	1490406-1	2	.625	0.156	.225	1.025	1.25	.180	.389	.496	.125	.08	.474	.03	-
1490356-3	□	1490406-1	2	.625	6-32 UNC-2B	.225	1.025	1.25	.180	.518	.690	.075	.08	.474	.062	-
1490356-4	□	1490406-1	2	.625	6-32 UNC-2B	.225	1.025	1.25	.180	.389	.526	.073	.08	.474	.062	-
1490356-5	□	1490599-1	4	.563	0.156	.163	.963	1.125	.180	.456	.550	.125	.08	.398	.03	-
1490356-6	□	1490598-1	6	.563	0.156	.163	.963	1.125	.180	.431	.528	.093	.08	.326	.03	-
1490356-7	□	1490597-1	8	.563	0.156	.163	.963	1.125	.180	.418	.505	.093	.08	.288	.03	-
1490356-8	□	1490700-1	1/0	.750	0.187	.437	1.063	1.500	.266	.684	.855	.156	.25	.580	.03	.031
1490356-9	□	1490700-1	1/0	.750	0.187	.437	1.063	1.500	.266	.850	1.021	.156	.25	.580	.03	.031
1-1490356-0	□	1490700-1	1/0	.750	8-32 UNC-2B	.437	1.063	1.500	.266	.675	.855	.112	.25	.580	.062	-
1-1490356-1	□	1490700-1	1/0	.750	8-32 UNC-2B	.437	1.063	1.500	.266	.841	1.021	.110	.25	.580	.062	-

USED ON

NOTES:

- IDENTIFY PART PER 115-67-2 IN APPROXIMATE AREA SHOWN.
- TAPPED HOLES PER 106-4007.
- ALL RADII TO BE BLEND RADII UNLESS OTHERWISE SPECIFIED.
- ALT. MATL.: 100-71 ALLOY STEEL  
H.T.: 111-71-6, RC 45-50  
ALT. MATL.: 100-3 TOOL STEEL  
H.T.: 111-3-6, RC 50-55  
ALT. MATL.: 100-52 ALLOY STEEL  
H.T.: 111-52-6, RC 45-50

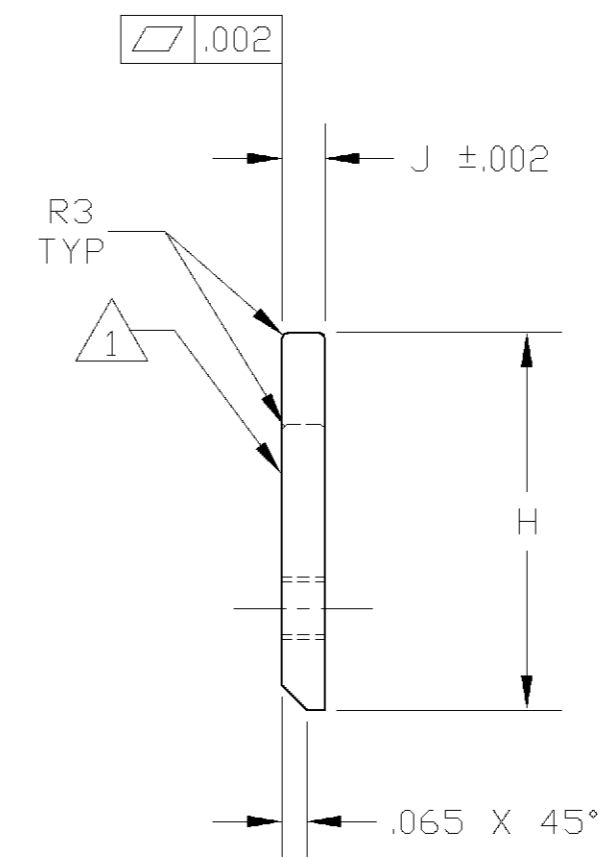
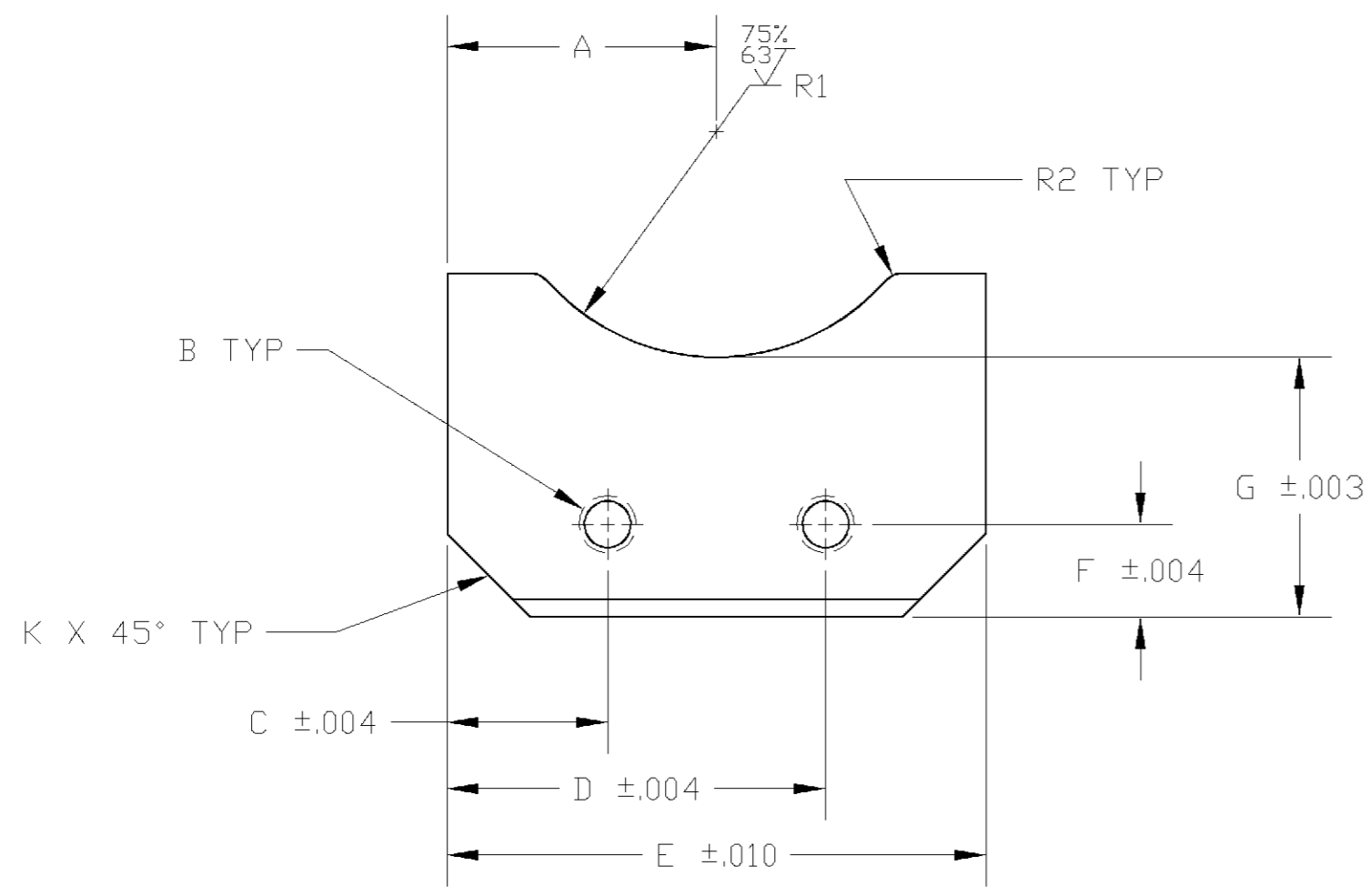

THIS INFORMATION IS CONFIDENTIAL AND PROPRIETARY TO TYCO ELECTRONICS CORPORATION AND ITS WORLDWIDE SUBSIDIARIES AND AFFILIATES. IT MAY NOT BE DISCLOSED TO ANYONE, OTHER THAN TYCO ELECTRONICS PERSONNEL, WITHOUT WRITTEN AUTHORIZATION FROM TYCO ELECTRONICS CORPORATION, HARRISBURG, PENNSYLVANIA USA.

LOC  
A  
DIST  
40

P	LTR	REVISION RECORD	DATE	DWN	APVD

FINISH 112-157-1 BLACKEN		DWN EMP 28DEC00	MATERIAL 100-41 CARBON STEEL	HEAT TREAT 111-41-6,R15N 83-86 CH .015-.020
DIMENSIONS: INCHES		CHK C. GAVLAK 29NOV01	APVD R. SCHAEFFER 03MAY02	
		TOLERANCES UNLESS OTHERWISE SPECIFIED: 0 PLC ± - 1 PLC ± - 2 PLC ± .02 3 PLC ± .005 4 FLC ± .0005		
ANGLES ± ±2		NAME FLARE PLATE		
SURFACE TEXTURE 250		SCALE 2:1	SIZE A2	DRAWING NO 1490356
		SHEET 1	OF 1	REV 04

## X-ON Electronics

Largest Supplier of Electrical and Electronic Components

*Click to view similar products for [Crimpers](#) category:*

*Click to view products by [TE Connectivity](#) manufacturer:*

Other Similar products are found below :

[576771-1](#) [576788-2](#) [010-0041](#) [010-0055](#) [010-0096](#) [604228-1](#) [M225202-37](#) [CT150-2-D02](#) [CT150-4-LY2](#) [CT150-6-RH07](#) [M322](#) [63484-3701](#)  
[63800-0140](#) [63800-8355](#) [63811-3275](#) [63811-3376](#) [63811-6375](#) [63811-6475](#) [63811-7875](#) [63811-8175](#) [63811-8875](#) [63819-0475](#) [63819-1875](#)  
[63819-2875](#) [63819-4375](#) [63819-4475](#) [63823-3475](#) [63823-5175](#) [63823-6375](#) [63823-8375](#) [63827-5375](#) [64001-0975](#) [64001-2175](#) [64001-4175](#)  
[662903-2](#) [690142-4](#) [690602-6](#) [D38999/20WA98JB-LC](#) [7-1633664-2](#) [7-22278-0](#) [7-22280-5](#) [7-240641-3](#) [762637-1](#) [808714-1](#) [8-1633117-3](#)  
[853721-6](#) [91362-1](#) [995-0001-187](#) [1-1633932-5](#) [999-50-020083](#)