

REVISIONS				
REV	DATE	BY	CHK	APPV
AB	11APR2022	SCB	KJK	

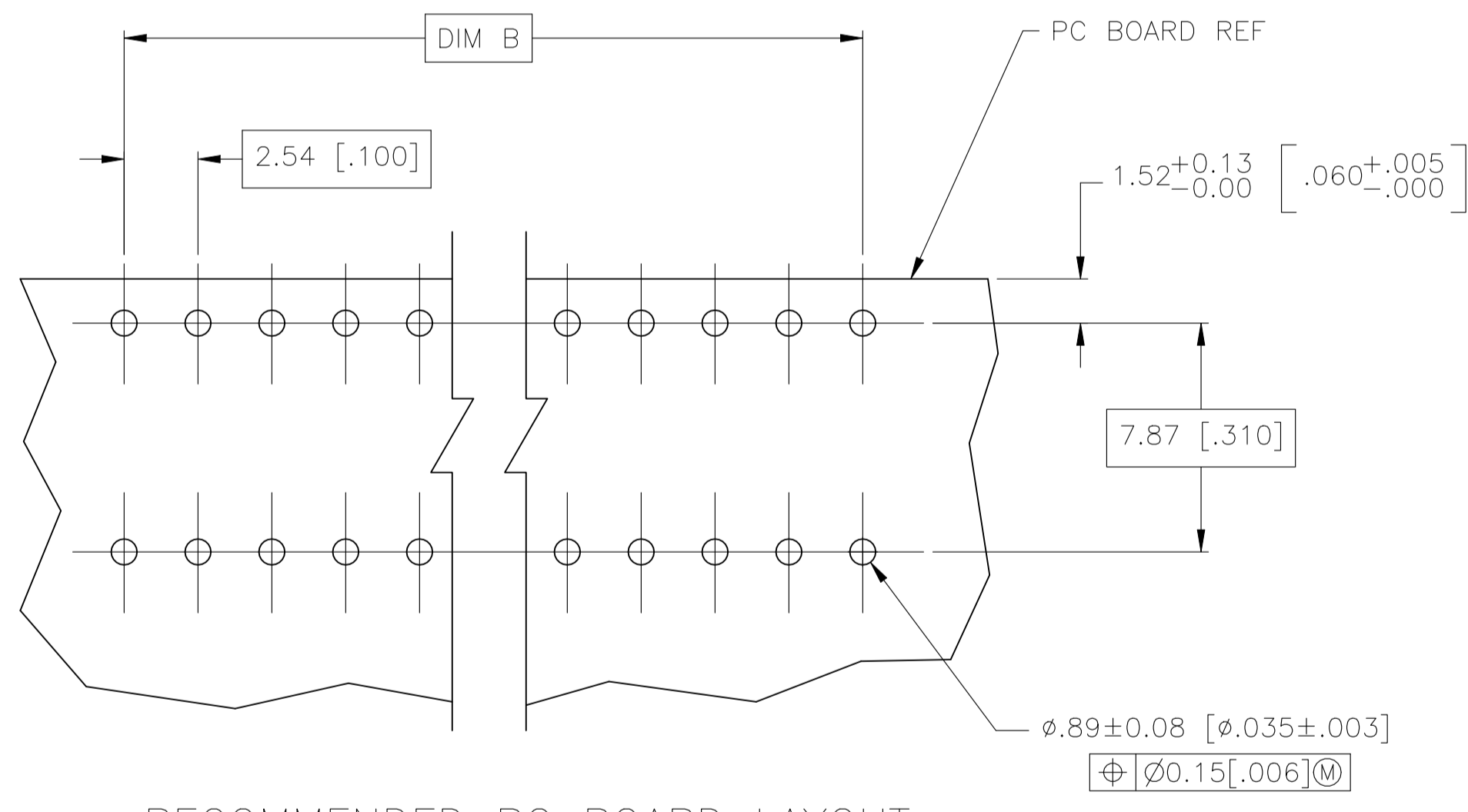
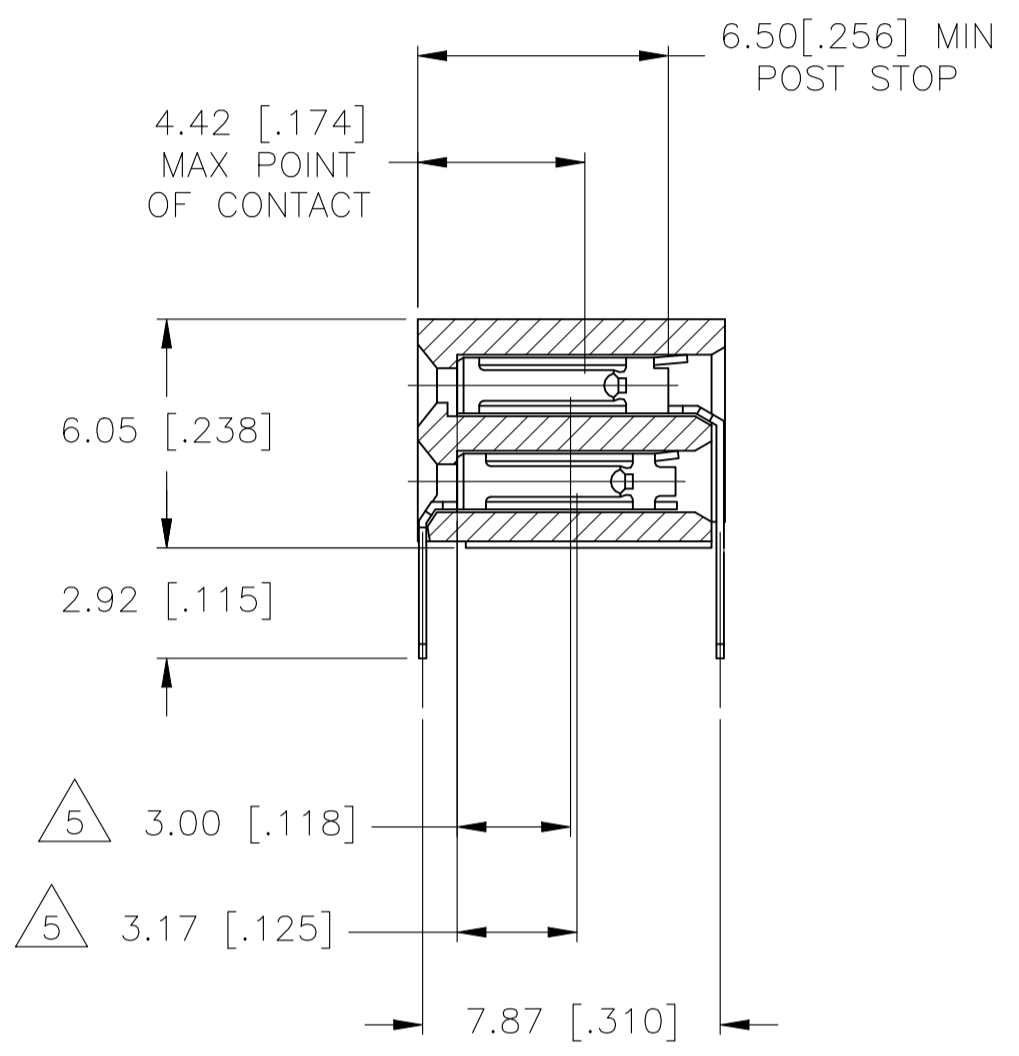
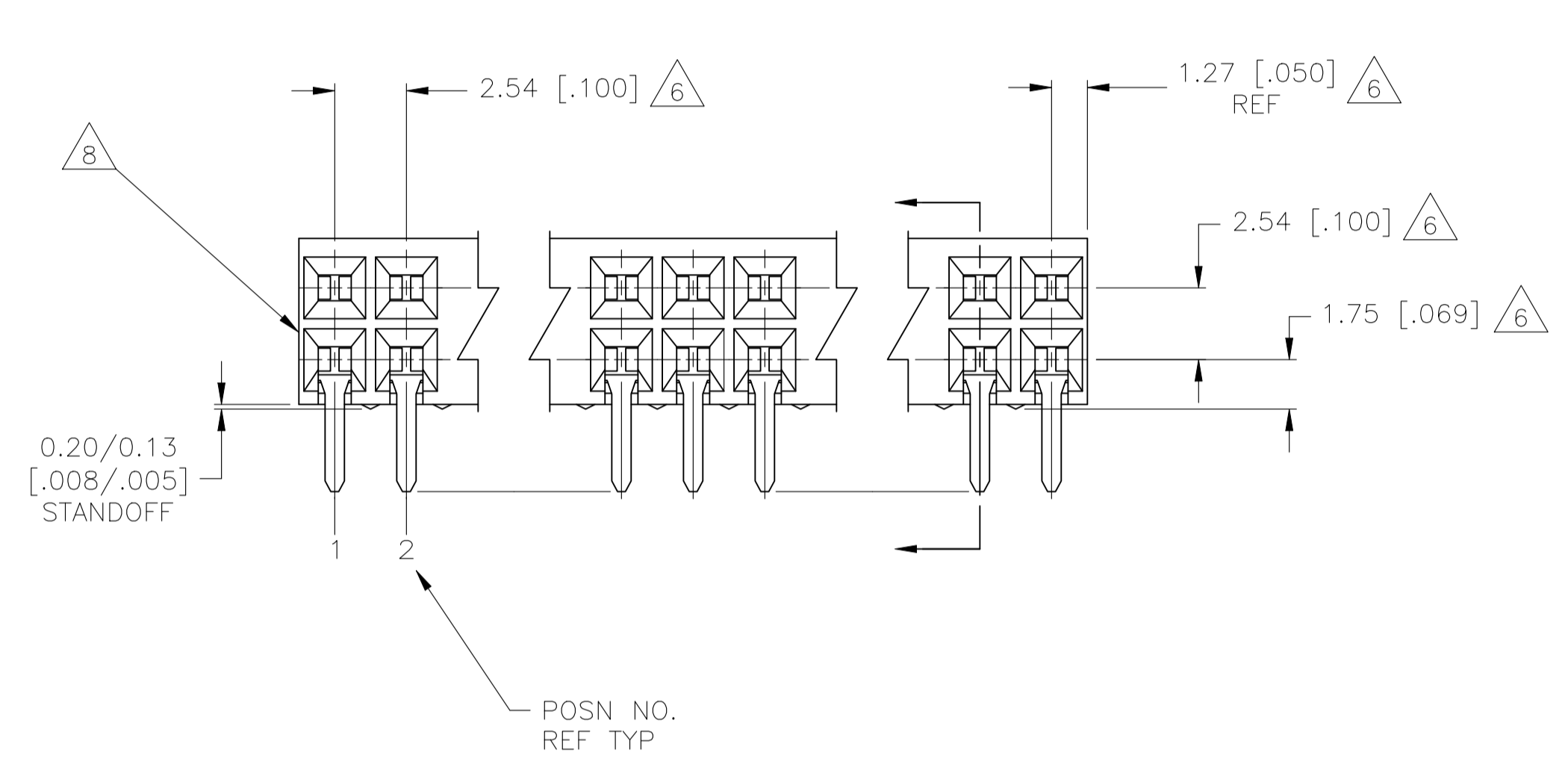
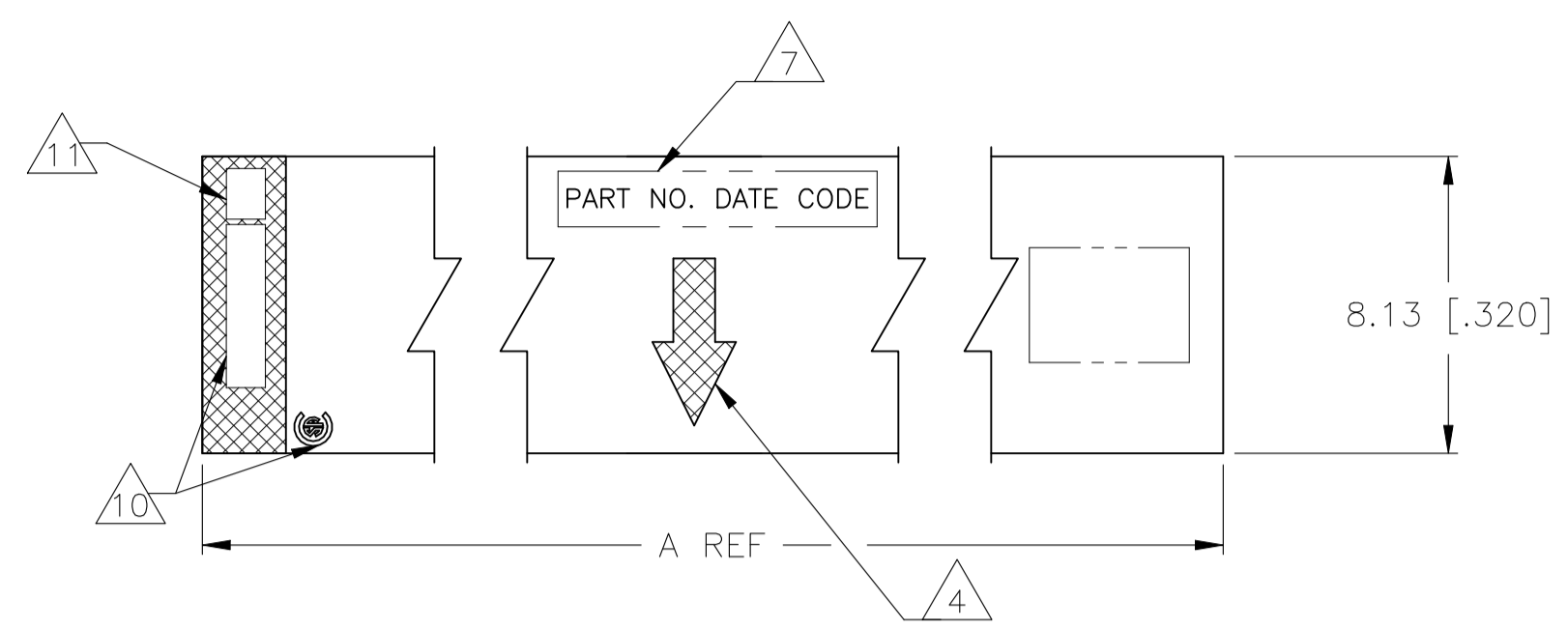

RECOMMENDED PC BOARD LAYOUT

- 1 HOUSING MATERIAL: GLASS FILLED POLYESTER, COLOR- BLACK
- 2 CONTACT MATERIAL: PHOSPHOR BRONZE
- 3 CONTACT FINISH: 0.00076[.000030] THK DUPLEX PLATED GOLD ON CONTACT AREA, 0.00127[.000050] MIN THK BRIGHT TIN-LEAD ON SOLDERLEADS, ALL OVER 0.00127[.000050] NICKEL
- 4 MOLDED IN ARROW DESIGNATES THE MATING FACE OF THE CONNECTOR
- 5 POINT OF MEASUREMENT FOR PLATING THICKNESS OF CONTACT AREA
- 6 DIMENSIONS PERTAIN TO HOUSING CAVITY CENTERLINES
- 7 PART NUMBER AND DATE CODE MARKED IN APPROXIMATE LOCATION SHOWN,EITHER END.
- 8 ALTERNATE LOCATION FOR DATE CODE FOR 4 AND 6 POSITION.
- 10 TE LOGO AND CSA LOGO ARE MOLDED INTO HOUSING, THIS LOCATION.
- 11 POSITION #1 MARKING ON THIS LOCATION FOR ALL PART NUMBERS EXCEPT 6-535512-1

10.16 [.400]	12.70 [.500]	10	6-535512-4
7.62 [.300]	10.16 [.400]	8	6-535512-3
5.08 [.200]	7.62 [.300]	6	6-535512-2
2.54 [.100]	5.08 [.200]	4	6-535512-1
162.56 [6.400]	165.10 [6.500]	130	6-535512-0
160.02 [6.300]	162.56 [6.400]	128	5-535512-9
157.48 [6.200]	160.02 [6.300]	126	5-535512-8
152.40 [6.000]	154.94 [6.100]	122	5-535512-7
149.86 [5.900]	152.40 [6.000]	120	5-535512-6
147.32 [5.800]	149.86 [5.900]	118	5-535512-5
144.78 [5.700]	147.32 [5.800]	116	5-535512-4
142.24 [5.600]	144.78 [5.700]	114	5-535512-3
139.70 [5.500]	142.24 [5.600]	112	5-535512-2
137.16 [5.400]	139.70 [5.500]	110	5-535512-1
134.62 [5.300]	137.16 [5.400]	108	5-535512-0
132.08 [5.200]	134.62 [5.300]	106	4-535512-9
129.54 [5.100]	132.08 [5.200]	104	4-535512-8
127.00 [5.000]	129.54 [5.100]	102	4-535512-7
124.46 [4.900]	127.00 [5.000]	100	4-535512-6
SUPERCEDED BY 4-5535512-5	121.92 [4.800]	98	4-535512-5
	119.38 [4.700]	96	4-535512-4
	116.84 [4.600]	94	4-535512-3
	114.30 [4.500]	92	4-535512-2
	111.76 [4.400]	90	4-535512-1
	109.22 [4.300]	88	4-535512-0
SUPERCEDED BY 3-5535512-9	106.68 [4.200]	86	3-535512-9
	104.14 [4.100]	84	3-535512-8
	101.6 [4.000]	82	3-535512-7
	91.44 [3.600]	74	3-535512-6
	88.90 [3.500]	72	3-535512-5
	83.82 [3.300]	68	3-535512-4
	81.28 [3.200]	66	3-535512-3
	78.74 [3.100]	64	3-535512-2
	76.20 [3.000]	62	3-535512-1
	73.66 [2.900]	60	3-535512-0
	71.12 [2.800]	58	2-535512-9
	63.50 [2.500]	52	2-535512-8
	55.88 [2.200]	46	2-535512-7
	50.8 [2.000]	42	2-535512-6
	48.26 [1.900]	40	2-535512-5
	45.72 [1.800]	38	2-535512-4
	43.18 [1.700]	36	2-535512-3
	40.64 [1.600]	34	2-535512-2
	38.10 [1.500]	32	2-535512-1
	35.56 [1.400]	30	2-535512-0
	33.02 [1.300]	28	2-535512-9
	30.48 [1.200]	26	2-535512-8
	27.94 [1.100]	24	2-535512-7
	25.40 [1.000]	22	2-535512-6
	22.86 [.900]	20	2-535512-5
	20.32 [.800]	18	2-535512-4
	17.78 [.700]	16	2-535512-3
	15.24 [.600]	14	2-535512-2
	12.70 [.500]	12	2-535512-1
		10	2-535512-0
		8	2-535512-9
		6	2-535512-8
		4	2-535512-7
		2	2-535512-6
		0	2-535512-5
		0	2-535512-4
		0	2-535512-3
		0	2-535512-2
		0	2-535512-1
		0	2-535512-0
		0	1-535512-9
		0	1-535512-8
		0	1-535512-7
		0	1-535512-6
		0	1-535512-5
		0	1-535512-4
		0	1-535512-3
		0	1-535512-2
		0	1-535512-1
		0	1-535512-0
		0	0-535512-9
		0	0-535512-8
		0	0-535512-7
		0	0-535512-6
		0	0-535512-5
		0	0-535512-4
		0	0-535512-3
		0	0-535512-2
		0	0-535512-1
		0	0-535512-0
		0	0-535512-9
		0	0-535512-8
		0	0-535512-7
		0	0-535512-6
		0	0-535512-5
		0	0-535512-4
		0	0-535512-3
		0	0-535512-2
		0	0-535512-1
		0	0-535512-0
		0	0-535512-9
		0	0-535512-8
		0	0-535512-7
		0	0-535512-6
		0	0-535512-5
		0	0-535512-4
		0	0-535512-3
		0	0-535512-2
		0	0-535512-1
		0	0-535512-0
		0	0-535512-9
		0	0-535512-8
		0	0-535512-7
		0	0-535512-6
		0	0-535512-5
		0	0-535512-4
		0	0-535512-3
		0	0-535512-2
		0	0-535512-1
		0	0-535512-0
		0	0-535512-9
		0	0-535512-8
		0	0-535512-7
		0	0-535512-6
		0	0-535512-5
		0	0-535512-4
		0	0-535512-3
		0	0-535512-2
		0	0-535512-1
		0	0-535512-0
		0	0-535512-9
		0	0-535512-8
		0	0-535512-7
		0	0-535512-6
		0	0-535512-5
		0	0-535512-4
		0	0-535512-3
		0	0-535512-2
		0	0-535512-1
		0	0-535512-0
		0	0-535512-9
		0	0-535512-8
		0	0-535512-7
		0	0-535512-6
		0	0-535512-5
		0	0-535512-4
		0	0-535512-3
		0	0-535512-2
		0	0-535512-1
		0	0-535512-0
		0	0-535512-9
		0	0-535512-8
		0	0-535512-7
		0	0-535512-6
		0	0-535512-5
		0	0-535512-4
		0	0-535512-3
		0	0-535512-2
		0	0-535512-1
		0	0-535512-0
		0	0-535512-9
		0	0-535512-8
		0	0-535512-7
		0	0-535512-6
		0	0-535512-5
		0	0-535512-4
		0	0-535512-3
		0	0-535512-2
		0	0-535512-1
		0	0-535512-0
		0	0-535512-9
		0	0-535512-8
		0	0-535512-7
		0	0-535512-6
		0	0-535512-5
		0	0-535512-4
		0	0-535512-3
		0	0-535512-2
		0	0-535512-1
		0	0-535512-0
		0	0-535512-9
		0	0-535512-8
		0	0-535512-7
		0	0-535512-6
		0	0-535512-5
		0	0-535512-4
		0	0-535512-3
		0	0-535512-2
		0	0-535512-1
		0	0-535512-0
		0	0-535512-9
		0	0-535512-8
		0	0-535512-7
		0	0-535512-6
		0	0-535512-5
		0	0-535512-4
		0	0-535512-3
		0	0-535512-2
		0	0-535512-1
		0	0-535512-0
		0	0-535512-9
		0	0-535512-8
		0	0-535512-7
		0	0-535512-6
		0	0-535512-5
		0	0-535512-4
		0	0-535512-3
		0	0-535512-2
		0	0-535512-1
		0	0-535512-0
		0	0-535512-9
		0	0-535512-8
		0	0-535512-7
		0	0-535512-6
		0	0-535512-5
		0	0-535512-4
		0	0-535512-3
		0	0-535512-2
		0	0-535512-1
		0	0-535512-0
		0	0-535512-9
		0	0-535512-8
		0	0-535512-7
		0	0-535512-6
		0	0-535512-5
		0	0-535512-4
		0	0-535512-3
		0	0-535512-2
		0	0-535512-1
		0	0-535512-0
		0	0-535512-9
		0	0-535512-8
		0	0-535512-7
		0	0-535512-6
		0	0-535512-5
		0	0-535512-4
		0	0-535512-3
		0	0-535512-2
		0	0-535512-1
		0	0-535512-0
		0	0-535512-9
		0	0-535512-8
		0	0-535512-7
		0	0-535512-6
		0	0-535512-5
		0	0-535512-4
		0	0-535512-3
		0	0-535512-2
		0	0-535512-1
		0	0-535512-0
		0	0-535512-9
		0	0-535512-8
		0	0-535512-7
		0	0-535512-6
		0	0-535512-5
		0	0-535512-4
		0	0-535512-3
		0	0-535512-2
		0	0-535512-1
		0	0-535512-0
		0	0-535512-9
		0	0-535512-8
		0	0-535512-7
		0	0-535512-6
		0	0-535512-5
		0	0-535512-4
		0	0-535512-3
		0	0-535512-2
		0	0-535512-1
		0	0-535512-0
		0	0-535512-9
		0	0-535512-8
		0	0-535512-7
		0	0-535512-6
		0	0-535512-5
		0	0-535512-4
		0	0-535512-3
		0	0-535512-2
		0	0-535512-1
		0	0-535512-0
		0	0-535512-9
		0	0-535512-8
		0	0-535512-7
		0	0-535512-6
		0	0-535512-5
		0	0-535512-4
		0	0-535512-3
		0	0-535512-2
		0	0-535512-1
		0	0-535512-0
		0	0-535512-9
		0	0-535512-8
		0	0-535512-7
		0	0-535512-6
		0	0-535512-5
		0	0-535512-4
		0	0-535512-3
		0	0-535512-2
		0	0-535512-1
		0	0-535512-0
		0	0-535512-9
		0	0-535512-8
		0	

## X-ON Electronics

Largest Supplier of Electrical and Electronic Components

*Click to view similar products for [Headers & Wire Housings](#) category:*

*Click to view products by [TE Connectivity](#) manufacturer:*

Other Similar products are found below :

[57102-F02-18ULF](#) [58102-G61-06LF](#) [582553-1](#) [009176003701906](#) [0050291907](#) [02.125.8002.8](#) [609-3404](#) [61062-3](#) [622-0430](#) [622-3653LF](#)  
[63453-116](#) [636-1030](#) [636-1427](#) [636-3427](#) [636-4007](#) [641938-9](#) [65495-038](#) [65692-001LF](#) [65781-018](#) [65781-047](#) [65817-010LF](#) [65817-015LF](#)  
[66207-023LF](#) [67016-026LF](#) [67095-007LF](#) [68631-112](#) [68645-018](#) [68648-049](#) [699319-000](#) [M90C108951C](#) [70.362.1628.0](#) [70-4210](#) [70-4226B](#)  
[70-4853B](#) [707-5020](#) [707-5028](#) [71.350.2428.0](#) [71961-016LF](#) [733-134](#) [754199-000](#) [760-3052](#) [787-8014-00](#) [FCN-367T-T012/H](#)  
[80.063.4001.1](#) [800-90-001-10-001000](#) [801-43-002-10-013000](#) [801-43-006-10-002000](#) [803-41-018-10-001000](#) [803-43-014-20-001000](#)  
[803-43-024-10-001000](#)