

LOC	DIST	REV	DATE	DWN	APVD
CM	00	A	04MAY05	KW	SR
		A1	07DEC2007	KW	DC

- PARTS COMPLY TO AMP SOLDERABILITY SPECIFICATION 109-11-3.
- CIRCUIT IDENTIFICATION CHARACTERS ARE ADJACENT TO THE INDICATED CAVITIES, BUT LOCATION AND ORIENTATION MAY DIFFER FROM PRINT.
- DIMENSIONS IN BRACKETS ARE IN INCHES.

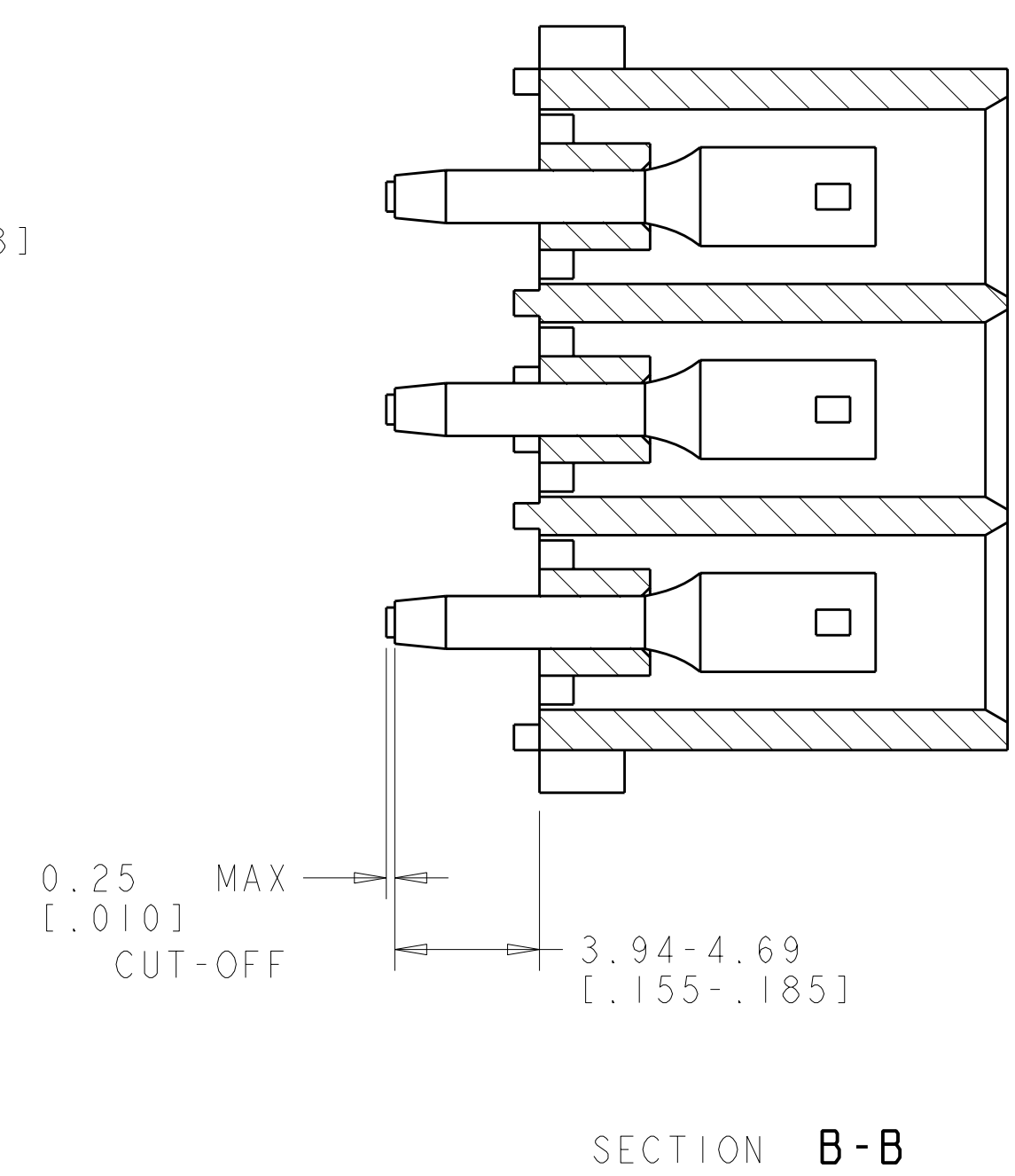
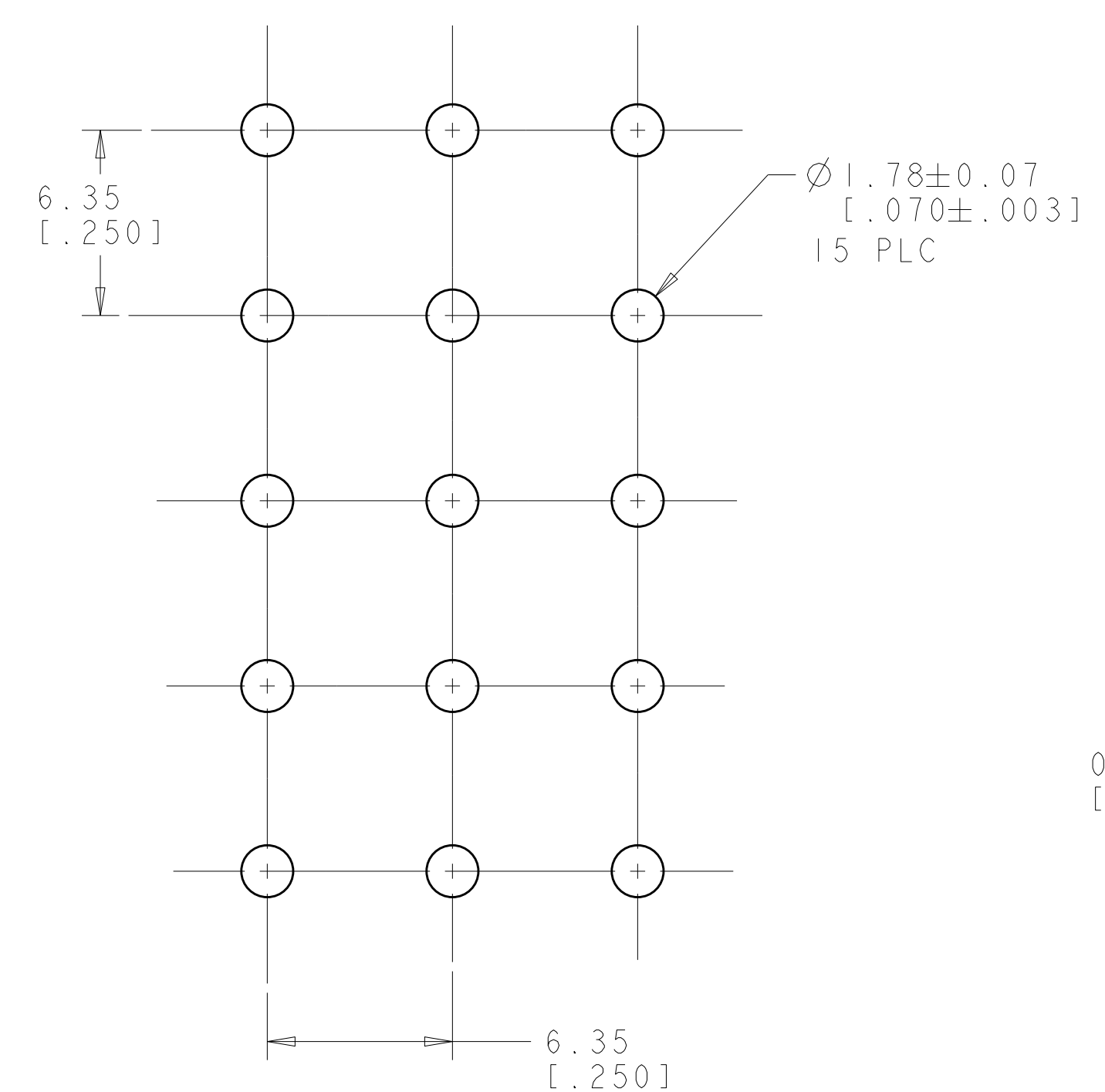
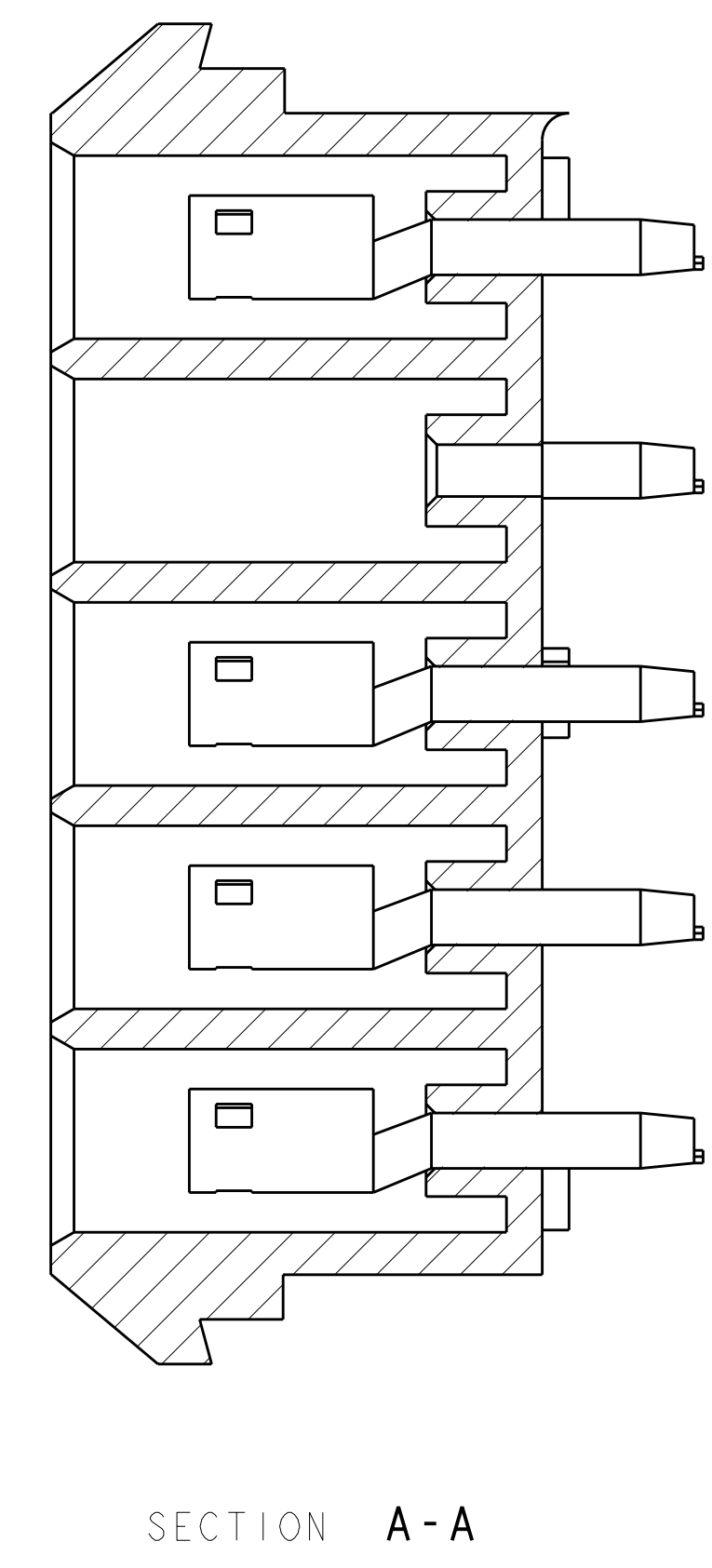
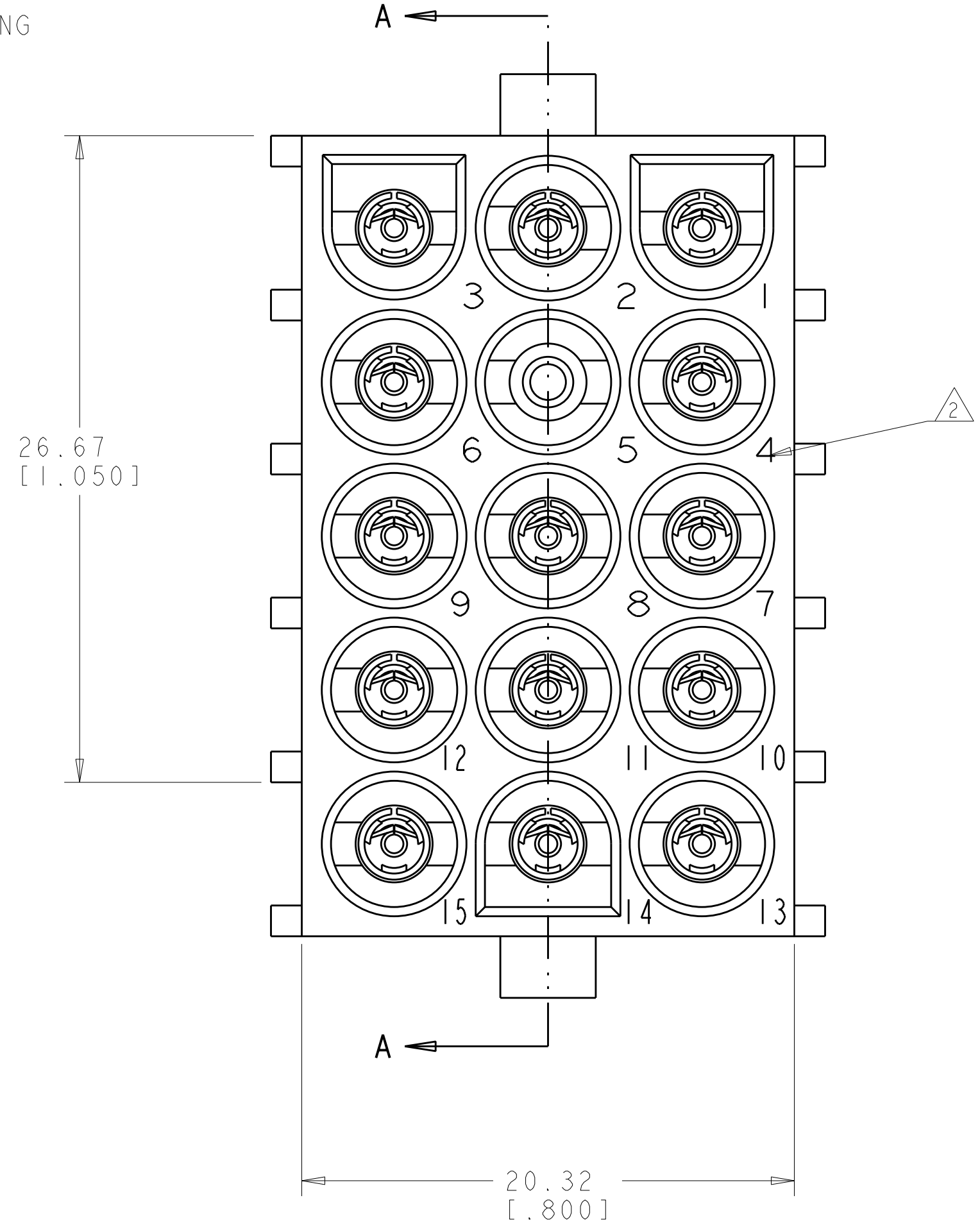
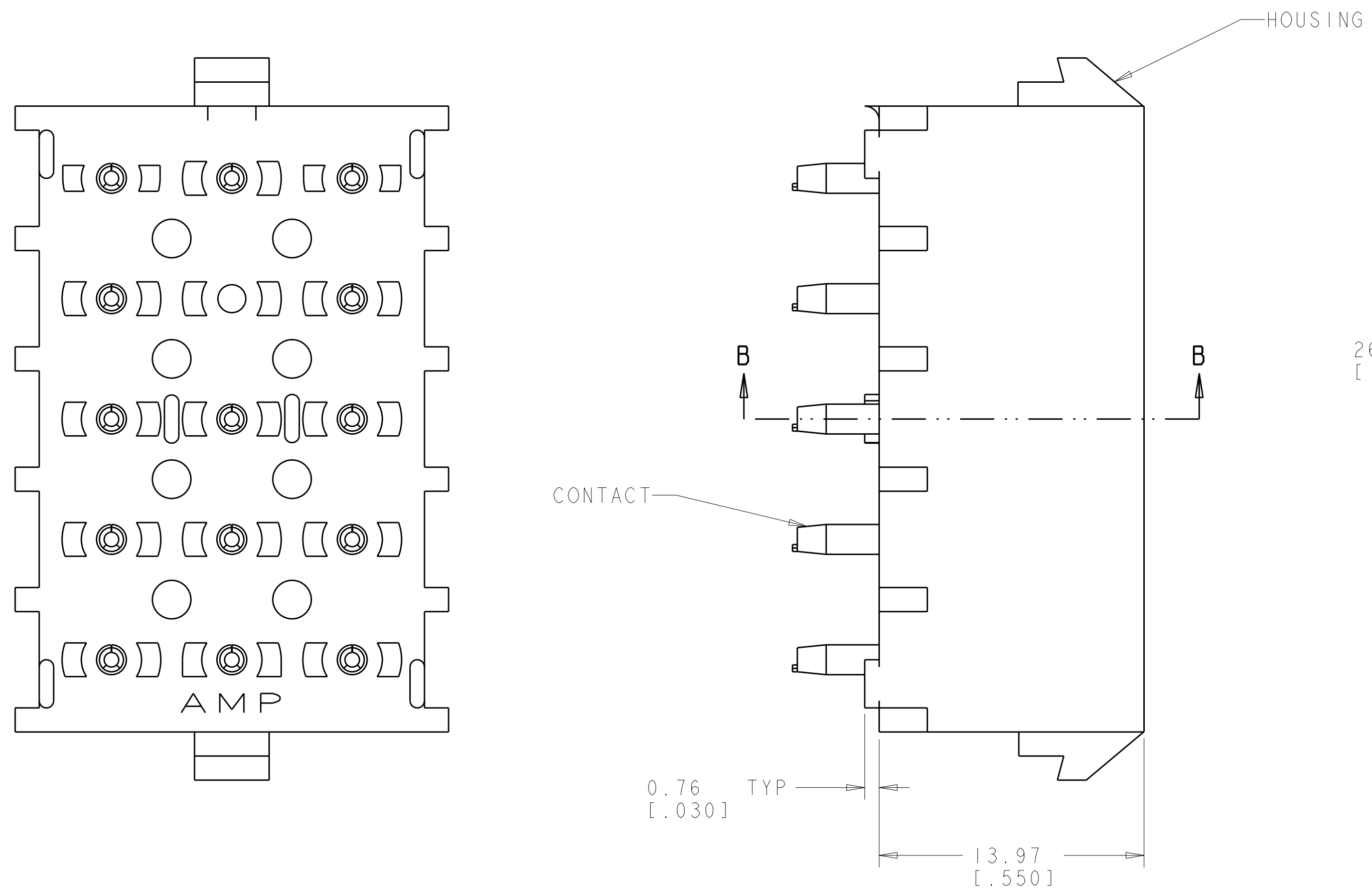

1586683-5 SHOWN

PIN	MATERIAL AND FINISH	HOUSING MATERIAL AND COLOR	PART NUMBER
15	PHOSPOR BRONZE, PRE-TIN	NYLON, UL94V-0, WHITE	1-1586683-5
14	PHOSPOR BRONZE, PRE-TIN	NYLON, UL94V-0, WHITE	1-1586683-4
13	PHOSPOR BRONZE, PRE-TIN	NYLON, UL94V-0, WHITE	1-1586683-3
11	PHOSPOR BRONZE, PRE-TIN	NYLON, UL94V-0, WHITE	1-1586683-1
10	PHOSPOR BRONZE, PRE-TIN	NYLON, UL94V-0, WHITE	1-1586683-0
9	PHOSPOR BRONZE, PRE-TIN	NYLON, UL94V-0, WHITE	1586683-9
5	PHOSPOR BRONZE, PRE-TIN	NYLON, UL94V-0, WHITE	1586683-5

SOCKET NO OMITTED PIN CONTACT MATERIAL AND FINISH HOUSING MATERIAL AND COLOR PART NUMBER

RECOMMENDED MOUNTING HOLE PATTERN FOR 1.57 [.062] THICK P.C. BOARD HOLE THAT CORRESPONDS TO REMOVED CONTACT CAN BE OMITTED



DIMENSIONS: mm [INCHES] TOLERANCES UNLESS OTHERWISE SPECIFIED: 9 PLC ± .013 [.005] 5 PLC ± .013 [.005] 4 PLC ± .013 [.005] ANGLES 40° 30'		DWN R. WHITAKER 04MAY2005 CHK S. RIDGILL 04MAY2005 APVD S. RIDGILL 04MAY2005		Tyco Electronics Harrisburg, PA 17105-3608	
MATERIAL SEE TABLE FINISH SEE TABLE		NAME: SOCKET HEADER ASSEMBLY, 15 CIRCUIT, SELECTIVELY LOADED, UNIVERSAL MATE-N-LOK(TM) PRODUCT SPEC: - APPLICATION SPEC: - WEIGHT: -		SIZE: A1 CAGE CODE: 00779 DRAWING NO: 1586683	
CUSTOMER DRAWING		SCALE: 5:1		SHEET 1 OF 1 REV A1	

X-ON Electronics

Largest Supplier of Electrical and Electronic Components

Click to view similar products for [Headers & Wire Housings](#) category:

Click to view products by [TE Connectivity](#) manufacturer:

Other Similar products are found below :

[892-18-020-10-001101](#) [58102-G61-06LF](#) [582553-1](#) [0009485154](#) [009176003701906](#) [0050291907](#) [LY20-4P-DT1-P1E-BR](#) [02.125.8002.8](#)
[609-3404](#) [61062-3](#) [61082-181009](#) [622-3653LF](#) [63453-116](#) [636-1030](#) [636-1427](#) [636-3427](#) [636-4007](#) [641938-9](#) [641991-4](#) [644827-2](#) [65817-010LF](#) [65817-015LF](#) [65863-015LF](#) [66207-023LF](#) [67095-007LF](#) [67601157](#) [68645-018](#) [68648-049](#) [70.362.1628.0](#) [70-4210](#) [70-4226B](#) [70-4853B](#) [707-5020](#) [707-5028](#) [71.350.2428.0](#) [71918-208LF](#) [71961-016LF](#) [733-134](#) [733-162](#) [754199-000](#) [760-3052](#) [787-8014-00](#) [79531-3000](#)
[FCN-360C032-B](#) [FCN-367T-T012/H](#) [FCN-723D010/2](#) [80.063.4001.1](#) [800-90-001-10-001000](#) [800-90-010-10-002000](#) [801-43-002-10-013000](#)