

THIS DRAWING IS UNPUBLISHED. RELEASED FOR PUBLICATION
 © COPYRIGHT - By - ALL RIGHTS RESERVED.

REVISIONS				
P	LTR	DESCRIPTION	DATE	APVD
E1		REVISED PER ECR-15-012827	31AUG2015	NK DC

- 1 MATERIAL: POLYAMIDE, UL94V-2, WHITE.
- 2 MATERIAL: POLYAMIDE, UL94-V0, PINK.
- 3 MATERIAL: POLYAMIDE, UL94-V0, BLUE.
- 4 GLOW WIRE FLAMMABILITY INDEX (GWFI) 850°C AT LEAST, ACC. TO IEC 60335-1
- 5 GLOW WIRE IGNITION TEMPERATURE (GWIT) 775°C AT LEAST, ACC. TO IEC 60335-1
- 6 GLOW WIRE END PRODUCT TEMPERATURE (GWEPT) 750°C NO FLAME ACC. TO IEC 60335-1

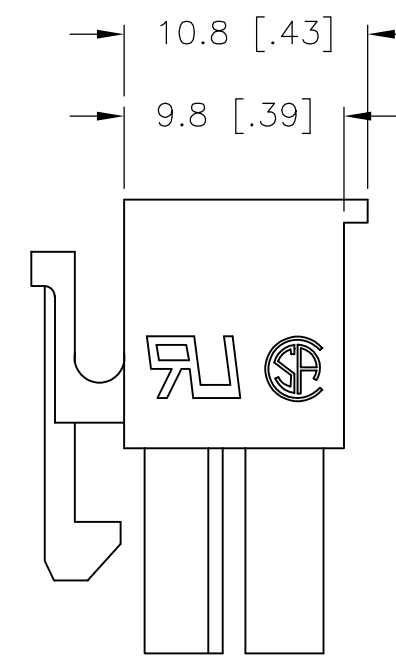
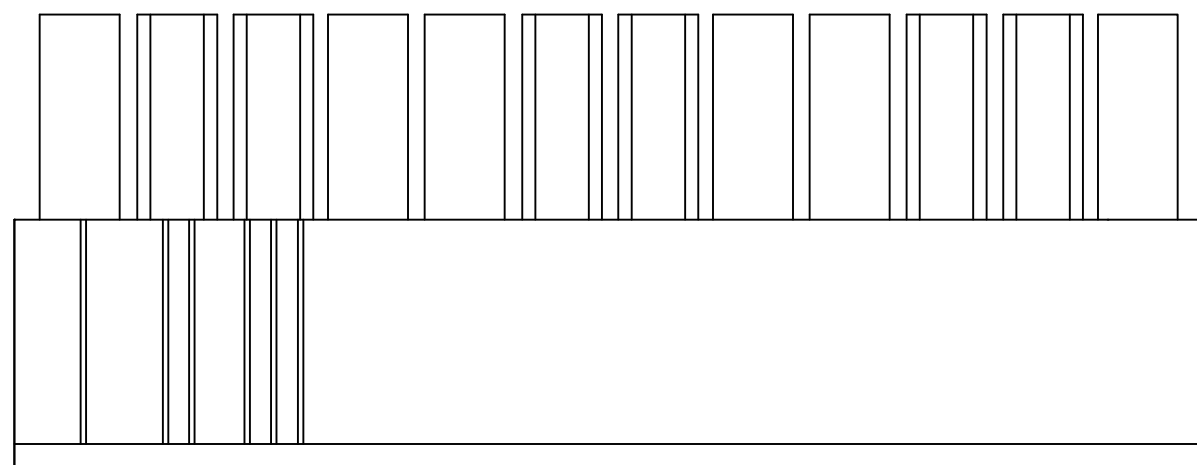
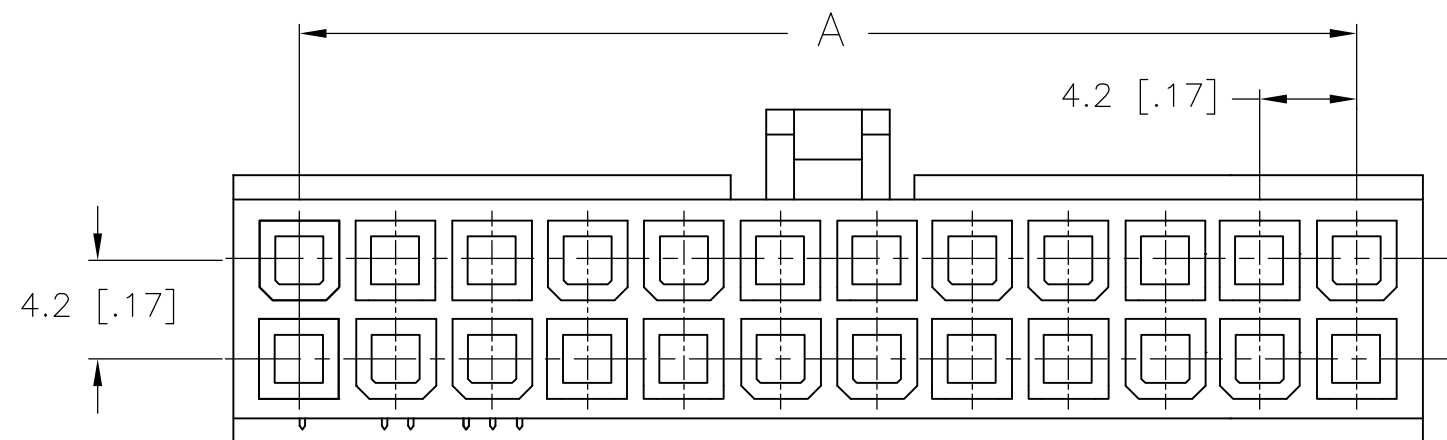
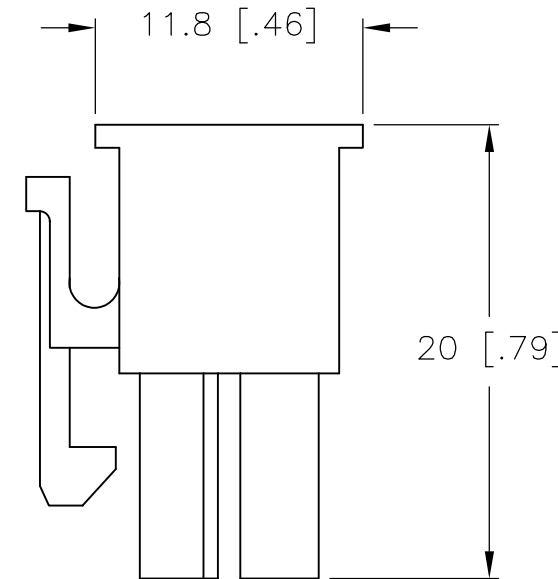
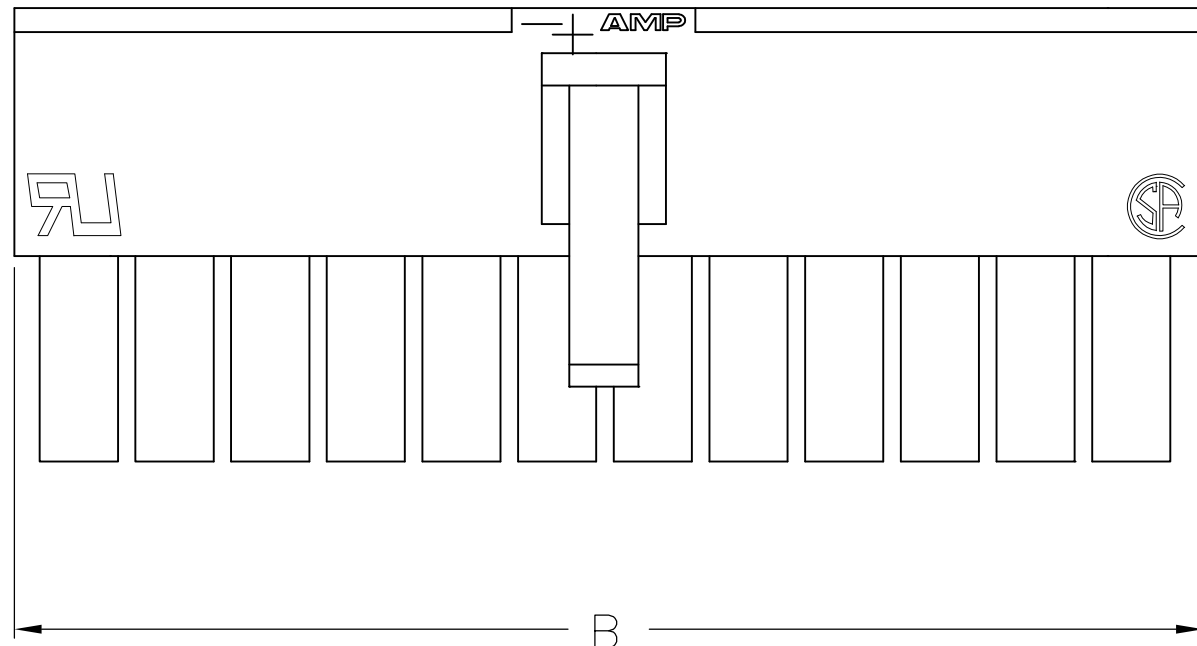
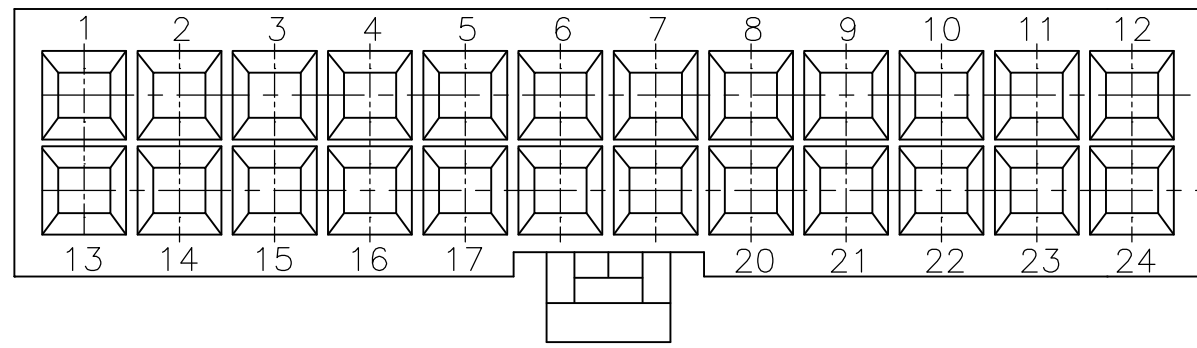

ONLY FOR 1586765-2

NOTES	DIM B	DIM A	POS.	PART NUMBER
3	43.2	37.8	20	2-2292405-0
2	39.0	33.6	18	1-2292404-8
1	51.6	46.2	24	2-1586765-4
1	47.4	42.0	22	2-1586765-2
1	43.2	37.8	20	2-1586765-0
1	39.0	33.6	18	1-1586765-8
1	34.8	29.4	16	1-1586765-6
1	30.6	25.2	14	1-1586765-4
1	26.4	21.0	12	1-1586765-2
1	22.2	16.8	10	1-1586765-0
1	18.0	12.6	8	1586765-8
1	13.8	8.4	6	1586765-6
1	9.6	4.2	4	1586765-4
1	5.4	-	2	1586765-2

THIS DRAWING IS A CONTROLLED DOCUMENT.		DWN K. WHITAKER 08MAY2007	TE Connectivity RECEPTACLE HOUSING, 4.2 MM P.E. SERIES	
DIMENSIONS: mm [INCHES]		CHK C. CASH 08MAY2007		
TOLERANCES UNLESS OTHERWISE SPECIFIED:		APVD C. CASH 08MAY2007	NAME	
0 PLC ±	1 PLC ± 0.4[.02]	PRODUCT SPEC	SIZE	
2 PLC ± 0.25[.010]	3 PLC ± 0.150[.0059]	APPLICATION SPEC	CAGE CODE	DRAWING NO
4 PLC ±	ANGLES ±	WEIGHT	A2 00779	C=1586765
MATERIAL SEE TABLE	FINISH -	CUSTOMER DRAWING	SCALE 3:1	SHEET 1 of 1
			RESTRICTED TO	REV E1

X-ON Electronics

Largest Supplier of Electrical and Electronic Components

Click to view similar products for [Headers & Wire Housings](#) category:

Click to view products by [TE Connectivity](#) manufacturer:

Other Similar products are found below :

[892-18-020-10-001101](#) [58102-G61-06LF](#) [582553-1](#) [0009485154](#) [009176003701906](#) [0050291907](#) [LY20-4P-DT1-P1E-BR](#) [02.125.8002.8](#)
[609-3404](#) [61062-3](#) [61082-181009](#) [622-3653LF](#) [63453-116](#) [636-1030](#) [636-1427](#) [636-3427](#) [636-4007](#) [641938-9](#) [641991-4](#) [644827-2](#) [65817-](#)
[010LF](#) [65817-015LF](#) [65863-015LF](#) [66207-023LF](#) [67095-007LF](#) [67601157](#) [68645-018](#) [68648-049](#) [70.362.1628.0](#) [70-4210](#) [70-4226B](#) [70-](#)
[4853B](#) [707-5020](#) [707-5028](#) [71.350.2428.0](#) [71918-208LF](#) [71961-016LF](#) [733-134](#) [733-162](#) [754199-000](#) [760-3052](#) [787-8014-00](#) [79531-3000](#)
[FCN-360C032-B](#) [FCN-367T-T012/H](#) [FCN-723D010/2](#) [80.063.4001.1](#) [800-90-001-10-001000](#) [800-90-010-10-002000](#) [801-43-002-10-013000](#)