

THIS DRAWING IS UNPUBLISHED. RELEASED FOR PUBLICATION
 © COPYRIGHT BY TYCO ELECTRONICS CORPORATION. ALL RIGHTS RESERVED.

LOC		DIST		REVISIONS			
P	LTR	DESCRIPTION		DATE	DWN	APVD	
AF	50	A3	REVISED PER ECR-21-106739	09JUL2021	CP	KR	

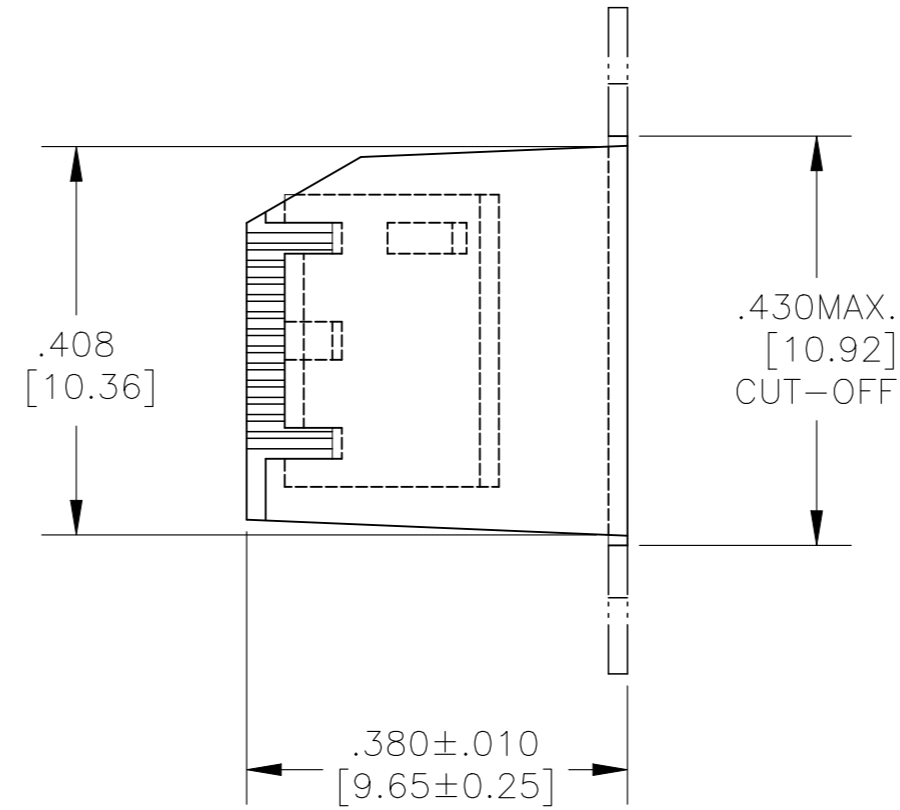
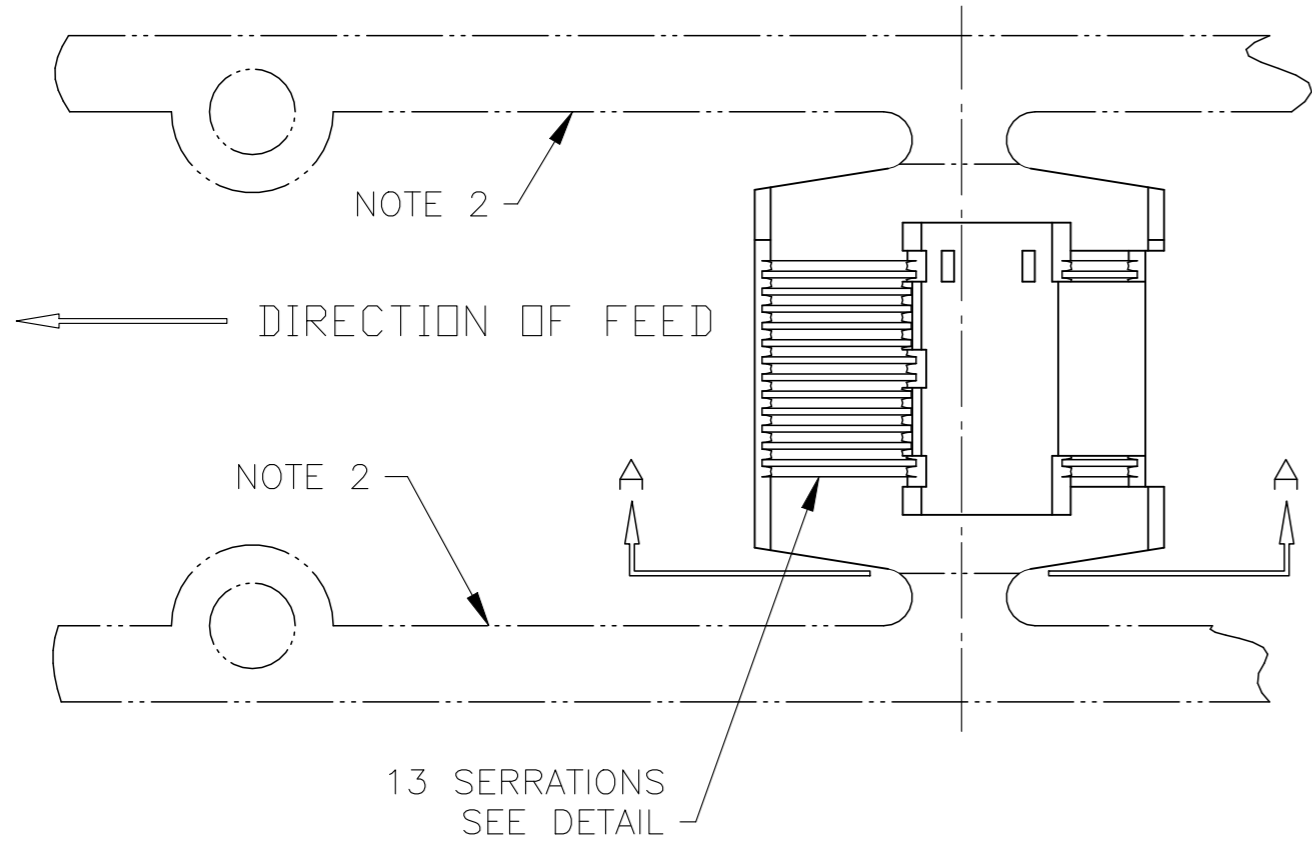

- SPECIFICATIONS
 LEAD WIRE : #14-#10 AWG (2.0-5.6mm²) (4,000-11,000 CMA)
 2 WIRES MAX
 MAGNET WIRE: #20-#11 AWG (0.81-2.30mm²)
 (1,000-9,000 CMA) 8 WIRES MAX
 TOTAL WIRE: 4,000-40,000 CMA
 CRIMP HEIGHT: (TOTAL CMA + 57,000) / 737,000

- CARRIER STRIPS (PHANTOM LINES) TO SCRAP DURING INSERTION.

△ 3 FINISH: PRE-TIN PLATE OVER COPPER UNDERPLATE.

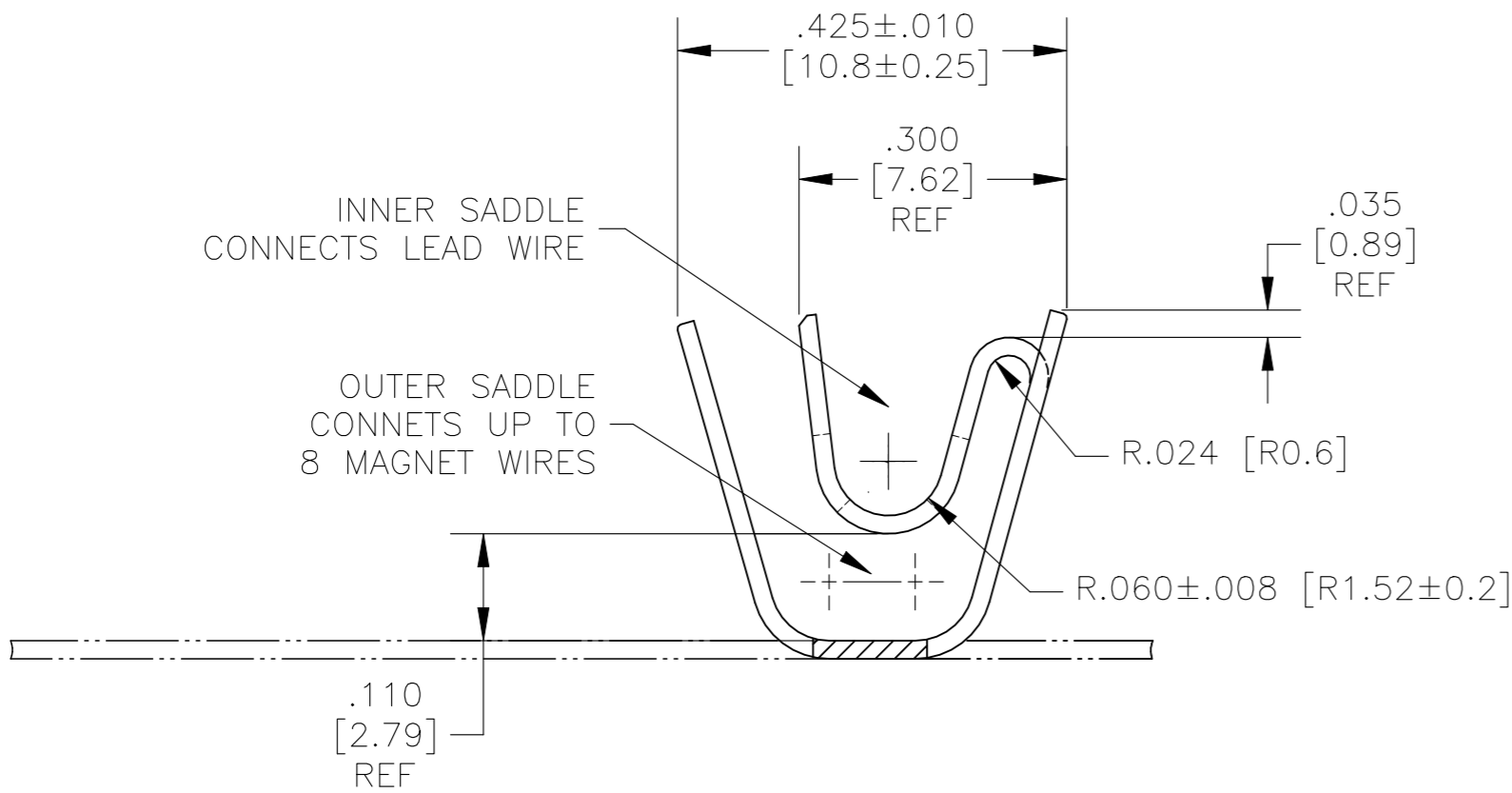

SERRATION DETAIL
SCALE 40X

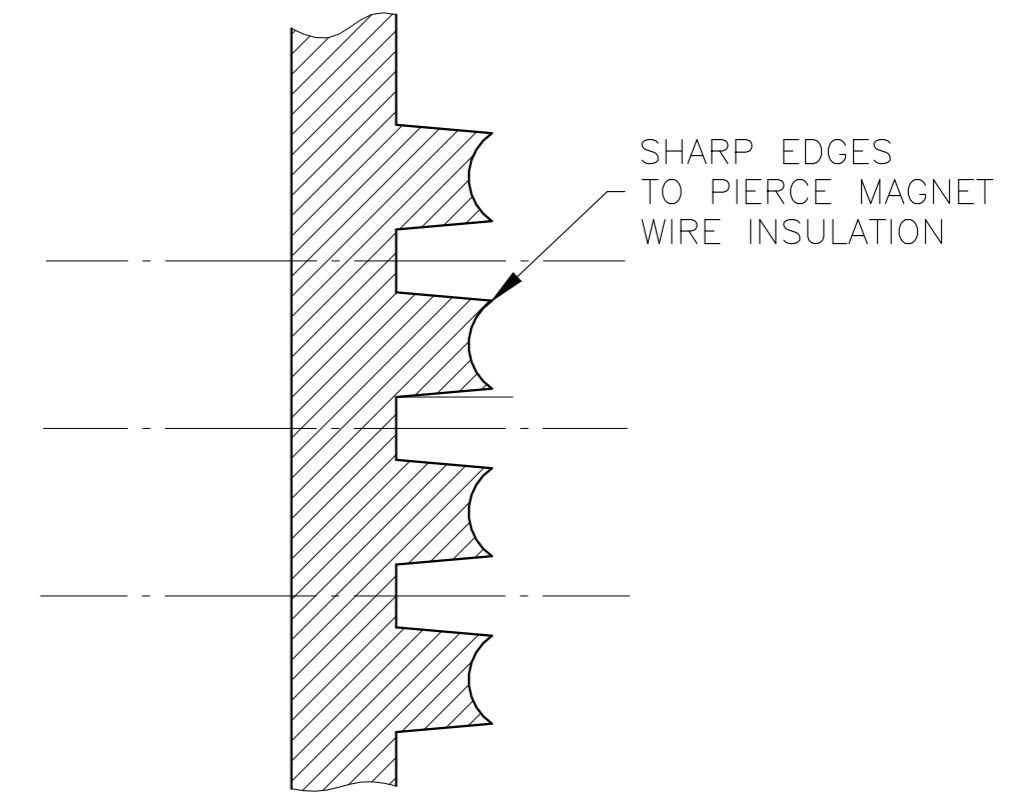

TERMINALS TO UNWIND FROM REELS AS SHOWN:

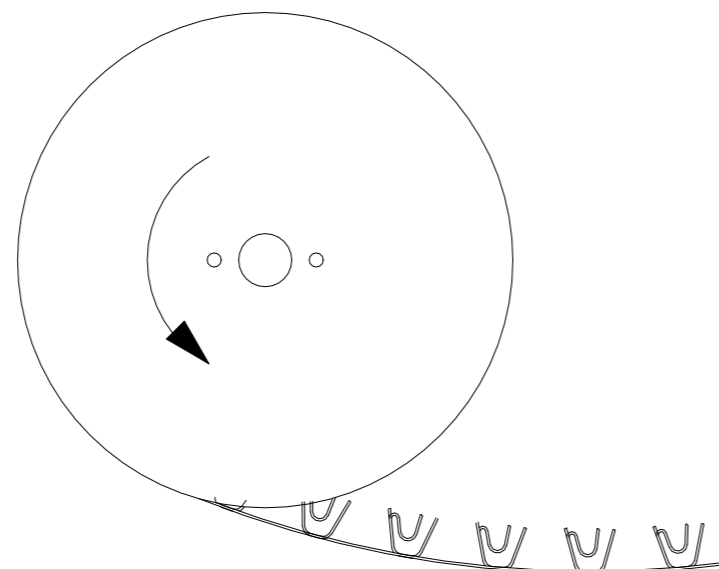

-		-		-	
△ 3		111-000-001		1601953-1	
FINISH		REFERENCE PART NUMBER		TYCO PART NUMBER	
THIS DRAWING IS A CONTROLLED DOCUMENT.		DWN 18JUL2002		TE Connectivity POWER SPLICE	
DIMENSIONS: INCHES		CHK 18JUL2002			
TOLERANCES UNLESS OTHERWISE SPECIFIED:		APVD 18JUL2002			
0 PLC ± - 1 PLC ± - 2 PLC ± .01[0.13] 3 PLC ± .005[0.026] 4 PLC ± - ANGLES ± 3°		NAME G JACONO PRODUCT SPEC APPLICATION SPEC 114-13093			
MATERIAL: BRASS, HALF HARD		FINISH: -		SIZE: A2 CAGE CODE: 00779 DRAWING NO: C=1601953 RESTRICTED TO: -	
		WEIGHT: -		SCALE: 1:1	
		CUSTOMER DRAWING		SHEET: 1 of 1	
				REV: A3	

X-ON Electronics

Largest Supplier of Electrical and Electronic Components

Click to view similar products for [Terminals](#) category:

Click to view products by [TE Connectivity](#) manufacturer:

Other Similar products are found below :

[00-054007-01074-6](#) [00-054007-70206-1](#) [00-054007-70210-8](#) [00-054007-70217-7](#) [00-054007-70226-9](#) [00-054007-70228-3](#) [00-054007-70248-1](#) [00-054007-70256-6](#) [00-054007-70301-3](#) [00-054007-70316-7](#) [00-054007-49560-4](#) [00-054007-70209-2](#) [00-054007-70225-2](#) [00-054007-70227-6](#) [00-054007-70231-3](#) [00-054007-70241-2](#) [00-054007-70242-9](#) [00-054007-70244-3](#) [00-054007-70246-7](#) [00-054007-70263-4](#) [00-054007-70288-7](#) [00-054007-70290-0](#) [00-054007-70300-6](#) [00-054007-70304-4](#) [01-2065-1-0216](#) [01-2900-1-04412](#) [00581P0075](#) [600TS-10](#) [60205-1](#) [604200-1](#) [605601-1](#) [60598-1-CUT-TAPE](#) [61314-6-C](#) [61810-3](#) [61-S](#) [61-SN](#) [626-0194](#) [62-NBM-A](#) [62-SN](#) [62-SP](#) [63-S](#) [640179-1](#) [M55155/059I03](#) [M55155/079C01](#) [M55155/099H02](#) [M55155/109H01](#) [M55155/109H02](#) [M55155/12XH05](#) [M55155/16XH02](#) [M55155/29-5S](#)