

THIS DRAWING IS UNPUBLISHED. RELEASED FOR PUBLICATION  
 © COPYRIGHT - By - ALL RIGHTS RESERVED.

REVISIONS				
P	LTR	DESCRIPTION	DATE	APVD
A		NEW DRAWING	20NOV2016	RS TD

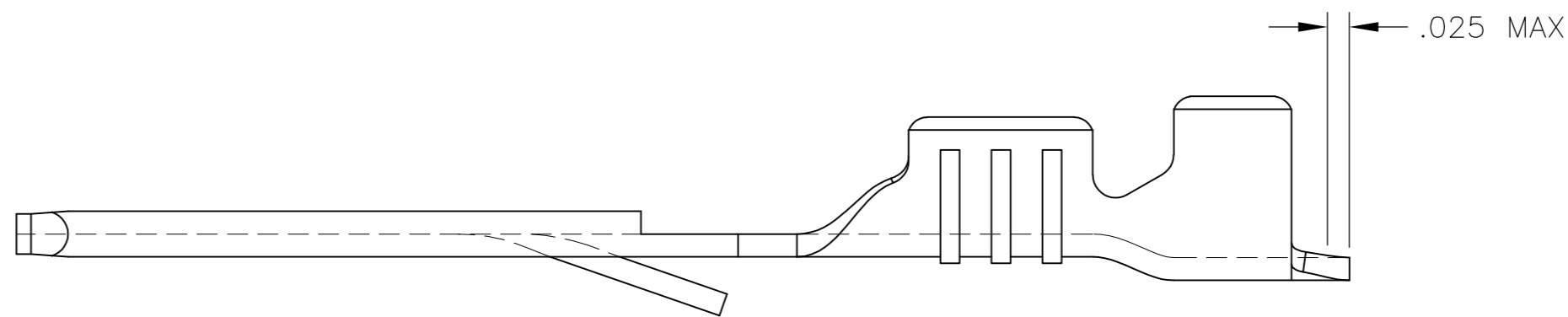
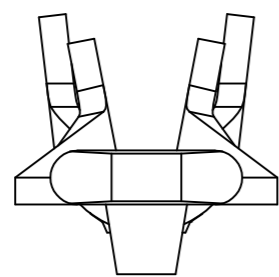
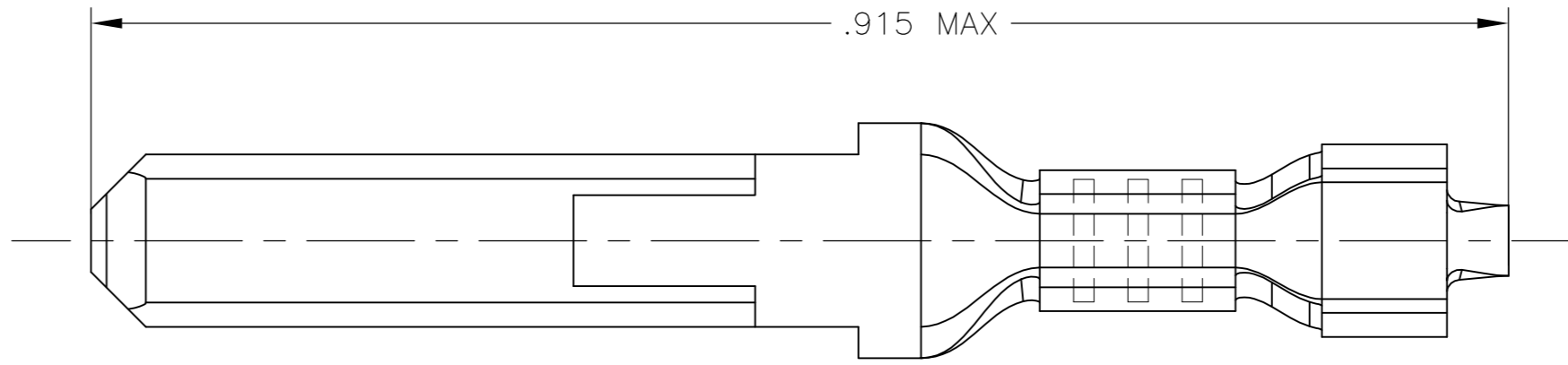

CODE	MATERIAL DESCRIPTION
A	BRASS
B	COPPER
C	STEEL
D	PHOSPHOR BRONZE

CODE	HEATTREATMENT
1	PRE-TIN
2	ELECTRO-TIN
3	SILVER

STOCK THK: .0162  
 WIRE RANGE: 22-20  
 INS. RANGE:  $\phi$ .055-.085

APPLICATOR FEED DIRECTION

OBSOLETE	160147-6	D-2	160309-6
OBSOLETE	160147-5	D	160309-5
OBSOLETE	160147-3	A-3	160309-3
	160147-2	A-2	160309-2
OBSOLETE	160147-1	A	160309-1
	STRIP EQUALITY	MAT.	PART NO

THIS DRAWING IS A CONTROLLED DOCUMENT.

DWN	RAVI S	20NOV2016
CHK	LI DAISY	20NOV2016
APVD	DING TIM	20NOV2016
PRODUCT SPEC		
APPLICATION SPEC		
WEIGHT	-	

TE Connectivity

FF 110 TAB 22-20AWG TPBR LP

SIZE	CAGE CODE	DRAWING NO	RESTRICTED TO
A2	00779	C=160309	-

CUSTOMER DRAWING SCALE 1:1 SHEET 1 of 1 REV A

## X-ON Electronics

Largest Supplier of Electrical and Electronic Components

*Click to view similar products for [Terminals](#) category:*

*Click to view products by [TE Connectivity](#) manufacturer:*

Other Similar products are found below :

[HT-13-10](#) [71M-250-32-NB](#) [01-2065-1-0216](#) [00581P0075](#) [M10-10RX](#) [M10BCK](#) [60205-1](#) [604200-1](#) [60598-1-CUT-TAPE](#) [60617-1-C](#) [60873-1](#) [M14-516R/SK](#) [M14-6RSX](#) [M18-8FBX](#) [M18-8R/LX](#) [M18BCK](#) [61314-6-C](#) [61-S](#) [61-SN-A](#) [62-NBM-A](#) [63-S](#) [640179-1](#) [640917-2-CUT-TAPE](#) [6501550002](#) [66107-2-C](#) [696683-1](#) [696834-1](#) [696861-1](#) [696931-1](#) [696999-1](#) [M8-516RK](#) [M86700006](#) [MA250DMFMX-A](#) [701-2007](#) [701-2307](#) [701-7761-03](#) [70F-110-32-PB](#) [718-N-A](#) [71M-187-20-NBL](#) [71M-250-32-NBL](#) [72F-187-20-NBL](#) [72M-250-32-NBL](#) [7310](#) [73F-250-32](#) [73F-250-32-NL](#) [F14-10C](#) [F-1M](#) [751-250](#) [76650-5002](#) [76828-149](#)