

| REVISIONS | | | | |
|-----------|---------------|---------|-----|------|
| LTR | DESCRIPTION | DATE | DWN | APVD |
| A1 | ECO-09-022178 | 24SEP09 | KK | AEG |

NUMBER C-160625

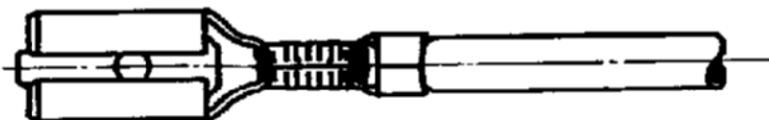

CHAMFER AROUND FRONT OF RECEPTACLE

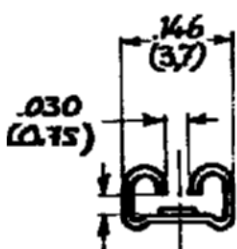
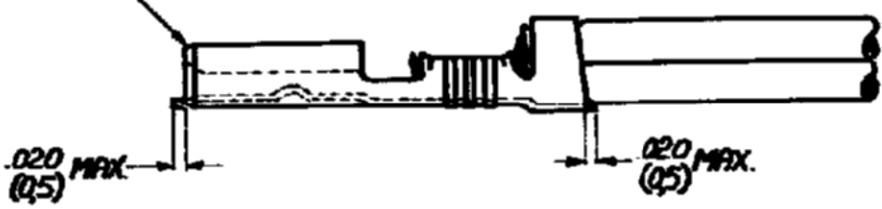

FOR .020 (0.5) TAB-THICKNESS

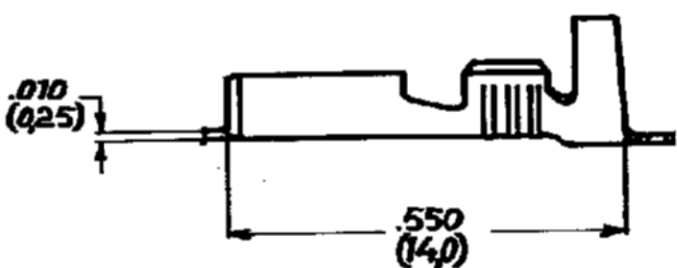
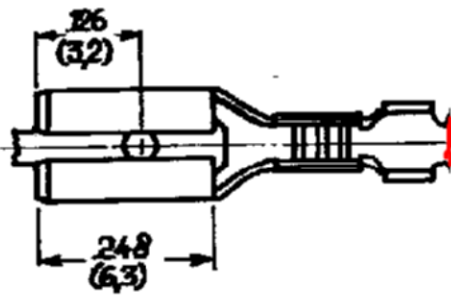

| | | |
|------------|-----------------|---------|
| 1-160625-0 | PHOS. BRONZE | △ |
| 160625-9 | PHOSPHOR BRONZE | PRE-TIN |
| 160625-5 | PHOS. BRONZE | TIN |
| 160625-4 | PHOS. BRONZE | --- |
| 160625-3 | BRASS | SILVER |
| 160625-2 | BRASS | TIN |
| 160625-1/2 | BRASS | --- |

△ BRIGHT PRE-TIN PLATED

△ OBSOLETE PARTS: OBSOLETE CIS STREAMLINING PER D.RENAUD/D.SINISI

CUSTOMER COPY FOR REFERENCE ONLY

©1979 BY AMP-HOLLAND N.V. ALL RIGHTS RESERVED A-MP PRODUCTS COVERED BY PATENTS AND/OR PATENTS PENDING.



AMP-HOLLAND N.V.
's-HERTOGENBOSCH
HOLLAND

| | | |
|----------------------------|---|------------|
| WIRE RANGE 05-10 MAX | INSUL. RANGE 080-120 DIA R.B.-4.0 | FIRST USED |
|----------------------------|---|------------|

| ORDER NO. | MATERIAL | PLATING |
|-----------|----------|---------|
| | | |

| | | | | |
|----------------|----------|-----------|----------------|-----------|
| SCALE 4 ≈ 1 | LOC H | SIZE A | NO C-160625 | REV A1 |
|----------------|----------|-----------|----------------|-----------|

| | | |
|----------|-----------------|----------------|
| DR S | DATE 7-79 | DATE |
| CHK S | DATE 20/1/89 | DATE 2-2-84 |

NAME 110 Ser. FASTON RECEPTACLE 1.P.

DIMENSIONS IN (M.M.) DO NOT SCALE PRINT

X-ON Electronics

Largest Supplier of Electrical and Electronic Components

Click to view similar products for [Terminals](#) category:

Click to view products by [TE Connectivity](#) manufacturer:

Other Similar products are found below :

[00-054007-01074-6](#) [00-054007-70206-1](#) [00-054007-70210-8](#) [00-054007-70217-7](#) [00-054007-70226-9](#) [00-054007-70228-3](#) [00-054007-70248-1](#) [00-054007-70256-6](#) [00-054007-70301-3](#) [00-054007-70316-7](#) [00-054007-49560-4](#) [00-054007-70209-2](#) [00-054007-70225-2](#) [00-054007-70227-6](#) [00-054007-70231-3](#) [00-054007-70241-2](#) [00-054007-70242-9](#) [00-054007-70244-3](#) [00-054007-70246-7](#) [00-054007-70263-4](#) [00-054007-70288-7](#) [00-054007-70290-0](#) [00-054007-70300-6](#) [00-054007-70304-4](#) [01-2065-1-0216](#) [01-2900-1-04412](#) [00581P0075](#) [600TS-10](#) [60205-1](#) [604200-1](#) [605601-1](#) [60598-1-CUT-TAPE](#) [61314-6-C](#) [61810-3](#) [61-S](#) [61-SN](#) [626-0194](#) [62-NBM-A](#) [62-SN](#) [62-SP](#) [63-S](#) [640179-1](#) [M55155/059I03](#) [M55155/079C01](#) [M55155/099H02](#) [M55155/109H01](#) [M55155/109H02](#) [M55155/12XH05](#) [M55155/16XH02](#) [M55155/29-5S](#)