

DO NOT SCALE

DIMENSIONS IN mm

METRIC

THIRD ANGLE
PROJECTION

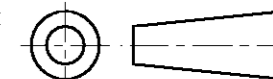

LTR.	REVISION RECORD	DR.	CHK.	DATE
C2	REVISED PER ECO-11-005140	RK	HMR	01APR11

NOTES

- 1. FOR USE ON MINIATURE APPLICATORS (LEFT-RIGHT FEED) AND STANDARD APPLICATORS (RIGHT-LEFT FEED).
- 2. REELED WITH PAPER AND PAPER COVER.
- 3. OBSOLETE PARTS: OBSOLETE CIS STREAMLINING PER D.RENAUD/D.SINISI

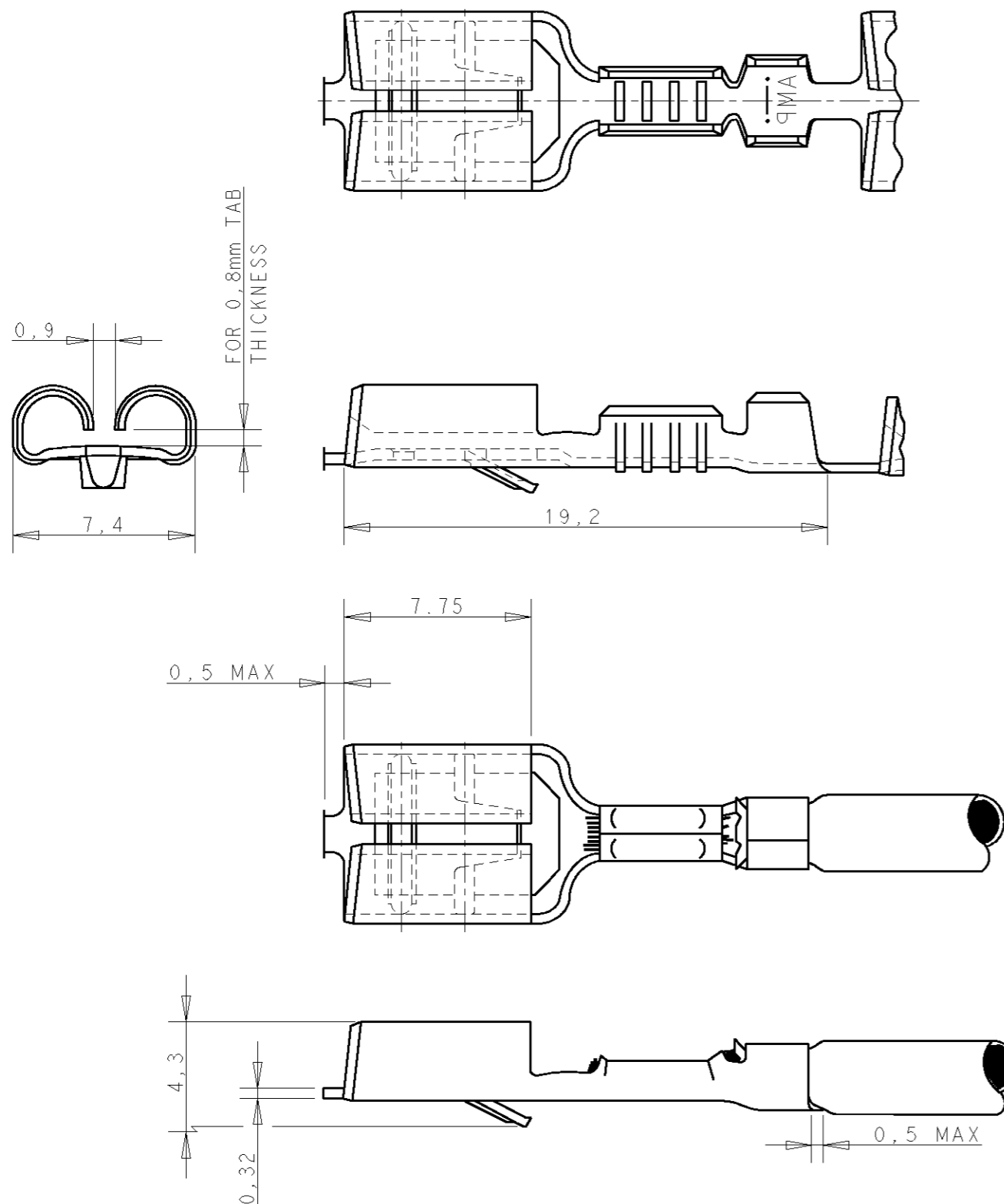

GENERAL TOLERANCES ±0.3

3	OBSOLETE	1	FINISH	MATERIAL	PARTNUMBER
		1	PRE-TINPLATED	PH.BRONZE	6-160928-8
		1	PRE-TINPLATED	BRASS	6-160928-7
		1	TINPLATED	PH.BRONZE	160928-4
		1	UNPLATED	PH.BRONZE	160928-3
		1	TINPLATED	BRASS	160928-2
		1	UNPLATED	BRASS	160928-1

CUSTOMER DRAWING

FOR REFERENCE ONLY
WILL NOT BE UPDATED

STE TE Connectivity

~~THIS DRAWING IS UNPUBLISHED~~ RELEASED FOR PUBLICATION jan ,1988

DR. R.v.Lokven	DATE 26.01.88	WIRE RANGE 0,5-1,0 mm ²	NAME .250 SRS FASTIN-ON RECEPTACLE.	REV. DATE D M Y
CHK. A.B.	DATE 02.02.88	INSUL. RANGE 1,4-2,3 DIA		01 04 11
APP. L.v.Soest	DATE 03.02.88	SIZE A3	SHEET 1 OF 1	REV. LTR. C2

X-ON Electronics

Largest Supplier of Electrical and Electronic Components

Click to view similar products for [Terminals](#) category:

Click to view products by [TE Connectivity](#) manufacturer:

Other Similar products are found below :

[00-054007-01074-6](#) [00-054007-70206-1](#) [00-054007-70210-8](#) [00-054007-70217-7](#) [00-054007-70226-9](#) [00-054007-70228-3](#) [00-054007-70248-1](#) [00-054007-70256-6](#) [00-054007-70301-3](#) [00-054007-70316-7](#) [00-054007-49560-4](#) [00-054007-70209-2](#) [00-054007-70225-2](#) [00-054007-70227-6](#) [00-054007-70231-3](#) [00-054007-70241-2](#) [00-054007-70242-9](#) [00-054007-70244-3](#) [00-054007-70246-7](#) [00-054007-70263-4](#) [00-054007-70288-7](#) [00-054007-70290-0](#) [00-054007-70300-6](#) [00-054007-70304-4](#) [01-2065-1-0216](#) [01-2900-1-04412](#) [00581P0075](#) [600TS-10](#) [60205-1](#) [604200-1](#) [605601-1](#) [60598-1-CUT-TAPE](#) [61314-6-C](#) [61810-3](#) [61-S](#) [61-SN](#) [626-0194](#) [62-NBM-A](#) [62-SN](#) [62-SP](#) [63-S](#) [640179-1](#) [M55155/059I03](#) [M55155/079C01](#) [M55155/099H02](#) [M55155/109H01](#) [M55155/109H02](#) [M55155/12XH05](#) [M55155/16XH02](#) [M55155/29-5S](#)