

| REV | DATE | DESCRIPTION               | BY | CHK | APP |
|-----|------|---------------------------|----|-----|-----|
| F   | 0    | REVISED PER ECR-20-000808 |    | PC  | SW  |

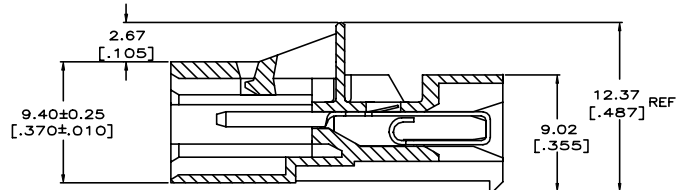
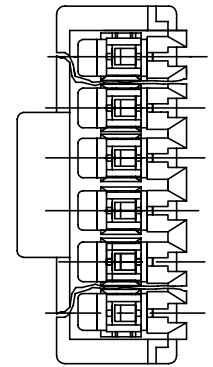
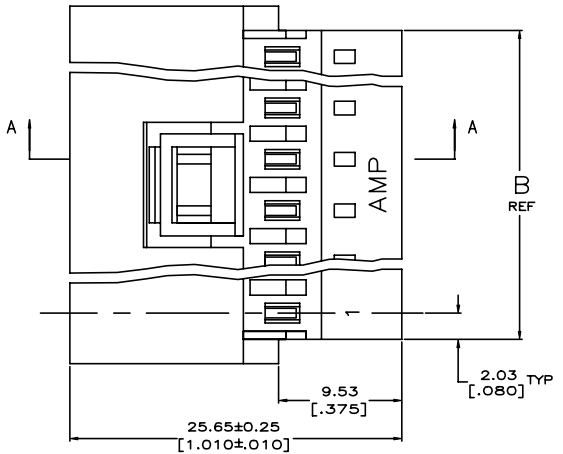
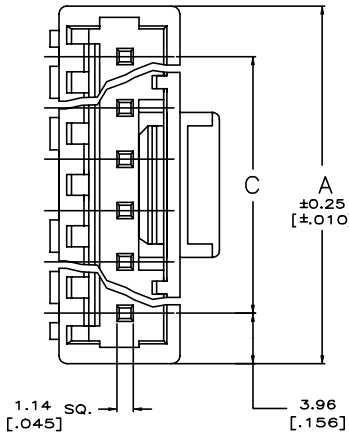

- MATERIAL: CONNECTOR - NYLON UL94-V2 (RED). CONTACTS - 0.30[.012] THICK COPPER ALLOY (BRIGHT TIN-LEAD 0.00203[.000080] MIN. THICK FOR CONTACTS 641437-2 THRU 2-641437-4). (MATTE TIN PLATE 0.00203[.000080] MIN. THICK FOR CONTACTS 3-641437-2 THRU 5-641437-4).
- CONTACTS ACCEPT #22 AWG SOLID, FUSED STRANDED OR STRANDED (7 STRANDS) WIRE WITH 2.41 [.095] MAX INSULATION DIA.
- BOW, IN ANY DIRECTION, NOT TO EXCEED 0.15 [.006] PER IN.
- HOUSING FEATURES: CLOSED END.
- DIMENSIONS IN BRACKETS ARE IN INCHES.
- OBsolete PARTS: OBsolete CIS STREAMLINING PER D.RENAUD/D.SINISI
- OBsolete PARTS

|            | 91.14 | 3.588 | 95.20 | 3.748 | 99.06 | 3.900 | 24 | 5-641437-4 |
|------------|-------|-------|-------|-------|-------|-------|----|------------|
|            | 55.47 | 2.184 | 59.54 | 2.344 | 63.40 | 2.498 | 15 | 4-641437-5 |
|            | 43.59 | 1.716 | 47.65 | 1.876 | 51.51 | 2.028 | 12 | 4-641437-2 |
|            | 31.70 | 1.248 | 35.76 | 1.408 | 39.62 | 1.560 | 9  | 3-641437-9 |
|            | 19.81 | .780  | 23.88 | .940  | 27.74 | 1.092 | 6  | 3-641437-6 |
|            | 11.89 | .468  | 15.95 | .628  | 19.81 | .780  | 4  | 3-641437-4 |
|            | 7.92  | .312  | 11.99 | .472  | 15.85 | .624  | 3  | 3-641437-3 |
|            | 3.96  | .156  | 8.03  | .316  | 11.89 | .468  | 2  | 3-641437-2 |
| OBsolete   | 91.14 | 3.588 | 95.20 | 3.748 | 99.06 | 3.900 | 24 | 2-641437-4 |
| SUPERSEDED | 55.47 | 2.184 | 59.54 | 2.344 | 63.40 | 2.498 | 15 | 1-641437-5 |
| OBsolete   | 43.59 | 1.716 | 47.65 | 1.876 | 51.51 | 2.028 | 12 | 1-641437-2 |
| SUPERSEDED | 31.70 | 1.248 | 35.76 | 1.408 | 39.62 | 1.560 | 9  | 641437-9   |
| SUPERSEDED | 19.81 | .780  | 23.88 | .940  | 27.74 | 1.092 | 6  | 641437-6   |
| SUPERSEDED | 11.89 | .468  | 15.95 | .628  | 19.81 | .780  | 4  | 641437-4   |
| SUPERSEDED | 7.92  | .312  | 11.99 | .472  | 15.85 | .624  | 3  | 641437-3   |
| SUPERSEDED | 3.96  | .156  | 8.03  | .316  | 11.89 | .468  | 2  | 641437-2   |

|  |   |   |                             |                 |             |
|--|---|---|-----------------------------|-----------------|-------------|
| FINISH                                 | C | B | A                           | NO. OF CIRCUITS | PART NUMBER |
| THIS DRAWING IS A CONTROLLED DOCUMENT. |   |   |                             |                 |             |
| DESIGNED BY: S. CARPENTER 5/24/03      |   |   | DRAWN BY: J. BOSSI 7/21/03  |                 |             |
| CHECKED BY: J. BOSSI 7/21/03           |   |   | DATE: 7/21/03               |                 |             |
| DIMENSIONS: mm (INCHES)                |   |   | SCALE: 5:1                  |                 |             |
| MATERIAL: NYLON UL94-V2 (RED)          |   |   | FINISH: BRIGHT              |                 |             |
| APPLICATION: MTA 156                   |   |   | PRODUCT SPEC: 22 AWG        |                 |             |
| CUSTOMER DRAWING                       |   |   | DRAWING NO: A100779C-641437 |                 |             |

## X-ON Electronics

Largest Supplier of Electrical and Electronic Components

*Click to view similar products for [Headers & Wire Housings](#) category:*

*Click to view products by [TE Connectivity](#) manufacturer:*

Other Similar products are found below :

[95000-104TRLF](#) [10135584-644402LF](#) [DF62W-EP2022PCA](#) [95000-106TRLF](#) [DF62W-2022SCA](#) [DF62W-EP2022PC](#) [2203348](#) [DF62W-2022SC](#) [1084018](#) [1029039](#) [1084017](#) [802-10-012-10-002000](#) [1112640](#) [1112639](#) [000-34000](#) [0009482033](#) [0009507031](#) [57102-S06-03LF](#) [57202-S52-04LF](#) [PCN6-15S-2.5E](#) [0039019024](#) [58102-G61-06LF](#) [582553-1](#) [0009508121](#) [0050291907](#) [018731A](#) [LY20-4P-DT1-P1E-BR](#) [02.125.8002.8](#) [60101931](#) [60598-1 \(Cut Strip\)](#) [M1625-3R/100](#) [61062-3](#) [61082-181009](#) [636-1427](#) [638009-1](#) [641938-9](#) [641991-4](#) [644168-1](#) [647662-1](#) [65039-019ELF](#) [65817-002LF](#) [65817-015LF](#) [65863-015LF](#) [66207-023LF](#) [67016-026LF](#) [67046-001LF](#) [67095-007LF](#) [68002-116](#) [68016-236H](#) [68648-049](#)